

FED. ROAD DIST. NO.	STATE	FED. AID PROJ. NO.	FISCAL YEAR	SHEET NO.	TOTAL SHEETS
6	ARK.	136A	1927	1	4

STATE OF ARKANSAS
STATE HIGHWAY DEPARTMENT

PLAN OF PROPOSED BRIDGE
OVER
DITCH NO 9
MARKED TREE - TYRONZA ROAD
POINSETT COUNTY
ROUTE 63 - SECTION 8
JOB No. 1075
FEDERAL AID PROJECT No.

INDEX OF SHEETS

Sheet 1	Drawing 479	Title Sheet
" 2	" 480	General Layout
" 3	" 481	Details Spans & Piers
" 4	" 482	Details of Abutment

QUANTITIES

Item No 13	Dry Excavation	297 Cu Yds
" " "	Wet	35 40 " "
" " 54	Seal concrete	203 208 " "
" " "	C.I.A. concrete	176 181 " "
" " "	C.I.S.	148 " "
" " 55	Rein. Steel	214 219 lbs.
" " 66	Timber Pile (untreated)	1800 Lin. ft.
" " 69	Rip Rap (1' thick)	67 Sq Yds

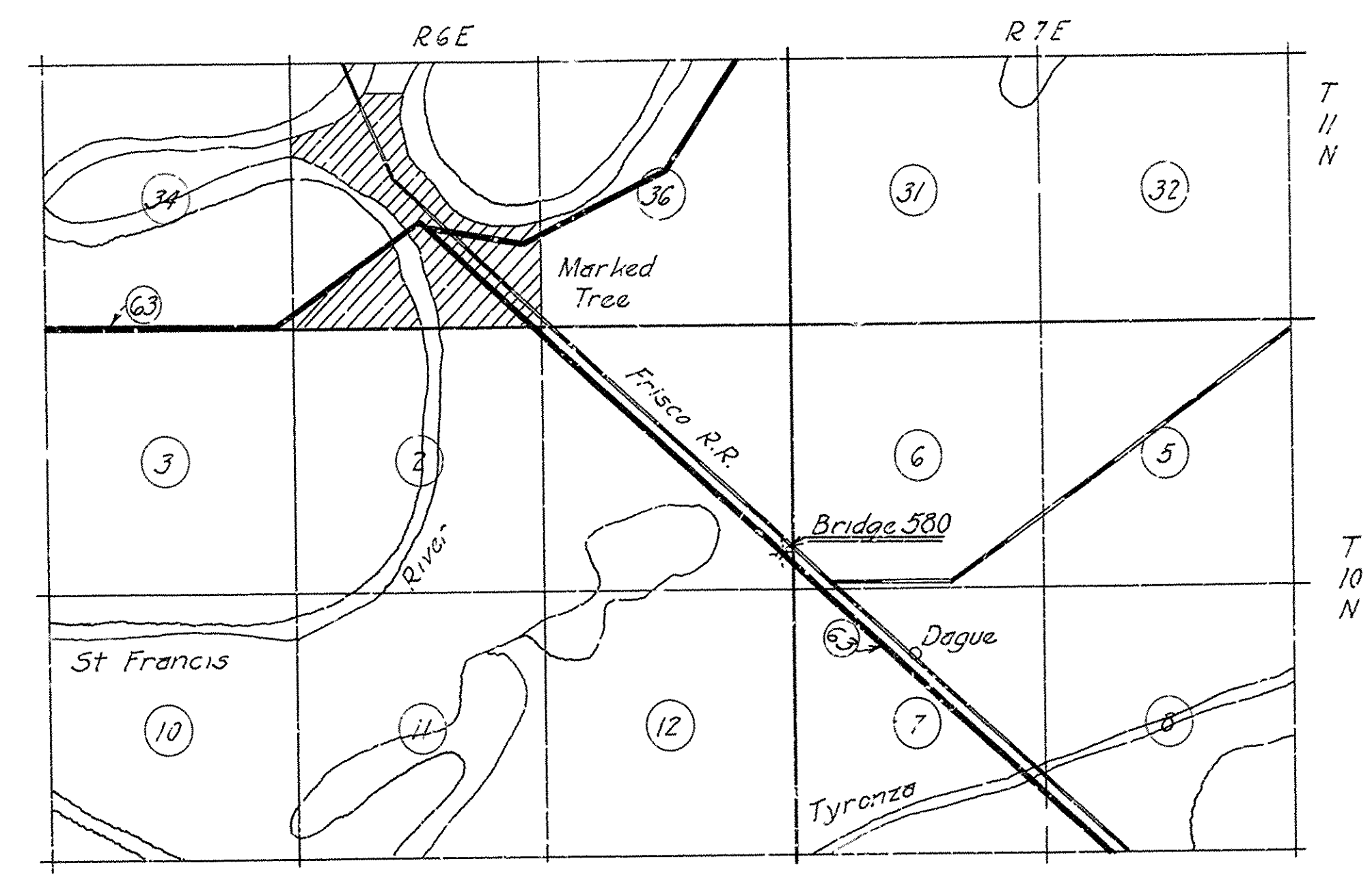

LAYOUT

Scale: 1" = 1/2 Mi
GROSS LENGTH OF PROJECT 92'-2" = .018 Mi
NET LENGTH OF PROJECT 92'-2"

APPROVED
COMMISSIONER STATE LANDS HIGHWAYS AND IMPROVEMENTS
APPROVED
STATE HIGHWAY ENGINEER
RECOMMENDED FOR APPROVAL
DISTRICT ENGINEER - 13 & 14 DIVISION OF PUBLIC ROADS
RECOMMENDED FOR APPROVAL
CHIEF ENGINEER U. S. BUREAU OF PUBLIC ROADS
APPROVED
DIRECTOR U. S. BUREAU OF PUBLIC ROADS

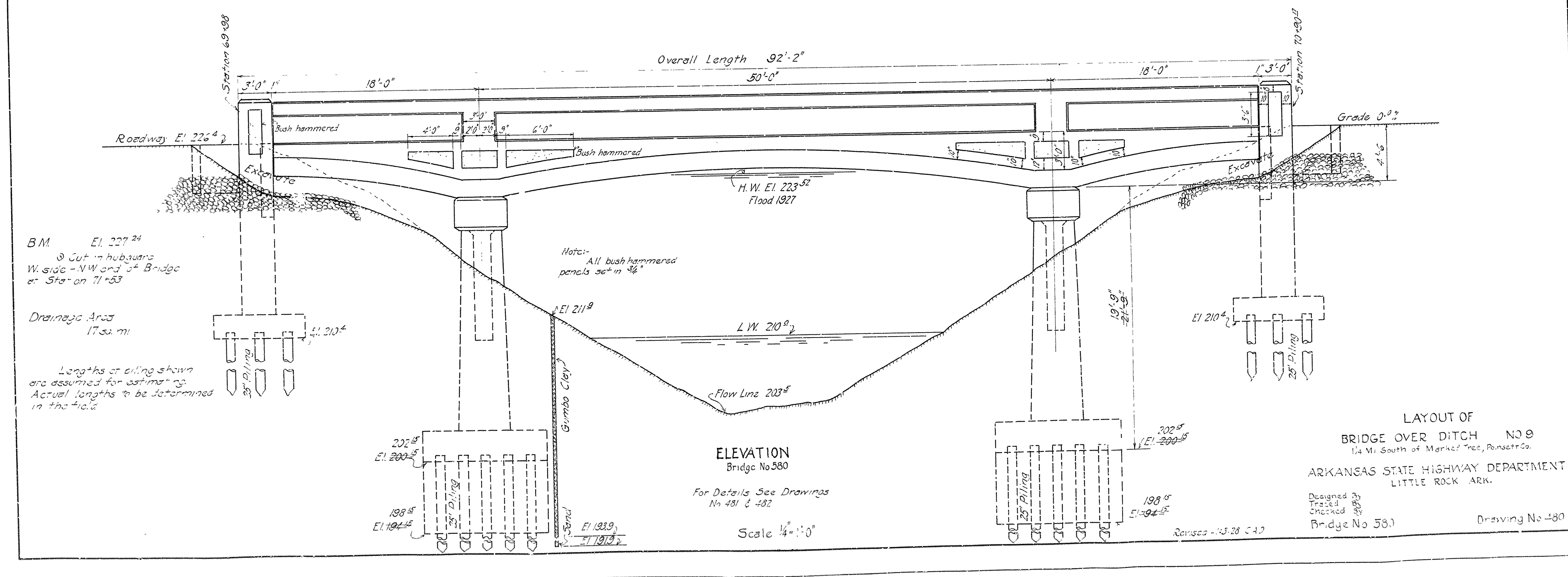
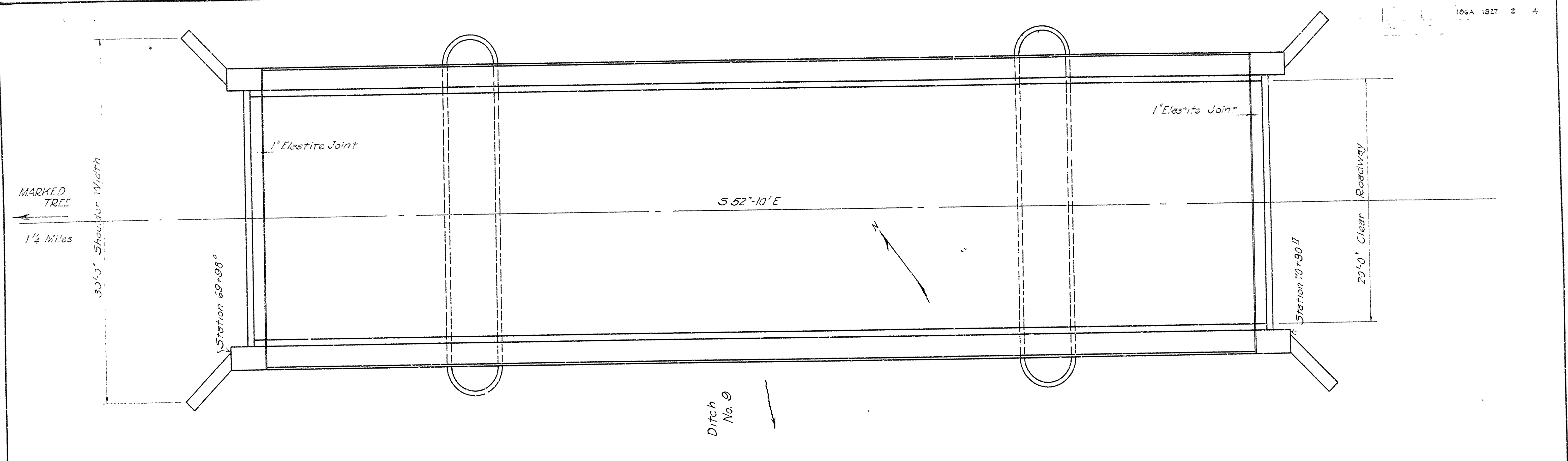

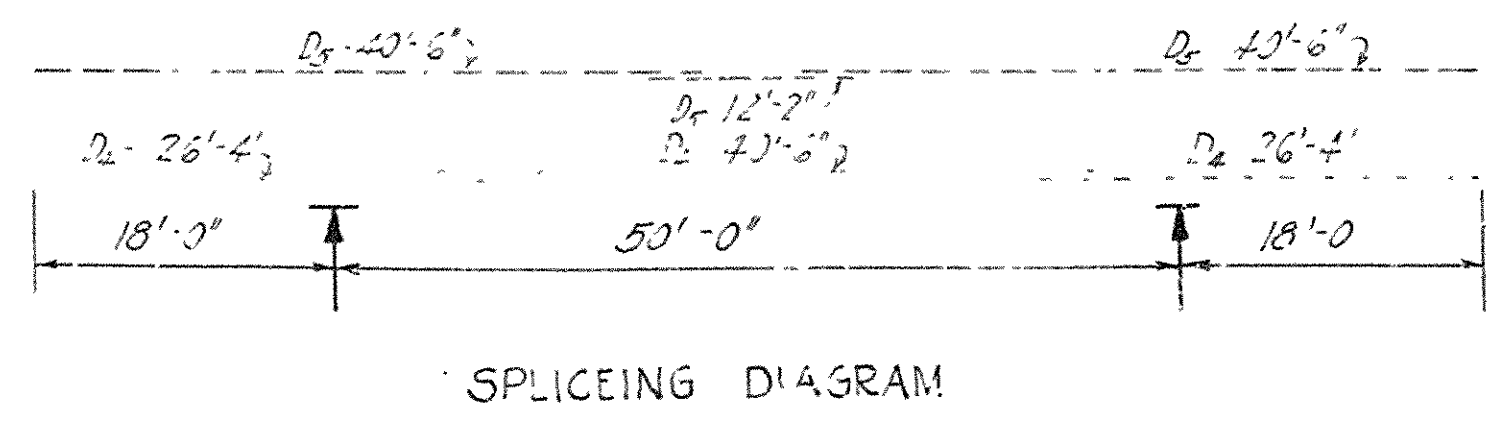
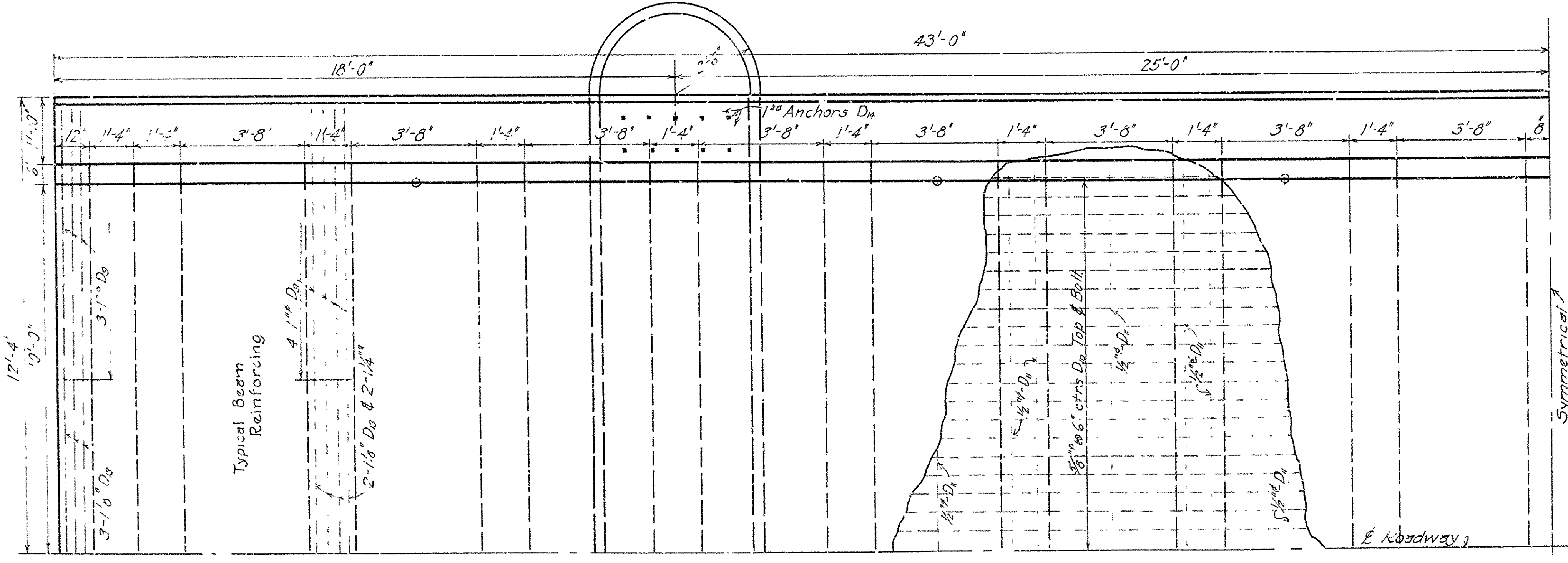
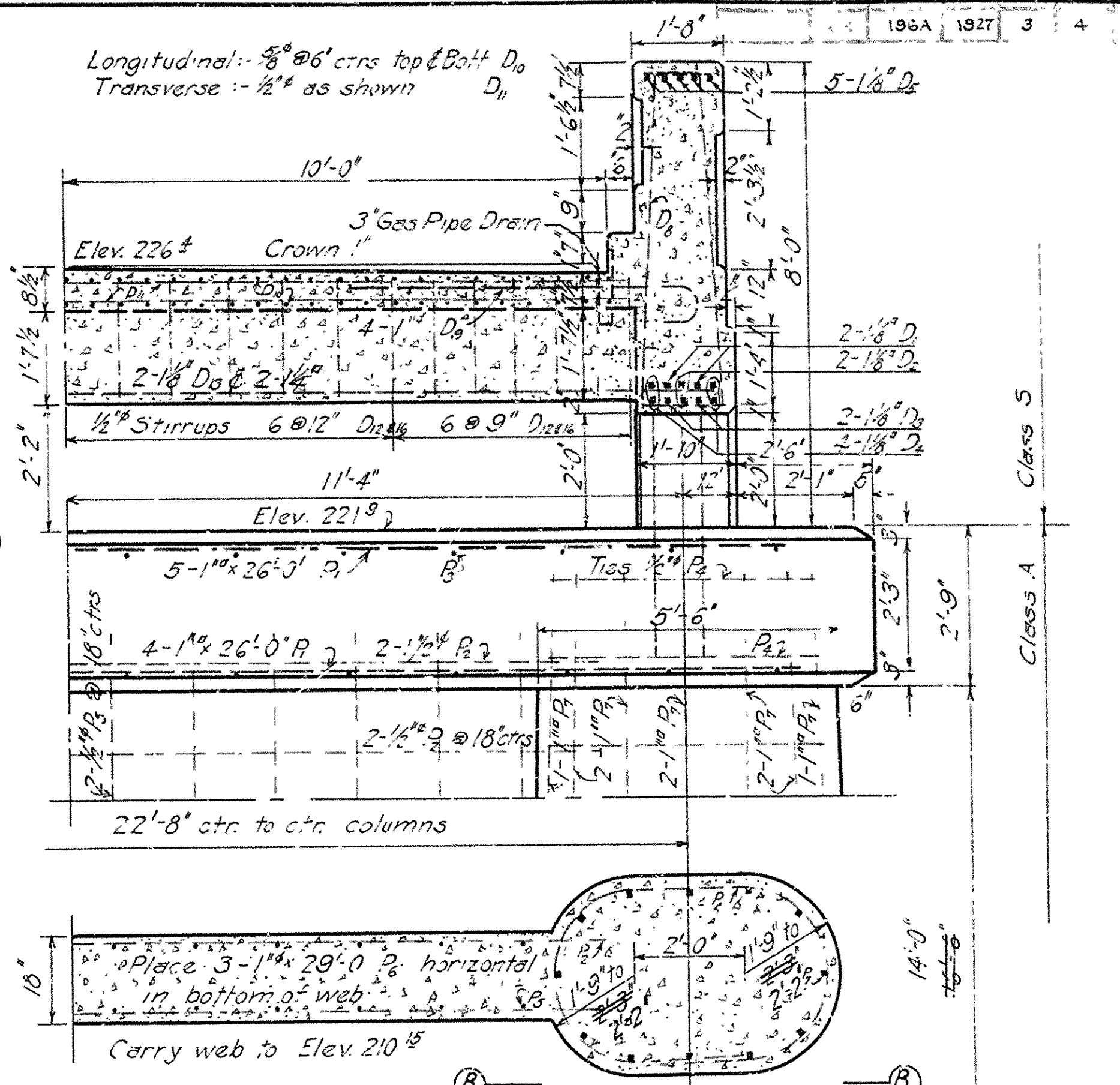
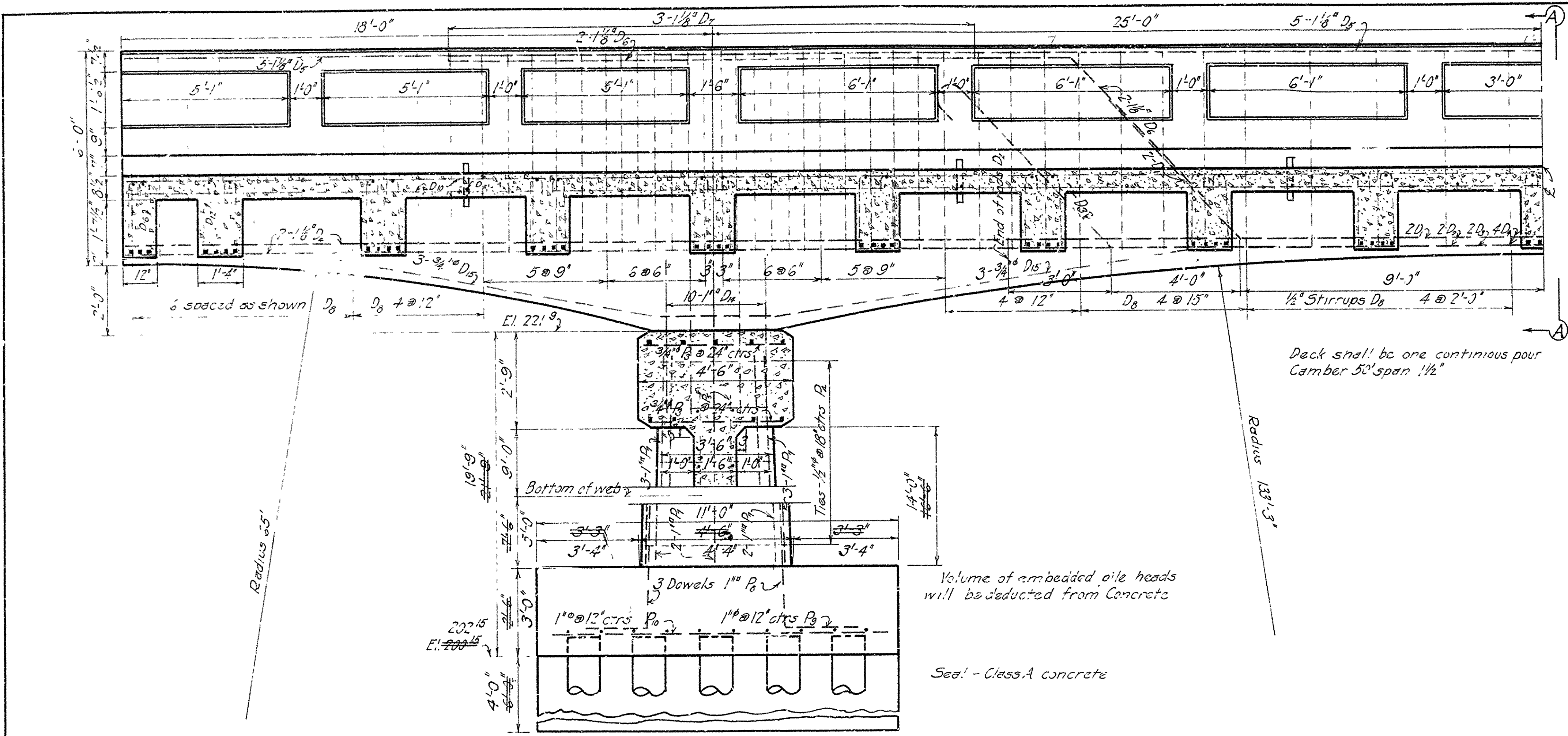

QUARTER PLAN

SECTION A-A

SECTION B-B

DETAILS OF SPANS AND PIERS
 BRIDGE OVER DITCH NO. 9 1 1/4 MI. So. MARKED TREE
 ARKANSAS STATE HIGHWAY DEPARTMENT
 LITTLE ROCK, ARK.

Designed By *E. R.*
 Traced By
 Checked By

Revised 1-3-28 C.V.D.