

FED. ROAD DIST. NO.	STATE	FED. AID PROJ. NO.	FISCAL YEAR	SHEET NO.	TOTAL SHEETS
6	ARK.			1	3

Proj. BRIDGE - ILL. RT. 99 DR. #506

STATE OF ARKANSAS
STATE HIGHWAY DEPARTMENT

PLAN OF PROPOSED BRIDGE
OVER
ILLINOIS RIVER
SILOAM SPRINGS - CINCINNATTI ROAD
ROUTE 99 - SECTION 2
BENTON COUNTY
JOB 430
FEDERAL AID PROJECT No.

INDEX OF SHEETS

SHEET NO.	DRAWING NO.	TITLE
NO. 1	506	DETAILS
NO. 2	507	LAYOUT
NO. 3	10	DETAILS

QUANTITIES

ITEM NO. 62	UNTREATED BRIDGE TIMBER	2,725 MFT. BM.
NO. 52	TREATED BRIDGE TIMBER	91,749 MFT. BM.
NO. 67	TREATED TIMBER PILING	1928 LIN. FT.

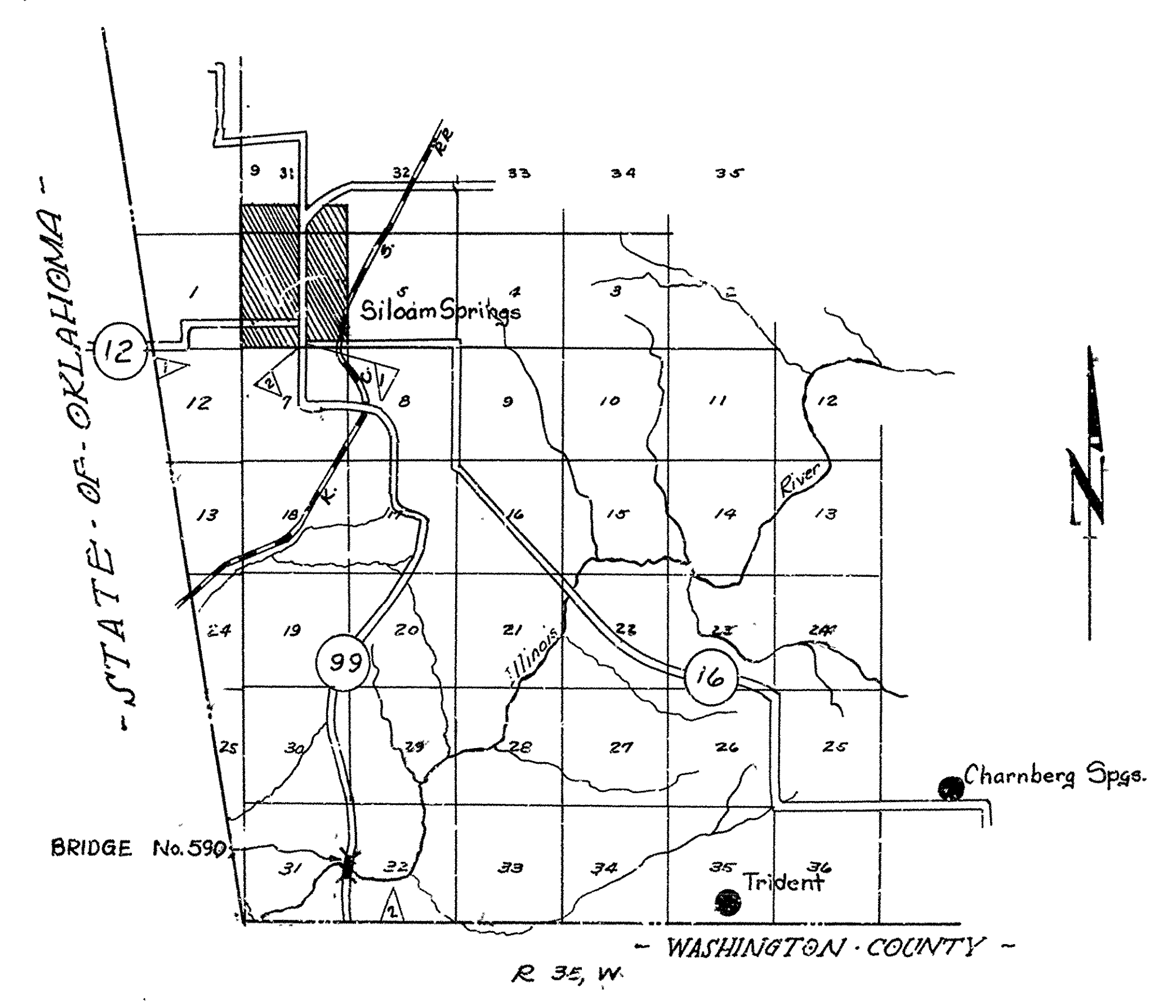

LAYOUT
Scale: 1"=1 MI.

GROSS LENGTH OF PROJECT 582'-4" or .11 mile
NET LENGTH OF PROJECT 582'-4" or .11 mile

M. B. Garret
Bridge Engineer

APPROVED
COMMISSIONER, STATE LANDS, HIGHWAYS AND IMPROVEMENTS

APPROVED
STATE HIGHWAY ENGINEER

RECOMMENDED FOR APPROVAL
DISTRICT ENGINEER - U. S. BUREAU OF PUBLIC ROADS

RECOMMENDED FOR APPROVAL
CHIEF ENGINEER - U. S. BUREAU OF PUBLIC ROADS

APPROVED
DIRECTOR, U. S. BUREAU OF PUBLIC ROADS

