

FISCAL YEAR	SHEET NO.	TOTAL SHEETS

Note: Arch centering shall be lowered before Spandrel walls are poured. Plans showing falsework and proposed order of concreting shall be submitted for approval before work on Arch Barrel is begun. Arch footing shall be carried at least 15 feet into sound rock.

Waterproofing: Ret-rod Tar of Aer-B Grade to be applied in two coats, while hot, to Ext and Inside face of Spandrel Wall 1/4 inch 3" below top. After one coat has been applied one piece of Roofing shall be placed as shown and second coat then put on.

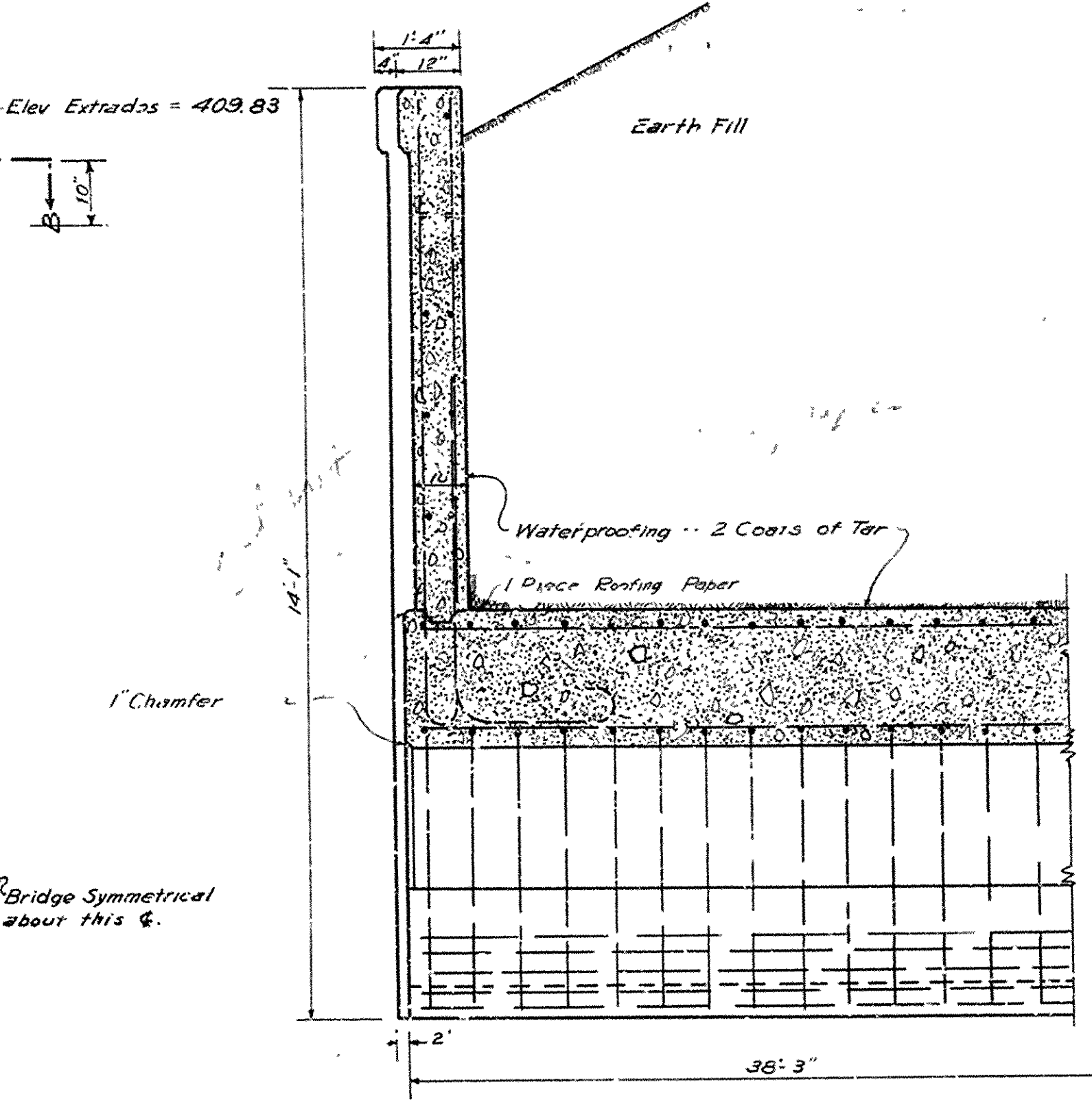
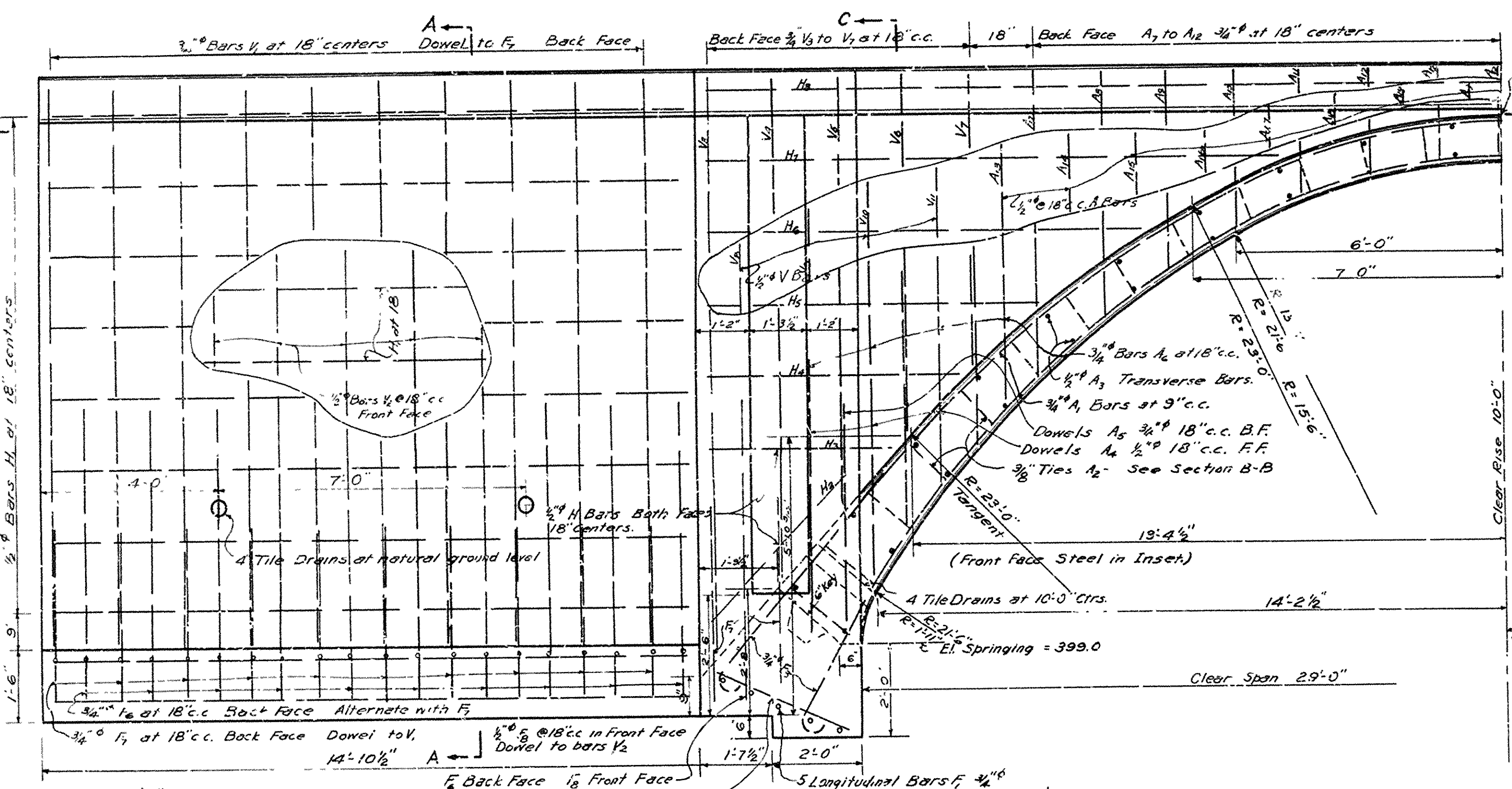

HALF ELEVATION

PART SECTION C-C

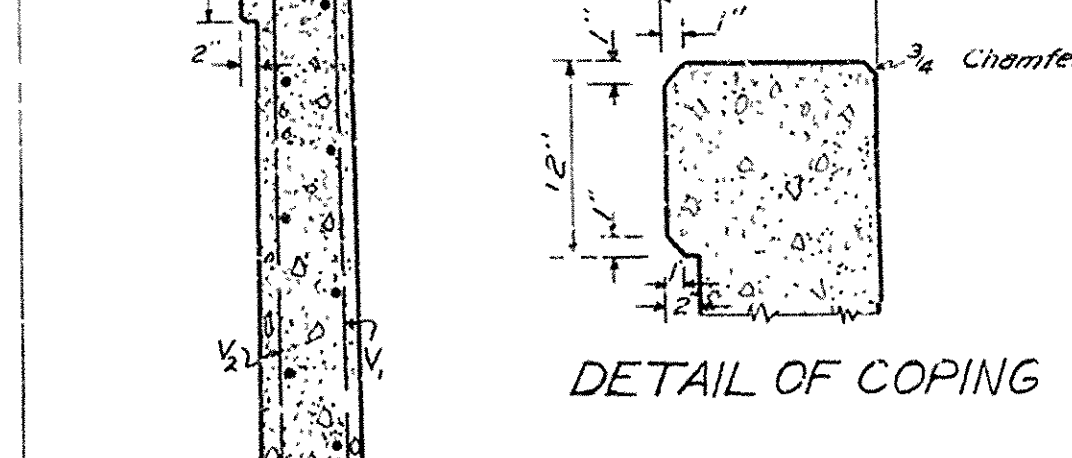

DETAIL OF COPING

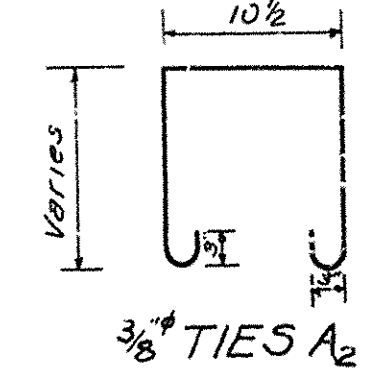

3/8 TIES A2

Mark	No.	Size	a	b	Length
F ₁	44	3/4"	6"	12'-6"	13'-3"
F ₂	400	1/2"	4"	3'-8"	4'-2"
A ₁	16	-	4"	4'-0"	4'-6"
A ₂	4	-	4"	7'-0"	7'-6"
A ₃	4	-	4"	5'-6"	6'-0"
A ₄	4	-	4"	4'-6"	5'-0"
A ₅	4	-	4"	3'-6"	4'-0"
A ₆	4	-	4"	2'-9"	3'-3"
A ₇	4	-	4"	2'-3"	2'-9"
A ₈	8	-	4"	1'-9"	2'-3"

Mark	Size	No.	a	b	Length
F ₁	3/4"	44	2'-3"	6'-2"	5'-11 1/2"
F ₂	-	48	2'-3"	3'-8"	6'-3 1/2"
A ₁	-	24	2'-6"	3'-6"	8'-6 1/2"
A ₂	-	4	2'-6"	6'-3"	3'-3 1/2"
A ₃	-	4	2'-6"	5'-0"	8'-0 1/2"
A ₄	-	4	2'-6"	4'-0"	7'-0 1/2"
A ₅	-	4	2'-6"	3'-2"	6'-3 1/2"
A ₆	-	4	2'-6"	2'-6"	5'-6 1/2"
A ₇	-	10	2'-6"	1'-8"	4'-8 1/2"

All exposed corners to have 3/4" Chamfer unless otherwise noted. Reinforcing Steel to be deformed bars of Structural or Intermediate Grade. Shop List and Bending Diagrams of Reinforcing Steel must be submitted by Contractor before fabrication is begun. Roadway Drains and expansion devices to be paid for at unit price bid for Reinforcing Steel. Specifications: Ark Std Road and Bridge Specifications adopted May 30th 1925. All Concrete to be poured in the dry.

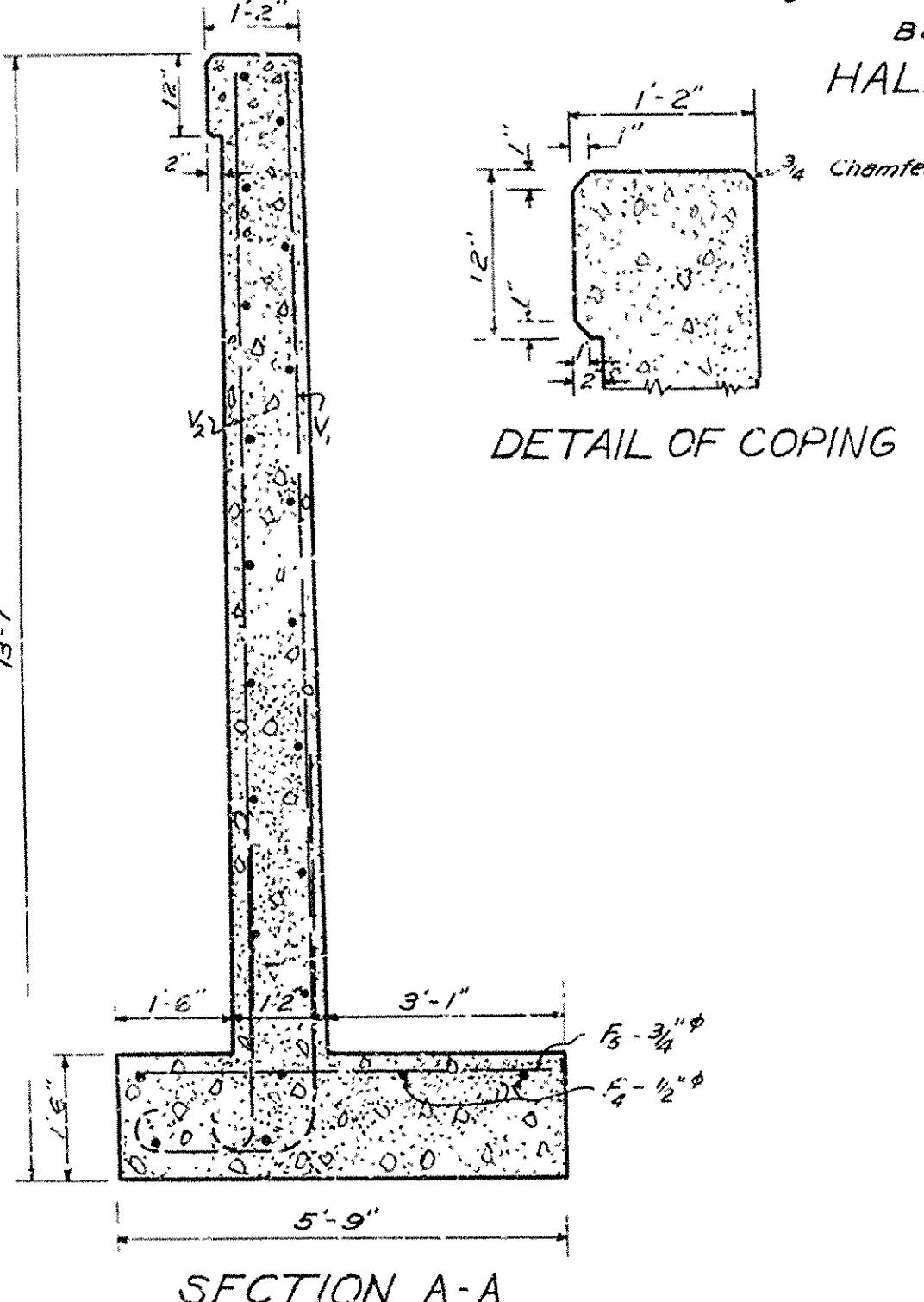

SECTION A-A

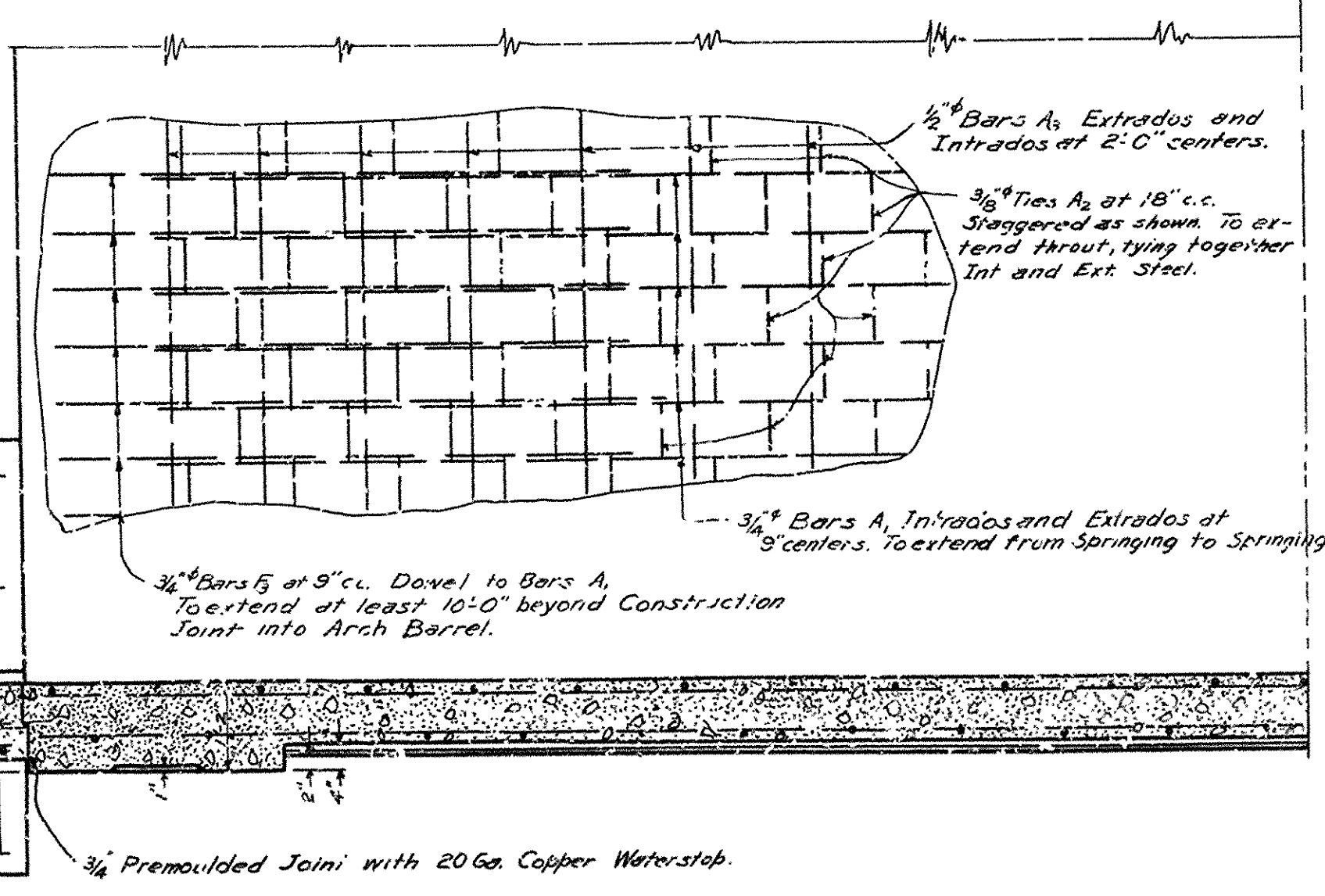

PART SECTION B-B

ROUTE SEC.
ARKANSAS STATE HIGHWAY DEPARTMENT
 LITTLE ROCK, ARK.
 Drawn By: _____ Date: _____
 Traced By: _____ Date: _____
 Checked By: _____ Date: _____
 Scale: in. ft.
BRIDGE NO. 815 **DRAWING NO. 1626**

BRIDGE ENGINEER