

STATE OF ARKANSAS  
STATE HIGHWAY DEPARTMENT

FISCAL YEAR	JOB NO.	SHEET NO.	TOTAL SHEETS
1929	487	1	13

PLAN OF PROPOSED BRIDGES  
ON  
FAYETTEVILLE-ELKINS ROAD  
WASHINGTON COUNTY

ROUTE 16 SEC. 3  
JOB NO 487  
FEDERAL AID PROJECT No.

INDEX OF SHEETS

Sheet No.	Drawing No.	Title
1	1499	Title Sheet
2	1500	Layout of Bridge No. 992
3	1501	Details " "
4	20	Details of Standard 19' Timber Trestle, 18' Rdwy.
5	1502	Layout of Bridge No. 993
6	1503	Details of Substructure of Br. No. 993
7	124	Details of Standard 130' Steel Truss, 18' Rdwy.
8	F.S. 22-A	Typical Cross Sections, 22' Flat Subgrade.
9-13		Plan, Profile and Cross Section Sheets.

It is hereby approved that the above described Public Property be used for the purpose of the above described Project and that the same may be used for the purpose of the above described Project in accordance with the provisions of the Act of the General Assembly of the State of Arkansas, approved March 11, 1929, Chapter 107, Section 107-1, 107-2, 107-3, 107-4, 107-5, 107-6, 107-7, 107-8, 107-9, 107-10, 107-11, 107-12, 107-13, 107-14, 107-15, 107-16, 107-17, 107-18, 107-19, 107-20, 107-21, 107-22, 107-23, 107-24, 107-25, 107-26, 107-27, 107-28, 107-29, 107-30, 107-31, 107-32, 107-33, 107-34, 107-35, 107-36, 107-37, 107-38, 107-39, 107-40, 107-41, 107-42, 107-43, 107-44, 107-45, 107-46, 107-47, 107-48, 107-49, 107-50, 107-51, 107-52, 107-53, 107-54, 107-55, 107-56, 107-57, 107-58, 107-59, 107-60, 107-61, 107-62, 107-63, 107-64, 107-65, 107-66, 107-67, 107-68, 107-69, 107-70, 107-71, 107-72, 107-73, 107-74, 107-75, 107-76, 107-77, 107-78, 107-79, 107-80, 107-81, 107-82, 107-83, 107-84, 107-85, 107-86, 107-87, 107-88, 107-89, 107-90, 107-91, 107-92, 107-93, 107-94, 107-95, 107-96, 107-97, 107-98, 107-99, 107-100.

SPECIAL PROVISIONS

- Treated Br. Timber, Supply to Par. 522 1 Sheets
- Revisions to Par. 17.2 and 17.3 1 Sheets
- Treated Timber Pile Cut-off 1 Sheets
- Raising Approach, Removing Abutment 1 Sheets
- Wings & Reflooring Existing Spans of Br. No. 982 1 Sheets
- Painting Existing Structural Steel 1 Sheets

QUANTITIES

Item No.	Description	Quantity	Unit
12	Common Excavation	2925	Cu. Yds.
13	Dry " for Structures	89	" "
13	Wet " " "	100	" "
13	Rock " " "	13	" "
17	Borrow	3531	" "
19	Overhaul	10,995	Sta. "
52	Untreated Timber	4,564	M. Ft. B. M.
52	Treated " "	137,869	" " "
54	Class "A" Concrete	110.67	Cu. Yds.
54	" "S" " "	57.14	" "
55	Reinforcing Steel	12,554	Lbs.
56	Structural Steel (Trusses)	111,000	" "
67	Treated Timber Piling	3,640	Lin. Ft.
69	Rip Rap	240	Sq. Yds.
S.P.	Treated Timber Pile Cut-off	284	Lin. Ft.
"	Painting Existing Struct'l Steel		Lump Sum
"	Raising Approach, Removing Abutment		" "
"	Wings & Reflooring Existing Spans		" "

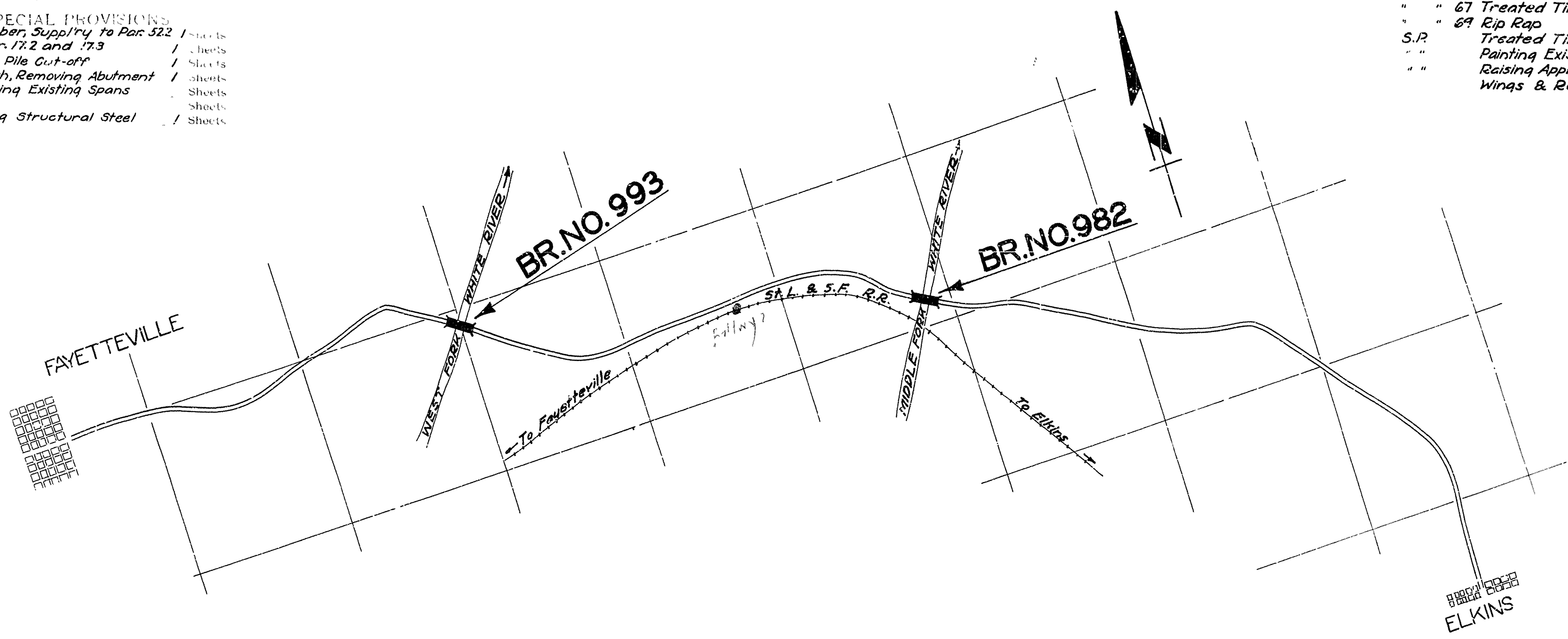

LAYOUT  
Scale: 1" = 2000'

LENGTH OF PROJECT = 999'-0"

APPROVED  
COMMISSIONER - STATE LANDS, HIGHWAYS AND IMPROVEMENTS

APPROVED  
STATE HIGHWAY ENGINEER

RECOMMENDED FOR APPROVAL  
DISTRICT ENGINEER - U.S. BUREAU OF PUBLIC ROADS

RECOMMENDED FOR APPROVAL  
CHIEF ENGINEER - U.S. DEPT. OF PUBLIC ROADS

APPROVED  
DIRECTOR - U.S. BUREAU OF PUBLIC ROADS

M.B. Laver  
BRIDGE ENGINEER

FISCAL YEAR	JOB NO.	SHEET NO.	TOTAL SHEETS
1929	487	5	13

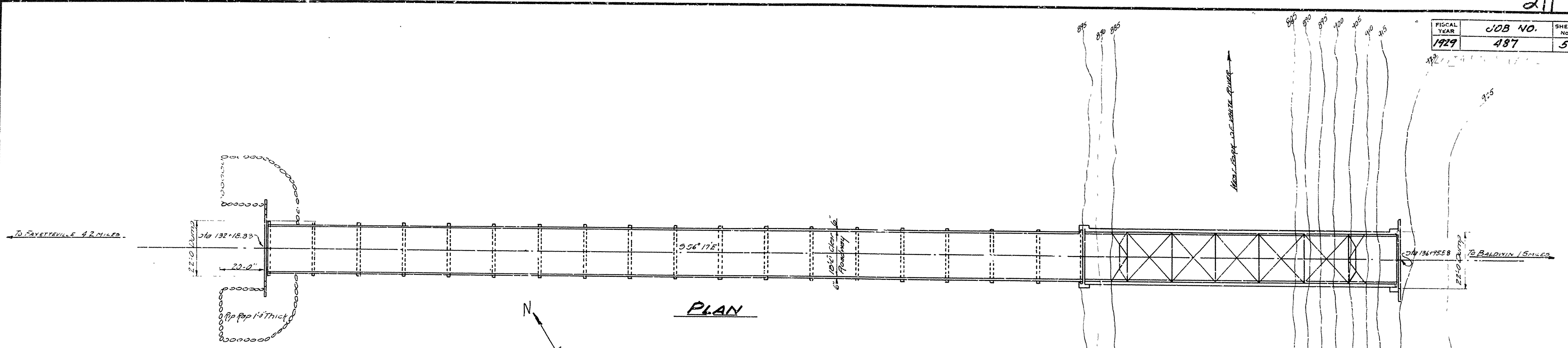

**QUANTITIES**

Item No 12 Common Excavation	for Struct's	2925 Cu.Yds.
" 13 Dry "	" "	89 "
" 13 Solid Rock Excavation "	" "	100 "
" 19 Overhaul "	" "	13 "
" 24 Corroded Timber "	" "	10,995 Sta.Yds
" 32 Trailing "	" "	2,417 M.F.F.B.M.
" 34 Class A Concrete "	" "	63,574 "
" 34 "	" "	101.83 Cu.Yds
" 35 Reinforcing Steel "	" "	37.14 "
" 36 Struct Steel in Trusses "	" "	11,554 Lbs.
" 67 Tr Timber Filling "	" "	2416 Lin. Ft.
" 67 Rip Rap (1 1/2 Thick) "	" "	240 Sq. Yds.
S.P. Tr Timber Pile Cut-off	" "	140 Lin. Ft.

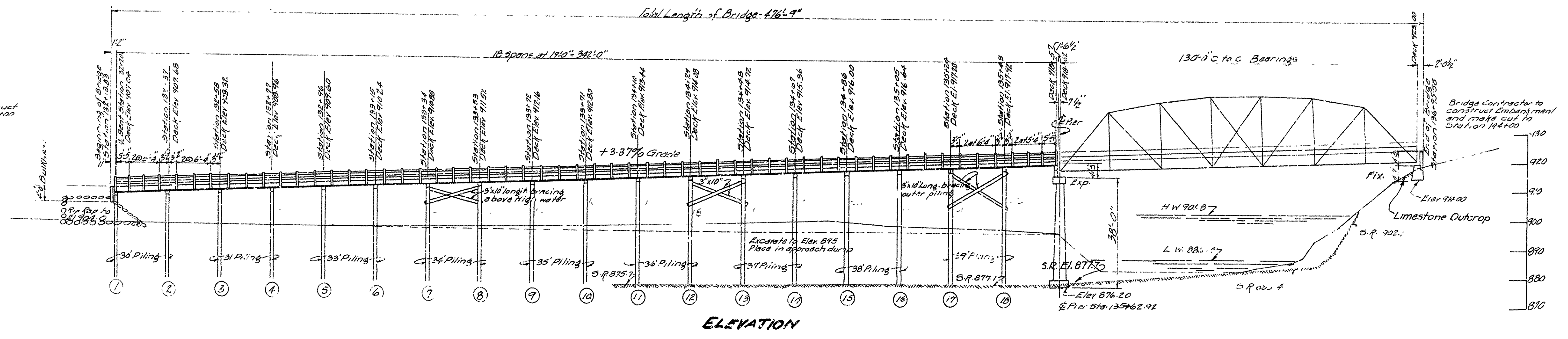

BENCH MARKS  
 Nail in 30" Elm 40' at station 135+63 Elev. 877.33  
 Nail in root 30" Oak 80' at station 137+28 Elev. 923.92

Note: Lengths of piling shown are for estimating quantities only. Actual lengths to be determined in the field. Lengths shown include 2'-0" cut-offs.

For details see div. No 20 & 124 & 1519

Drainage Area - 125 Sq. miles  
 Topography - Mountainous

**LAYOUT OF BRIDGE OVER  
 WEST FORK OF WHITE RIVER  
 WASHINGTON COUNTY  
 ROUTE 16 SEC. 3  
 ARKANSAS STATE HIGHWAY DEPARTMENT  
 LITTLE ROCK, ARK.**

Drawn By: *Caplan* Date: 2-26-29  
 Traced By: *Caplan* Date: 4-6-29  
 Checked By: \_\_\_\_\_ Date: \_\_\_\_\_  
 BRIDGE NO. 993 DRAWING NO. 1502

*H. B. Kean*  
 BRIDGE ENGINEER

