

STATE OF ARKANSAS
STATE HIGHWAY COMMISSION

FISCAL YEAR	JOB NO.	SHEET NO.	TOTAL SHEETS	FED. DIST. NO.	STATE	N. R. N. PROJ. NO.	FISCAL YEAR	SHEET NO.	TOTAL SHEETS
1934	8150	1	7	6	ARK.	256-B	1934	1	7

INDEX OF SHEETS

Sheet No.	Dwrgr	No.	Title Sheet
1		3252	Title Sheet
2		3253	Layout of Bridge No. 1198
3		3254	Details of Piers for Bridge No. 1198
4		3255	Layout of Bridge No. 1724
5		2329	Details of Std. 36'-0" R.C.D. Girder & Pile Bents - 24'-0" Rdy.
6		2449	Details of Std. 100'-0" Low Truss Span - 24'-0" Rdy.
7			Details of Bronze Protect Marker Plates & Bronze State Bridge Name Plates

**PLAN OF PROPOSED BRIDGES
OVER HORSEHEAD CREEK
HARTMAN-CLARKSVILLE ROAD
JOHNSON COUNTY**

ROUTE 64 SEC. 4
JOB NO 8150

NATIONAL RECOVERY HIGHWAY PROJECT NO. 256-B
FEDERAL AID PROJECT NO. 256-B

QUANTITIES

Item No.	Description	Quantity
13	Dry Excavation for Structures	315 Cu. Yds.
13	Wet Excavation for Structures	371 " "
13	Solid Rock Excavation for Structures	214 " "
21	Class "A" Concrete for Bridges	322.6 " "
21	Class "S" Concrete for Bridges	594.50 " "
22	Reinforcing Steel for Bridges	176813 Lbs
23	Concrete Piling	1820 Lin Ft.
24	Concrete Railing for Bridges	664 Lin. Ft.
25	Rip Rap	558 Cu Yds.
26	Structural Steel	219,310 Lbs
3.P	Cast Steel and Cast Iron	4624 Lbs.
3.P	Bronze Expansion Devices	2766 Lbs.
3.P	Removal of Existing Structures	Lump Sum
3.P	Bronze Protect Marker Plates	4 each
3.P	Bronze State Bridge Name Plates	4 each

Project Marker Plates to be placed by Contractor on the roadway side of right hand rail post of each bridge.

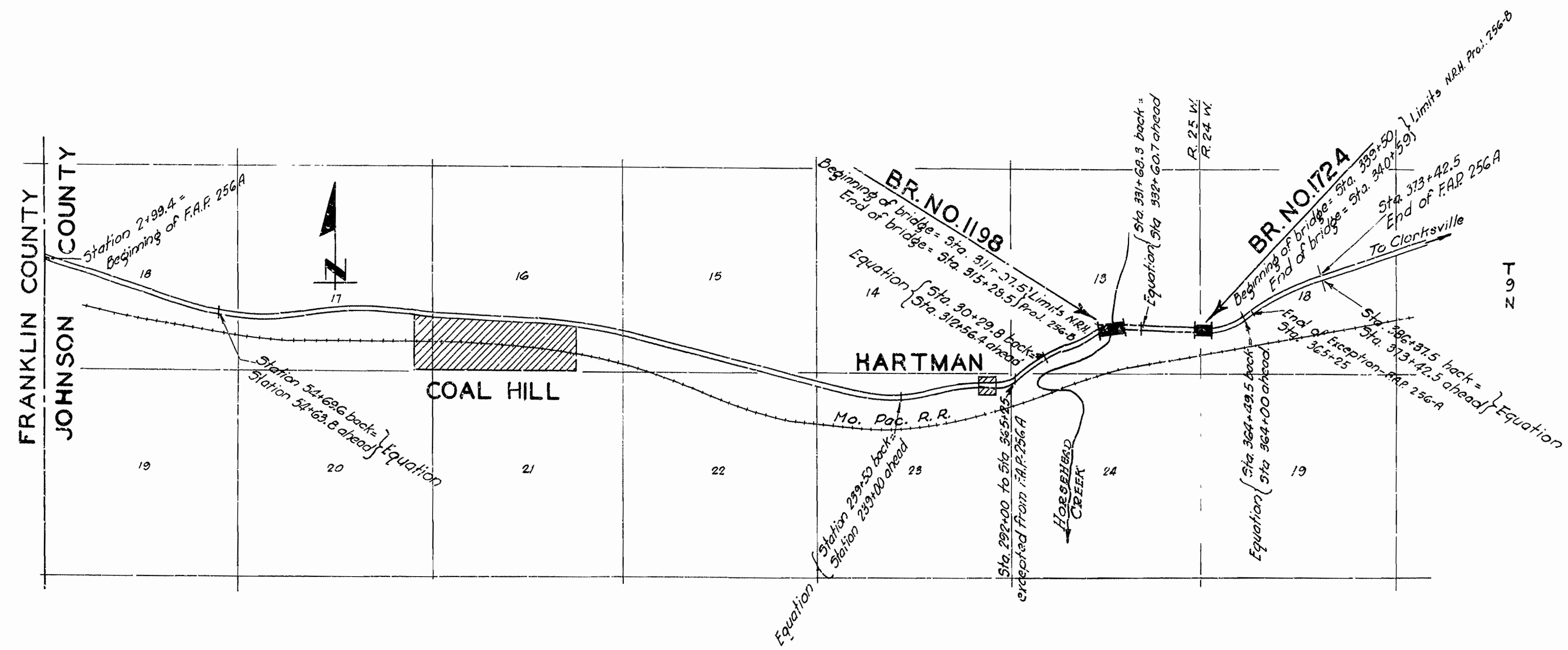

Specifications approved by Chief, Bureau of Public Roads, September 28, 1925, and adopted by State Highway Commission May 30, 1925 with revisions and Special Provisions as follows:

REVISIONS

Pamphlet A Revised Mar. 1st, 1931 Approved June 13, 1931

Letter	Date	Description
L	Revised Feb 10, 1933	
M	Mar 1, 1931	June 13, 1931
N	Sept. 1, 1932	
O	Sept. 1, 1932	

SPECIAL PROVISIONS

Item	No. of Sheets
NURA (Labor)	11
Partial Payments Revised 9-26-32-1933	1
Removal of Existing Structures, 8-15-33	1
Cast Steel and Cast Iron 7-17-33	1
Bronze Expansion Devices 8-15-33	1
Arkansas Material and Labor	1
Bronze Protect Marker Plates & Bronze State Bridge Name Plates 8-10-33	1

LAYOUT
Scale: 1" = 200'

LENGTH OF PROJECT	= 530'-0" = 0.099 MI.
LENGTH OF BRIDGES	= 530'-0" = 0.099 MI.
LENGTH OF EMBANKMENT	= 0'-0" = 0.000 MI.
LENGTH OF JOB	= 530'-0" = 0.099 MI.

APPROVED [Signature]

CHIEF ENGINEER - U. S. BUREAU OF PUBLIC ROADS

APPROVED [Signature]

DISTRICT ENGINEER - U. S. BUREAU OF PUBLIC ROADS

APPROVED [Signature]

CHIEF - U. S. BUREAU OF PUBLIC ROADS

APPROVED [Signature]

CHAIRMAN - STATE HIGHWAY COMMISSION

APPROVED [Signature]

STATE HIGHWAY ENGINEER

N. R. Lawrence
BRIDGE ENGINEER

BRIDGES NO. 1198, 1724

DRAWING NO. 3252

FISCAL YEAR	Job No	SHEET NO	TOTAL SHEETS
1934	5150	2	7

RIGHT OF WAY DATA				
From Sta	To Sta	Rt of E	Lt of E	Total Width
302+00	311+00	60'	65'	125'
311+00	315+10.5	40'	40'	80'
315+10.5	320+00	75'	75'	150'

TANGENT DISTANCE DATA	
From Beginning of Br.	From End of Br.
126.9'	2548.5

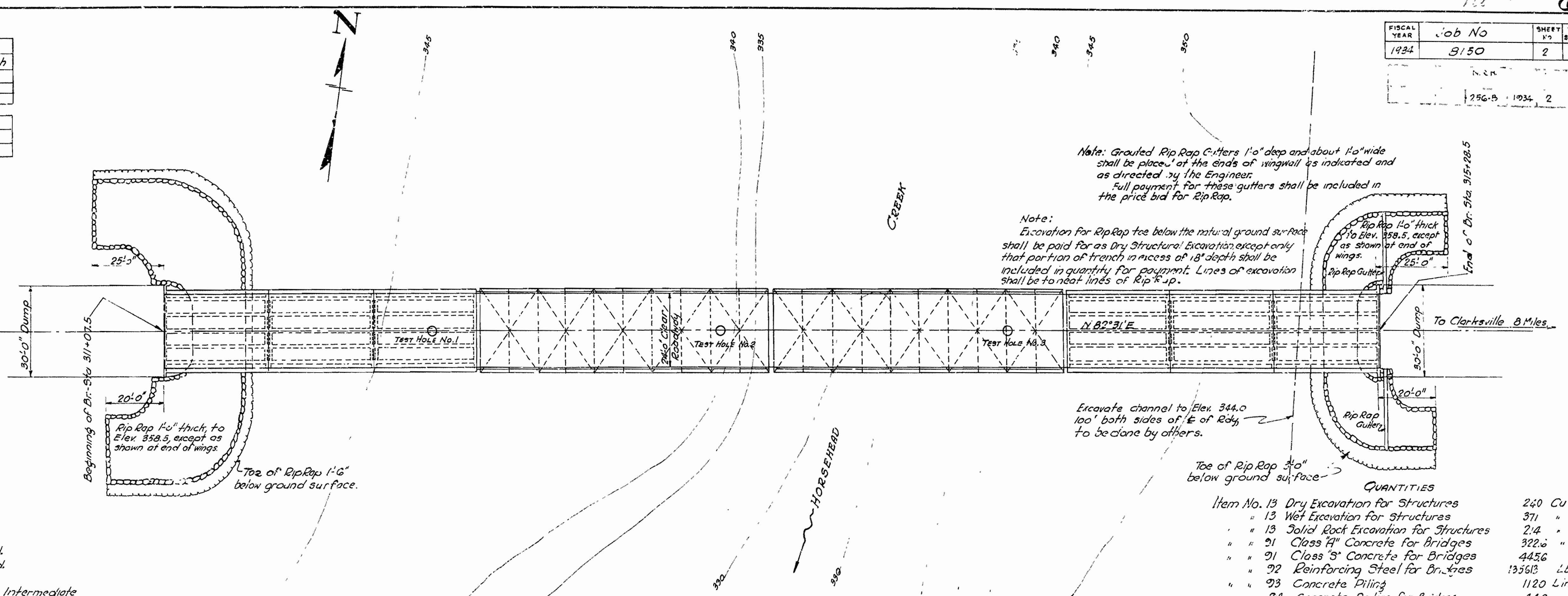

GENERAL NOTES

All concrete to be placed in the dry.
 All exposed corners to have 1/4" chamfer, unless otherwise noted.
 All concrete in substructure to be Class 'A' except as noted.
 Expansion Joints to be constructed as shown on Layout.
 Reinforcing Steel to be deformed bars of Structural or Intermediate grade. Shop List and Bending Diagrams must be submitted and approved before fabrication is begun.
 Lengths of Piling shown are assumed for estimating quantities only. Actual lengths to be determined in the field.
 Precast Concrete piles are to be provided with cast iron pile points as shown in detail on Layout Sheet For Br. No. 1724. Octagon type piles to be used.
 Contractor is to remove existing bridge and approach. See Special Provisions.
 Contractor shall place Rip Rap at Bridge End as indicated.

For Details of 36"-0" R.C.D. Girder Spans, See Dwg. No. 2523.
 For Details of 100'-0" Low Truss Span, See Dwg. No. 2449
 Field Paint: 1st Coat, white lead tinted with lamp black, and 2nd Coat, aluminum paint (See Specifications)
 Specifications: Arkansas Standard Road and Bridge Specifications, adopted, May 30, 1925, and revised
 Volumes occupied by pile heads will not be included in pay quantity of concrete caps.

Note: Grouted Rip Rap Cutters 1'-0" deep and about 1/2" wide shall be placed at the ends of wingwall as indicated and as directed by the Engineer.
 Full payment for these gutters shall be included in the price bid for Rip Rap.

Note:
 Excavation for Rip Rap toe below the natural ground surface shall be paid for as Dry Structural Excavation except only that portion of trench in excess of 18" depth shall be included in quantity for payment. Lines of excavation shall be to neat lines of Rip Rap.

QUANTITIES

Item No. 13 Dry Excavation for Structures	240 Cu Yds
" " 13 Wet Excavation for Structures	371 " "
" " 13 Solid Rock Excavation for Structures	2.4 " "
" " 21 Class 'A' Concrete for Bridges	322.6 " "
" " 21 Class 'S' Concrete for Bridges	44.56 " "
" " 22 Reinforcing Steel for Bridges	1356.3 Lbs.
" " 23 Concrete Piling	1120 Lin Ft
" " 24 Concrete Railing for Bridges	4.40 " "
" " 25 Rip Rap	274 Cu Yds.
" " 26 Structural Steel	219,310 Lbs.
" " 5P Cast Steel and Cast Iron	4216 " "
" " 5P Bronze Expansion Devices	1544 " "
" " 5P Removal of Existing Structure	Lump Sum
" " 3P Bronze Project Marker Plates	2 Each
" " 5P Bronze State Bridge Name Plates	2 Each

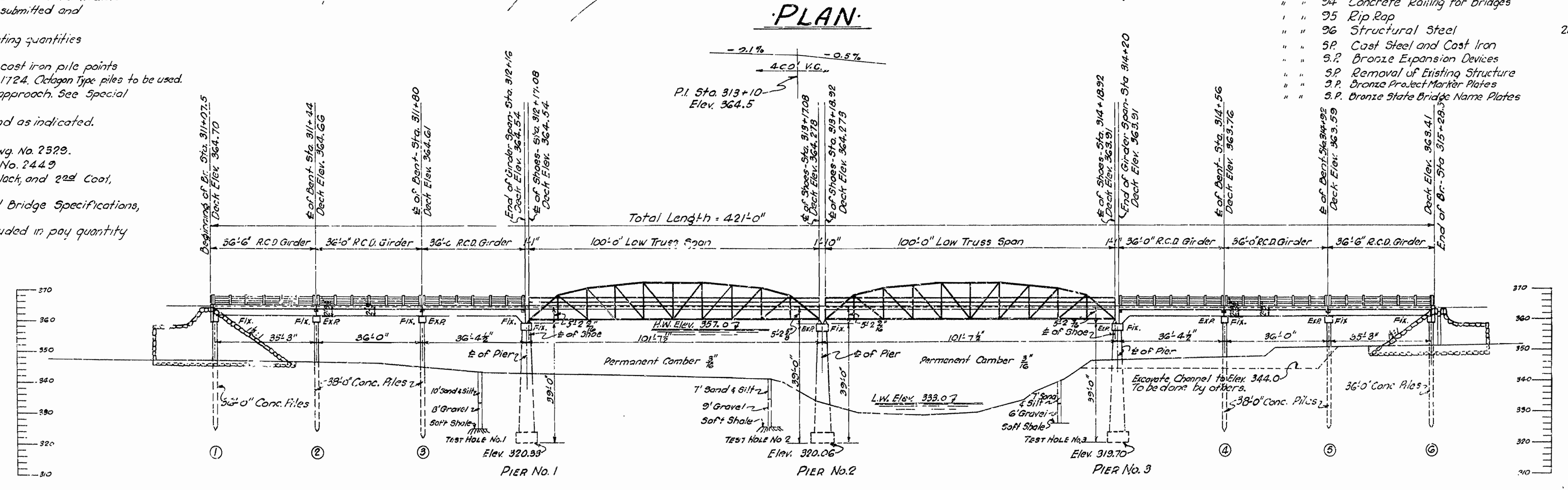

Maximum Design Pile Load = 28 Tons
 Maximum Bearing Pressure = 6000 Lbs. per sq. ft.

ELEVATION

DRAINAGE AREA
 150 Sq. Mi. Mountainous

B.M. Elev. 356.70
 N.E. Cor. of East Abutment of present bridge.

LAYOUT OF BRIDGE OVER HORSEHEAD CREEK
 HARTMAN-CLARKSVILLE ROAD
 JOHNSON COUNTY
 ROUTE 64 SEC. 4
 ARKANSAS STATE HIGHWAY DEPARTMENT
 LITTLE ROCK, ARK.

Drawn By: H.E.D. Date: 7-27-33
 Traced By: Date: 8-2-33
 Checked By: Date:
 Scale: 1/4" = 20 ft.

N.B. Lucas
 BRIDGE ENGINEER

BRIDGE NO. 1198 DRAWING NO. 3253

FED. ROAD DIST. NO.	N.R.	DATE	FISCAL YEAR	JOB NO.	SHEET NO.	TOTAL SHEETS
6	1	256-B	1934	3	7	1934
				8150	3	7

For Details of 36'-0" R.C.D. Girder Span, See Dwg. No. 2329
 For Details of 100'-0" Low Truss Span, See Dwg. No. 2449

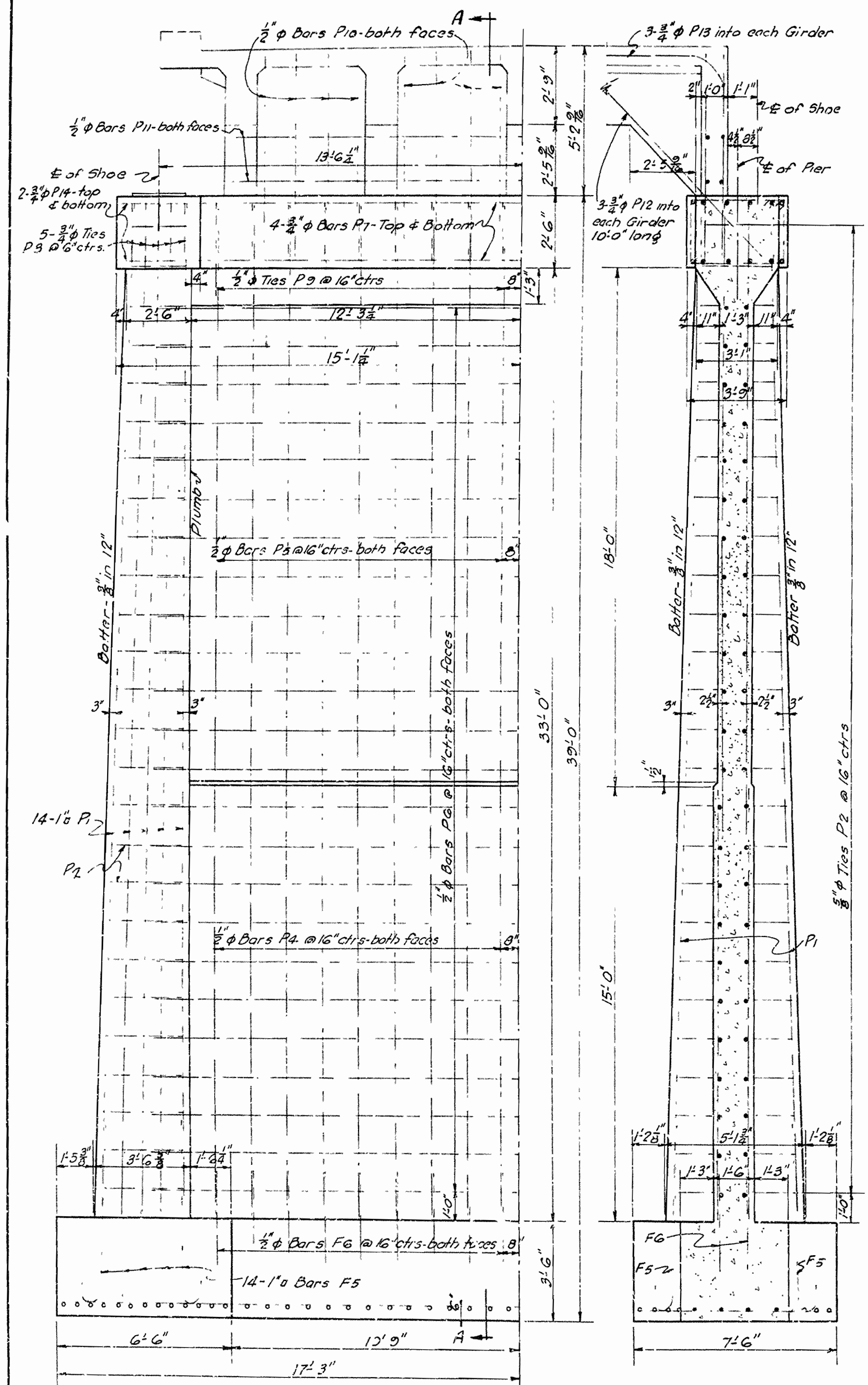

HALF ELEVATION-PIER NOS 1 & 3

SECTION A-A

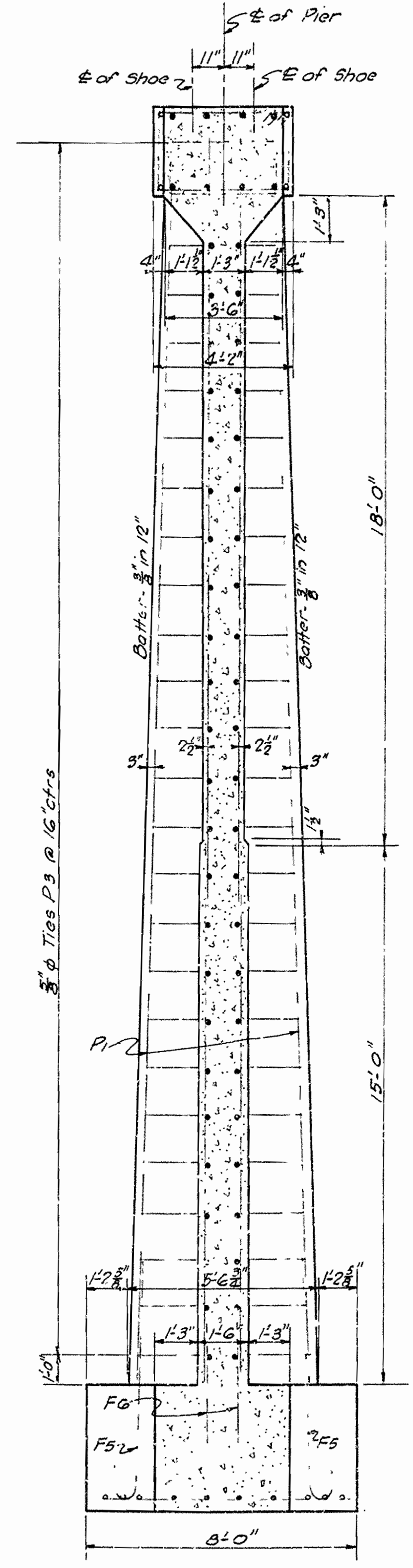

SECTION B-B

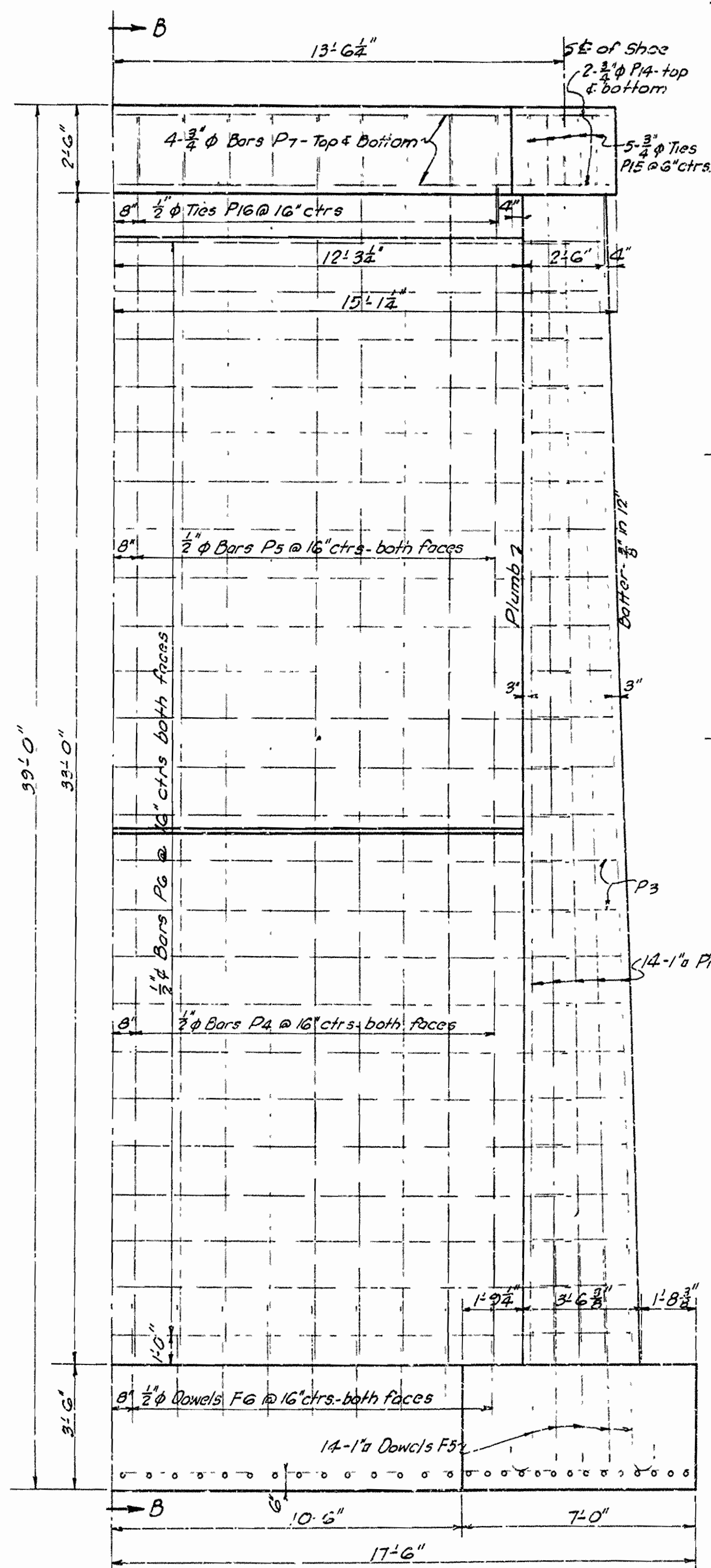

HALF ELEVATION-PIER NO. 2

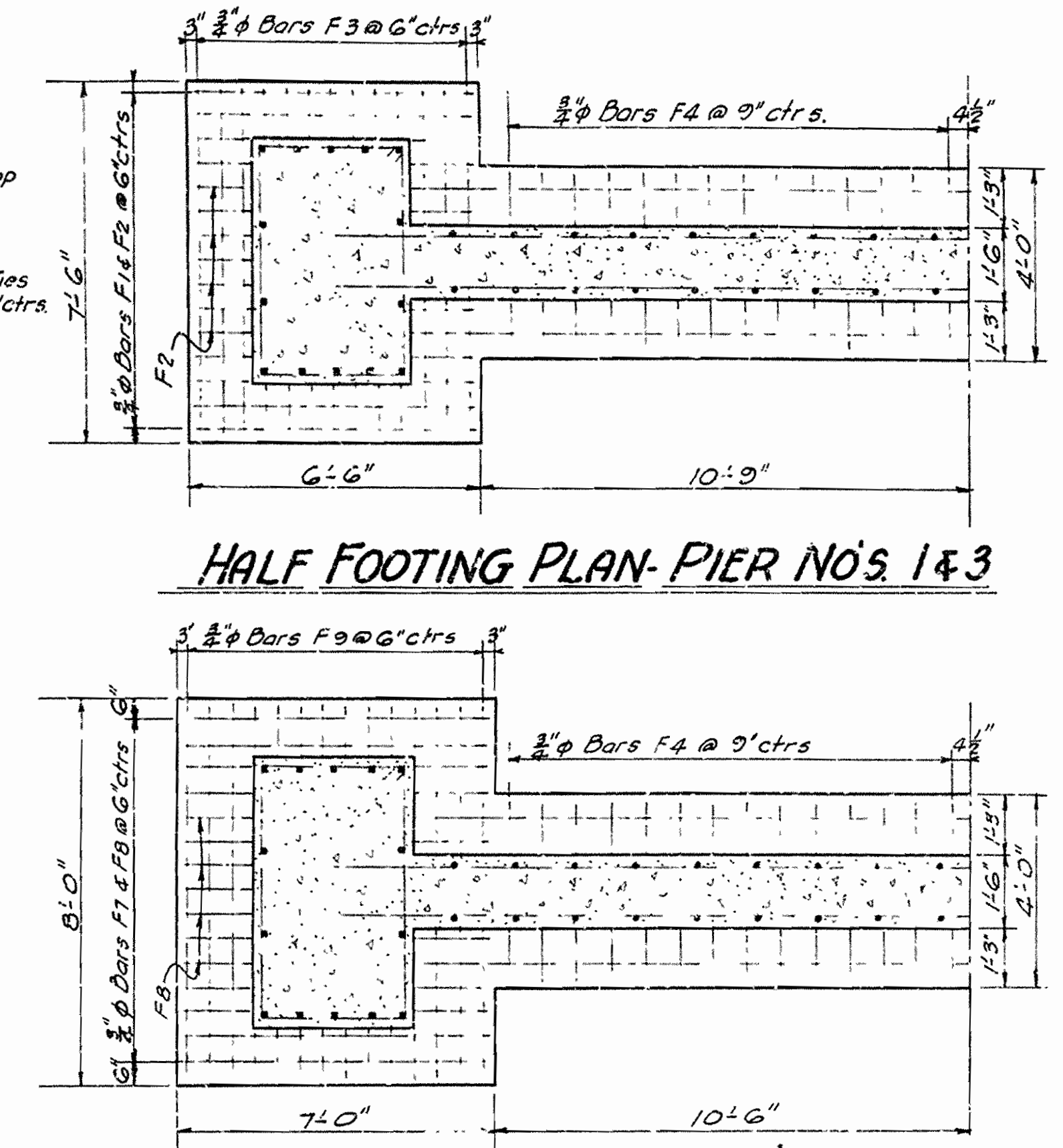

HALF FOOTING PLAN-PIER NOS. 1 & 3

HALF FOOTING PLAN-PIER NO. 2

Mark	Size	Length	Bending Diagram
F5	1"Ø	7'-4"	
P2	5/8"Ø	Varies Avg. 15'-3 1/2"	
P3	5/8"Ø	Varies Avg. 14'-1 1/2"	
P8	3/8"Ø	11'-11"	
P9	3/8"Ø	10'-7"	
P15	3/8"Ø	12'-9"	
P16	3/8"Ø	11'-5"	
P13	3/8"Ø	11'-0"	

DETAILS OF PIERS
FOR BRIDGE OVER HORSEHEAD CREEK
 HARTMAN-CLARKSVILLE ROAD
 JOHNSON COUNTY
 ROUTE 64 SEC. 4

ARKANSAS STATE HIGHWAY DEPARTMENT
 LITTLE ROCK, ARK.

Drawn By: H.F.B. Date: 7-29-33
 Traced By: Date: 8-1-33
 Checked By: Date: Scale: 3/8" = 1 ft.
 BRIDGE NO. DRAWING No. 3254

H.F.B.
 BRIDGE ENGINEER