

DATE REVISED	DATE FILMED	DATE REVISED	DATE FILMED	FED. RD. DIST. NO.	STATE	FED. AID PROJ. NO.	SHEET NO.	TOTAL SHEETS
				6	ARK.			
						070380	1	51
(2) HAYNES CREEK STR. & APPRS. (S)								

ARKANSAS DEPARTMENT OF TRANSPORTATION  
CONSTRUCTION PLANS FOR STATE HIGHWAY

# HAYNES CREEK STR. & APPRS. (S)

UNION COUNTY

ROUTE 335 SECTION 2

## JOB 070380

FED. AID PROJ. NHPP-0070(39)

NOT TO SCALE

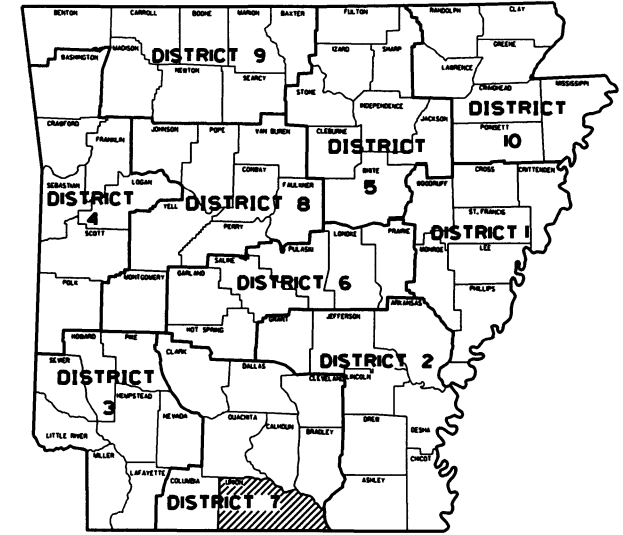

ARK. HWY. DIST. NO. 7

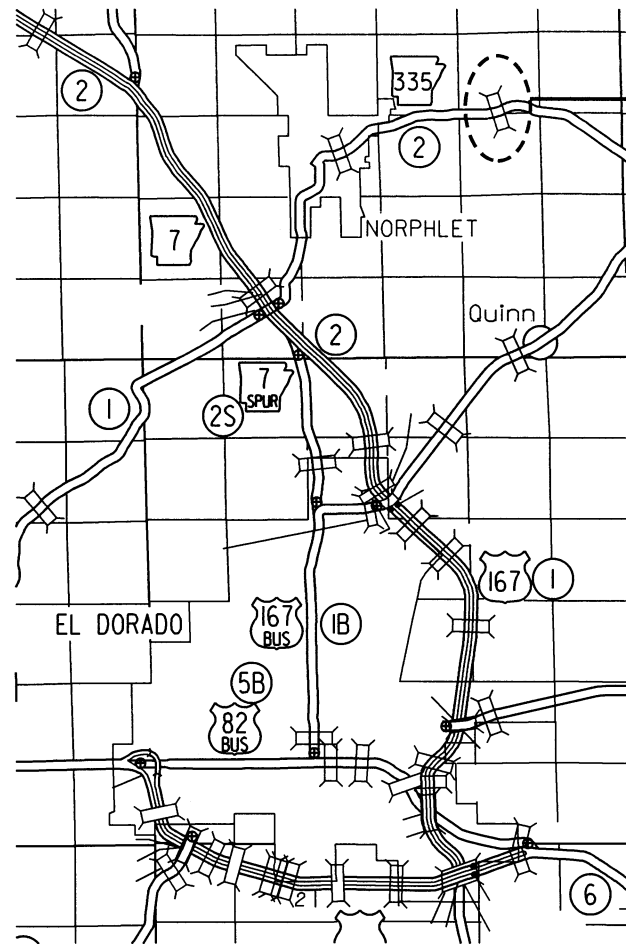

VICINITY MAP

PROJECT  
LOCATION

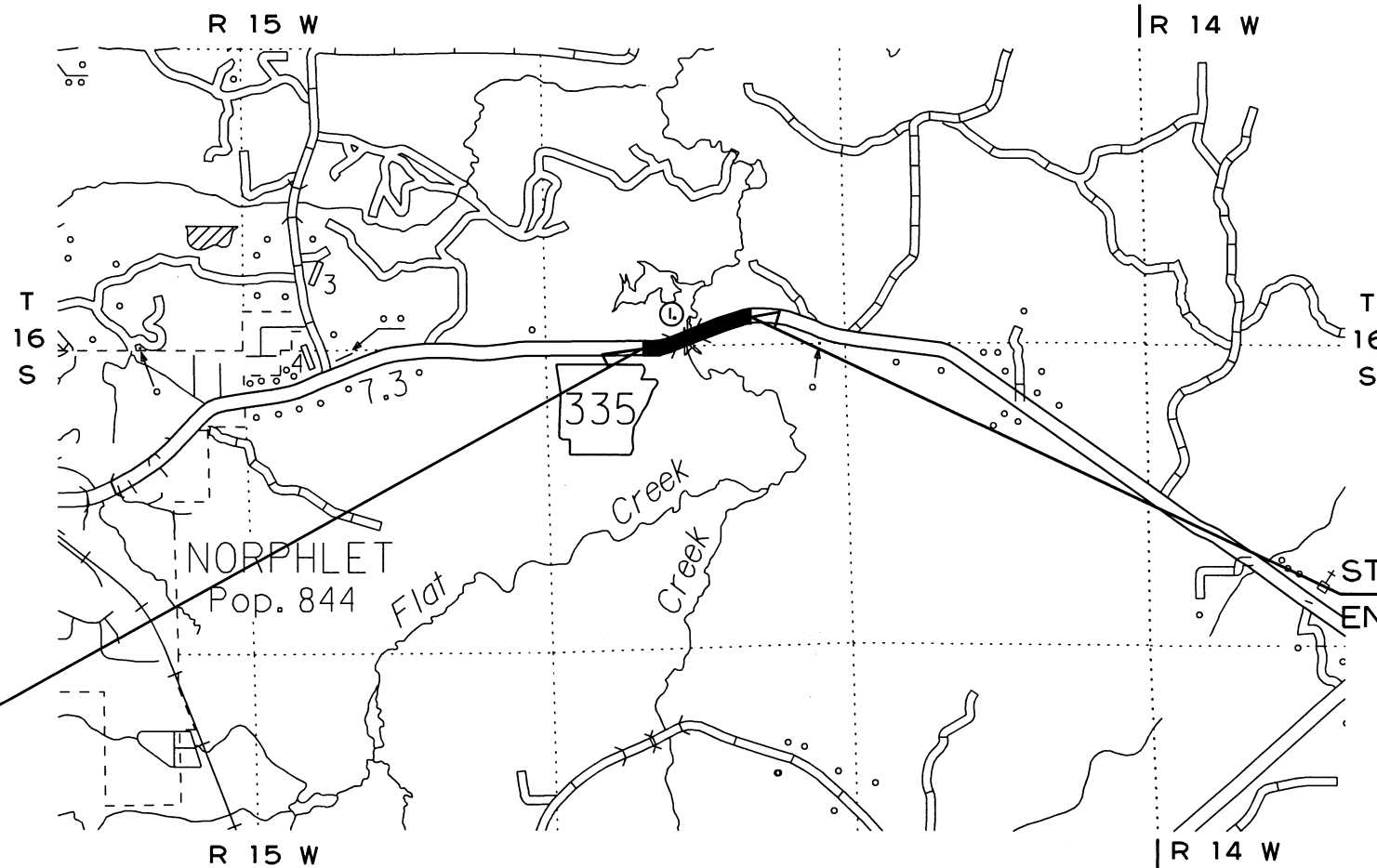

• DESIGN TRAFFIC DATA •

DESIGN YEAR	-----	2039
2019 ADT	-----	520
2039 ADT	-----	570
2039 DHV	-----	63
DIRECTIONAL DISTRIBUTION	-----	60%
TRUCKS	-----	5%
DESIGN SPEED	-----	55 MPH

**BRIDGE DATA**

- ① STA. 209+77.75 BR. END
- 260' -6" BRIDGE LENGTH
- 259' -6" COMP. INTEGRAL PRESTRESSED CONCRETE GIRDER UNIT (TYPE III)
- (64' -9", 65' -0", 65' -0", 64' -9")
- BR. NO. 07466
- 30' - 0" CLEAR ROADWAY
- STA. 212+38.25 BR. END

STA. 201+34.00  
BEGIN JOB 070380  
LOG MILE 4.33

STA. 219+12.00  
END JOB 070380

	BEGIN PROJECT	MID-POINT OF PROJECT	END PROJECT
LATITUDE	N 33°19' 23.05"	N 33°19' 24.31"	N 33°19' 27.35"
LONGITUDE	W 92°37' 34.02"	W 92°37' 22.57"	W 92°37' 14.10"

GROSS LENGTH OF PROJECT	1778.00	FEET OR	0.337	MILES
NET " " ROADWAY	1517.50	" "	0.288	"
NET " " BRIDGES	260.50	" "	0.049	"
NET " " PROJECT	1778.00	" "	0.337	"

APPROVED

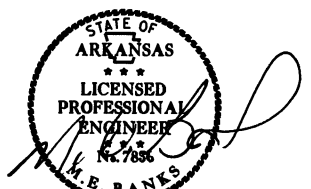

9-17-19  
DEPUTY DIRECTOR  
AND CHIEF ENGINEER

DATE REVISED	DATE FILMED	DATE REVISED	DATE FILMED	FED. DIST. NO.	STATE	FED. AID PROJ. NO.	SHEET NO.	TOTAL SHEETS
				6	ARK.			
						070380	2	51

### INDEX OF SHEETS

SHEET NO.	TITLE	BRIDGE NO.	DRWG. NO.
1	TITLE SHEET		
2	INDEX OF SHEETS AND STANDARD DRAWINGS		
3	GOVERNING SPECIFICATIONS AND GENERAL NOTES		
4	TYPICAL SECTIONS OF IMPROVEMENT		
5	SPECIAL DETAILS		
6 - 11	TEMPORARY EROSION CONTROL DETAILS		
12 - 15	MAINTENANCE OF TRAFFIC DETAILS		
16 - 17	PERMANENT PAVEMENT MARKING DETAILS		
18 - 21	QUANTITIES		
22	SCHEDULE OF BRIDGE QUANTITIES	07466	61107
23	SUMMARY OF QUANTITIES AND REVISIONS		
24 - 26	SURVEY CONTROL DETAILS		
27 - 28	PLAN AND PROFILE SHEETS		
29	LAYOUT OF BRIDGE HIGHWAY 335 OVER HAYNES CREEK (SHEET 1 OF 2)	07466	61108
30	LAYOUT OF BRIDGE HIGHWAY 335 OVER HAYNES CREEK (SHEET 2 OF 2)	07466	61109
31	DETAILS OF END BENTS	07466	61110
32	DETAILS OF INTERMEDIATE BENTS	07466	61111
33	DETAILS OF 259'-6" INTEGRAL PRESTRESSED CONCRETE GIRDER UNIT (SHEET 1 OF 8)	07466	61112
34	DETAILS OF 259'-6" INTEGRAL PRESTRESSED CONCRETE GIRDER UNIT (SHEET 2 OF 8)	07466	61113
35	DETAILS OF 259'-6" INTEGRAL PRESTRESSED CONCRETE GIRDER UNIT (SHEET 3 OF 8)	07466	61114
36	DETAILS OF 259'-6" INTEGRAL PRESTRESSED CONCRETE GIRDER UNIT (SHEET 4 OF 8)	07466	61115
37	DETAILS OF 259'-6" INTEGRAL PRESTRESSED CONCRETE GIRDER UNIT (SHEET 5 OF 8)	07466	61116
38	DETAILS OF 259'-6" INTEGRAL PRESTRESSED CONCRETE GIRDER UNIT (SHEET 6 OF 8)	07466	61117
39	DETAILS OF 259'-6" INTEGRAL PRESTRESSED CONCRETE GIRDER UNIT (SHEET 7 OF 8)	07466	61118
40	DETAILS OF 259'-6" INTEGRAL PRESTRESSED CONCRETE GIRDER UNIT (SHEET 8 OF 8)	07466	61119
41	DETAILS OF ELASTOMERIC BEARINGS	07466	61120
42	DETAILS OF TYPE SPECIAL APPROACH SLAB	07466	61121
43 - 51	CROSS SECTIONS		

2 INDEX OF SHEETS AND STANDARD DRAWINGS



### BRIDGE STANDARD DRAWINGS

DRWG. NO.	TITLE	DATE
55000	STANDARD DETAILS FOR EMBANKMENT CONSTRUCTION AND BACKFILL AT BRIDGE ENDS	02-27-14
55001	STANDARD DETAILS FOR DUMPED RIPRAP AND FILTER BLANKET AND COMPUTING EXCAVATION FOR STRUCTURES	02-27-14
55005	STANDARD DETAILS FOR PERMANENT STEEL BRIDGE DECK FORMS FOR STEEL & CONCRETE GIRDER SPANS	03-24-16
55010	STANDARD DETAILS FOR TYPE D BRIDGE NAME PLATE	01-15-19
55021	STANDARD DETAILS FOR CONCRETE FILLED STEEL SHELL PILES AND PILE ENCASEMENTS	03-24-16
55030C	STANDARD DETAILS FOR TYPE C APPROACH GUTTERS	02-27-14

### ROADWAY STANDARD DRAWINGS

DRWG. NO.	TITLE	DATE
GR-8	GUARD RAIL DETAILS	11-16-17
GR-8A	GUARD RAIL DETAILS	11-16-17
GR-9	GUARD RAIL DETAILS	04-17-08
GR-9A	GUARD RAIL DETAILS	04-17-08
GR-10	GUARD RAIL DETAILS	11-16-17
GR-11	GUARD RAIL DETAILS	11-16-17
GR-12	GUARD RAIL DETAILS	11-16-17
PCC-1	CONCRETE PIPE CULVERT FILL HEIGHTS & BEDDING	02-27-14
PCM-1	METAL PIPE CULVERT FILL HEIGHTS & BEDDING	02-27-14
PCP-1	PLASTIC PIPE CULVERT (HIGH DENSITY POLYETHYLENE)	02-27-14
PCP-2	PLASTIC PIPE CULVERT (PVC F949)	02-27-14
PM-1	PAVEMENT MARKING DETAILS	06-01-17
PU-1	DETAILS OF PIPE UNDERDRAIN	12-08-16
SE-2	TABLES AND METHOD OF SUPERELEVATION FOR TWO-WAY TRAFFIC	10-18-96
TC-1	STANDARD TRAFFIC CONTROLS FOR HIGHWAY CONSTRUCTION	04-13-17
TC-2	STANDARD TRAFFIC CONTROLS FOR HIGHWAY CONSTRUCTION	09-02-15
TC-3	STANDARD TRAFFIC CONTROLS FOR HIGHWAY CONSTRUCTION	07-25-19
TEC-1	TEMPORARY EROSION CONTROL DEVICES	11-16-17
TEC-2	TEMPORARY EROSION CONTROL DEVICES	06-02-94
TEC-3	TEMPORARY EROSION CONTROL DEVICES	11-03-94
WF-4	WIRE FENCE TYPE C AND D	08-22-02

9/12/2019

R070380.DGN

DATE REVISED	DATE FILMED	DATE REVISED	DATE FILMED	FED. RD. DIST. NO.	STATE	FED. AID PROJ. NO.	SHEET NO.	TOTAL SHEETS
				6	ARK.			
						JOB NO. 070380	3	51

2 GOVERNING SPECS. AND GENERAL NOTES

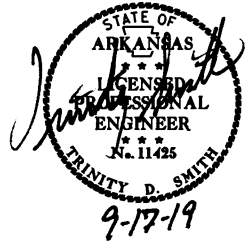

### GOVERNING SPECIFICATIONS

ARKANSAS STATE HIGHWAY COMMISSION STANDARD SPECIFICATIONS FOR HIGHWAY CONSTRUCTION, EDITION OF 2014, AND THE FOLLOWING SPECIAL PROVISIONS AND SUPPLEMENTAL SPECIFICATIONS:

NUMBER	TITLE
ERRATA	ERRATA FOR THE BOOK OF STANDARD SPECIFICATIONS
FHWA-1273	REQUIRED CONTRACT PROVISIONS FEDERAL-AID CONSTRUCTION CONTRACTS
FHWA-1273	SUPPLEMENT - EQUAL EMPLOYMENT OPPORTUNITY - NOTICE TO CONTRACTORS
FHWA-1273	SUPPLEMENT - SPECIFIC EQUAL EMPLOYMENT OPPORTUNITY RESPONSIBILITIES (23 U.S.C. 140)
FHWA-1273	SUPPLEMENT - EQUAL EMPLOYMENT OPPORTUNITY - GOALS AND TIMETABLES
FHWA-1273	SUPPLEMENT - EQUAL EMPLOYMENT OPPORTUNITY - FEDERAL STANDARDS
FHWA-1273	SUPPLEMENT - POSTERS AND NOTICES REQUIRED FOR FEDERAL-AID PROJECTS
FHWA-1273	SUPPLEMENT - WAGE RATE DETERMINATION
100-3	CONTRACTOR'S LICENSE
100-4	DEPARTMENT NAME CHANGE
102-2	ISSUANCE OF PROPOSALS
108-1	LIQUIDATED DAMAGES
108-2	WORK ALLOWED PRIOR TO ISSUANCE OF WORK ORDER
110-1	PROTECTION OF WATER QUALITY AND WETLANDS
303-1	AGGREGATE BASE COURSE
306-1	QUALITY CONTROL AND ACCEPTANCE
400-1	TACK COATS
400-4	DESIGN AND QUALITY CONTROL OF ASPHALT MIXTURES
400-5	PERCENT AIR VOIDS FOR ACHM MIX DESIGNS
400-6	LIQUID ANTI-STRIP ADDITIVE
410-1	CONSTRUCTION REQUIREMENTS AND ACCEPTANCE OF ASPHALT CONCRETE PLANT MIX COURSES
410-2	DEVICES FOR MEASURING DENSITY FOR ROLLING PATTERNS
600-2	INCIDENTAL CONSTRUCTION
604-1	RETROREFLECTIVE SHEETING FOR TRAFFIC CONTROL DEVICES IN CONSTRUCTION ZONES
606-1	PIPE CULVERTS FOR SIDE DRAINS
617-1	GUARDRAIL TERMINAL (TYPE 2)
620-1	MULCH COVER
800-1	STRUCTURES
802-3	CONCRETE FOR STRUCTURES
804-2	REINFORCING STEEL FOR STRUCTURES
808-1	INSTALLATION OF ELASTOMERIC BEARINGS
808-2	ELASTOMERIC BEARINGS
JOB 070380	BIDDING REQUIREMENTS AND CONDITIONS
JOB 070380	BROADBAND INTERNET SERVICE FOR ASPHALT CONCRETE PLANT
JOB 070380	BROADBAND INTERNET SERVICE FOR FIELD OFFICE
JOB 070380	CARGO PREFERENCE ACT REQUIREMENTS
JOB 070380	CLASS C FLY ASH IN PORTLAND CEMENT CONCRETE PAVEMENT AND CLASS S(AE) CONCRETE
JOB 070380	CONSTRUCTION IN SPECIAL FLOOD HAZARD AREAS
JOB 070380	DELAY IN RIGHT OF WAY OCCUPANCY
JOB 070380	DIRECT TENSION INDICATORS FOR HIGH STRENGTH BOLT ASSEMBLIES
JOB 070380	DISADVANTAGED BUSINESS ENTERPRISE BIDDER'S RESPONSIBILITIES
JOB 070380	FLEXIBLE BEGINNING OF WORK
JOB 070380	GOALS FOR DISADVANTAGED BUSINESS ENTERPRISE PARTICIPATION
JOB 070380	MANDATORY ELECTRONIC CONTRACT
JOB 070380	MANDATORY ELECTRONIC DOCUMENT SUBMITTAL
JOB 070380	NESTING SITES OF MIGRATORY BIRDS
JOB 070380	PARTNERING REQUIREMENTS
JOB 070380	PLASTIC PIPE
JOB 070380	SECTION 404 NATIONWIDE 23 PERMIT REQUIREMENTS
JOB 070380	SHORING
JOB 070380	SOIL STABILIZATION
JOB 070380	STORM WATER POLLUTION PREVENTION PLAN
JOB 070380	SUBMISSION OF ASPHALT CONCRETE HOT MIX ACCEPTANCE TEST RESULTS
JOB 070380	UTILITY ADJUSTMENTS
JOB 070380	VALUE ENGINEERING
JOB 070380	WARM MIX ASPHALT
JOB 070380	WELLHEAD PROTECTION

### GENERAL NOTES

- GRADE LINE DENOTES FINISHED GRADE WHERE SHOWN ON PLANS.
- ALL PIPE LINES, POWER, TELEPHONE, AND TELEGRAPH LINES TO BE MOVED OR LOWERED BY THE RESPECTIVE OWNERS AS PER AGREEMENT WITH SUCH OWNERS.
- ANY EQUIPMENT OR APPURTENANCE THAT INTERFERES WITH THE PROPOSED CONSTRUCTION AND WHICH MAY BE THE PROPERTY OF UTILITY SERVICE ORGANIZATIONS SHALL BE MOVED BY THE OWNERS UNLESS OTHERWISE PROVIDED.
- THE CONTRACTOR SHALL BE RESPONSIBLE FOR MAINTAINING U. S. MAILBOXES WITHIN THE PROJECT LIMITS IN SUCH A MANNER THAT THE PUBLIC MAY RECEIVE CONTINUED MAIL SERVICE. PAYMENT WILL BE CONSIDERED INCLUDED IN THE PRICE BID FOR THE VARIOUS BID ITEMS.
- ALL LAND MONUMENTS LOCATED WITHIN THE CONSTRUCTION AREA SHALL BE PROTECTED IN ACCORDANCE WITH SECTION 107.12 OF THE STANDARD SPECIFICATIONS.
- ALL TREES THAT DO NOT DIRECTLY INTERFERE WITH THE PROPOSED CONSTRUCTION SHALL BE SPARED AS DIRECTED BY THE ENGINEER. CARE AND DISCRETION SHALL BE USED TO ENSURE THAT ALL TREES NOT TO BE REMOVED SHALL BE HARMED AS LITTLE AS POSSIBLE DURING THE CONSTRUCTION OPERATIONS.
- THE CONTRACTOR SHALL BE RESPONSIBLE FOR PROVIDING A FENCE TO CONTROL LIVESTOCK IN AREAS WHERE PASTURES ARE SEVERED. WIRE FENCE MAY BE CONSTRUCTED INITIALLY, OR IN LIEU THEREOF, THE CONTRACTOR AT HIS OWN EXPENSE, MAY ELECT TO PROVIDE TEMPORARY FENCING SUITABLE TO CONTAIN LIVESTOCK.
- THE SEQUENCE AS SHOWN ON THE MAINTENANCE OF TRAFFIC PLANS IS A GENERAL OUTLINE FOR THE CONSTRUCTION OF THIS PROJECT, AND IN NO WAY IS IT INTENDED TO COVER EVERY ITEM IN THE PROJECT. ITEMS NOT CRITICAL TO THE CONSTRUCTION SEQUENCE MAY BE CONSTRUCTED IN ANY STAGE AS APPROVED BY THE RESIDENT ENGINEER.
- ALL FLEXIBLE BASE AND ASPHALTIC PAVEMENTS REMOVED SHALL BE PAID FOR UNDER THE ITEM NO. 210 - UNCLASSIFIED EXCAVATION.
- THE EXISTING ASPHALT PAVEMENT TO BE REMOVED FROM THE REMAINING PAVEMENT SHALL BE SEPARATED BY SAWING ALONG A NEAT LINE. AFTER SAWING, THE PAVEMENT TO BE REMOVED SHALL BE CAREFULLY REMOVED IN A MANNER THAT WILL NOT DAMAGE THE PAVEMENT THAT IS TO REMAIN. ANY DAMAGE OF THE ASPHALT PAVEMENT THAT IS TO REMAIN IN PLACE SHALL BE REPAIRED AT THE CONTRACTOR'S EXPENSE.

9/12/2019

R070380.DGN

DATE REVISED	DATE FILMED	DATE REVISED	DATE FILMED	FED. RD. DIST. NO.	STATE	FED. AID PROJ. NO.	SHEET NO.	TOTAL SHEETS
				6	ARK.			
				JOB NO.	070380		4	51

2 TYPICAL SECTIONS OF IMPROVEMENT

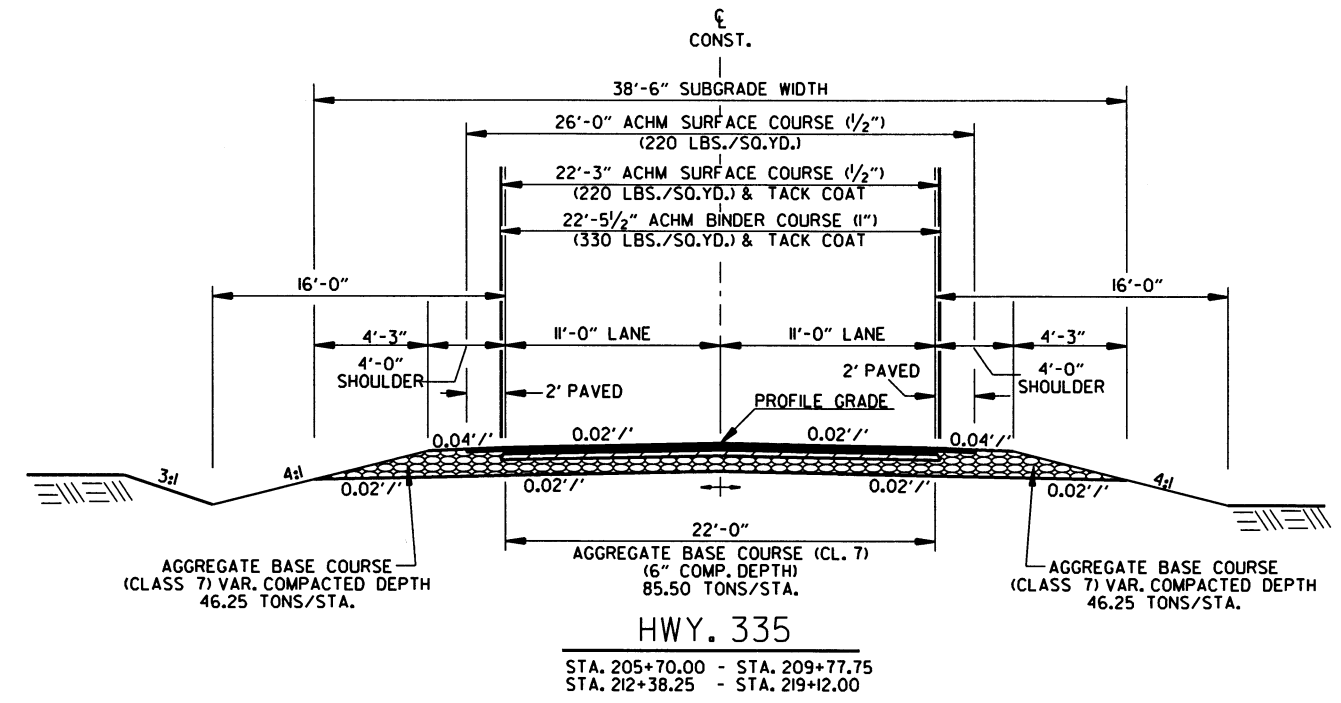
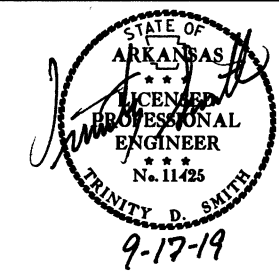

ON ALL SUPERELEVATED CURVES AND THRU SUPERELEVATION TRANSITIONS THE ALGEBRAIC DIFFERENCE BETWEEN PAVEMENT SLOPE AND SHOULDER SLOPE SHALL NOT EXCEED 0.08 '/'.

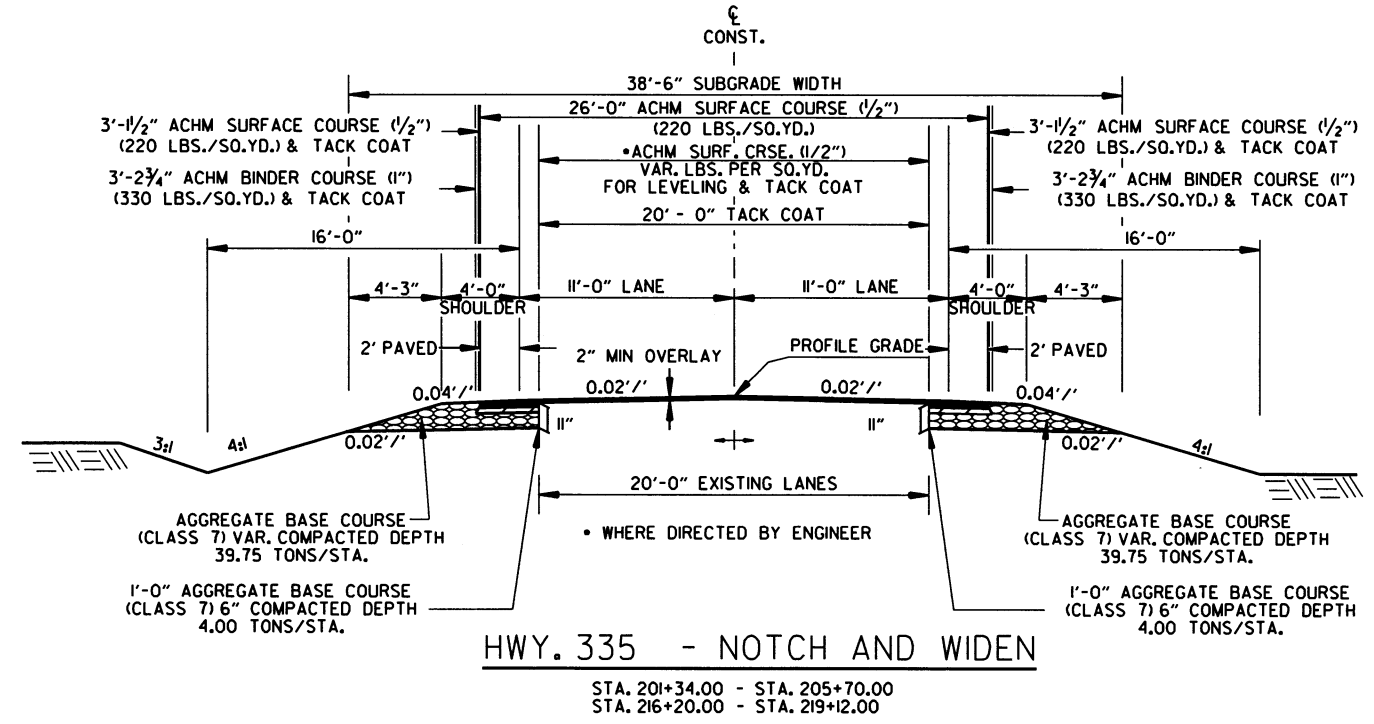
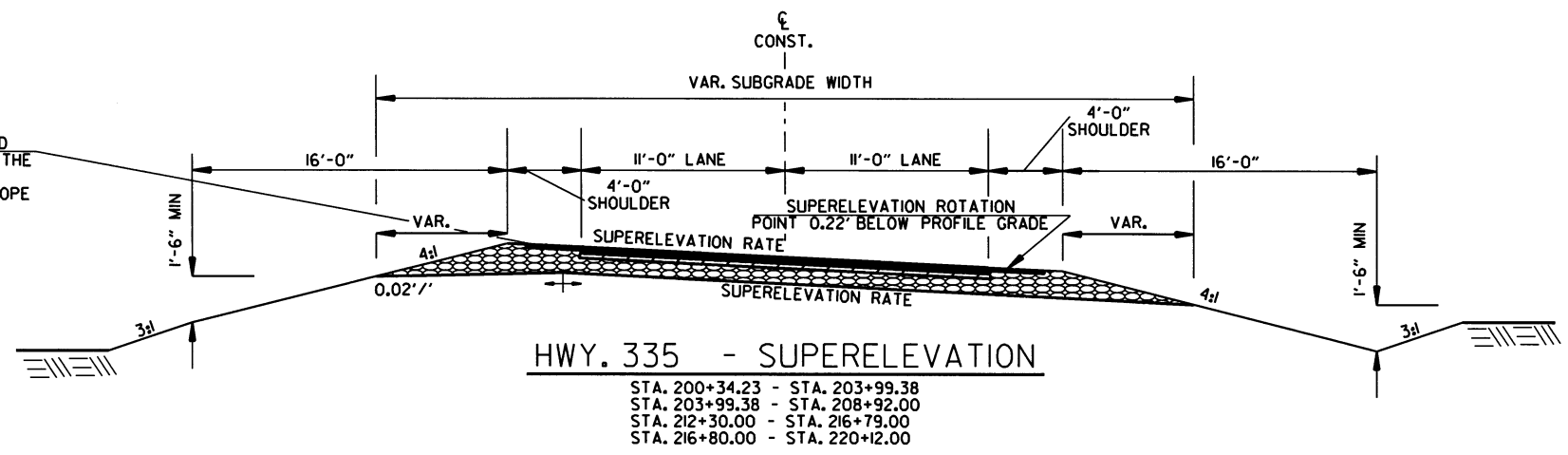

NOTES:  
REFER TO CROSS SECTIONS FOR DEVIATION FROM THE NORMAL SLOPES. NO CHANGES SHALL BE MADE FROM THE PLANNED SLOPES WITHOUT THE APPROVAL OF THE ENGINEER.

THE THICKNESS OF AGGREGATE BASE COURSE SHALL BE WITHIN PLUS OR MINUS ONE INCH OF THE PLAN THICKNESS SHOWN. THE CONTRACTOR WILL CORRECT ANY DEFICIENT THICKNESS THAT DOES NOT MEET TOLERANCE INDICATED. PAYMENT WILL NOT BE MADE FOR MATERIAL PLACED IN EXCESS OF THE TOLERANCE INDICATED.

THE EXISTING ASPHALT PAVEMENT TO BE REMOVED FROM THE REMAINING PAVEMENT SHALL BE SEPARATED BY SAWING ALONG A NEAT LINE. AFTER SAWING, THE PAVEMENT TO BE REMOVED SHALL BE CAREFULLY REMOVED IN A MANNER THAT WILL NOT DAMAGE THE PAVEMENT THAT IS TO REMAIN. ANY DAMAGE OF THE ASPHALT PAVEMENT THAT IS TO REMAIN IN PLACE SHALL BE REPAIRED AT THE CONTRACTOR'S EXPENSE.

ASPHALT FOR LEVELING OF EXISTING PAVEMENT SHALL BE PLACED ONLY IF AND WHERE DIRECTED BY THE ENGINEER. CALCULATIONS FOR THE AMOUNT OF LEVELING AND/OR LEVELING OPERATIONS SHALL BE PERFORMED BEFORE CONSTRUCTION NOTCH AND WIDENING. CALCULATIONS WILL NOT BE PAID FOR DIRECTLY, BUT PAYMENT WILL BE CONSIDERED INCLUDED IN THE VARIOUS PAY ITEMS.

THE FINAL 2" OF SURFACE COURSE IS TO BE PLACED AFTER ALL OTHER COURSES HAVE BEEN LAID. LONGITUDINAL JOINTS SHALL BE AT LANE LINES.

9/12/2019 R070380.DGN

DATE REVISED	DATE FILMED	DATE REVISED	DATE FILMED	FED. RD. DIST. NO.	STATE	FED. RD. PROJ. NO.	SHEET NO.	TOTAL SHEETS
				6	ARK.			
				JOB NO.	070380		5	51

2 SPECIAL DETAILS

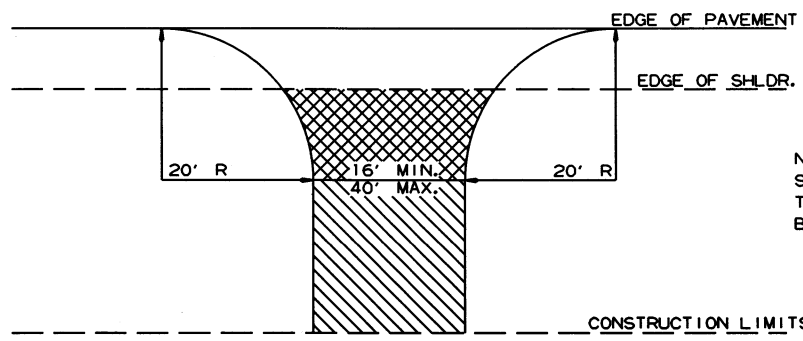
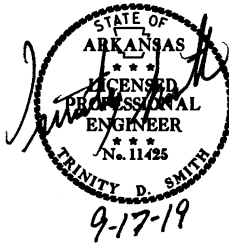

NOTE: TURNOUTS AND PRIVATE DRIVES SHALL BE MODIFIED WHERE NECESSARY TO MEET LOCAL CONDITIONS AS DIRECTED BY THE ENGINEER.

- ASPHALT CONCRETE HOT MIX SURFACE COURSE (220 LBS. PER SQ. YD.)  
AGGREGATE BASE COURSE (CLASS 7)  
7" COMP. DEPTH IF ASPHALT DRIVE EXIST OR  
6" CONCRETE IF CONCRETE DRIVE EXIST.
- AGGREGATE BASE COURSE (CLASS 7)  
9" COMP. DEPTH OR CONFORM  
TO EXISTING DRIVEWAY

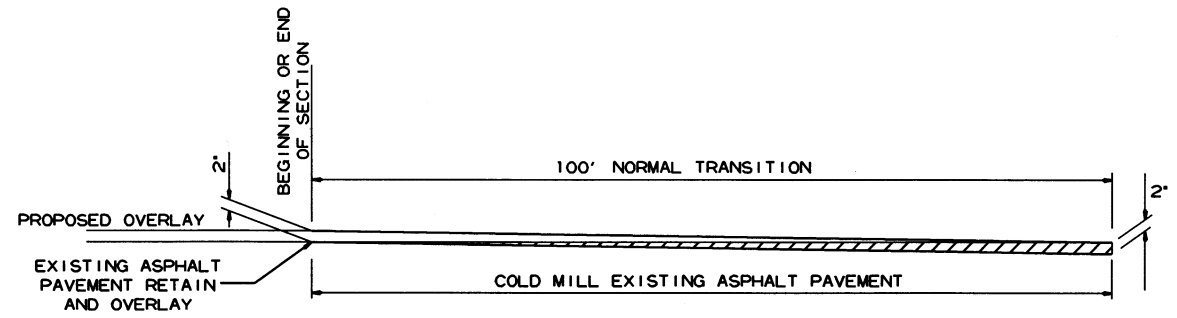

DETAIL FOR TRANSITIONS

DETAIL FOR DRIVEWAY TURNOUTS (COLLECTORS)

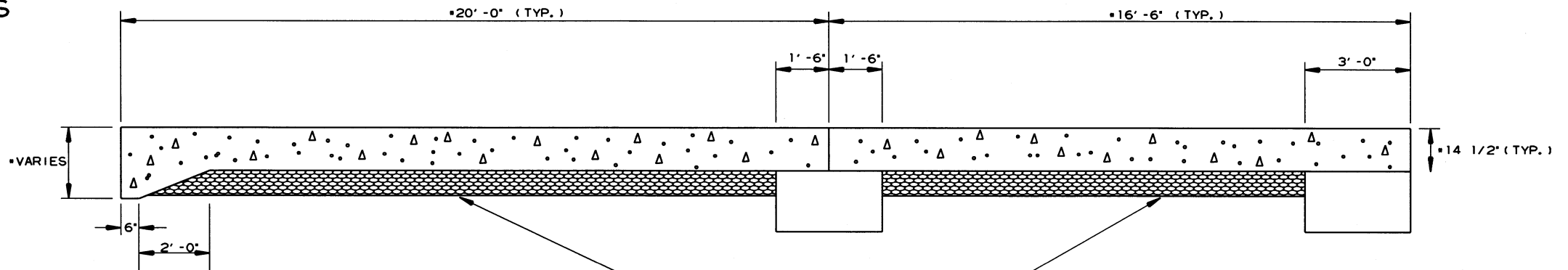

AGGREGATE BASE COURSE (CLASS 7)  
VARIABLE - 6" MIN. COMPACTED DEPTH  
• SEE APPROACH SLAB DETAILS IN BRIDGE DRAWINGS

SECTION OF APPROACH SLAB

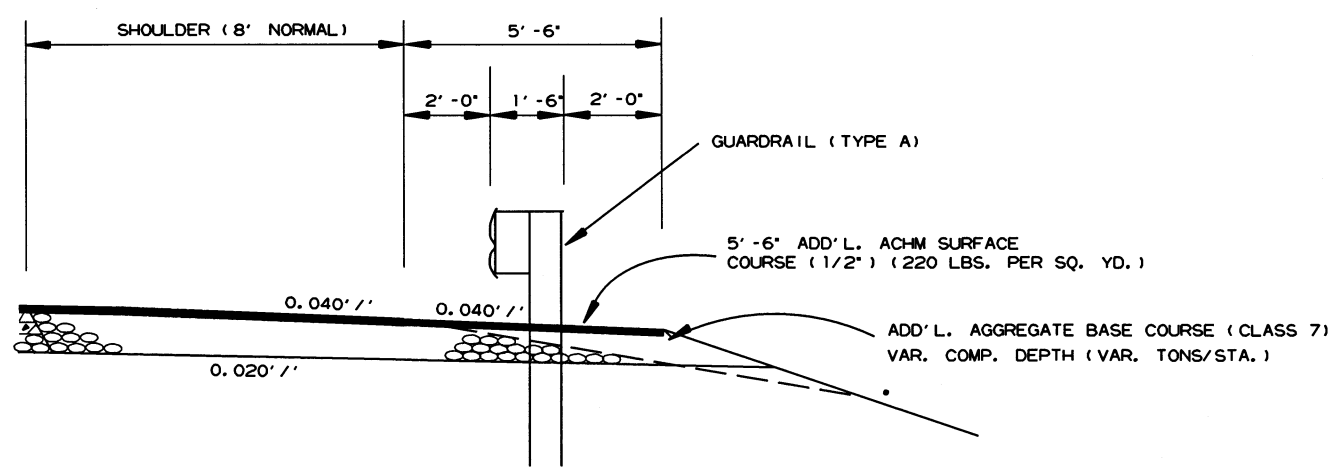

NOTE: REFER TO STD. DWG. GR-9A AND CROSS SECTIONS FOR SLOPE REQUIREMENTS BEHIND GUARDRAIL.

WIDENING FOR GUARDRAIL

9/12/2019 R070380.DGN