

ARKANSAS DEPARTMENT OF TRANSPORTATION  
CONSTRUCTION PLANS FOR STATE HIGHWAY

DATE REVISED	DATE FILMED	DATE REVISED	DATE FILMED	FED. RD. DIST. NO.	STATE	FED. AID PROJ. NO.	SHEET NO.	TOTAL SHEETS
				6	ARK.			
							JOB NO.	100842
								1
								30

② LITTLE CACHE RIVER DITCH STR. & APPRS. (S)

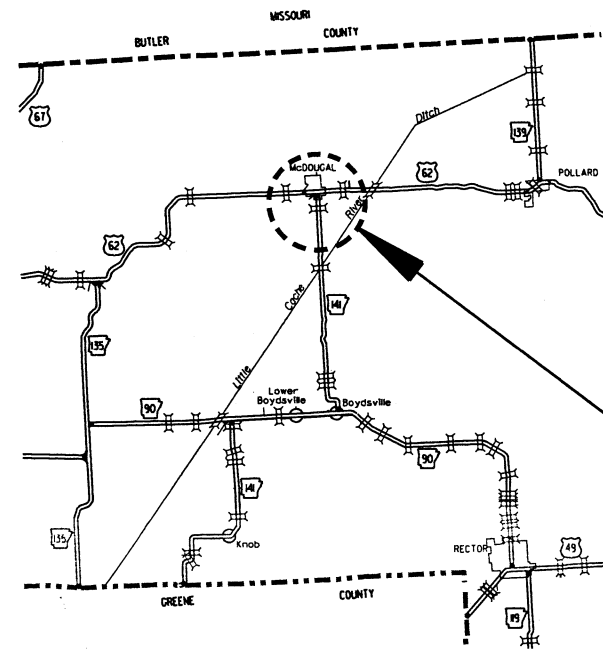

VICINITY MAP

LITTLE CACHE RIVER  
DITCH STR. & APPRS. (S)

CLAY COUNTY  
ROUTE 141 SECTION 6

JOB 100842

F.A.P. NHPP-0011(44)

NOT TO SCALE

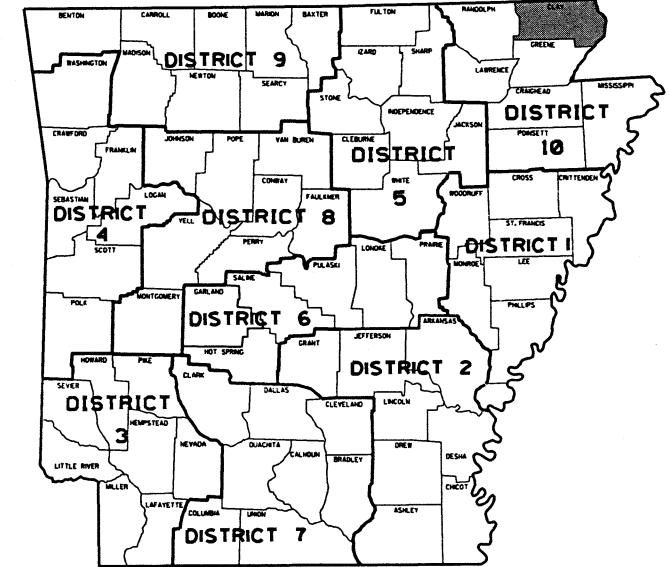

ARKANSAS HWY. DIST. 10

• DESIGN TRAFFIC DATA •

DESIGN YEAR	2039
2019 ADT	340
2039 ADT	440
2039 DHV	48
DIRECTIONAL DISTRIBUTION	0.60
TRUCKS	5%
DESIGN SPEED	55 MPH

BRIDGE DATA

- ① STA. 105+33.00 BRIDGE END  
BRIDGE NO. 07439  
31'-6" CLEAR ROADWAY  
124'-0" BRIDGE LENGTH  
124'-0" PRECAST CONCRETE SPANS (31'-31'-31'-31')  
STA. 106+57.00 BRIDGE END

STA. 100+00.00  
BEGIN JOB 100842  
LOG MILE 6.55

STA. 113+00.00  
END JOB 100842

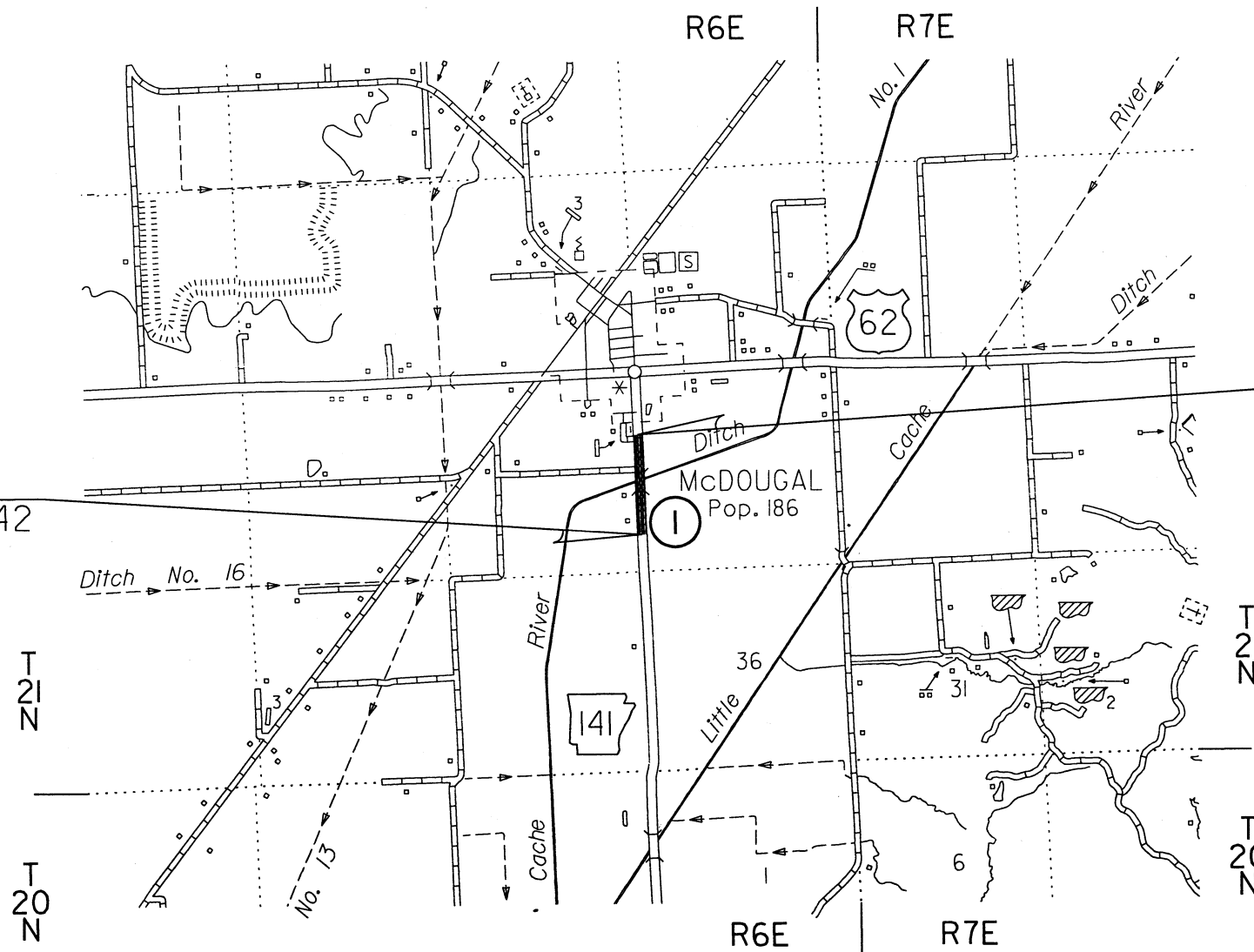

APPROVED



5-17-19  
DEPUTY DIRECTOR  
AND CHIEF ENGINEER

	BEGIN PROJECT	MID-POINT OF PROJECT	END PROJECT
LATITUDE	N36°25'31"	N36°25'37"	N36°25'44"
LONGITUDE	W90°23'21"	W90°23'21"	W90°23'21"

PROJECT LENGTH CALCULATED ALONG C.L. CONSTRUCTION  
GROSS LENGTH OF PROJECT 1300.00 FEET OR 0.246 MILES  
NET LENGTH OF ROADWAY 1176.00 FEET OR 0.223 MILES  
NET LENGTH OF BRIDGES 124.00 FEET OR 0.023 MILES  
NET LENGTH OF PROJECT 1300.00 FEET OR 0.246 MILES

DATE REVISED	DATE FILED	DATE REVISED	DATE FILED	FED. RD. DIST. NO.	STATE	FED. AID PROJ. NO.	SHEET NO.	TOTAL SHEETS
				6	ARK.			
						JOB NO.	100842	2
								30

② INDEX OF SHEETS & STANDARD DRAWINGS

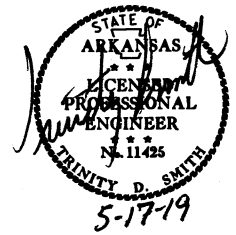

**INDEX OF SHEETS**

SHEET NO.	TITLE	BRIDGE NO.	DRWG. NO.
1	TITLE SHEET		
2	INDEX OF SHEETS AND STANDARD DRAWINGS		
3	GOVERNING SPECIFICATIONS AND GENERAL NOTES		
4	TYPICAL SECTIONS OF IMPROVEMENT		
5	SPECIAL DETAILS		
6 - 7	TEMPORARY EROSION CONTROL DETAILS		
8 - 9	MAINTENANCE OF TRAFFIC DETAILS		
10	PERMANENT PAVEMENT MARKING DETAILS		
11 - 13	QUANTITIES		
14	SCHEDULE OF BRIDGE QUANTITIES	07439	60484
15	SUMMARY OF QUANTITIES AND REVISIONS		
16 - 17	SURVEY CONTROL DETAILS		
18	PLAN AND PROFILE SHEETS		
19	SHEET 1 OF 2 LAYOUT OF BRIDGE HIGHWAY 141 OVER LITTLE CACHE RIVER DITCH	07439	60485
20	SHEET 2 OF 2 LAYOUT OF BRIDGE HIGHWAY 141 OVER LITTLE CACHE RIVER DITCH	07439	60486
21	DETAILS OF END BENTS	07439	60487
22	DETAILS OF INTERMEDIATE BENTS	07439	60488
23	DETAILS FOR 31'-0" PRECAST CONCRETE SPANS 31'-6" CLEAR ROADWAY	07439	60489
24	DETAILS FOR PRECAST PARAPET RAILS 31'-6" PRECAST END SPANS	07439	60490
25 - 30	CROSS SECTIONS		

**BRIDGE STANDARD DRAWINGS**

DRWG. NO.	TITLE	DATE
55000	STANDARD DETAILS FOR EMBANKMENT CONSTRUCTION AND BACKFILL AT BRIDGE ENDS	02-27-14
55001	STANDARD DETAILS FOR DUMPED RIPRAP AND FILTER BLANKET AND COMPUTING EXCAVATION FOR STRUCTURES	02-27-14
55010	STANDARD DETAILS FOR TYPE D BRIDGE NAME PLATE	01-15-19
55021	STANDARD DETAILS FOR CONCRETE FILLED STEEL SHELL PILES AND PILE ENCASEMENTS	03-24-16
55030D	STANDARD DETAILS FOR TYPE D APPROACH GUTTERS	02-27-14
55040D	STANDARD DETAILS FOR TYPE D APPROACH SLAB	02-27-14

**ROADWAY STANDARD DRAWINGS**

DRWG. NO.	TITLE	DATE
GR-7	GUARD RAIL DETAILS (TYPE C) STREET/ROAD BARRICADE OR TEMPORARY INSTALLATION	11-16-17
GR-8	GUARD RAIL DETAILS	11-16-17
GR-8A	GUARD RAIL DETAILS	11-16-17
GR-9	GUARD RAIL DETAILS	04-17-08
GR-9A	GUARD RAIL DETAILS	04-17-08
GR-10	GUARD RAIL DETAILS	11-16-17
GR-11	GUARD RAIL DETAILS	11-16-17
GR-12	GUARD RAIL DETAILS	11-16-17
MB-1	MAILBOX DETAILS	11-18-04
PCC-1	CONCRETE PIPE CULVERT FILL HEIGHTS & BEDDING	02-27-14
PCM-1	METAL PIPE CULVERT FILL HEIGHTS & BEDDING	02-27-14
PCP-1	PLASTIC PIPE CULVERT (HIGH DENSITY POLYETHYLENE)	02-27-14
PCP-2	PLASTIC PIPE CULVERT (PVC F949)	02-27-14
PM-1	PAVEMENT MARKING DETAILS	06-01-17
PU-1	DETAILS OF PIPE UNDERDRAIN	12-08-16
TC-1	STANDARD TRAFFIC CONTROLS FOR HIGHWAY CONSTRUCTION	04-13-17
TC-2	STANDARD TRAFFIC CONTROLS FOR HIGHWAY CONSTRUCTION	09-02-15
TC-3	STANDARD TRAFFIC CONTROLS FOR HIGHWAY CONSTRUCTION	09-02-15
TEC-1	TEMPORARY EROSION CONTROL DEVICES	11-16-17
TEC-2	TEMPORARY EROSION CONTROL DEVICES	06-02-94
TEC-3	TEMPORARY EROSION CONTROL DEVICES	11-03-94

5/16/2019

RI00842.DGN

DATE REVISED	DATE FILED	DATE REVISED	DATE FILED	FED. RD. DIST. NO.	STATE	FED. AID PROJ. NO.	SHEET NO.	TOTAL SHEETS
				6	ARK.			
						JOB NO. 100842	3	30

2 GOVERNING SPECS. & GENERAL NOTES

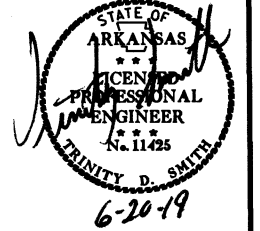

### GOVERNING SPECIFICATIONS

ARKANSAS STATE HIGHWAY COMMISSION STANDARD SPECIFICATIONS FOR HIGHWAY CONSTRUCTION, EDITION OF 2014, AND THE FOLLOWING SPECIAL PROVISIONS AND SUPPLEMENTAL SPECIFICATIONS:

NUMBER	TITLE
ERRATA	ERRATA FOR THE BOOK OF STANDARD SPECIFICATIONS
FHWA-1273	REQUIRED CONTRACT PROVISIONS FEDERAL-AID CONSTRUCTION CONTRACTS
FHWA-1273	SUPPLEMENT - EQUAL EMPLOYMENT OPPORTUNITY - NOTICE TO CONTRACTORS
FHWA-1273	SUPPLEMENT - SPECIFIC EQUAL EMPLOYMENT OPPORTUNITY RESPONSIBILITIES (23 U.S.C. 140)
FHWA-1273	SUPPLEMENT - EQUAL EMPLOYMENT OPPORTUNITY - GOALS AND TIMETABLES
FHWA-1273	SUPPLEMENT - EQUAL EMPLOYMENT OPPORTUNITY - FEDERAL STANDARDS
FHWA-1273	SUPPLEMENT - POSTERS AND NOTICES REQUIRED FOR FEDERAL-AID PROJECTS
FHWA-1273	SUPPLEMENT - WAGE RATE DETERMINATION
100-3	CONTRACTOR'S LICENSE
100-4	DEPARTMENT NAME CHANGE
102-2	ISSUANCE OF PROPOSALS
108-1	LIQUIDATED DAMAGES
108-2	WORK ALLOWED PRIOR TO ISSUANCE OF WORK ORDER
110-1	PROTECTION OF WATER QUALITY AND WETLANDS
303-1	AGGREGATE BASE COURSE
306-1	QUALITY CONTROL AND ACCEPTANCE
400-1	TACK COATS
400-4	DESIGN AND QUALITY CONTROL OF ASPHALT MIXTURES
400-5	PERCENT AIR VOIDS FOR ACHM MIX DESIGNS
400-6	LIQUID ANTI-STRIP ADDITIVE
410-1	CONSTRUCTION REQUIREMENTS AND ACCEPTANCE OF ASPHALT CONCRETE PLANT MIX COURSES
410-2	DEVICES FOR MEASURING DENSITY FOR ROLLING PATTERNS
600-2	INCIDENTAL CONSTRUCTION
604-1	RETROREFLECTIVE SHEETING FOR TRAFFIC CONTROL DEVICES IN CONSTRUCTION ZONES
606-1	PIPE CULVERTS FOR SIDE DRAINS
617-1	GUARDRAIL TERMINAL (TYPE 2)
620-1	MULCH COVER
800-1	STRUCTURES
802-3	CONCRETE FOR STRUCTURES
804-2	REINFORCING STEEL FOR STRUCTURES
JOB 100842	BIDDING REQUIREMENTS AND CONDITIONS
JOB 100842	BROADBAND INTERNET SERVICE FOR ASPHALT CONCRETE PLANT
JOB 100842	BROADBAND INTERNET SERVICE FOR FIELD OFFICE
JOB 100842	CARGO PREFERENCE ACT REQUIREMENTS
JOB 100842	DISADVANTAGED BUSINESS ENTERPRISE BIDDER'S RESPONSIBILITIES
JOB 100842	FLEXIBLE BEGINNING OF WORK - CALENDAR DAY CONTRACT
JOB 100842	GOALS FOR DISADVANTAGED BUSINESS ENTERPRISE PARTICIPATION
JOB 100842	MANDATORY ELECTRONIC CONTRACT
JOB 100842	MANDATORY ELECTRONIC DOCUMENT SUBMITTAL
JOB 100842	NESTING SITES OF MIGRATORY BIRDS
JOB 100842	OFF-SITE RESTRAINING CONDITIONS FOR INDIANA BATS
JOB 100842	PLASTIC PIPE
JOB 100842	PRICE ADJUSTMENT FOR ASPHALT BINDER
JOB 100842	PROSECUTION AND PROGRESS WITH BID SCHEDULE
JOB 100842	SECTION 404 NATIONWIDE 14 PERMIT REQUIREMENTS
JOB 100842	SITE USE (A+B METHOD) - CALENDAR DAY CONTRACT
JOB 100842	SOIL STABILIZATION
JOB 100842	STORM WATER POLLUTION PREVENTION PLAN
JOB 100842	SUBMISSION OF ASPHALT CONCRETE HOT MIX ACCEPTANCE TEST RESULTS
JOB 100842	UTILITY ADJUSTMENTS
JOB 100842	WARM MIX ASPHALT
JOB 100842	WELLHEAD PROTECTION

### GENERAL NOTES

- GRADE LINE DENOTES FINISHED GRADE WHERE SHOWN ON PLANS.
- ALL PIPE LINES, POWER, TELEPHONE, AND TELEGRAPH LINES TO BE MOVED OR LOWERED BY THE RESPECTIVE OWNERS AS PER AGREEMENT WITH SUCH OWNERS.
- ANY EQUIPMENT OR APPURTENANCE THAT INTERFERES WITH THE PROPOSED CONSTRUCTION AND WHICH MAY BE THE PROPERTY OF UTILITY SERVICE ORGANIZATIONS SHALL BE MOVED BY THE OWNERS UNLESS OTHERWISE PROVIDED.
- THE CONTRACTOR SHALL BE RESPONSIBLE FOR MAINTAINING U. S. MAILBOXES WITHIN THE PROJECT LIMITS IN SUCH A MANNER THAT THE PUBLIC MAY RECEIVE CONTINUED MAIL SERVICE. PAYMENT WILL BE CONSIDERED INCLUDED IN THE PRICE BID FOR THE VARIOUS BID ITEMS.
- ALL LAND MONUMENTS LOCATED WITHIN THE CONSTRUCTION AREA SHALL BE PROTECTED IN ACCORDANCE WITH SECTION 107.12 OF THE STANDARD SPECIFICATIONS.
- ALL TREES THAT DO NOT DIRECTLY INTERFERE WITH THE PROPOSED CONSTRUCTION SHALL BE SPARED AS DIRECTED BY THE ENGINEER. CARE AND DISCRETION SHALL BE USED TO INSURE THAT ALL TREES NOT TO BE REMOVED SHALL BE HARMED AS LITTLE AS POSSIBLE DURING THE CONSTRUCTION OPERATIONS.
- THE CONTRACTOR SHALL BE RESPONSIBLE FOR PROVIDING A FENCE TO CONTROL LIVESTOCK IN AREAS WHERE PASTURES ARE SEVERED. WIRE FENCE MAY BE CONSTRUCTED INITIALLY, OR IN LIEU THEREOF, THE CONTRACTOR AT HIS OWN EXPENSE, MAY ELECT TO PROVIDE TEMPORARY FENCING SUITABLE TO CONTAIN LIVESTOCK.
- THE SEQUENCE AS SHOWN ON THE MAINTENANCE OF TRAFFIC PLANS IS A GENERAL OUTLINE FOR THE CONSTRUCTION OF THIS PROJECT, AND IN NO WAY IS IT INTENDED TO COVER EVERY ITEM IN THE PROJECT. ITEMS NOT CRITICAL TO THE CONSTRUCTION SEQUENCE MAY BE CONSTRUCTED IN ANY STAGE AS APPROVED BY THE RESIDENT ENGINEER.
- THE EXISTING ASPHALT PAVEMENT TO BE REMOVED FROM THE REMAINING PAVEMENT SHALL BE SEPARATED BY SAWING ALONG A NEAT LINE. AFTER SAWING, THE PAVEMENT TO BE REMOVED SHALL BE CAREFULLY REMOVED IN A MANNER THAT WILL NOT DAMAGE THE PAVEMENT THAT IS TO REMAIN. ANY DAMAGE OF THE ASPHALT PAVEMENT THAT IS TO REMAIN IN PLACE SHALL BE REPAIRED AT THE CONTRACTOR'S EXPENSE.
- ALL FLEXIBLE BASE AND ASPHALTIC PAVEMENTS REMOVED SHALL BE PAID FOR UNDER THE ITEM NO. 210 - UNCLASSIFIED EXCAVATION.

5/17/2019

R100842.DGN

DATE REVISED	DATE FILMED	DATE REVISED	DATE FILMED	FED. AID DIST. NO.	STATE	FED. AID PROJ. NO.	SHEET NO.	TOTAL SHEETS
				6	ARK.			
				JOB NO. 100842		4		30

2 TYPICAL SECTION OF IMPROVEMENT

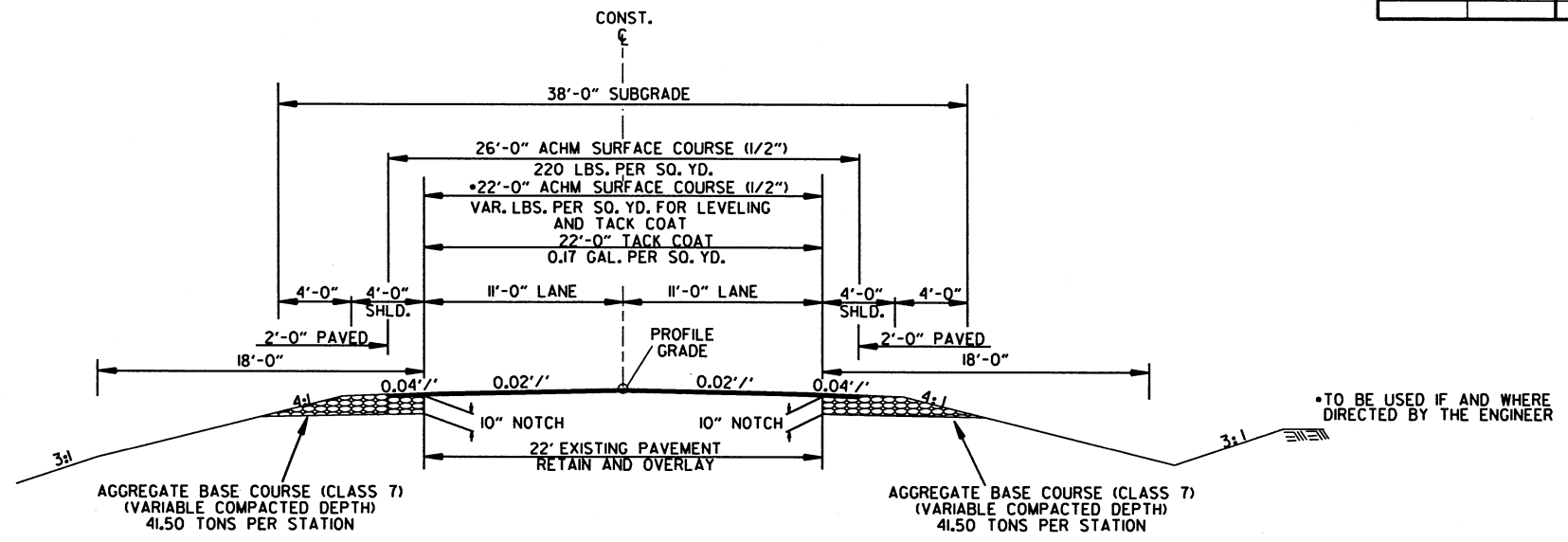
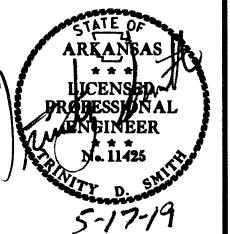

TYPICAL SECTION OF IMPROVEMENT  
NOTCH AND WIDEN  
STA. 100+00.00-STA. 102+10.00  
STA. 110+50.00-STA. 113+00.00

•TO BE USED IF AND WHERE DIRECTED BY THE ENGINEER

NOTES:  
REFER TO CROSS SECTIONS FOR DEVIATION FROM THE NORMAL SLOPES. NO CHANGES SHALL BE MADE FROM THE PLANNED SLOPES WITHOUT THE APPROVAL OF THE ENGINEER.

THE THICKNESS OF AGGREGATE BASE COURSE SHALL BE WITHIN PLUS OR MINUS ONE INCH OF THE PLAN THICKNESS SHOWN. THE CONTRACTOR WILL CORRECT ANY DEFICIENT THICKNESS THAT DOES NOT MEET TOLERANCE INDICATED. PAYMENT WILL NOT BE MADE FOR MATERIAL PLACED IN EXCESS OF THE TOLERANCE INDICATED.

ASPHALT FOR LEVELING OF EXISTING PAVEMENT SHALL BE PLACED ONLY IF AND WHERE DIRECTED BY THE ENGINEER. CALCULATIONS FOR THE AMOUNT OF LEVELING AND/OR LEVELING OPERATIONS SHALL BE PERFORMED BEFORE CONSTRUCTING NOTCH AND WIDENING. CALCULATIONS WILL NOT BE PAID FOR DIRECTLY, BUT PAYMENT WILL BE CONSIDERED INCLUDED IN THE VARIOUS PAY ITEMS.

THE FINAL 2" OF SURFACE COURSE IS TO BE PLACED AFTER ALL OTHER COURSES HAVE BEEN LAID. LONGITUDINAL JOINTS SHALL BE AT LANE LINES.

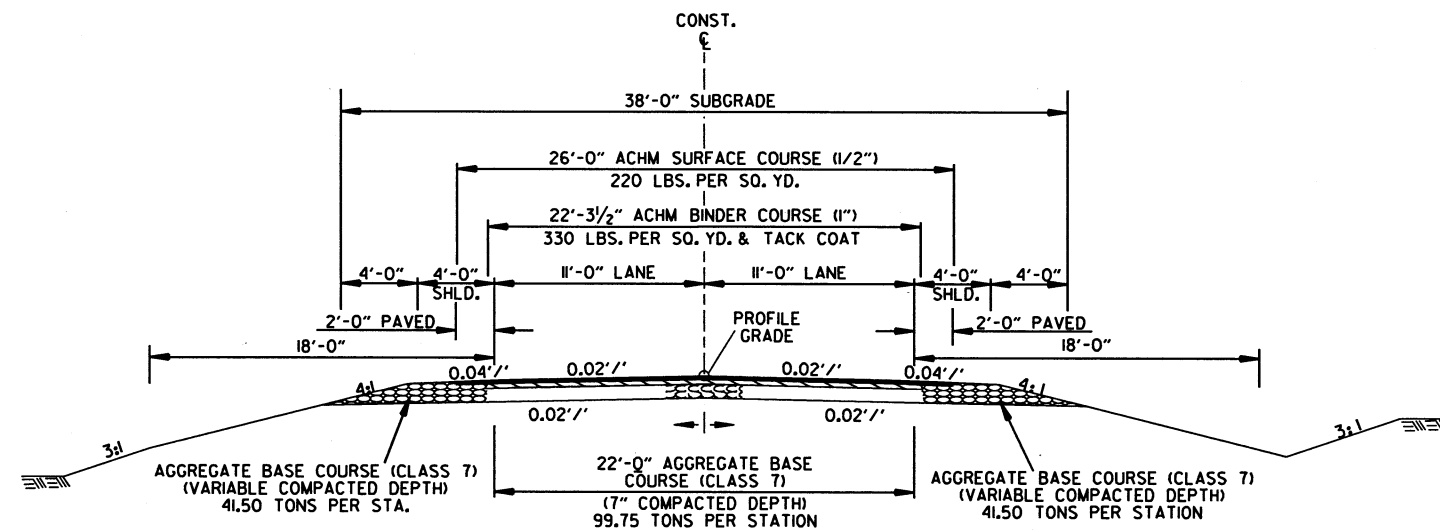

TYPICAL SECTION OF IMPROVEMENT  
TWO LANE OPEN SHOULDER  
STA. 102+10.00-STA. 105+17.00  
STA. 106+73-STA. 110+50.00

TYPICAL SECTIONS OF IMPROVEMENT

DATE REVISED	DATE FILMED	DATE REVISED	DATE FILMED	FED. RD. DIST. NO.	STATE	FED. AID PROJ. NO.	SHEET NO.	TOTAL SHEETS
				6	ARK.			
JOB NO. 100842							5	30

2 SPECIAL DETAILS

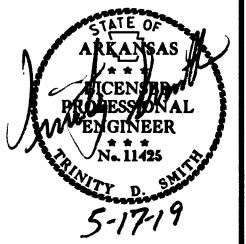

CONSTRUCT 25 LIN. FT. TYPE 'C' GUARDRAIL WITH 3 RED DIAMOND REFLECTORS MOUNTED ON U-CHANNEL POSTS DIRECTLY BEHIND THE GUARDRAIL AT A HEIGHT OF 4'-0".

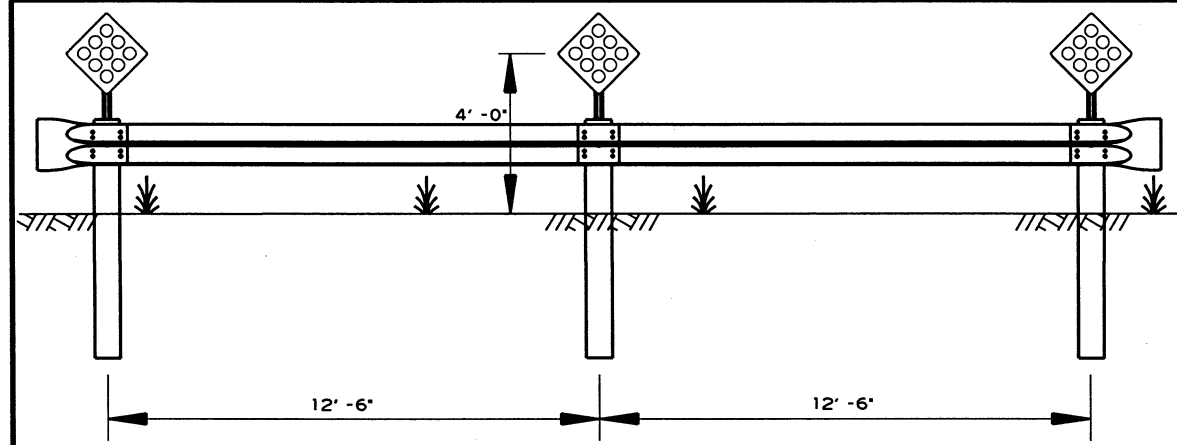

ROAD CLOSED DETAIL

TO BE USED WHERE EXISTING ROADS WILL BE PERMANENTLY CLOSED. SEE PLAN SHEETS FOR LOCATIONS. SEE STD. DWG. GR-7 FOR MORE DETAILS.

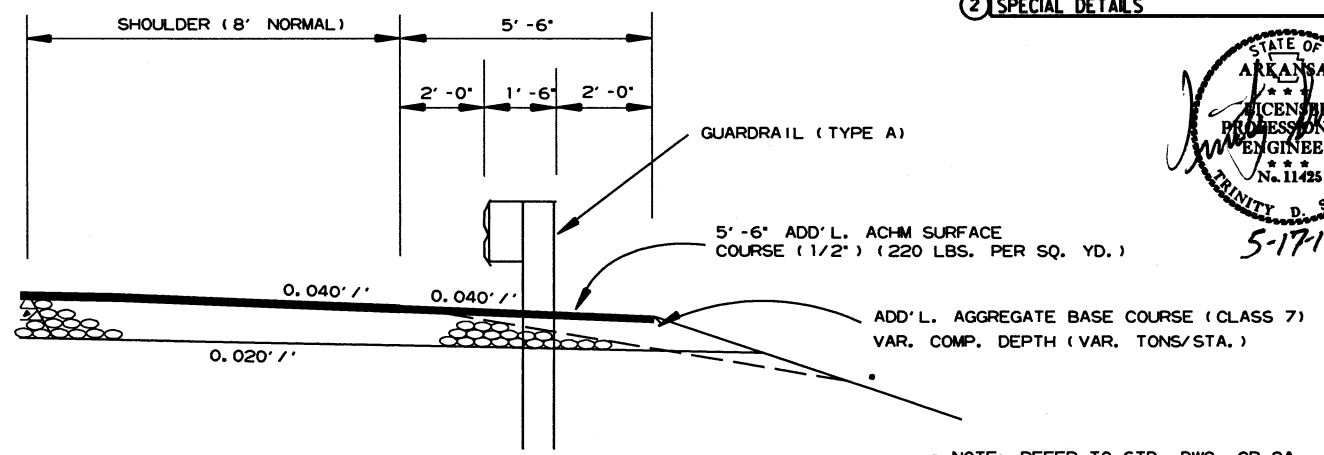

WIDENING FOR GUARDRAIL

NOTE: REFER TO STD. DWG. GR-9A AND CROSS SECTIONS FOR SLOPE REQUIREMENTS BEHIND GUARDRAIL.

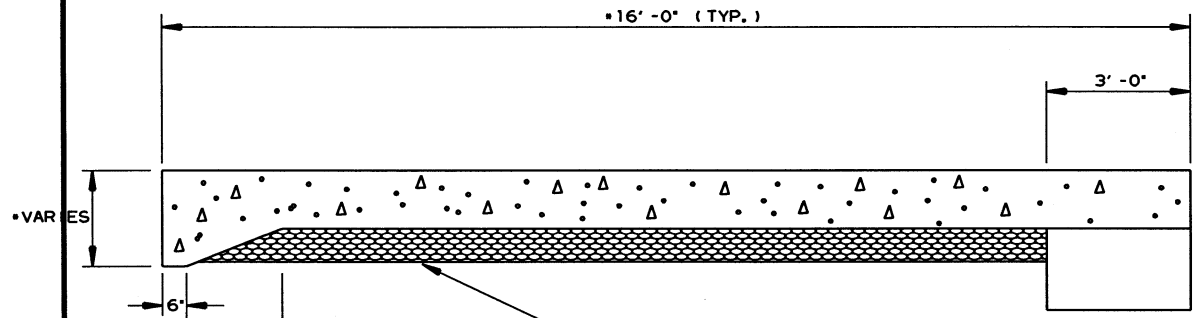

SECTION OF APPROACH SLAB

AGGREGATE BASE COURSE (CLASS 7) VARIABLE - 6" MIN. COMPACTED DEPTH  
 \* SEE APPROACH SLAB DETAILS IN BRIDGE DRAWINGS

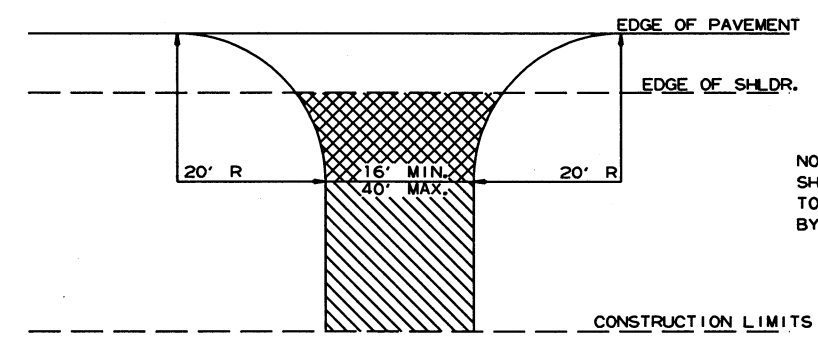

NOTE: TURNOUTS AND PRIVATE DRIVES SHALL BE MODIFIED WHERE NECESSARY TO MEET LOCAL CONDITIONS AS DIRECTED BY THE ENGINEER.

- ASPHALT CONCRETE HOT MIX SURFACE COURSE (220 LBS. PER SQ. YD.)  
AGGREGATE BASE COURSE (CLASS 7)  
7" COMP. DEPTH IF ASPHALT DRIVE EXIST OR  
6" CONCRETE IF CONCRETE DRIVE EXIST.
- AGGREGATE BASE COURSE (CLASS 7)  
9" COMP. DEPTH OR CONFORM  
TO EXISTING DRIVEWAY

DETAIL FOR DRIVEWAY TURNOUTS (COLLECTORS)

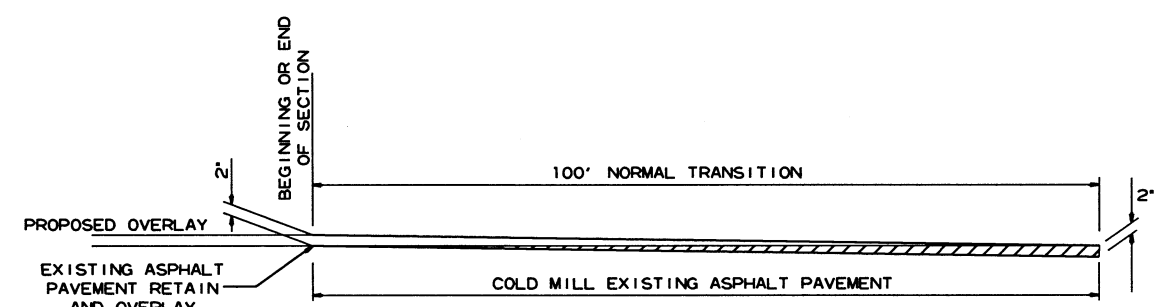

DETAIL FOR TRANSITIONS

4/19/2019

R100842.DGN

DATE REVISED	DATE FILMED	DATE REVISED	DATE FILMED	FED. RD. DIST. NO.	STATE	FED. AID PROJ. NO.	SHEET NO.	TOTAL SHEETS
				6	ARK.			
JOB NO. 100842							6	30

② EROSION CONTROL DETAILS

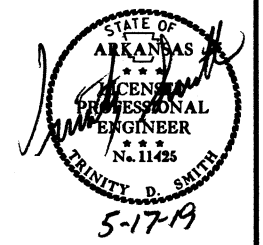

**LEGEND**

	= ROCK DITCH CHECKS
	= SEDIMENT BASIN

NOTE: PERIMETER CONTROLS SHALL BE PLACED AS CLEARING AND GRUBBING OPERATIONS ARE STARTED. RETAIN ALL EROSION CONTROL DEVICES UNTIL END OF CONSTRUCTION UNLESS OTHERWISE NOTED.

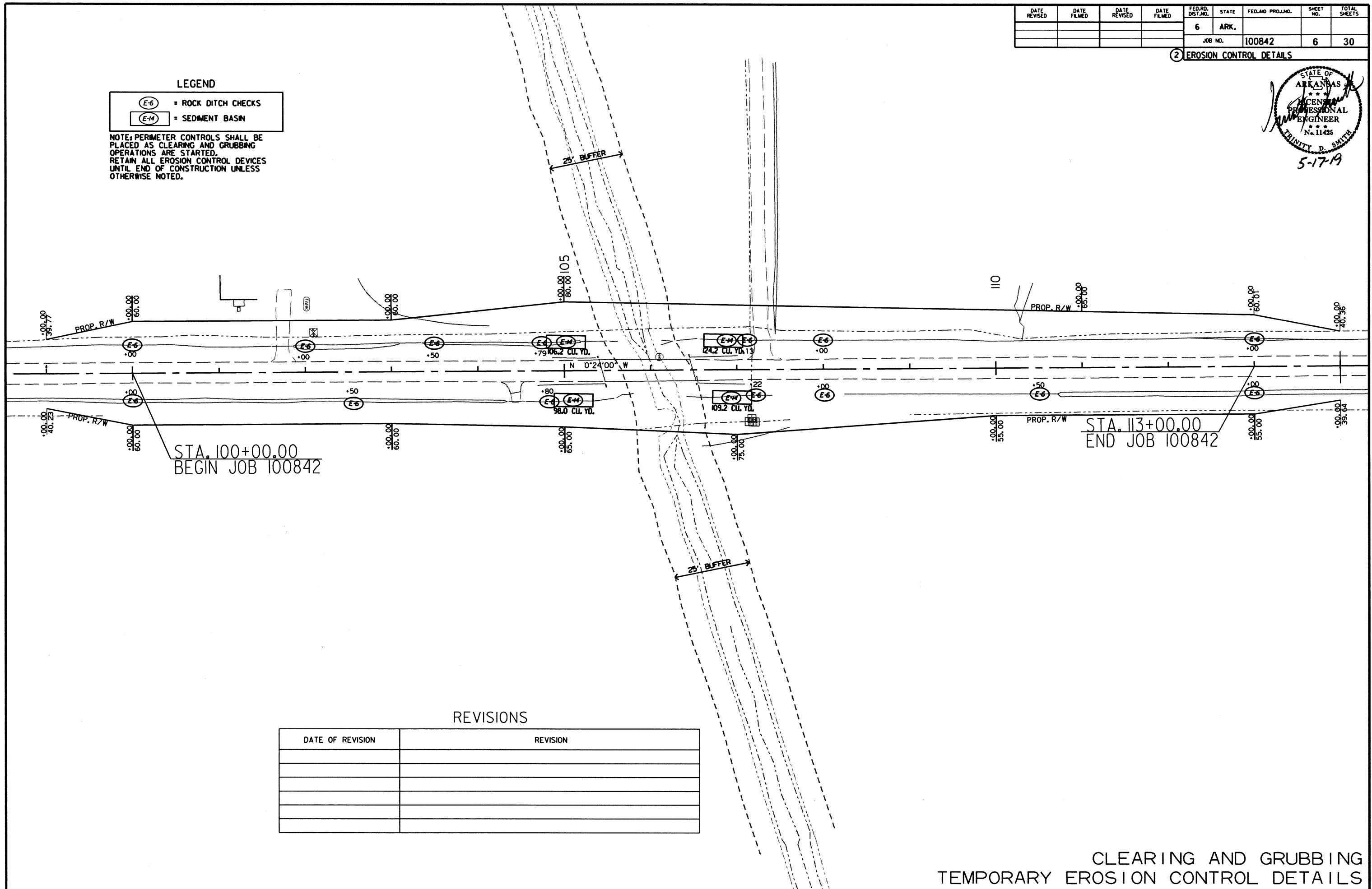

STA. 100+00.00  
BEGIN JOB 100842

STA. 113+00.00  
END JOB 100842

REVISIONS

DATE OF REVISION	REVISION

CLEARING AND GRUBBING  
TEMPORARY EROSION CONTROL DETAILS

5/7/2019  
R100842.DGN