

DATE REVISED	DATE FILMED	DATE REVISED	DATE FILMED	FED. NO. DIST. NO.	STATE	FED. AID PROJ. NO.	SHEET NO.	TOTAL SHEETS
				5	ARK.		1	42
				JOB NO. 110635		AHP DIST. 5 MULTI-PURPOSE FACILITY (WEST MEMPHIS) (S)		

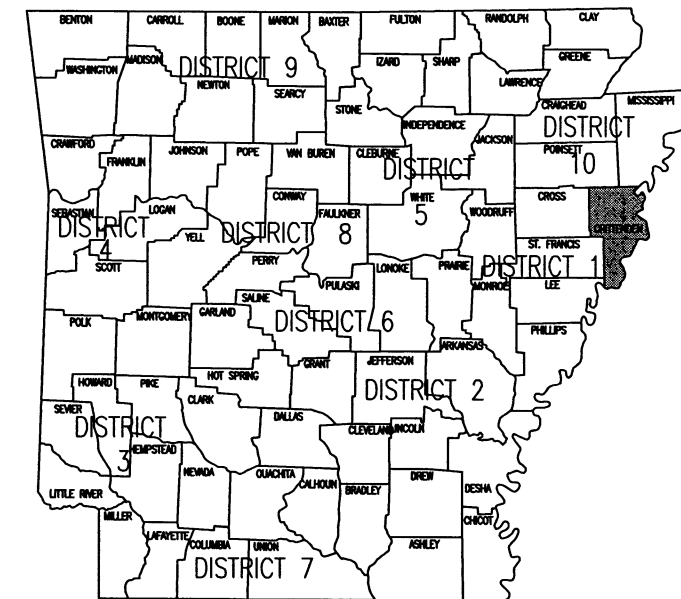

ARKANSAS STATE HIGHWAY AND TRANSPORTATION DEPARTMENT

CONSTRUCTION PLANS FOR AHP DIST. 5 MULTI-PURPOSE FACILITY (WEST MEMPHIS) (S) CRITTENDEN COUNTY HWY. 191 SECTION 1 JOB 110635



ARK. HWY. DIST. NO. 1

**AHP DIST. 5
MULTI-PURPOSE FACILITY**
West Memphis, Arkansas
Crittenden County

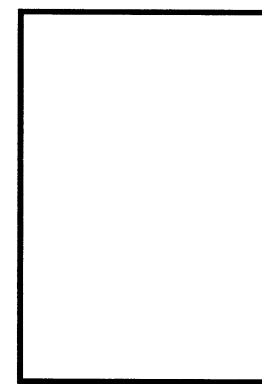

DATE: AUG. 8, 2016
JOB NO: 110635
DRAWN BY: KB
REVISIONS:

G1.1
1 OF 42



PROJECT LOCATION
911 ADDRESS:
1950 NORTH 7TH STREET
WEST MEMPHIS, AR 72301



VICINITY MAP

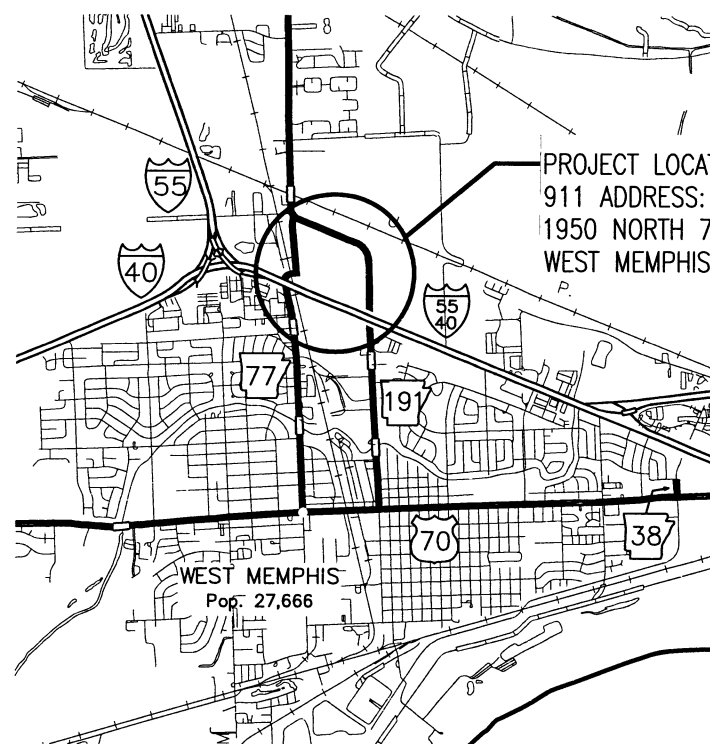

PROJECT LOCATION
911 ADDRESS:
1950 NORTH 7TH STREET
WEST MEMPHIS, AR 72301



LOCATION MAP

MIDPOINT OF PROJECT:
LATITUDE: N 35° 09' 58.72"
LONGITUDE: W 90° 10' 35.18"

APPROVED
STATE OF ARKANSAS
REGISTERED PROFESSIONAL ENGINEER
No. 7836
M. E. BANKS

8-9-16
DEPUTY DIRECTOR
AND CHIEF ENGINEER

ABBREVIATIONS

AD	AREA DRAIN	GALV	GALVANIZED
ADA	AMERICANS WITH DISABILITIES	INSUL	INSULATION
AFF	ABOVE FINISHED FLOOR	INT	INTERIOR
AFG	ABOVE FINISHED GRADE	MAX	MAXIMUM
ALUM	ALUMINUM	MBM	METAL BUILDING MANUFACTURER
ANOD	ANODIZED	MECH	MECHANICAL
BOT	BOTTOM	MIN	MINIMUM
CJ	CONTROL JOINT	MTL	METAL
CLG	CEILING	NIC	NOT IN CONTRACT
CLR	CLEAR	NO	NUMBER
CMU	CONCRETE MASONRY UNIT	NOM	NOMINAL
COL	COLUMN	OC	ON CENTER
CONC	CONCRETE	OPG	OPENING
CONT	CONTINUOUS	PLUMB	PLUMBING
DEMO	DEMOLITION	PLAS. LAM.	PLASTIC LAMINATE
DTL	DETAIL	PLYWD	PLYWOOD
DIA	DIAMETER	PVC	POLYVINYL CHLORIDE
DIM	DIMENSION	RBR	RUBBER
EA	EACH	RD	ROOF DRAIN
EJ	EXPANSION JOINT	REQ	REQUIRED
ELEC	ELECTRICAL	SIM	SIMILAR
ELEV	ELEVATION	SPEC	SPECIFICATION
EQ	EQUAL	SPK	SPRINKLER
EWC	ELECTRIC WATER COOLER	STRUCT	STRUCTURAL
EXIST	EXISTING	T&G	TONGUE AND GROOVE
FD	FLOOR DRAIN	TELE	TELEPHONE
FEC	FIRE EXTINGUISHER CABINET	TLT	TOILET
FFE	FINISHED FLOOR ELEVATION	TYP	TYPICAL
FIXT	FIXTURE	UNO	UNLESS NOTED OTHERWISE
FLR	FLOOR	VCT	VINYL COMPOSITION TILE
GA	GAUGE		

SYMBOL LEGEND

	DOOR AND FRAME
	HARDWARE SET
	WINDOW TAG
	ROOM NAME
	FINISH
	CEILING HEIGHT
	ROOM NUMBER
	MILLWORK ELEVATION TAG
	DRAWING NUMBER
	SHEET NUMBER
	KEYED PLAN NOTE
	KEYED DEMOLITION PLAN NOTE

MATERIAL LEGEND

	FACE BRICK
	CONCRETE BLOCK RE: PLANS FOR SIZE
	STUDS
	CONCRETE (SECTION)
	BATT. INSULATION
	FOAM OR RIGID INSULATION
	ROUGH FRAMING
	FINISHED WOOD

INDEX OF SHEETS

SHEET	NO.	SHEET TITLE	SHEET	NO.	SHEET TITLE
G1.1	1	TITLE SHEET	P1.1	35	SEWER FLOOR PLAN
G1.2	2	INDEX OF SHEETS	P1.2	36	PIPING FLOOR PLAN
G1.3	3	GOVERNING SPECS, SUMMARY OF QUANTITIES, EARTHWORK AND REVISIONS	P2.1	37	RISER DIAGRAMS
			P3.1	38	PLUMB. LEGENDS AND SCHED.
			E1.1	39	POWER FLOOR PLAN
C1.1	4	EXISTING CONDITIONS SITE PLAN	E1.2	40	LIGHTING FLOOR PLAN
C1.2	5	OVERALL SITE PLAN	E2.1	41	ELECT. LEGENDS AND SCHEDULES
C1.3	6	GRADING PLAN	E3.1	42	PANEL SCHED. AND RISER DIGRM.
C1.4	7	OVERALL SITE DIMENSION PLAN			
C1.5	8	ENLARGED SITE PLAN			
C2.1	9	SITE DETAILS			
C2.2	10	SITE DETAILS			
A1.1	11	FINISH SCHEDULE AND DETAILS			
A1.2	12	DOOR AND WINDOW SCHEDULE			
A1.3	13	DOOR AND WINDOW DETAILS			
A1.4	14	CABINET ELEV. AND DETAILS			
A2.1	15	FLOOR PLAN			
A2.2	16	DIMENSION PLAN			
A2.3	17	ENLARGED TOILET PLANS			
A3.1	18	EXTERIOR ELEVATIONS			
A3.2	19	EXTERIOR ELEVATIONS			
A4.1	20	BUILDING SECTIONS			
A4.2	21	WALL SECTIONS			
A4.3	22	WALL SECTIONS			
A4.4	23	WALL SECTIONS			
A4.5	24	WALL SECTIONS			
A5.1	25	REFLECTED CEILING PLAN			
A6.1	26	ROOF PLAN			
S1.1	27	FOUNDATION PLAN			
S1.2	28	FOUNDATION DETAILS			
S2.1	29	ROOF FRAMING PLAN			
MEP1.1	30	OVERALL SITE UTILITIES PLAN			
MEP1.2	31	ENLARGED SITE UTILITIES PLAN			
MEP2.1	32	SITE UTILITIES DETAILS			
M1.1	33	MECHANICAL FLOOR PLAN			
M2.1	34	MECH. EQUIP. SCHED. & DETAILS			

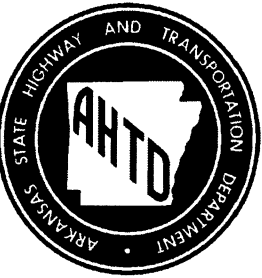

AHP DIST. 5
MULTI-PURPOSE FACILITY
 West Memphis, Arkansas
 Crittenden County

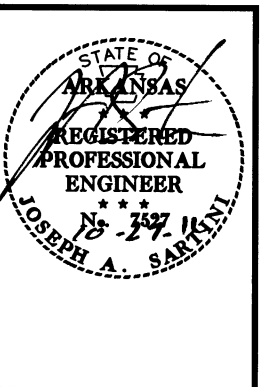

DATE: AUG. 8, 2016
JOB NO: 110635
 DRAWN BY: KB
 REVISIONS: 10-24-16

G1.2



SUMMARY OF QUANTITIES

ITEM NO.	ITEM DESCRIPTION	QTY	UNIT
210	UNCLASSIFIED EXCAVATION	2,908	CU.YD.
SP & 210	COMPACTED EMBANKMENT	6,666	CU.YD.
601	MOBILIZATION	1.00	LUMP SUM
SP	MULTI-PURPOSE FACILITY	1.00	LUMP SUM

GOVERNING SPECIFICATIONS:

ARKANSAS STATE HIGHWAY COMMISSION STANDARD SPECIFICATIONS FOR HIGHWAY CONSTRUCTION, EDITION OF 2014, AND THE FOLLOWING SPECIAL PROVISIONS AND SUPPLEMENTAL SPECIFICATIONS:

ERRATA	ERRATA FOR THE BOOK OF STANDARD SPECIFICATIONS
100-3	CONTRACTOR'S LICENSE
102-2	ISSUANCE OF PROPOSALS
108-1	LIQUIDATED DAMAGES
108-2	WORK ALLOWED PRIOR TO ISSUANCE OF WORK ORDER
JOB 110635	BIDDING REQUIREMENTS AND CONDITIONS
JOB 110635	COMPACTED EMBANKMENT SPECIAL
JOB 110635	MANDATORY ELECTRONIC CONTRACT
JOB 110635	MANDATORY ELECTRONIC DOCUMENT SUBMITTAL
JOB 110635	MEASUREMENT AND PAYMENT
JOB 110635	PROJECT MANUAL
JOB 110635	STORM WATER POLLUTION PREVENTION PLAN

EARTHWORK

STATION	STATION	LOCATION / DESCRIPTION	UNCLASSIFIED EXCAVATION	COMPACTED EMBANKMENT
			CU. YD.	
ENTIRE	PROJECT	UNDERCUT AND FILL TO BE USED AS DESCRIBED ON GRADING PLAN	2,908	6,666
TOTALS:			2,908	6,666

NOTE: EARTHWORK QUANTITIES SHOWN ABOVE SHALL BE PAID AS PLAN QUANTITY.

REVISIONS

DATE	DESCRIPTION	SHEET #
09-07-16	ADDED SP STORM WATER POLLUTION PREVENTION PLAN	3
10-24-16	REVISED PROJECT MANUAL, ADDED EARTHWORK BOX WITH UNCLASSIFIED EXCAVATION AND COMPACTED EMBANKMENT. REVISED DIMENSION ON WALL SECTION. ADDED BACKUP GENERATOR TO CONTRACT. REVISED STORM WATER POLLUTION PREVENTION PLAN SP, MEASUREMENT AND PAYMENT SP AND ADDED COMPACTED EMBANKMENT SPECIAL SP.	2, 3, 8, 21 & 31
11-01-16	ADDED PAY ITEM MOBILIZATION	3

AHP DIST. 5
MULTI-PURPOSE FACILITY
 West Memphis, Arkansas
 Crittenden County

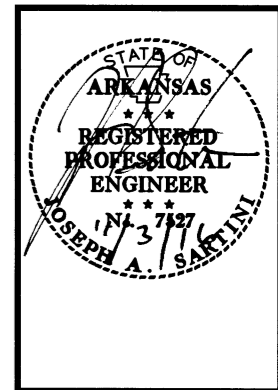

DATE: AUG. 8, 2016
JOB NO: 110635
 DRAWN BY: KB
 REVISIONS: 09-07-16
 10-24-16
 11-01-16

G1.3

3 OF 42



AHP DIST. 5
MULTI-PURPOSE FACILITY
West Memphis, Arkansas
Crittenden County

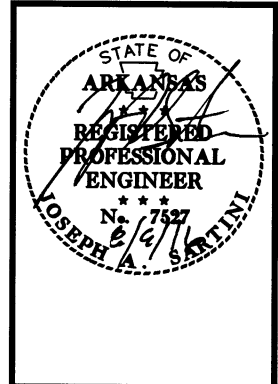

DATE: AUG. 8, 2016
JOB NO: 110635
DRAWN BY: KB
REVISIONS:

C1.1
4 OF 42

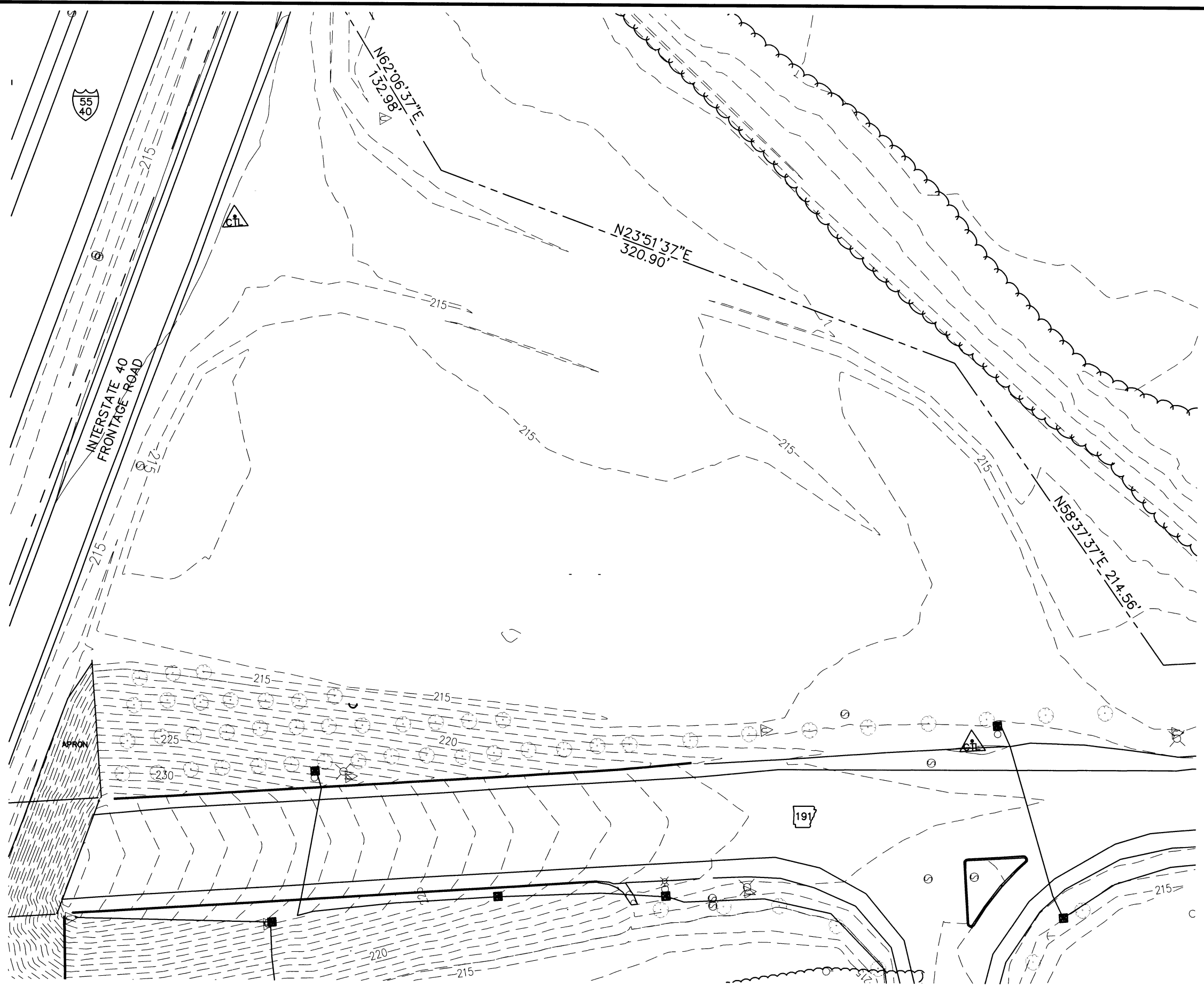

1
C1.1

EXISTING CONDITIONS SITE PLAN

SCALE: 1" = 60.0'