

FED. ROAD DIST. NO.	STATE PROJ. NO.	F.I.C. NO.	SHEET NO.	TOTAL SHEETS
			358	365

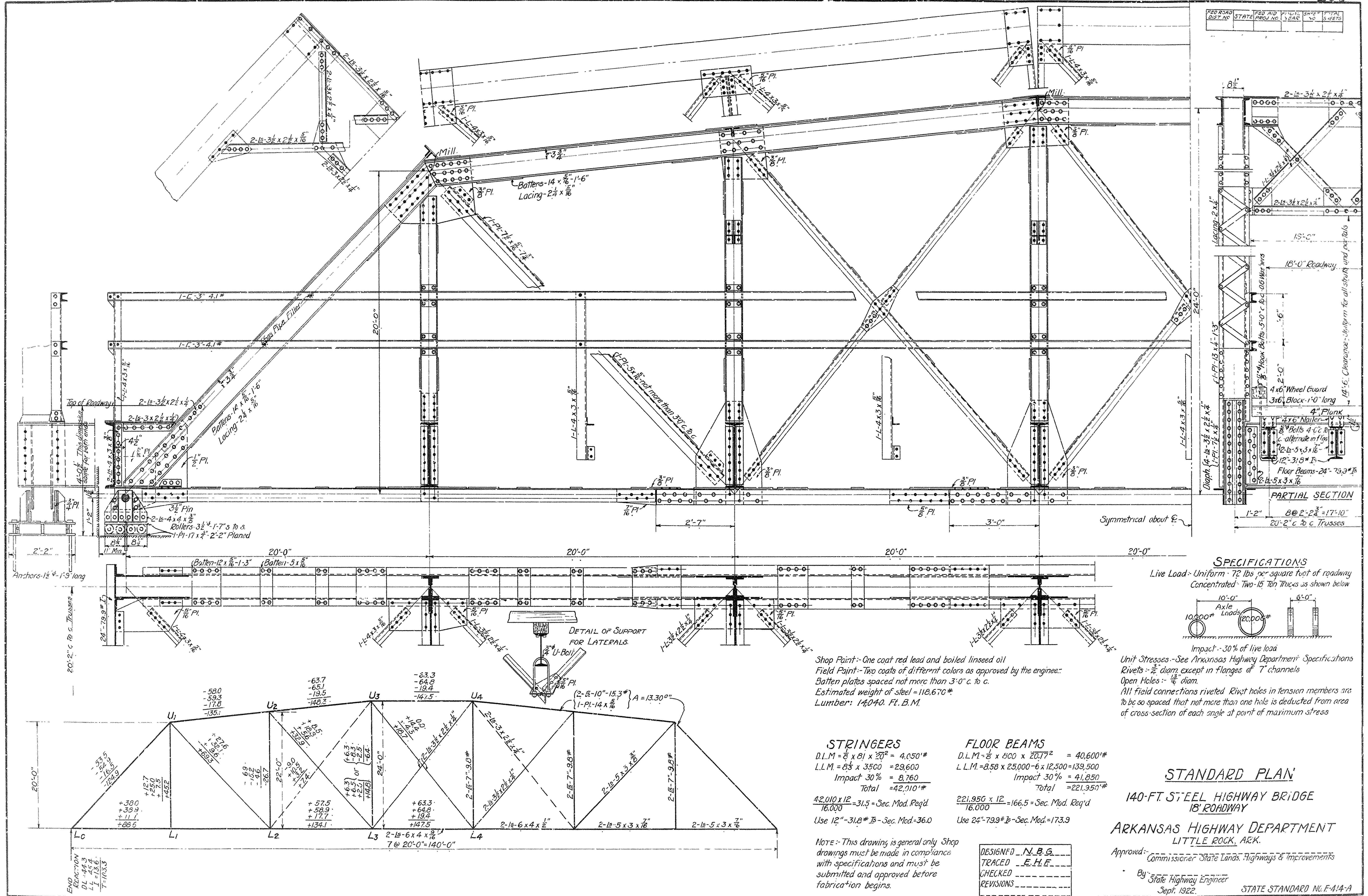

**SPECIFICATIONS**  
 Live Load - Uniform - 72 lbs per square foot of roadway  
 Concentrated - Two 15 Ton Trucks as shown below

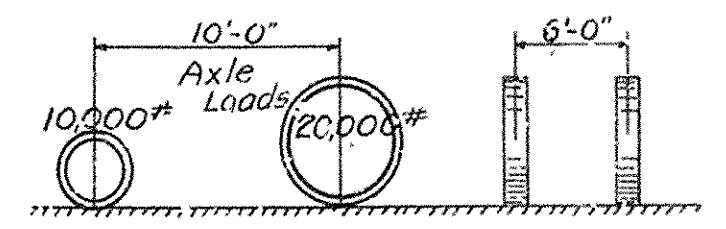

Impact - 30% of live load  
 Unit Stresses - See Arkansas Highway Department Specifications  
 Rivets - 3/4" diam except in flanges of T channels  
 Open Holes - 1/8" diam  
 All field connections riveted. Rivet holes in tension members are to be so spaced that not more than one hole is deducted from area of cross-section of each angle at point of maximum stress

Shop Paint - One coat red lead and boiled linseed oil  
 Field Paint - Two coats of different colors as approved by the engineer.  
 Batten plates spaced not more than 3'-0" c. to c.  
 Estimated weight of steel = 118,670 #  
 Lumber: 14,040 Ft. B.M.

**STRINGERS**  
 D.L.M. = 8 x 81 x 20<sup>2</sup> = 4,050 #  
 L.L.M. = 8 1/2 x 3500 = 29,600  
 Impact 30% = 8,760  
 Total = 42,010 #  
 42,010 x 12 = 31.5 = Sec. Mod. Req'd  
 16,000  
 Use 12" - 31.8 # I - Sec. Mod. = 36.0

**FLOOR BEAMS**  
 D.L.M. = 8 x 800 x 20.77<sup>2</sup> = 40,600 #  
 L.L.M. = 8.58 x 25,000 - 6 x 12,500 = 139,500  
 Impact 30% = 41,850  
 Total = 221,950 #  
 221,950 x 12 = 166.5 = Sec. Mod. Req'd  
 16,000  
 Use 24" - 79.9 # I - Sec. Mod. = 173.9

**STANDARD PLAN**  
 140-FT. STEEL HIGHWAY BRIDGE  
 18' ROADWAY

ARKANSAS HIGHWAY DEPARTMENT  
 LITTLE ROCK, ARK.  
 Approved: \_\_\_\_\_  
 Commissioner State Lands, Highways & Improvements  
 By: \_\_\_\_\_  
 State Highway Engineer  
 Sept. 1922. STATE STANDARD NO. F-14-A

NOTE: - This drawing is general only. Shop drawings must be made in compliance with specifications and must be submitted and approved before fabrication begins.

DESIGNED	N. B. G.
TRACED	E. H. F.
CHECKED	
REVISIONS	