

FED. ROAD DIST. NO.	STATE	FED. AID PROJ. NO.	FISCAL YEAR	SHEET NO.	TOTAL SHEETS
6	ARK.	169	1922	4	7

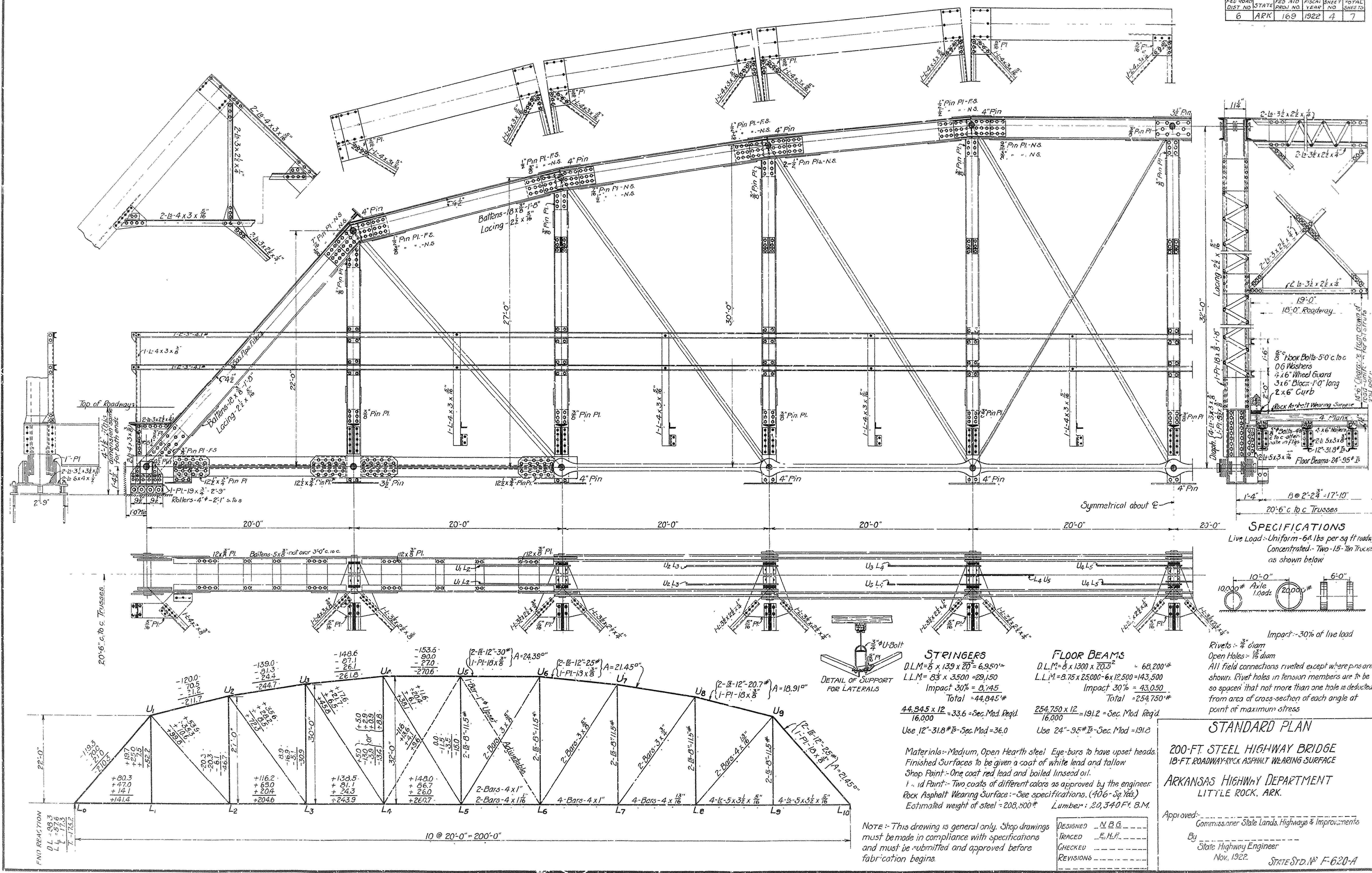

SPECIFICATIONS
 Live Load - Uniform - 64 lbs per sq ft roadway
 Concentrated - Two 15-Ton Trucks as shown below

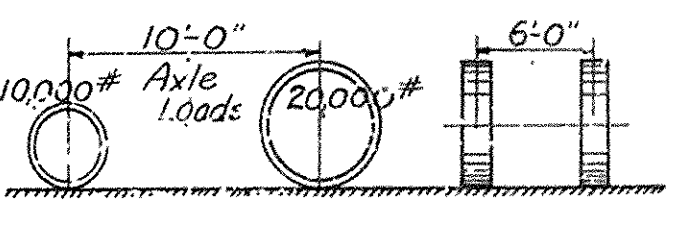

Impact - 30% of live load
 Rivets - 3/4" diam
 Open Holes - 1/8" diam
 All field connections riveted except where pins are shown. Rivet holes in tension members are to be so spaced that not more than one hole is deducted from area of cross-section of each angle at point of maximum stress.

STANDARD PLAN
 200-FT. STEEL HIGHWAY BRIDGE
 13-FT. ROADWAY - ROCK ASPHALT WEARING SURFACE
 ARKANSAS HIGHWAY DEPARTMENT
 LITTLE ROCK, ARK.

Approved: _____
 Commissioner State Lands, Highways & Improvements
 By _____
 State Highway Engineer
 Nov., 1922. STATE STD. NO. F-620-A

STRINGERS
 D.L.M. = 8 x 139 x 20 = 6,950
 L.L.M. = 8 3/4 x 3,500 = 29,150
 Impact 30% = 8,745
 Total = 44,845
 44,845 x 12 = 33.6 = Sec. Mod. Reqd.
 Use 12" - 31.8# B - Sec. Mod. = 36.0

FLOOR BEAMS
 D.L.M. = 8 x 1300 x 20.5 = 68,200
 L.L.M. = 8.75 x 25,000 - 6 x 12,500 = 143,500
 Impact 30% = 43,050
 Total = 254,750
 254,750 x 12 = 191.2 = Sec. Mod. Reqd.
 Use 24" - 95# B - Sec. Mod. = 191.2

Materials - Medium, Open Hearth steel Eye-bars to have upset heads.
 Finished Surfaces to be given a coat of white lead and tallow
 Shop Paint - One coat red lead and boiled linseed oil.
 Field Paint - Two coats of different colors as approved by the engineer
 Rock Asphalt Wearing Surface - See specifications. (406-Sp. 145)
 Estimated weight of steel = 208,800# Lumber: 20,340 Ft. 3.M.

NOTE - This drawing is general only. Shop drawings must be made in compliance with specifications and must be submitted and approved before fabrication begins.

DESIGNED	N.B.G.
TRACED	E.H.F.
CHECKED	
REVISIONS	

