

PROJ. NO.	STATE	PROJ. NO.	YEAR	SHEET NO.	TOTAL SHEETS
6	ARK.			11	12

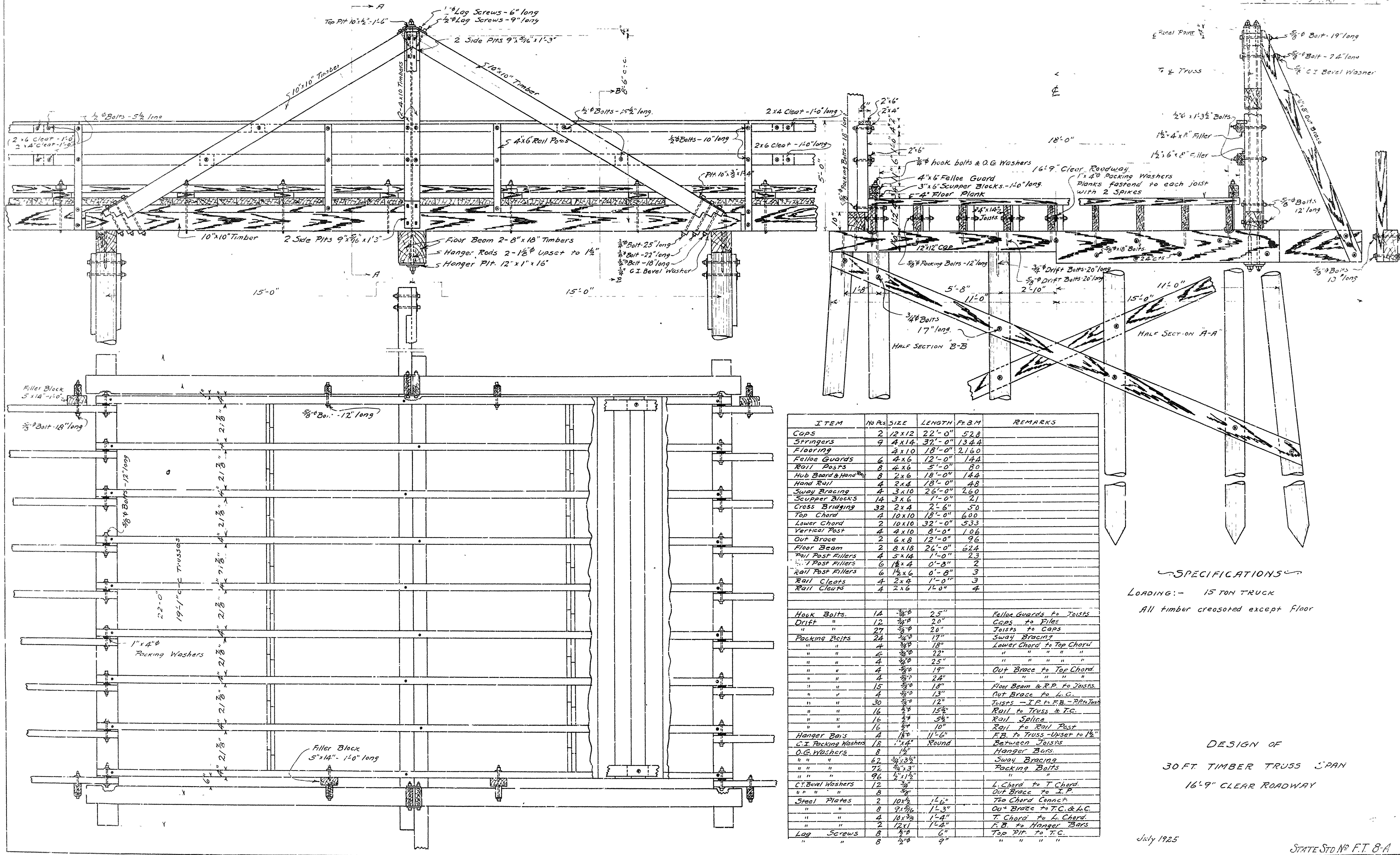

ITEM	No	SIZE	LENGTH	FR. AM	REMARKS
Caps	2	12x12	22'-0"	52.8	
Stringers	9	4x14	37'-0"	134.4	
Flooring	2	2x10	18'-0"	21.60	
Felloe Guards	6	4x6	12'-0"	14.4	
Rail Posts	8	4x6	5'-0"	8.0	
Hub Board & Hand Rail	8	2x6	18'-0"	14.4	
Hand Rail	4	2x4	18'-0"	4.8	
Sway Bracing	4	3x10	26'-0"	26.0	
Scupper Blocks	14	3x6	1'-0"	2.1	
Cross Bridging	32	2x4	2'-6"	5.0	
Top Chord	4	10x10	18'-0"	60.0	
Lower Chord	2	10x10	32'-0"	53.3	
Vertical Post	4	4x10	8'-0"	10.6	
Out Brace	2	6x8	12'-0"	9.6	
Floor Beam	2	8x18	26'-0"	62.4	
Rail Post Fillers	4	5x14	1'-0"	2.3	
T Post Fillers	6	1 1/2 x 4	0'-8"	2	
Rail Post Fillers	6	1 1/2 x 6	0'-8"	3	
Rail Cleats	4	2x4	1'-0"	3	
Rail Cleats	4	2x6	12'-0"	4	
Hook Bolts	14	3/4"	2.5"		Felloe Guards to Joists
Drift	12	3/4"	2.0"		Caps to Piles
	27	3/4"	2.0"		Joists to Caps
Packing Bolts	24	3/4"	1.7"		Sway Bracing
	4	3/4"	1.8"		Lower Chord to Top Chord
	4	3/4"	2.2"		" " " "
	4	3/4"	2.5"		" " " "
	4	3/4"	1.9"		Out Brace to Top Chord
	4	3/4"	2.4"		" " " "
	15	3/4"	1.8"		Floor Beam & R.P. to Joists
	4	3/4"	1.3"		Out Brace to L.C.
	30	3/4"	1.2"		Joists - I.P. to F.B. - R.P. to Joist
	16	3/4"	1.5"		Rail to Truss & T.C.
	16	3/4"	1.5"		Rail Splice
	16	3/4"	1.0"		Rail to Rail Post
Hanger Bars	4	1 1/2	11'-6"		F.B. to Truss - Upset to 1 1/2"
O.G. Washers	18	1" x 4" Round			Between Joists
O.G. Washers	8	1 1/2"			Hanger Bars
	67	3/4" x 3 1/2"			Sway Bracing
	72	3/4" x 3"			Packing Bolts
	96	1 1/2" x 1 1/2"			" " " "
C.T. Bevel Washers	12	3"			L. Chord to T. Chord
	8	3"			Out Brace to I.P.
Steel Plates	2	10 1/2"	1 1/2"		Top Chord Connect.
	8	9 1/2"	1 1/2"		Out Brace to T.C. & L.C.
	4	10 3/8"	1 1/4"		T. Chord to L. Chord
	2	12 1/2"	1 1/4"		F.B. to Hanger Bars
Log Screws	8	2"	6"		Top Pit. to T.C.
	8	2"	9"		" " " "

SPECIFICATIONS
 Loading:- 15 TON TRUCK
 All timber creosoted except floor

DESIGN OF
30 FT. TIMBER TRUSS SPAN
16'9" CLEAR ROADWAY

July 1925