

Bridge Inspection Report

00734
SH 1-15- LM 6.31
over
ENGLAND CR



Inspection Date:

Inspected By:

Inspection Type(s):

TABLE OF CONTENTS

	PAGE NUMBER
LOCATION MAP	3
NATIONAL BRIDGE INVENTORY	7
ELEMENTS	8
PICTURES	9
SKETCHES	10

Inspector:

Structure Number: 00734

Inspection Date:

Facility Carried: SH 1-15- LM 6.31

Bridge Inspection Report

Location Map

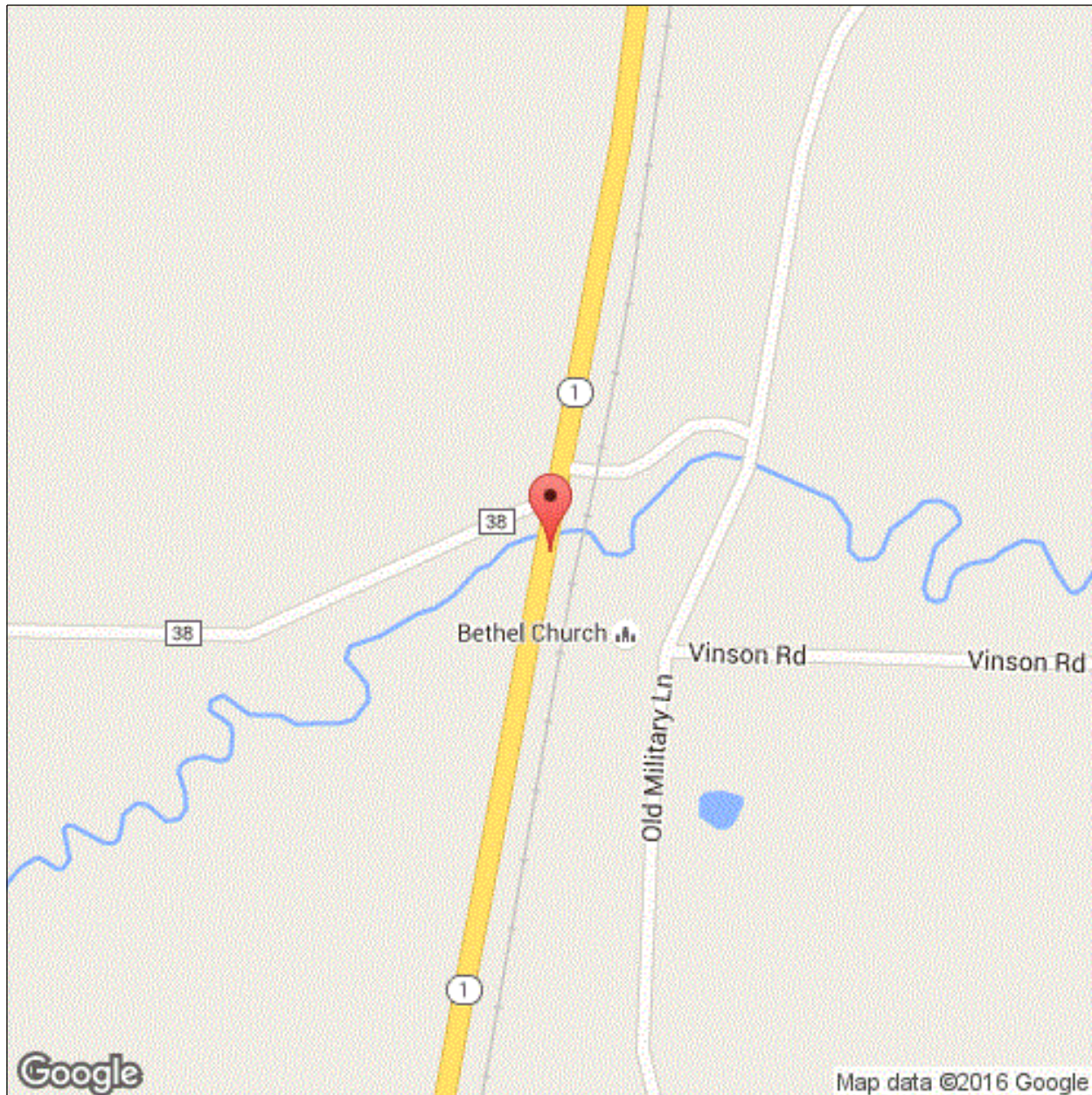

Latitude: 35.53548

Longitude: -90.72284

Inspector:

Structure Number: 00734

Inspection Date:

Facility Carried: SH 1-15- LM 6.31

Bridge Inspection Report

Location Map

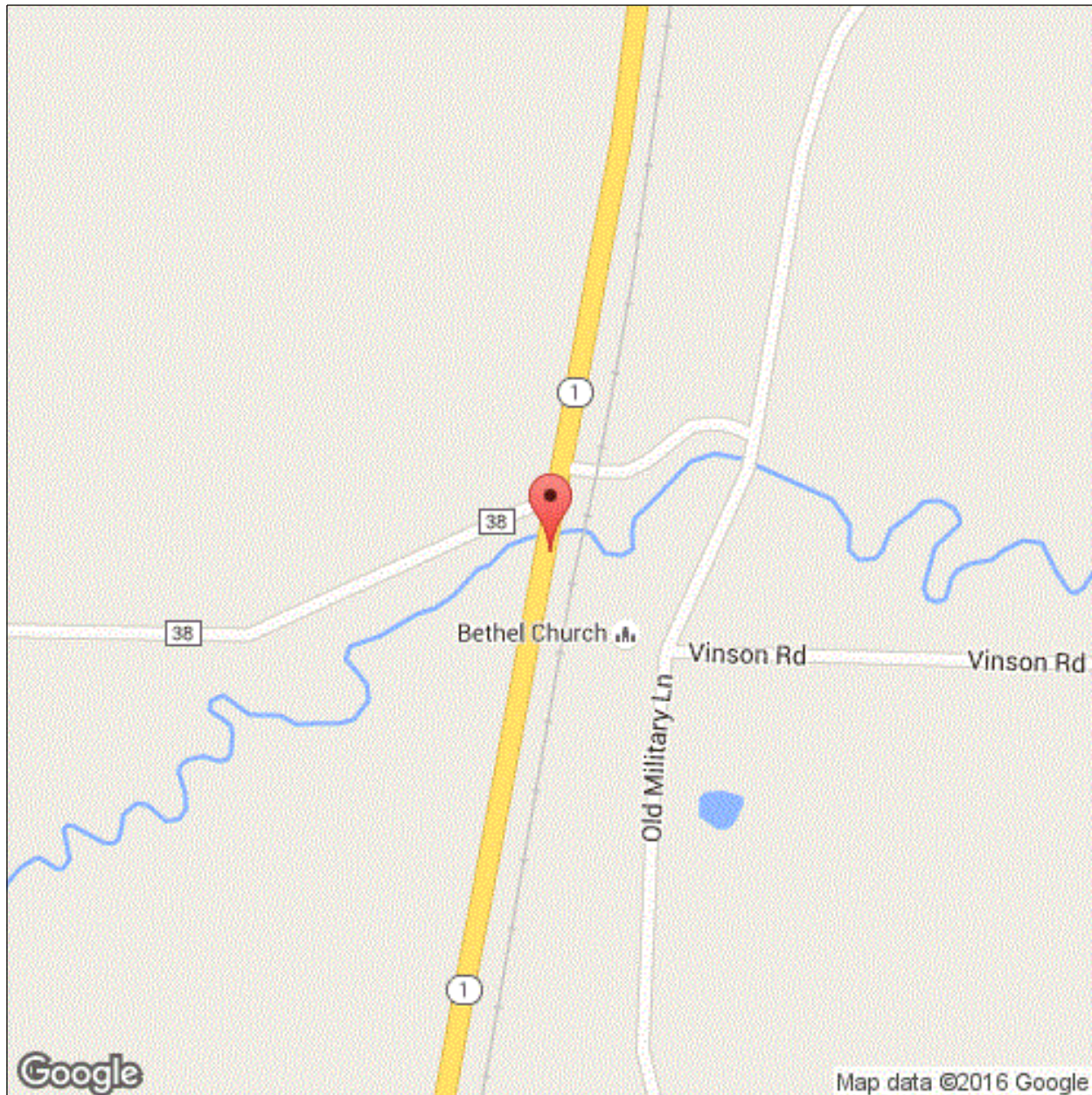

Latitude: 35.53548

Longitude: -90.72284

Inspector:

Structure Number: 00734

Inspection Date:

Facility Carried: SH 1-15- LM 6.31

Bridge Inspection Report

Location Map

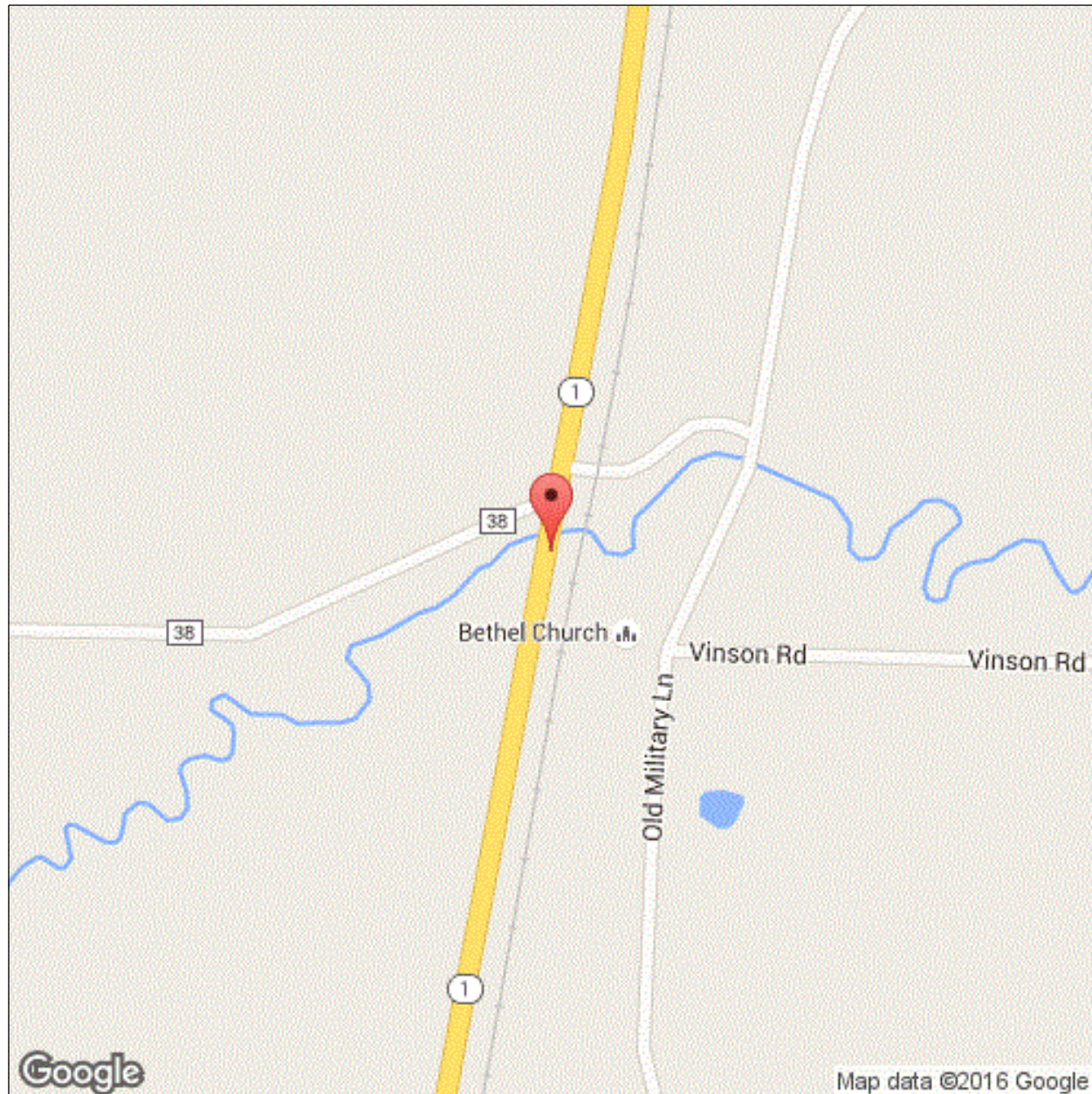

Latitude: 35.53548

Longitude: -90.72284

Inspector:

Inspection Date:

Structure Number: 00734

Facility Carried: SH 1-15- LM 6.31

Bridge Inspection Report

Executive Summary

Inspector:

Structure Number: 00734

Inspection Date:

Facility Carried: SH 1-15- LM 6.31

Bridge Inspection Report

National Bridge Inventory

IDENTIFICATION		INSPECTIONS	
(1) STATE CODE	056 - Arkansas	(90) INSPECTION DATE	05/24/2018
(8) STRUCTURE NUMBER	00734	(91) DESIGNATED INSPECTION FREQUENCY	24
(5) INV. ROUTE (ON/UNDER)	1 3 1 1 0	(92) CRITICAL FEATURE INSPECTION	(93) CFI DATE
(2) HIGHWAY AGENCY	10 (3) COUNTY CODE 111	A. FRACTURE CRITICAL DETAIL	N
(4) PLACE CODE	00000	B. UNDERWATER INSPECTION	N
(6) FEATURES INTERSECTED	ENGLAND CR	C. OTHER SPECIAL	N
(7) FACILITY CARRIED	SH 1-15- LM 6.31		
(9) LOCATION	2.1 MI SO JCT SH 14		
(11) MILEPOINT 6.310	(12) BASE HIGHWAY NETWORK 1		
(13A) LRS INVENTORY ROUTE	0000001150 (13B) SUBROUTE NUMBER 01		
(16) LATITUDE 35.53548	(17) LONGITUDE -90.72284		
(98A) BORDER BRIDGE CODE			
PERCENT RESPONSIBILITY	(99) BORDER BRIDGE STRUCT		
STRUCTURE TYPE AND MATERIAL		CONDITION	
(43) STRUCTURE TYPE, MAIN		(58) DECK	6
A) KIND OF MATERIAL/DESIGN: 1 - Concrete		(59) SUPERSTRUCTURE	6 (60) SUBSTRUCTURE 5
B) TYPE OF DESIGN/CONSTR: 01 - Slab		(61) CHANNEL & CHANNEL PROTECTION	5 (62) CULVERT N
(44) STRUCTURE TYPE, APPROACH SPANS			
A) KIND OF MATERIAL/DESIGN: 0 - Other			
B) TYPE OF DESIGN/CONSTR: 00 - Other			
(45) NUMBER OF SPANS IN MAIN	4 (46) NUMBER OF APPROACH	0	
(107) DECK STRUCTURE TYPE	1 (108A) WEARING SURFACE	6	
(108B) DECK MEMBRANE	0 (108C) DECK PROTECTION	0	
AGE OF SERVICE		LOAD RATING AND POSTING	
(27) YEAR BUILT	1954 (106) YEAR RECONSTRUCTED	0000	
(42) TYPE OF SERVICE	ON 1 UNDER 5	(31) DESIGN LOAD 4	
(28) LANES	ON 02 UNDER 00	(63) METHOD USED TO DETERMINE OPERATING RATING	
(29) AVERAGE DAILY TRAFFIC	4200 (19) BYPASS DETOUR LENGTH	24	
(30) YEAR OF AVERAGE DAILY TRAFFIC	2014	(64) OPERATING RATING 47.0	
(109) AVERAGE DAILY TRUCK TRAFFIC	1	(65) METHOD USED TO DETERMINE INVENTORY RATING	
		1	
		(66) INVENTORY RATING 28.0	
		(70) BRIDGE POSTING 5	
		(41) STRUCTURE OPEN/POSTED/CLOSED A	
GEOMETRIC DATA		APPRAISAL	
(48) LENGTH OF MAX SPAN (ft.)	25 (49) STRUCTURE LENGTH (ft.)	5	
(50) CURB/SIDEWALK WIDTHS (ft.)	LEFT 1.4 RIGHT 1.4	(67) STRUCTURAL EVALUATION	
(51) BRDG RDWY WIDTH CURB-TO-CURB (ft.)	25.9	5	
(52) DECK WIDTH, OUT-TO-OUT (ft.)	29.5	(68) DECK GEOMETRY 3	
(32) APPROACH ROADWAY WIDTH (ft.)	28.9	(69) UNDERCLEARANCES, VERTICAL & HORIZONTAL	
(33) BRIDGE MEDIAN	0 (34) SKEW (DEG.)	N	
(35) STRUCTURE FLARED	0 (10) INV RTE, MIN VERT CLEAR (ft.)	99.99	
(47) TOTAL HORIZONTAL CLEARANCE (ft.)	25.9	(71) WATERWAY ADEQUACY 6	
(53) VERTICAL CLEARANCE OVER BRIDGE ROADWAY (ft.)	99.99	(72) APPROACH ROADWAY ALIGNMENT 8	
(54) VERTICAL UNDER CLEARANCE (ft.)	N 0	(36) TRAFFIC SAFETY FEATURE	
(55) LATERAL UNDER CLEARANCE RIGHT (ft.)	N 99.9	36A) BRIDGE RAILINGS: 0	
(56) MIN LATERAL UNDER CLEARANCE (ft.)	0	36B) TRANSITIONS: 0	
		36C) APPROACH GUARDRAIL: 0	
		36D) APPROACH GUARDRAIL ENDS: 0	
		(113) SCOUR CRITICAL BRIDGES 5	
		SUFFICIENCY RATING 47.6 STATUS 2	
PROPOSED IMPROVEMENTS		CLASSIFICATION	
(75A) TYPE OF WORK PROPOSED	31 (75B) WORK DONE BY	1	
(76) LENGTH OF STRUCTURE IMPROVEMENT (ft.)	127.0	(112) NBIS BRIDGE LENGTH Y	
(94) BRIDGE IMPROVEMENT COST (\$)	0	(104) HIGHWAY SYSTEM OF THE INVENTORY ROUTE	
(95) ROADWAY IMPROVEMENT COST (\$)	400	1	
(96) TOTAL PROJECT COST	944	(26) FUNCTIONAL CLASSIFICATION OF INVENTORY ROUTE	
(97) YEAR OF IMPROVEMENT COST ESTIMATE	2002	02	
(114) FUTURE ADT	4346 (115) YEAR OF FUTURE ADT	2028	
		(100) STRAHNET HIGHWAY DESIGNATION 0	
		(101) PARALLEL STRUCTURE DESIGNATION N	
		(102) DIRECTION OF TRAFFIC 2	
		(103) TEMP STRUCTURE	
		(105) FEDERAL LANDS HIGHWAYS 0	
		(110) DESIGNATED NATIONAL NETWORK 0	
		(20) TOLL 3	
		(21) MAINTENANCE RESPONSIBILITY 01	
		(22) OWNER 01	
		(37) HISTORICAL 5	
NAVIGATION DATA			
		(38) NAVIGATION CONTROL 0	
		(111) PIER OR ABUTMENT PROTECTION 5	
		(39) NAV VERT CLEARANCE (ft.) 0	
		(116) MIN NAVIGATION VERT CLEARANCE, VERT LIFT BRIDGE (ft.) 0	
		(40) NAV HORIZONTAL CLEARANCE (ft.) 0	

Inspector:

Structure Number: 00734

Inspection Date:

Facility Carried: SH 1-15- LM 6.31

Bridge Inspection Report

Element Inspection

	Environment	Total Quantity	Units	Condition State 1	Condition State 2	Condition State 3	Condition State 4
38 - Reinforced Concrete Slab	1- Ben.	2950	sq. ft.	2813	122	15	0
1080 - Delamination/Spall/Patched Area		16			16		
1090 - Exposed Rebar		14				14	
1120 - Efflorescence/Rust Staining		57			56	1	
1130 - Cracking (RC and Other)		50			50		
510 - Wearing Surfaces		2600	sq. ft.	2037	0	563	0
3210 - Delamination/Spall/Patched Area/Pothole (Wearing Surfaces)		347				347	
3220 - Crack (Wearing Surface)		216				216	
227 - Reinforced Concrete Pile	1- Ben.	12	each	10	2	0	0
1120 - Efflorescence/Rust Staining		1			1		
1130 - Cracking (RC and Other)		1			1		
234 - Reinforced Concrete Pier Cap	1- Ben.	166	ft.	115	16	35	0
1080 - Delamination/Spall/Patched Area		12			11	1	
1090 - Exposed Rebar		31				31	
1120 - Efflorescence/Rust Staining		3				3	
1130 - Cracking (RC and Other)		5			5		
301 - Pourable Joint Seal	1- Ben.	78	ft.	78			
Not visible for inspection							
330 - Metal Bridge Railing	1- Ben.	200	ft.	0	200	0	0
1000 - Corrosion		200			200		

Inspection Date:

Facility Carried: SH 1-15- LM 6.31

Bridge Inspection Report

Pictures

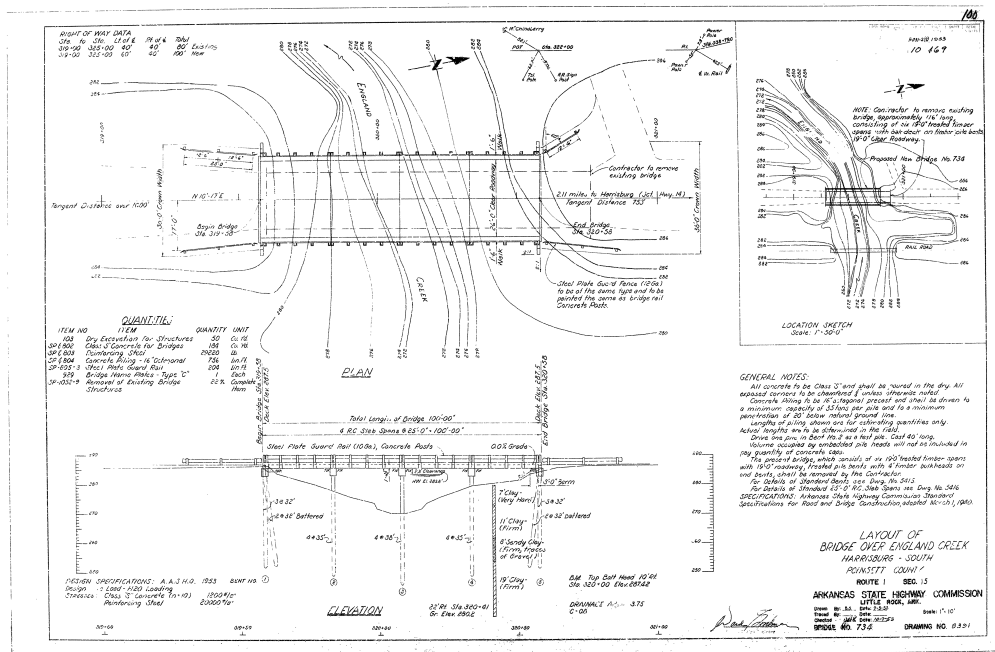

PHOTO 1

Description Layout View

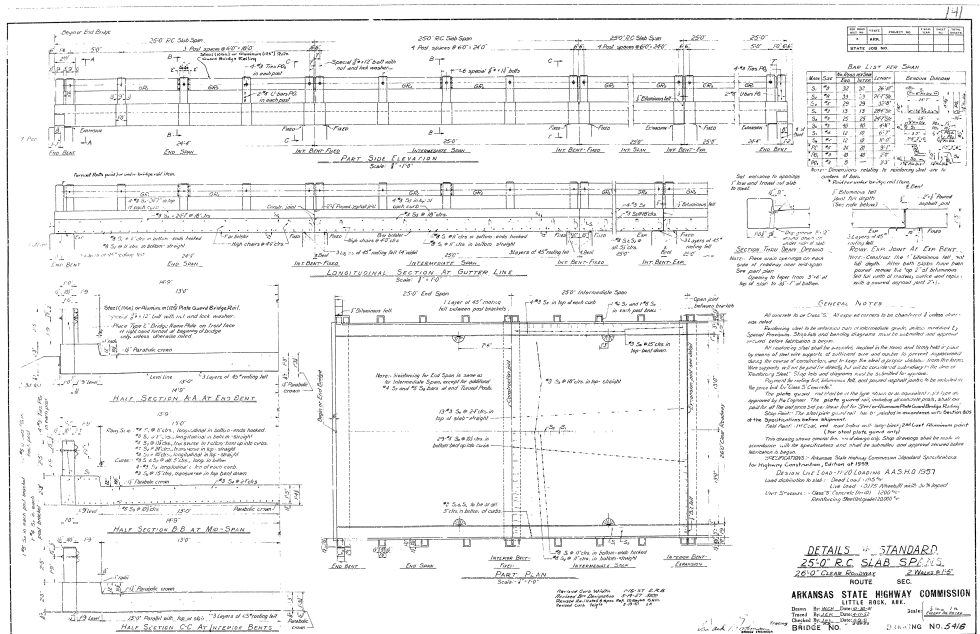

PHOTO 2

Description	Cross Section View
1. Base Plate The base plate is the bottom-most layer, providing a stable foundation for the entire structure. It is typically made of a rigid material like metal or plastic.	
2. Insulation Layer A layer of insulating material is placed on top of the base plate to reduce heat loss and maintain a consistent temperature within the structure.	
3. Structural Frame The structural frame is the central support structure, often made of metal or wood, which holds the internal components in place and provides structural integrity.	
4. Internal Components These are the various parts and assemblies located inside the structure, such as wiring, sensors, or mechanical parts, which perform the specific functions of the system.	
5. Outer Enclosure The outer enclosure is the final protective layer, often made of a durable material like metal or plastic, which shields the internal components from environmental factors and provides a finished appearance.	

Inspector:

Inspection Date:

Structure Number: 00734

Facility Carried: SH 1-15- LM 6.31

Bridge Inspection Report

Sketches

Inspector:

Structure Number: 00734

Inspection Date:

Facility Carried: SH 1-15- LM 6.31

Bridge Inspection Report

Maintenance Needs

Date Reported: 6/18/2012 12:00:00 AM

Priority: C - Important

Work Code:

Deficiency Description:

Wearing surface has several cracked, spalled and delaminated areas along joints and gutterlines.

Work Description:

Date Repairs Completed:

Maintenance Comments:

Stage: Monitor



PHOTO 1 Description

Stage: Monitor



PHOTO 2 Description

Inspector:

Structure Number: 00734

Inspection Date:

Facility Carried: SH 1-15- LM 6.31

Bridge Inspection Report

Maintenance Needs

Date Reported: 6/18/2012 12:00:00 AM

Priority: D - Routine

Work Code:

Deficiency Description:

Soffit has longitudinal cracks with some efflorescence near center line. Soffit has cracked and/or delaminated areas near drain openings and a few spalls with rebar exposed.

Work Description:

Date Repairs Completed:

Maintenance Comments:

Inspector:

Structure Number: 00734

Inspection Date:

Facility Carried: SH 1-15- LM 6.31

Bridge Inspection Report

Maintenance Needs

Date Reported: 6/18/2012 12:00:00 AM

Priority: D - Routine

Work Code:

Deficiency Description:

Bent 1 has a 1.5' spall and 1' of delamination.

Bents 2 – 4 caps have several cracks, delaminated areas, and spalls with rebar exposed.

Work Description:

Date Repairs Completed:

Maintenance Comments:

Stage: Monitor



PHOTO 1 Description

Inspector:

Structure Number: 00734

Inspection Date:

Facility Carried: SH 1-15- LM 6.31

Bridge Inspection Report

Maintenance Needs

Date Reported: 6/11/2014 12:00:00 AM

Priority: D - Routine

Work Code:

Deficiency Description:

Deck has debris and vegetation in gutterlines.

Work Description:

Date Repairs Completed:

Maintenance Comments:

Inspector:

Structure Number: 00734

Inspection Date:

Facility Carried: SH 1-15- LM 6.31

Bridge Inspection Report

Maintenance Needs

Date Reported: 6/11/2014 12:00:00 AM

Priority: D - Routine

Work Code:

Deficiency Description:

Embankment under spans 1 and 4 has some erosion.

Work Description:

Date Repairs Completed:

Maintenance Comments:

Stage: Monitor



PHOTO 1 Description

Inspector:

Structure Number: 00734

Inspection Date:

Facility Carried: SH 1-15- LM 6.31

Bridge Inspection Report

Maintenance Needs

Date Reported: 05/24/2018

Priority: D - Routine

Work Code:

Deficiency Description:

Approach roadway has settlement at bent 5 end.

Work Description:

Date Repairs Completed:

Maintenance Comments:

Inspector:

Structure Number: 00734

Inspection Date:

Facility Carried: SH 1-15- LM 6.31

Bridge Inspection Report

Maintenance Needs

Date Reported: 05/24/2018

Priority: C - Important

Work Code:

Deficiency Description:

Bent 5 Lt approach rail has collision damage.

Work Description:

Date Repairs Completed:

Maintenance Comments:

repair parts have been ordered. KAW 1/23/2018

Stage: Open



PHOTO 1 Description