

LEGEND

- COUNTY BOUNDARY
- U.S. LAND TOWNSHIP LINE
- SECTION LINE
- PAVED STATE OR U.S. HIGHWAY
- U.S. NUMBERED HIGHWAY
- STATE HIGHWAY
- PAVED LOCAL ROAD
- GRAVEL LOCAL ROAD
- GRAVEL & DRAINED LOCAL ROAD
- UNIMPROVED LOCAL ROAD
- RAILROAD (WIDE SPACING TRACKS)
- RAILROAD STATION
- GRADE CROSSING
- OVERPASS
- UNDERPASS
- HIGHWAY BRIDGE (60 FEET OR MORE IN LENGTH)
- PAVED FORD OR LOW WATER BRIDGE
- LEVEE OR DIKE
- LEVEE WITH ROAD
- MILEAGE BETWEEN POINTS
- LAKE, RESERVOIR OR POND
- LAKE, RESERVOIR OR POND WITH DAM
- MARSH OR SWAMP
- WIDE RIVER OR STREAM
- DOCK, PIER OR LANDING
- NAVIGABLE STREAM
- DAM WITH LOCK
- SMALL STREAM
- DRAINAGE DITCH
- CORPORATE LIMITS AND ROADS THROUGH TOWN
- COUNTY SEAT
- OTHER CITIES AND TOWNS
- MUNICIPAL AIRPORT
- FARM UNIT OR DWELLING
- GROUP OF CLOSELY SPACED DWELLINGS (if no figure shown)
- CHURCH OR OTHER RELIGIOUS INSTITUTION
- SCHOOL
- CEMETERY
- CHURCH WITH CEMETERY ADJACENT
- BUSINESS ESTABLISHMENT
- FACTORY OR INDUSTRIAL PLANT-COTTON GN
- SAWMILL
- FIRE ENGINE HOUSE
- GRAVEL PIT
- QUARRY
- RADIO OR TELEVISION STATION AND CALL LETTERS
- A.H.T.O. GARAGE OR COUNTY GARAGE
- TRAILER PARK
- POWER SUBSTATION
- PUMPING STATION, OIL OR GAS
- OBSERVATION OR LOOKOUT TOWER
- CAMP OR LODGE
- SMALL PARK (STATE, COUNTY, MUNICIPAL, PRIVATE, UNRESTRICTED AREA)
- WATER SUPPLY STANDPIPE OR TANK
- SEWAGE DISPOSAL PLANT
- GARBAGE DUMP OR SANITARY LANDFILL
- CHICKEN HOUSE OR OTHER LIVESTOCK

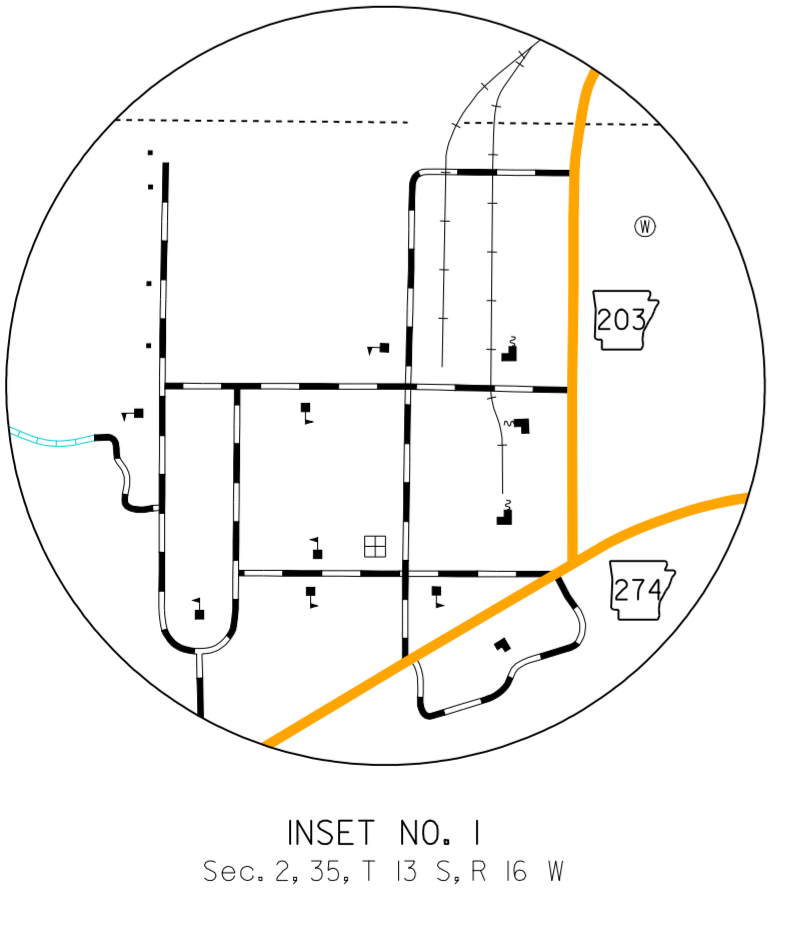

INSET NO. 1
Sec. 2, 35, T 13 S, R 16 W

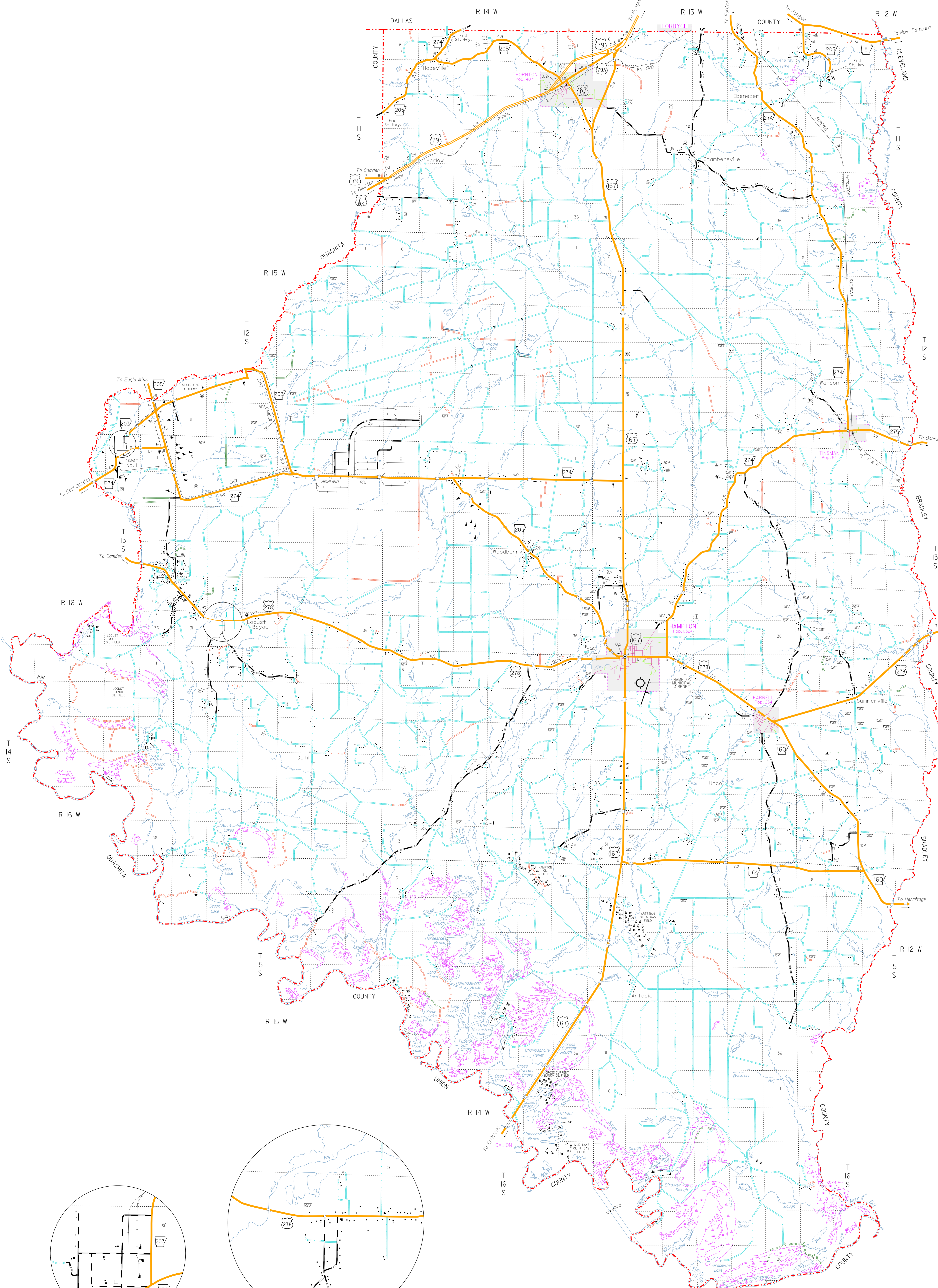
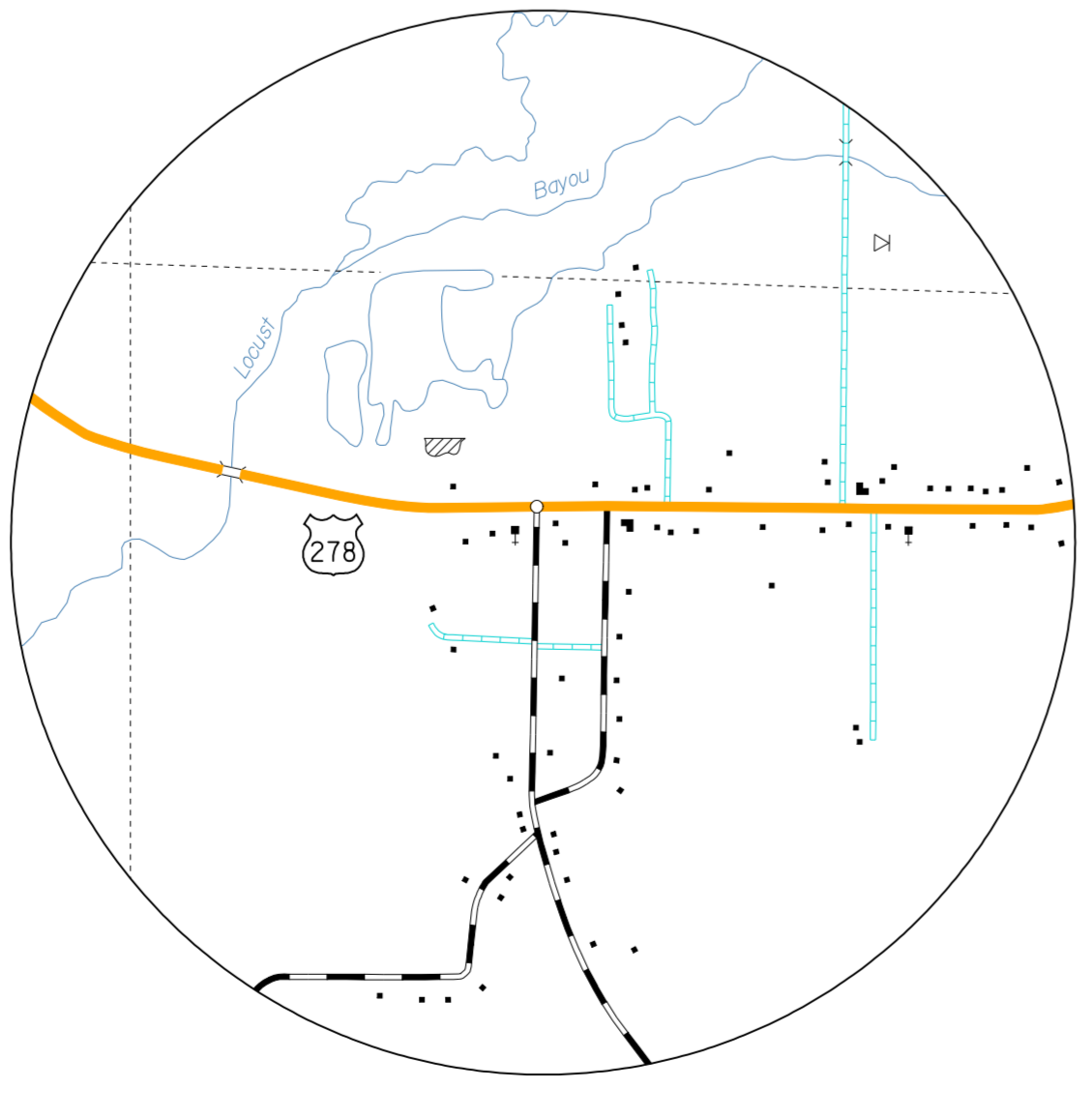

LOCUST BAYOU
Sec. 29, 32, T 13 S, R 15 W

NOTES: Enlargements of all congested areas are five times map scale unless otherwise noted.
 Individual maps are available for all active incorporated cities.
 Area: 433 square miles
 Population: 5,368 (2000 Census)
 Map Issued: 9-30-99, replaces map issued 6-6-89
 Field Inventory: 87%
 Map revisions made from aerial photographs taken 2-4-97
 Map compilation completed 8-29-99
 County map produced using Computer Assisted Cartography.

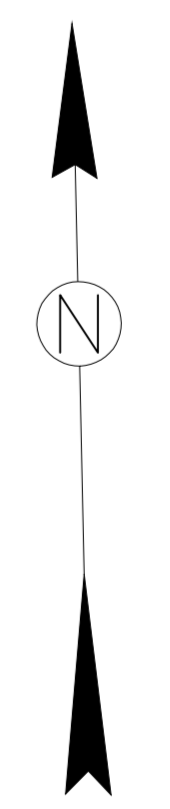

GENERAL HIGHWAY MAP
CALHOUN COUNTY
 ARKANSAS

PREPARED BY
 ARKANSAS STATE HIGHWAY AND TRANSPORTATION DEPARTMENT
 PLANNING AND RESEARCH DIVISION
 IN COOPERATION WITH
 U.S. DEPARTMENT OF TRANSPORTATION
 FEDERAL HIGHWAY ADMINISTRATION
 SCALE: 1:62,500
 MILES
 KILOMETERS

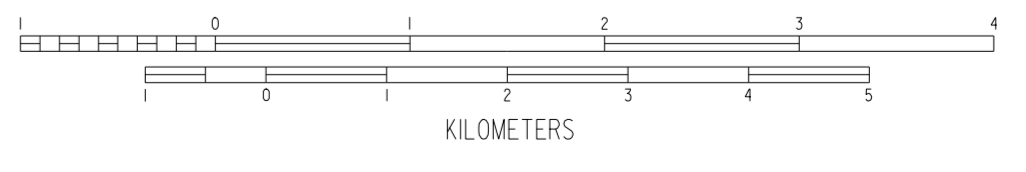

Copies of this map are available at a nominal fee from the Arkansas State Highway and Transportation Department, P.O. Box 226 Little Rock, AR 72203

