

AREA SOUTH OF PRATTSVILLE  
Sec. 1, 2, 3, 4, 5, R 14 W  
Sec. 12, 13, 14, 15, R 15 W

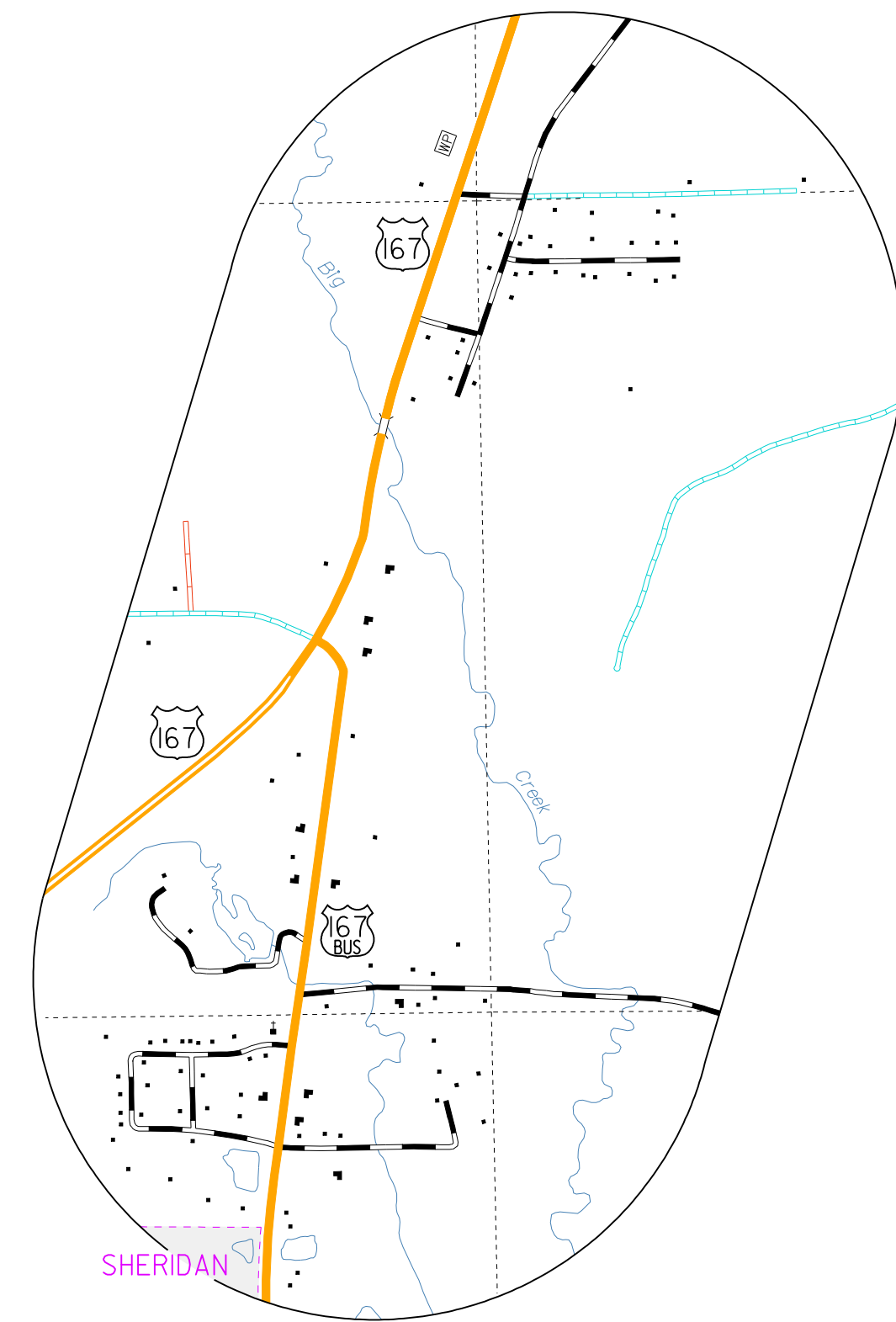

INSET NO. 2  
Sec. 22, 23, 26, 27, 34, 35, T 4 S, R 13 W

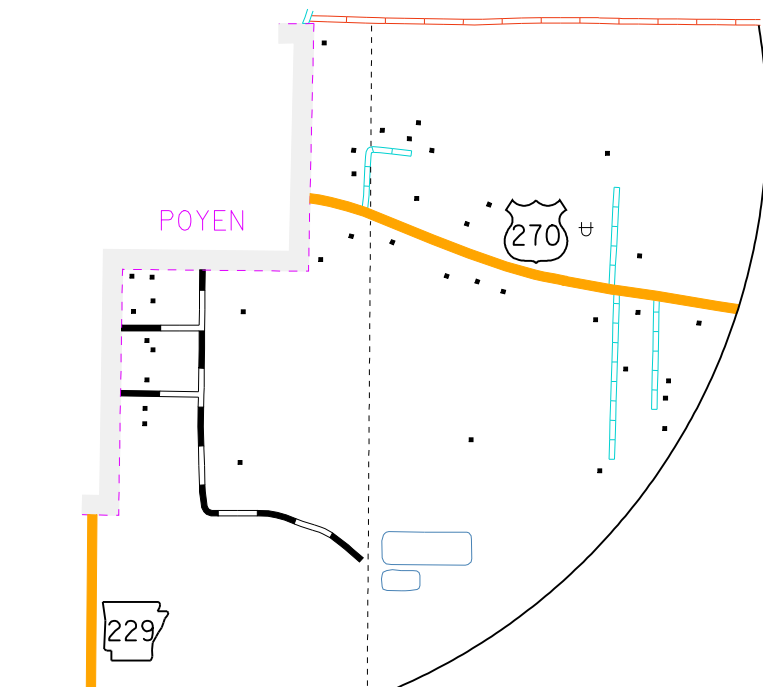

AREA EAST OF SHERIDAN  
Sec. 35, 36, T 4 S, R 13 W  
Sec. 1, 2, 11, 12, 13, 14, 15, R 13 W

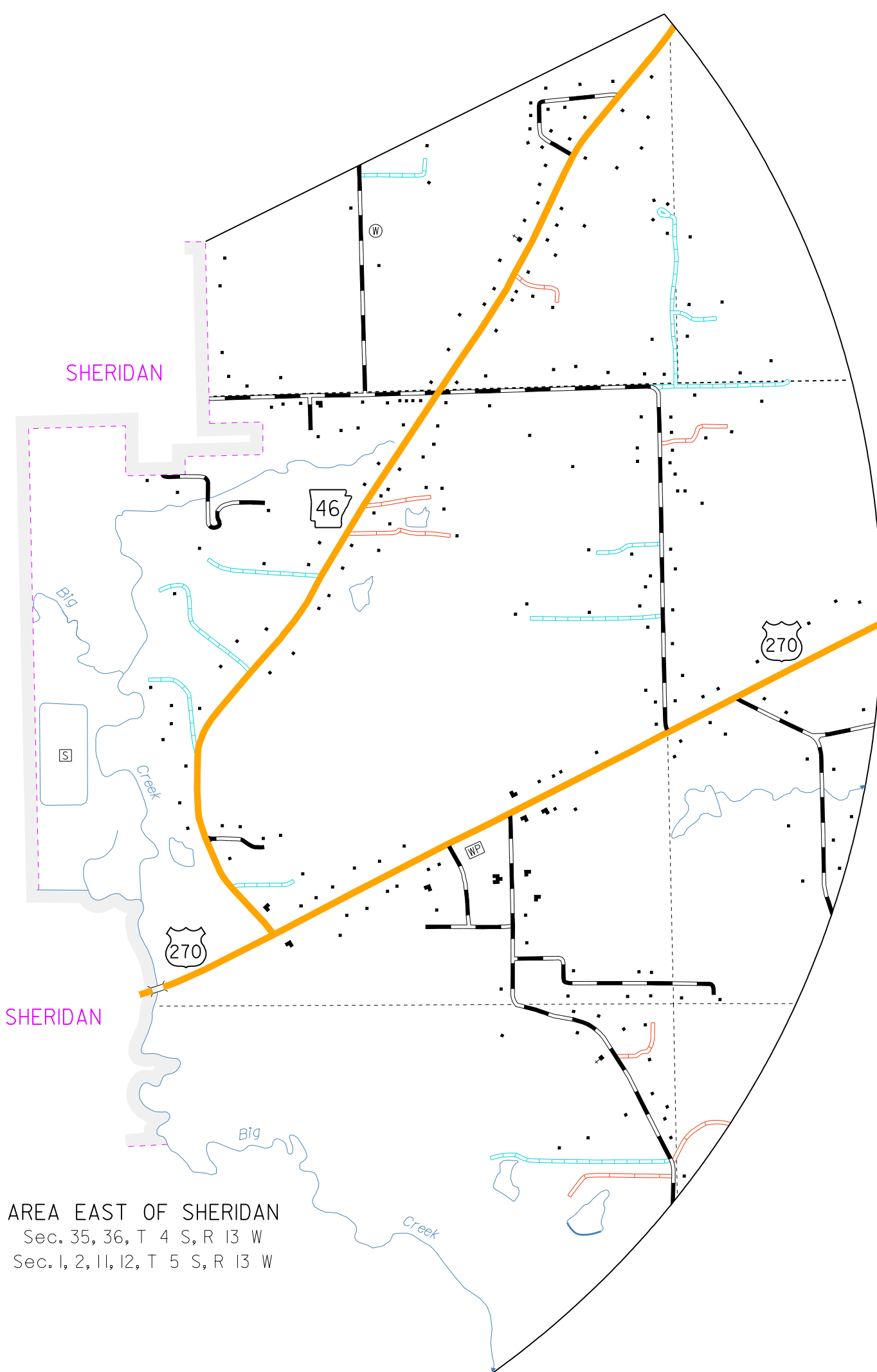

AREA EAST OF SHERIDAN  
Sec. 35, 36, T 4 S, R 13 W  
Sec. 1, 2, 11, 12, 13, 14, 15, R 13 W

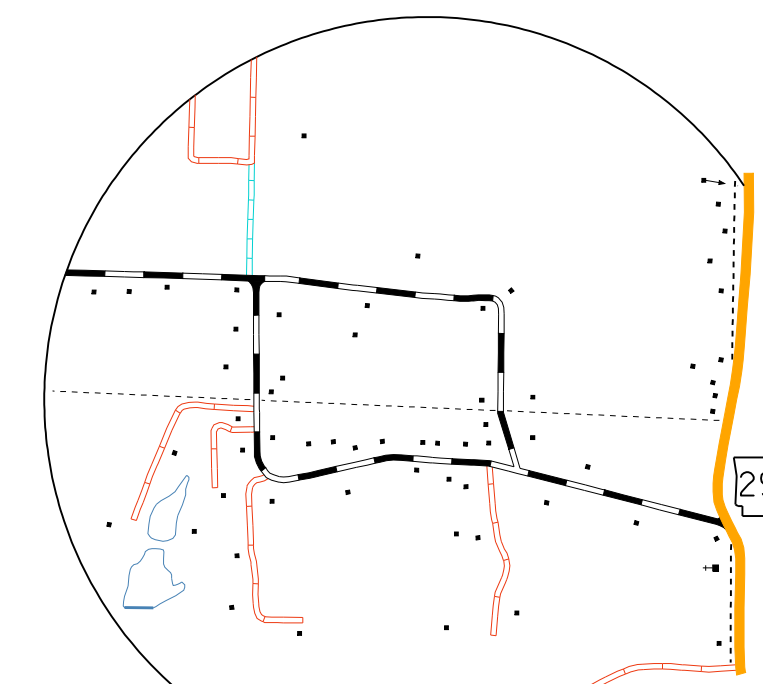

INSET NO. 4  
Sec. 24, 25, T 4 S, R 15 W

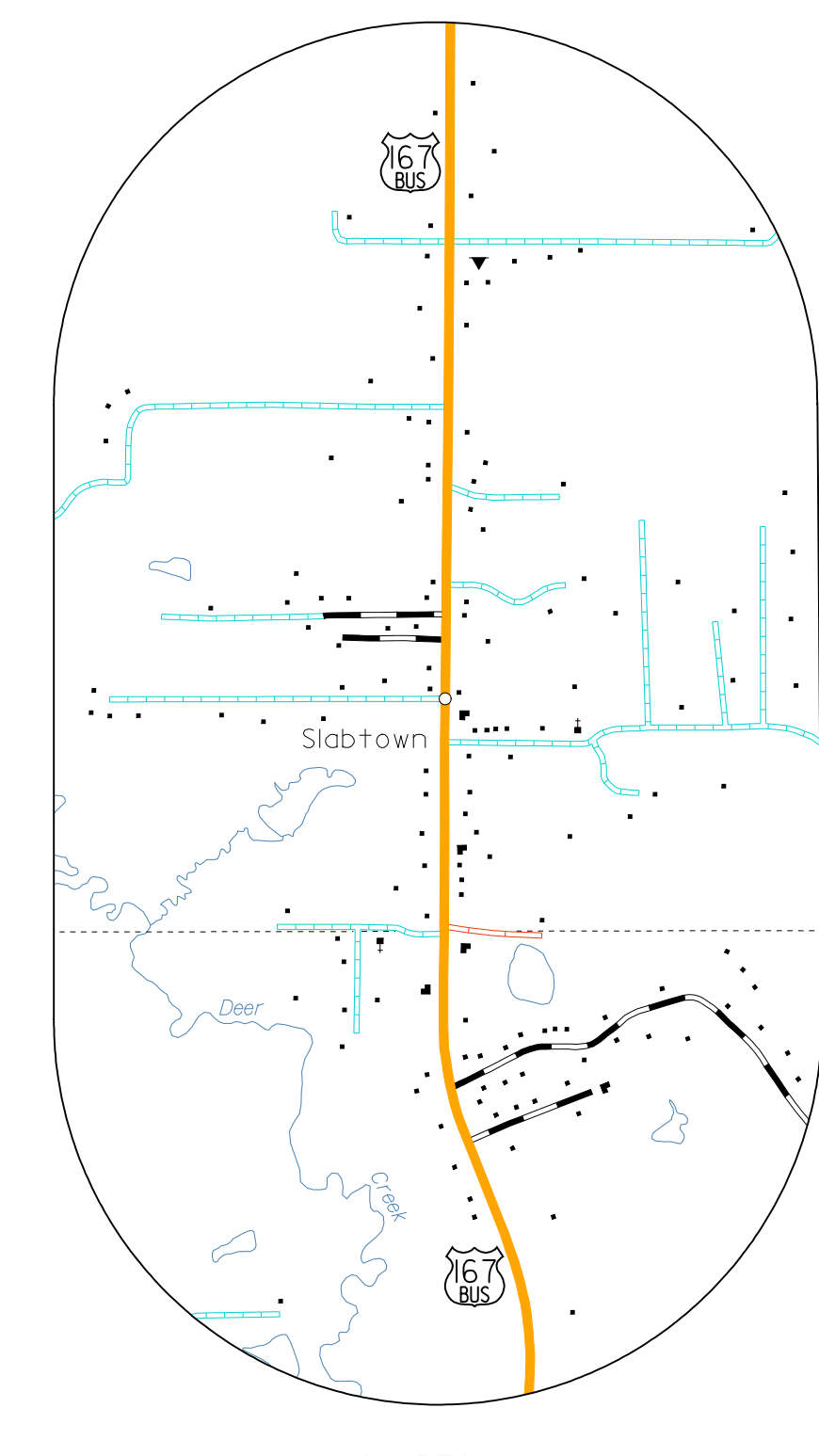

SLABTOWN  
Sec. 22, 27, T 5 S, R 13 W

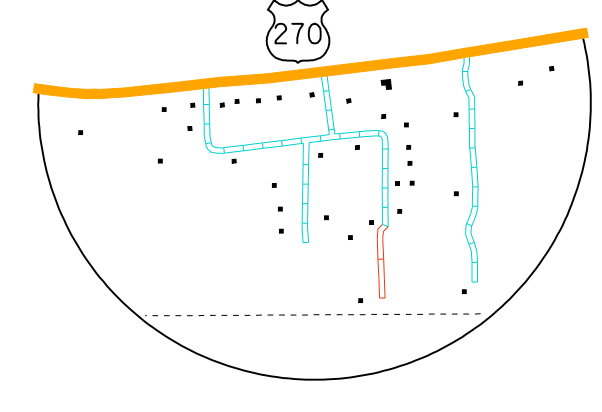

INSET NO. 3  
Sec. 6, 7, T 5 S, R 13 W

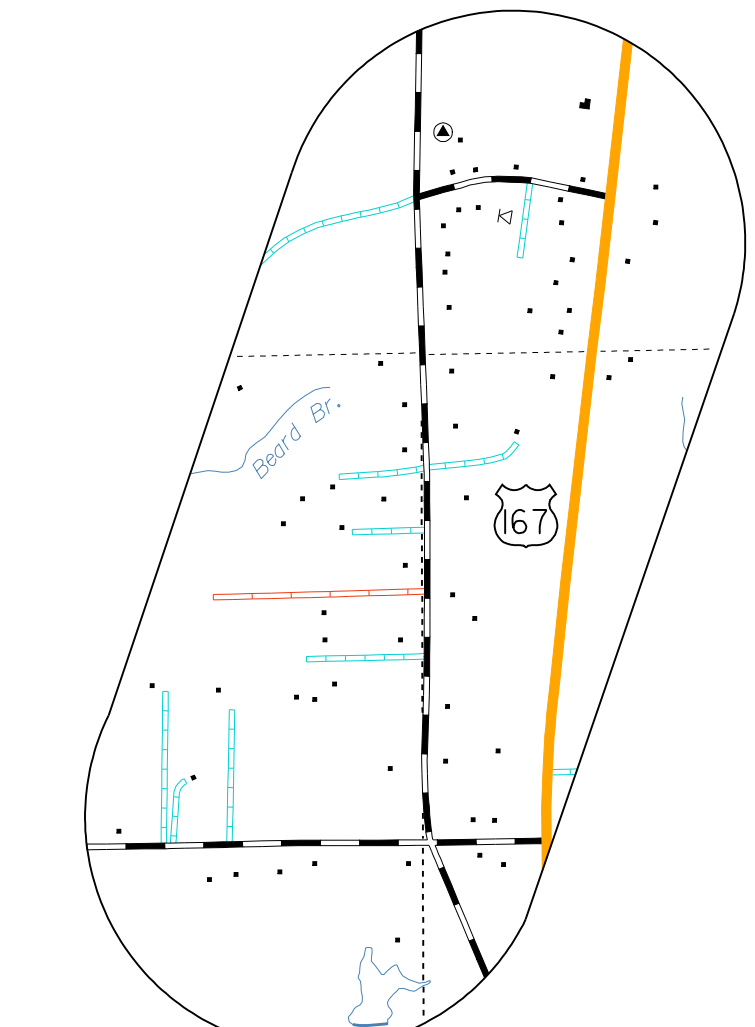
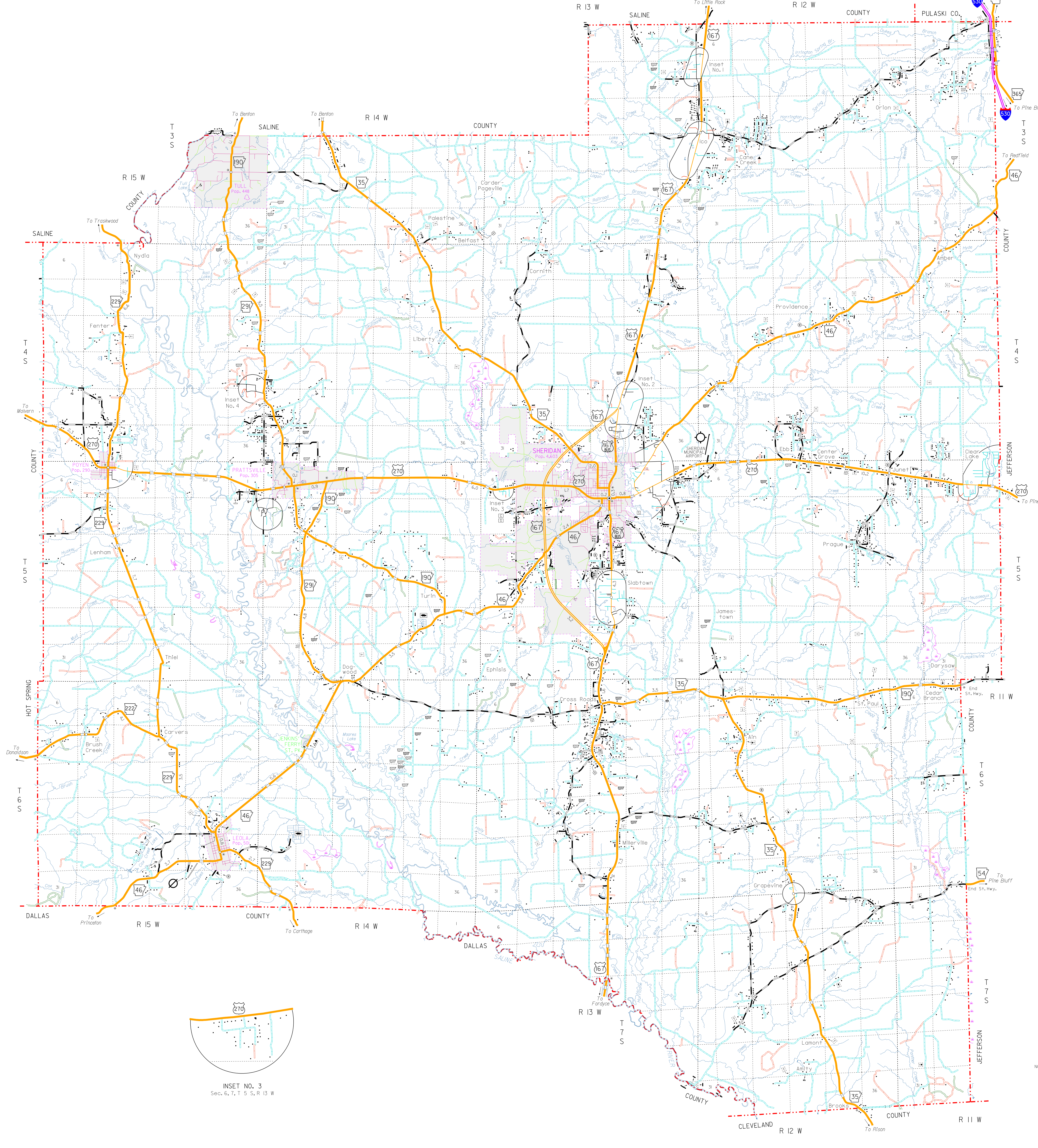

INSET NO. 2  
Sec. 6, 7, T 5 S, R 12 W  
Sec. 1, 2, 3, 4, 5, R 13 W

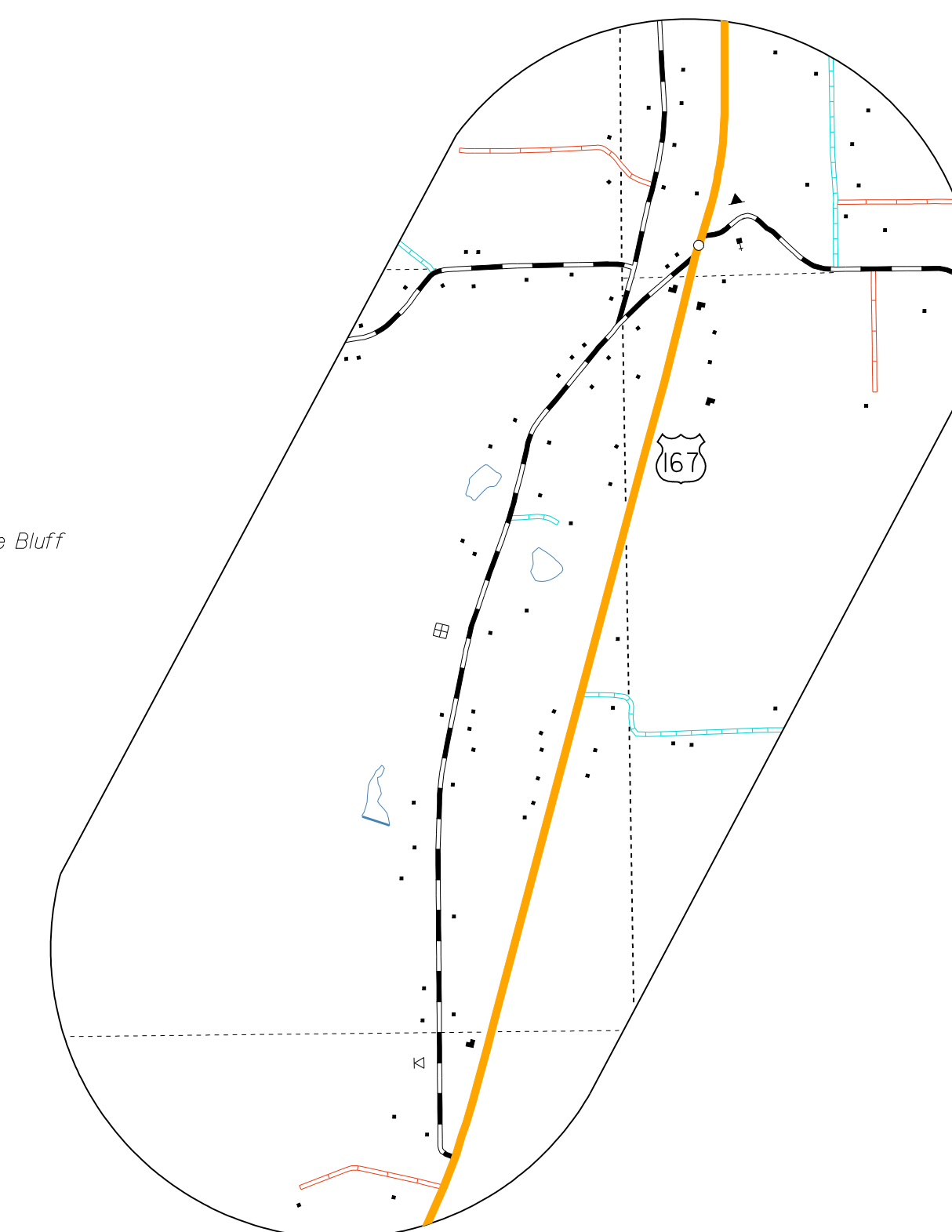

ICO  
Sec. 18, 19, T 3 S, R 12 W  
Sec. 13, 24, 25, T 3 S, R 13 W

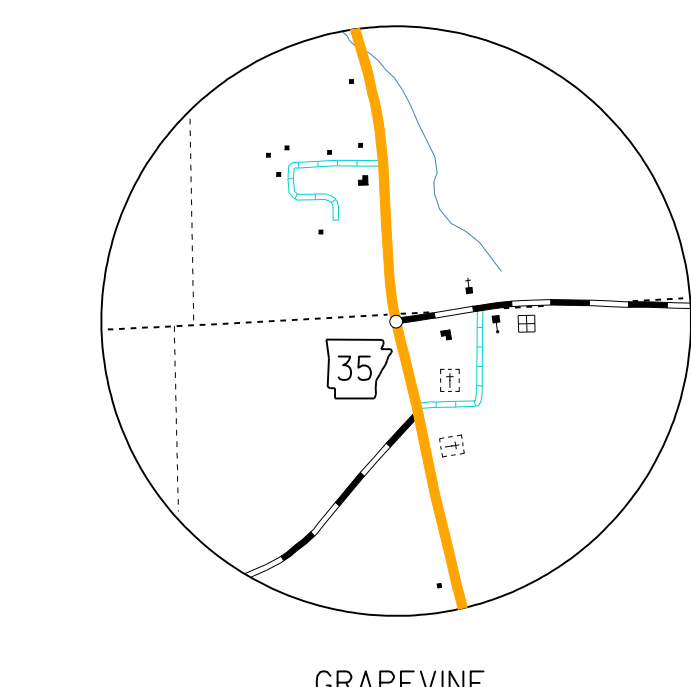

GRAPEVINE  
Sec. 33, 34, T 6 S, R 12 W  
Sec. 3, 4, T 7 S, R 12 W

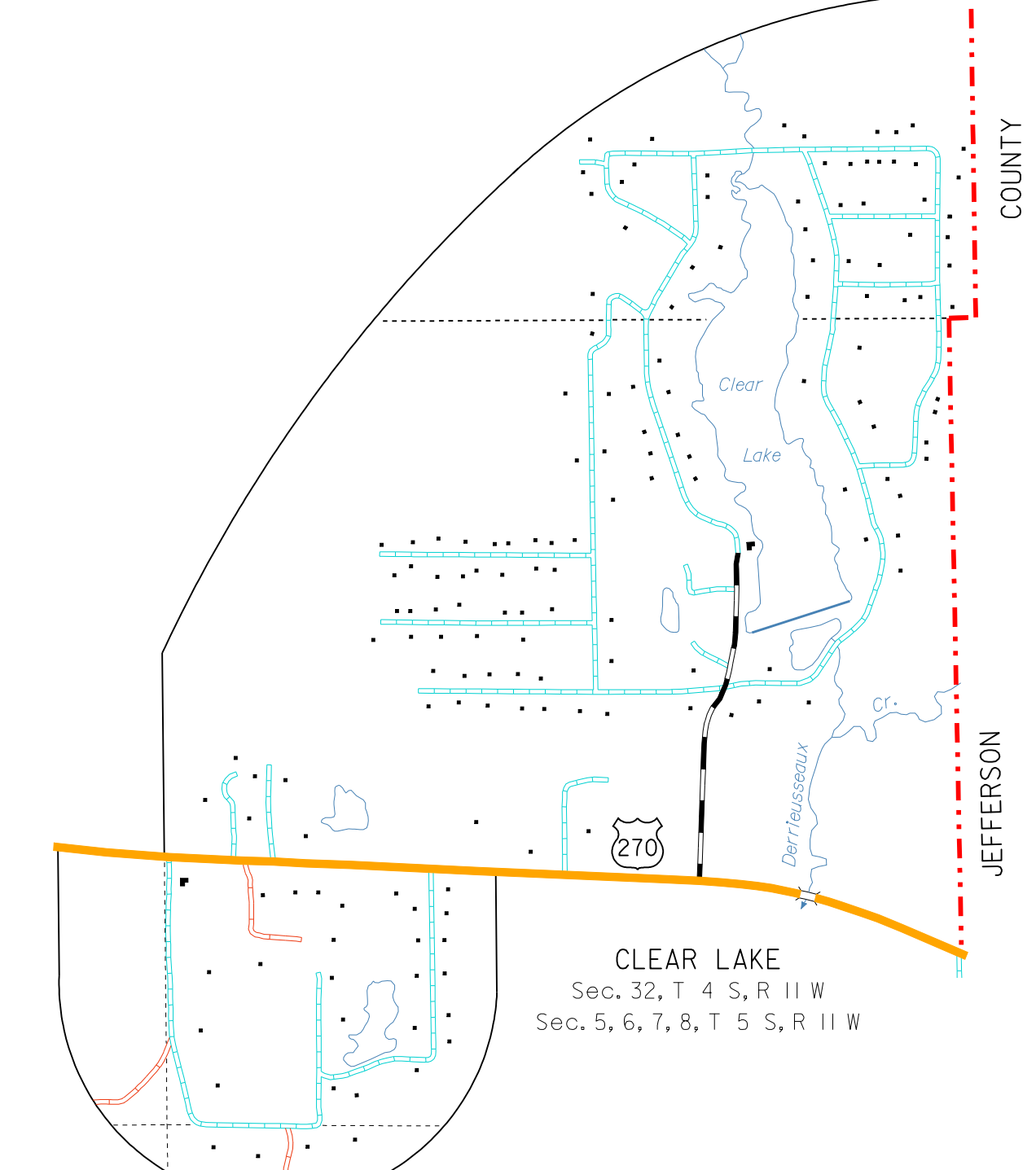

CLEAR LAKE  
Sec. 32, T 4 S, R 11 W  
Sec. 5, 6, 7, 8, T 5 S, R 11 W

- LEGEND**
- COUNTY BOUNDARY
  - U.S. LAND TOWNSHIP LINE
  - SECTION LINE
  - PARK OR RESERVATION BOUNDARY
  - PAVED STATE OR U.S. HIGHWAY
  - DIVIDED HIGHWAY (SEE KEY FOR WIDTH OF ROAD)
  - INTERSTATE HIGHWAY
  - U.S. NUMBERED HIGHWAY
  - STATE HIGHWAY
  - PAVED LOCAL ROAD
  - GRAVEL LOCAL ROAD
  - GRADED & DRAINED LOCAL ROAD
  - UNIMPROVED LOCAL ROAD
  - HIGHWAY BRIDGE (SEE KEY FOR LENGTH)
  - MEILEAGE BETWEEN POINTS
  - LAKE, RESERVOIR OR POND
  - LAKE, RESERVOIR OR POND WITH DAM
  - MARSH OR SWAMP
  - WIDE RIVER OR STREAM
  - DOCK, PIER OR LANDING
  - HEAD OF NAVIGATION (SEE DEPARTMENT REGULATION)
  - SMALL STREAM
  - DRAINAGE DITCH
  - CORPORATE LIMITS AND ROADS THROUGH TOWN
  - COUNTY SEAT
  - OTHER CITIES AND TOWNS
  - MUNICIPAL AIRFIELD
  - PRIVATE AIRFIELD
  - FARM UNIT OR DWELLING
  - GROUP OF CLOSELY SPACED DWELLINGS (UP TO FIVE BUILT)
  - CHURCH OR OTHER RELIGIOUS INSTITUTION
  - SCHOOL
  - CEMETERY
  - CHURCH WITH CEMETERY ADJACENT
  - BUSINESS ESTABLISHMENT
  - FACTORY OR INDUSTRIAL PLANT
  - GRAVEL PIT QUARRY
  - A.H.T.O. GARAGE OR COUNTY GARAGE
  - MUSEUM, GENERAL
  - FIRE ENGINE HOUSE
  - Gauging or Pumping Station
  - POWER SUBSTATION
  - TRAILER PARK
  - FISH HATCHERY
  - OBSERVATION OR LOOKOUT TOWER
  - CAMP OR LODGE
  - GOLF COURSE OR COUNTRY CLUB
  - ATHLETIC FIELD
  - SMALL PARK (UP TO STATE, COUNTY, MUNICIPAL, OR PRIVATE TRACT AREA)
  - WATER SUPPLY STANDPIPE OR TANK
  - SEWAGE DISPOSAL PLANT
  - ARMORY
  - CHICKEN HOUSE OR OTHER LIVESTOCK
  - PICNIC GROUND

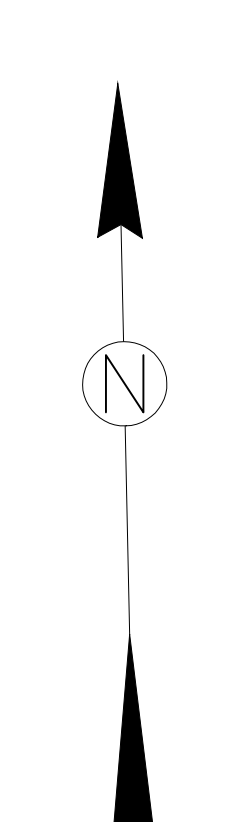

GENERAL HIGHWAY MAP  
**GRANT COUNTY**  
ARKANSAS

PREPARED BY  
ARKANSAS STATE HIGHWAY AND TRANSPORTATION DEPARTMENT  
PLANNING AND RESEARCH DIVISION  
IN COOPERATION WITH  
U.S. DEPARTMENT OF TRANSPORTATION  
FEDERAL HIGHWAY ADMINISTRATION  
SCALE 62500  
MILES  
KILOMETERS

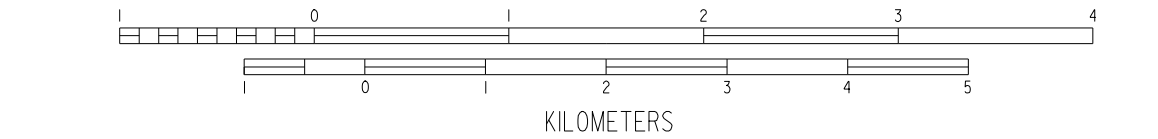

Notes: Enlargements of all congested areas are five times map scale unless otherwise noted.  
Individual maps are available for all active incorporated cities.  
Area-633 Square Miles  
Population-1283 - 2000 Census  
Map issued 11-20-07, replaces map issued 11-21-97  
Field Inventory 1978

