

- LEGEND**
- COUNTY BOUNDARY
 - U.S. LAND TOWNSHIP LINE
 - SECTION LINE
 - PARK OR RESERVATION BOUNDARY
 - PAVED STATE OR U.S. HIGHWAY
 - U.S. NUMBERED HIGHWAY
 - STATE HIGHWAY
 - PAVED LOCAL ROAD
 - GRAVEL LOCAL ROAD
 - GRADED & DRAINED LOCAL ROAD
 - UNIMPROVED LOCAL ROAD
 - RAILROAD
 - RAILROAD STATION
 - GRADE CROSSING
 - OVERPASS
 - UNDERPASS
 - HIGHWAY BRIDGE (60 FEET OR MORE IN LENGTH)
 - PAVED FORD OR LOW WATER BRIDGE
 - LEVEE OR DIKE
 - MILEAGE BETWEEN POINTS
 - LAKE, RESERVOIR OR POND
 - LAKE, RESERVOIR OR POND WITH DAM
 - MARSH OR SWAMP
 - NAVIGABLE STREAM
 - DOCK, PIER OR LANDING
 - SMALL STREAM
 - DRAINAGE DITCH
 - CORPORATE LIMITS AND ROADS THROUGH TOWN
 - COUNTY SEAT
 - OTHER CITIES AND TOWNS
 - MUNICIPAL AIRPORT
 - PRIVATE AIRFIELD
 - FARM UNIT OR DWELLING
 - GROUP OF CLOSELY SPACED DWELLINGS (e.g. FARM HOUSES)
 - APARTMENT COMPLEX OR MOTEL
 - CHURCH OR OTHER RELIGIOUS INSTITUTION
 - SCHOOL
 - POST OFFICE
 - POST OFFICE AND BUSINESS
 - CEMETERY
 - CHURCH WITH CEMETERY ADJACENT
 - BUSINESS ESTABLISHMENT
 - FACTORY OR INDUSTRIAL PLANT-COTTON GIN
 - SAMMIL
 - GRAVEL PIT
 - QUARRY
 - NURSERY
 - POWER PLANT
 - RADIO OR TELEVISION STATION AND CALL LETTERS
 - AUTO GARAGE OR COUNTY GARAGE
 - FIRE ENGINE HOUSE
 - POWER SUBSTATION
 - GRAN ELEVATOR
 - TRAILER PARK
 - PUMPING STATION, OIL OR GAS
 - OBSERVATION OR LOOKOUT TOWER
 - CAMP OR LODGE
 - ATHLETIC FIELD OR AMUSEMENT PARK
 - SMALL PARK (QUALITY OF COURSE, SWAMP, MARSH, OR BEST AREA)
 - WATER SUPPLY STANDPIPE OR TANK
 - SEWAGE DISPOSAL PLANT
 - FAIRGROUND, RACE COURSE OR SPEEDWAY
 - CHICKEN HOUSE OR OTHER LIVESTOCK

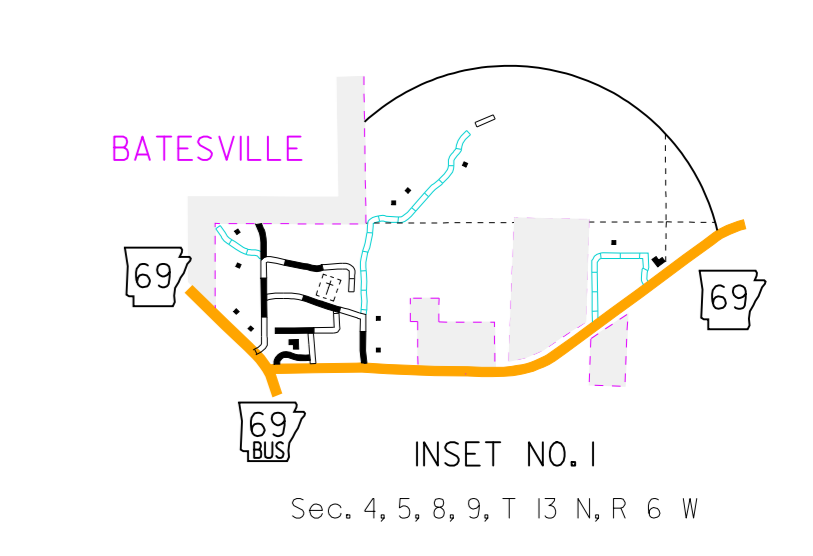

GENERAL HIGHWAY MAP
INDEPENDENCE COUNTY
 ARKANSAS

PREPARED BY
 ARKANSAS STATE HIGHWAY AND TRANSPORTATION DEPARTMENT
 TRANSPORTATION PLANNING AND POLICY DIVISION
 IN COOPERATION WITH
 U.S. DEPARTMENT OF TRANSPORTATION
 FEDERAL HIGHWAY ADMINISTRATION

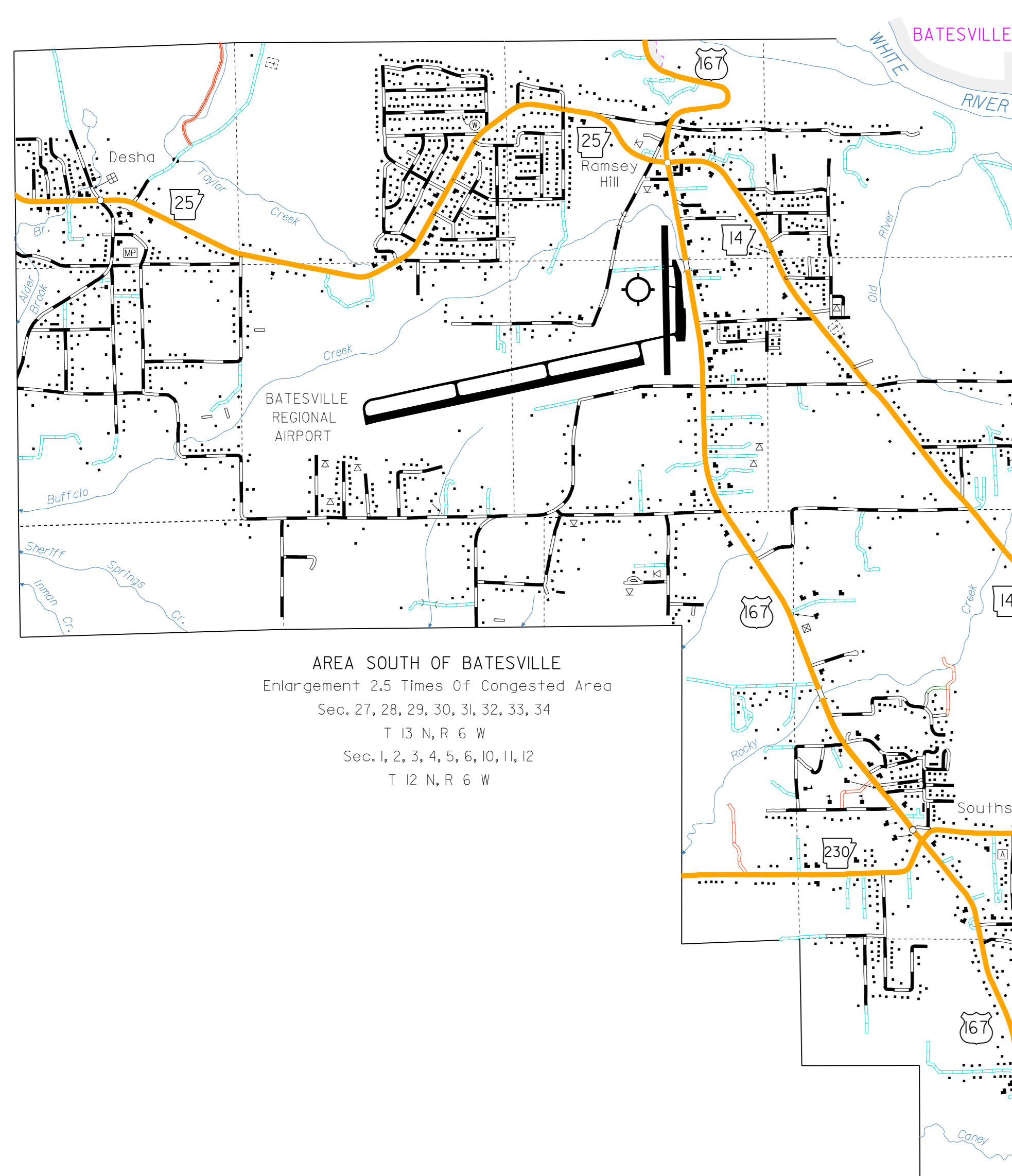
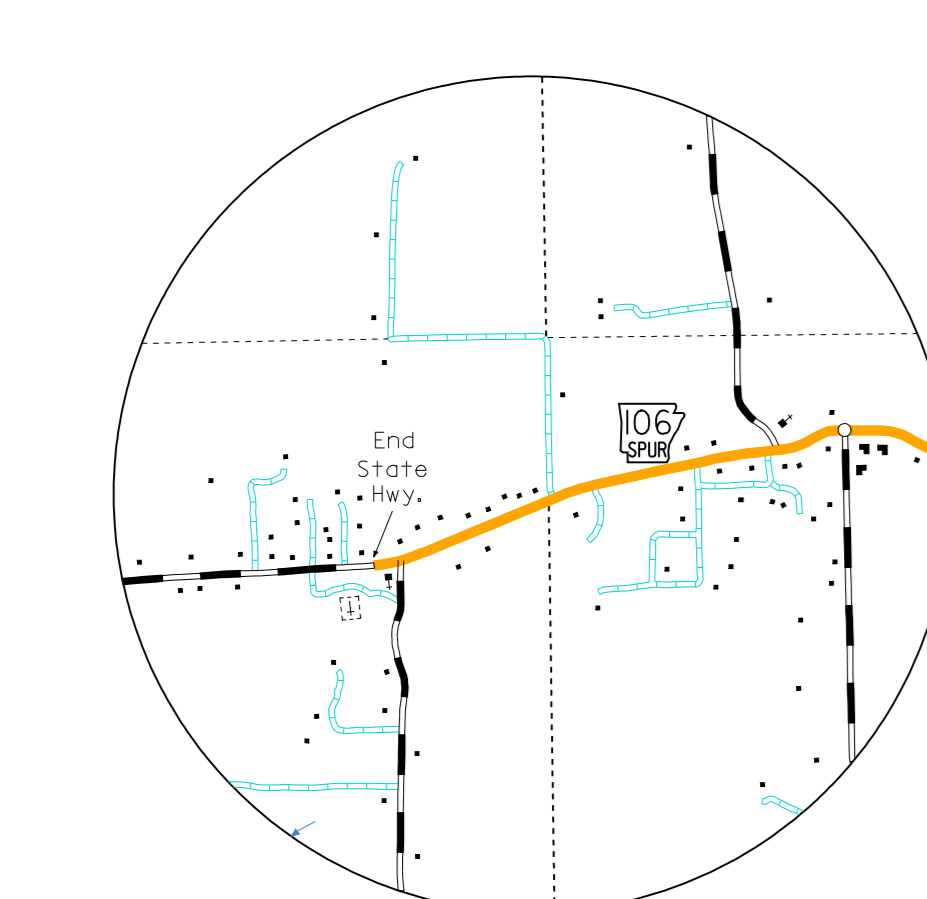
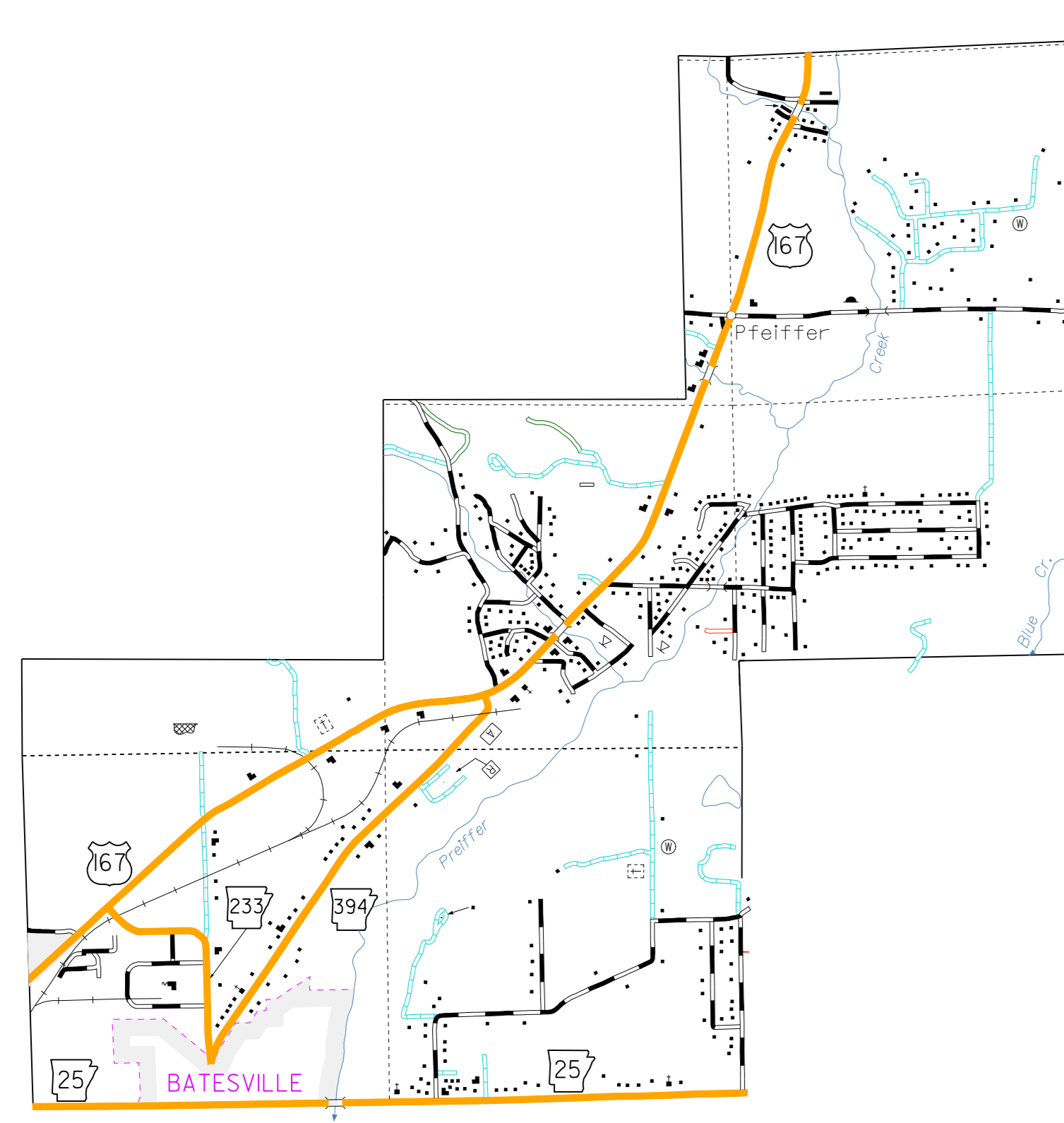
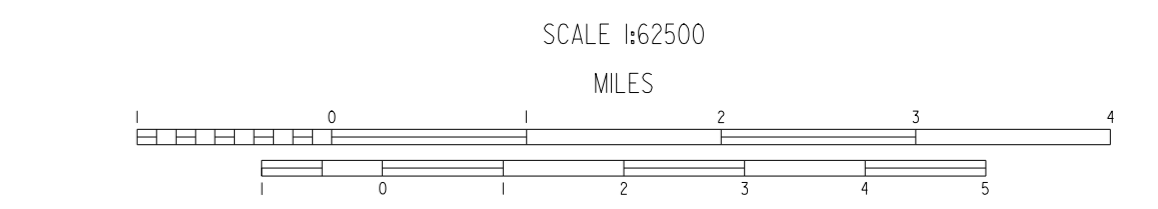

NOTE: Enlargements of all congested areas are three times map scale unless otherwise noted.
 Individual maps are available for all active incorporated cities.
 Area: 1741 Square Miles
 Population: 84,447, 2008 Census
 Map Issued: 01-04-04, reissues map issued 07-05-96
 Field Inventory: 9/85
 Map revisions made from aerial photographs taken 02-28-02
 Map compilation completed 02-01-04
 County map produced using Computer Aided Cartography.
 Map Revised: 01-04-06, S.H. 67, Section 4 mileage change.
 Map Revised: 01-31-04, intersection relocation on Hwy. 134 at Jct. Hwy. 167, S.H.
 Map Revised: 01-31-04, intersection relocation on Hwy. 233 at Jct. Hwy. 167, S.H.

Copies of this map are available at a nominal fee from the Arkansas State Highway and Transportation Department, P.O. Box 226, Little Rock, AR, 72203

