

- LEGEND**
- COUNTY BOUNDARY
 - U.S. LAND TOWNSHIP LINE
 - SECTION LINE
 - PARK OR RESERVATION BOUNDARY
 - PAVED STATE OR U.S. HIGHWAY
 - DIVIDED HIGHWAY (FORMERLY STATE ROAD)
 - U.S. NUMBERED HIGHWAY
 - STATE HIGHWAY
 - PAVED LOCAL ROAD
 - GRAVEL LOCAL ROAD
 - GRADED & DRAINED LOCAL ROAD
 - UNIMPROVED LOCAL ROAD
 - INTERCHANGE
 - RAILROAD (WITH NUMBER OF TRACKS USED BY RAILROAD STATICS)
 - GRADE CROSSING
 - OVERPASS
 - UNDERPASS
 - HIGHWAY BRIDGE (SEE KEY OR NOTE IN LEGEND)
 - MILEAGE BETWEEN POINTS
 - LAKE, RESERVOIR OR POND
 - LAKE, RESERVOIR OR POND WITH DAM
 - MARSH OR SWAMP
 - WIDE RIVER OR STREAM
 - DOCK, PIER OR LANDING
 - NAVIGABLE STREAM
 - INTERMITTENT NAVIGATION
 - HEAD OF NAVIGATION (SEE DEPARTMENT REGULATION)
 - SMALL STREAM
 - DRAINAGE DITCH
 - CORPORATE LIMITS AND ROADS THROUGH TOWN
 - COUNTY SEAT
 - OTHER CITIES AND TOWNS
 - MUNICIPAL AIRPORT
 - PRIVATE AIRFIELD
 - FARM UNIT OR DWELLING
 - GROUP OF CLOSELY SPACED DWELLINGS (S.F. NO. ROAD SHOWN)
 - CHURCH OR OTHER RELIGIOUS INSTITUTION
 - SCHOOL
 - POST OFFICE + POST OFFICE AND BUSINESS
 - CEMETERY
 - CHURCH WITH CEMETERY ADJACENT
 - BUSINESS ESTABLISHMENT
 - FACTORY OR INDUSTRIAL PLANT
 - GRAVEL PIT + QUARRY
 - POWER SUBSTATION
 - TRAILER PARK
 - FISH HATCHERY
 - OBSERVATION OR LOOKOUT TOWER
 - CAMP OR LODGE
 - GOLF COURSE OR COUNTRY CLUB
 - ATHLETIC FIELD OR AMUSEMENT PARK
 - SMALL PARK (UP TO 1/4 MILE BY ROAD, UP TO 1/2 MILE BY AIR)
 - WATER SUPPLY STANDPIPE OR TANK
 - SEWAGE DISPOSAL PLANT
 - CHICKEN HOUSE OR OTHER LIVESTOCK

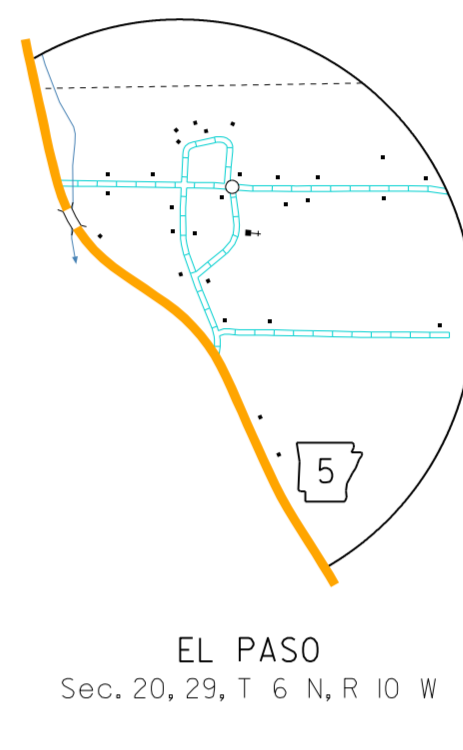

EL PASO
Sec. 20, 25, T. 6 N., R. 10 W.

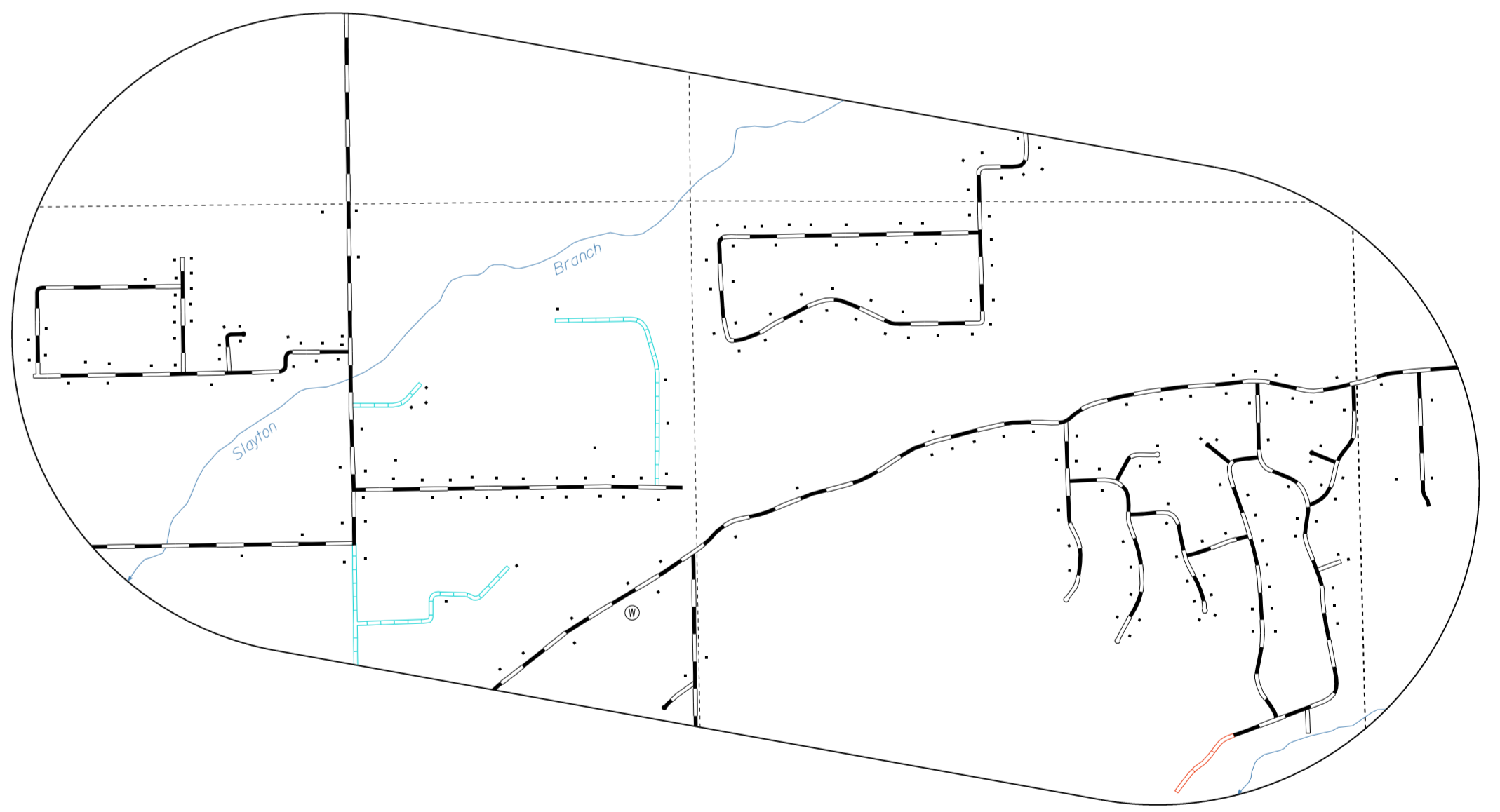

AREA WEST OF SEARCY
Sec. 11, 12, 13, 14, T. 7 N., R. 8 W.

GENERAL HIGHWAY MAP
WHITE COUNTY
ARKANSAS

PREPARED BY
ARKANSAS DEPARTMENT OF TRANSPORTATION
TRANSPORTATION PLANNING AND POLICY DIVISION
U.S. DEPARTMENT OF TRANSPORTATION
FEDERAL HIGHWAY ADMINISTRATION
SCALE 1:62500
MILES
KILOMETERS

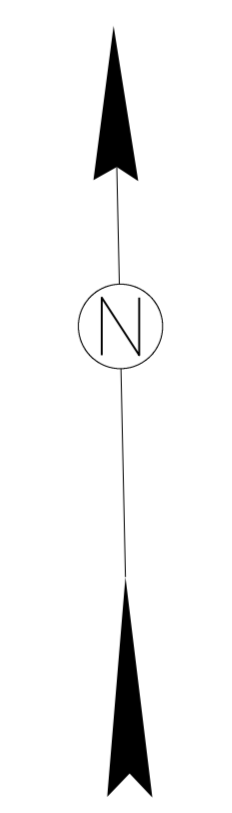

NOTE: Enlargements of all congested areas are five times map scale unless otherwise noted.
Individual maps are available for all active incorporated cities.
Area 1042 square miles.
Population 17,076, 2008 Census.
Map issued 6-28-05, replaces map issued 2-1-01.
Field Inventory 1979.

Map revisions made from aerial photographs taken
Map compilation completed in 05
County map produced using Computer Assisted Cartography.

Map Revised 08-31-2006, revised city limits of Bebe and Searcy.
Map Revised 08-08-2001, added S.R. 347, Section 15 Spur in Bebe, LA.
Map Revised 07-04-2008, added S.R. 362, Section 16 in Searcy, LA.
Map Revised 07-27-2008, realignment of S.R. 36, Section 2, LA.
Map Revised 04-27-2008, realignment of S.R. 6, Section 15 north of Searcy, LA.
Map Revised 04-30-2006, added new part of Hwy. 13 at Searcy, LA.
Map Revised 04-05-2006, added new part of Hwy. 13 north of Searcy.

Copies of this map are available at a nominal fee from the Arkansas State Highway and Transportation Department, P.O. Box 226, Little Rock, AR, 72203.

