



Latitude:33.76608, Longitude:-93.39118

Route:51 Section:00 Log:0.31

Arnold Road ID:50xNEVADA51x1xA, Arnold Log mile:2.18

District 03, Nevada County

Owner: 2-County Highway Agency



Bridge #04289(Routine, Underwater type 2)

C.R. 51 - F - 0.31 over ONION CREEK

Location: 2 M S PRESCOTT

Team Lead: John King Inspection Date: February 07, 2022

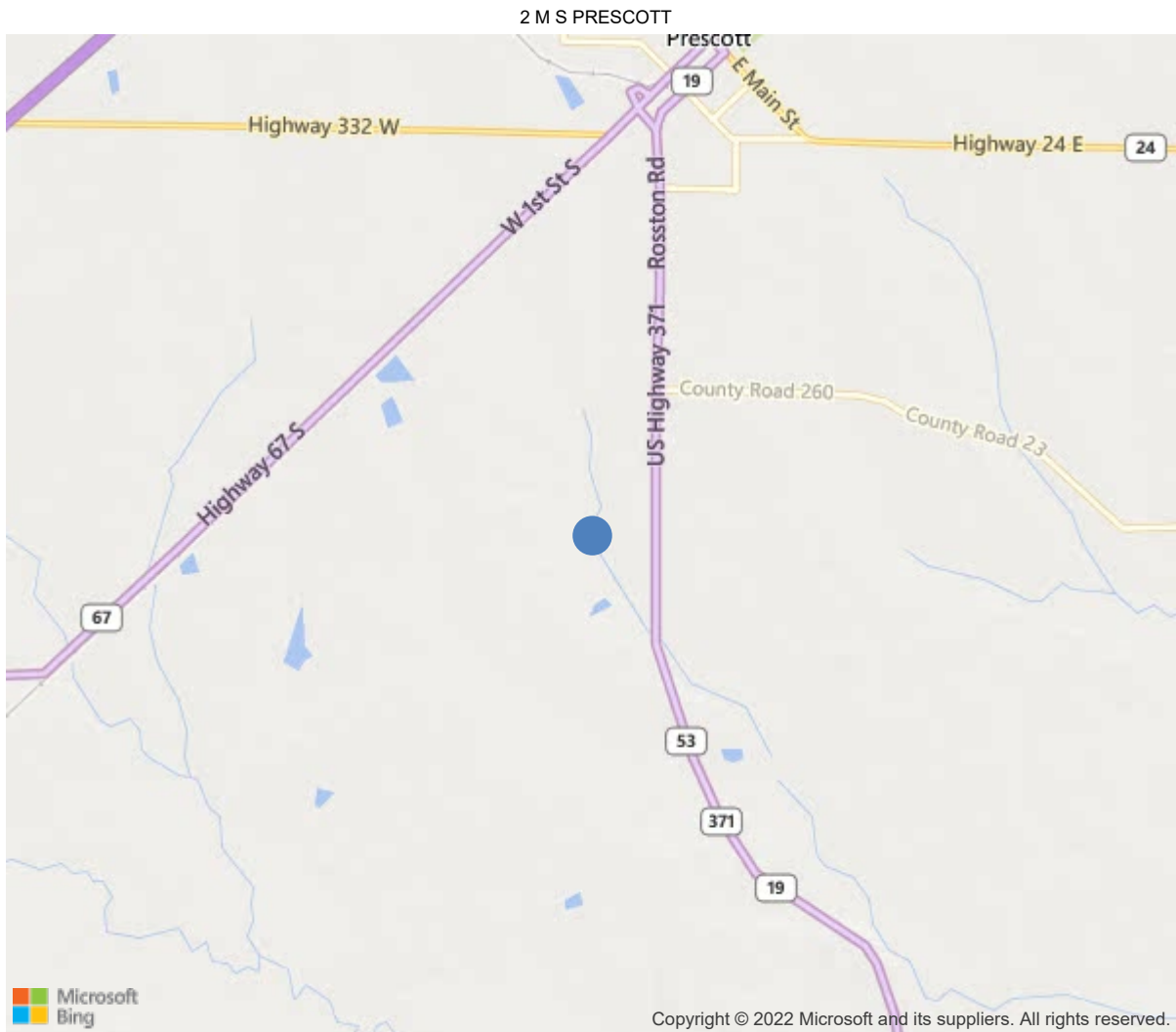

33.76608, -93.39118

Inspection Direction : E to W



Bridge #04289(Routine, Underwater type 2)

C.R. 51 - F - 0.31 over ONION CREEK

Location: 2 M S PRESCOTT

Team Lead: John King Inspection Date: February 07, 2022

IDENTIFICATION	
(1) State Names	Arkansas
(8) Structure Number	04289
(5) Inventory Route	51
(2) Highway Agency District	03
(3) County Code	99-Nevada County, Arkansas
(4) Place Code	0
(6) Features Intersected	ONION CREEK
(7) Facility Carried	C.R. 51 - F - 0.31
(9) Location	2 M S PRESCOTT
(11) Mile Point	0.31 mi
(12) Base Highway Network	No
(13) LRS Inventory Rte & Subrte	0000000000
(16) Latitude	33.766079
(17) Longitude	-93.391182
(98) Border Bridge State Code	
(99) Border Bridge Structure No.	
STRUCTURE TYPE AND MATERIAL	
(43) Main Structure Type	122
Material	1-Concrete
Type	22-Channel beam
(44) Approach Structure Type	00
Material	0-Other
Type	0-Other
(45) No. of Spans in Main Unit	3
(46) No. of Approach Spans	0
(107) Deck Structure Type	2-Concrete Precast Panels
(108) Wearing Surface/Protective System	
Type of Wearing Surface	6-Bituminous
Type of Membrane	0-None
Type of Deck Protection	0-None
AGE AND SERVICE	
(27) Year Built	1975
(106) Year Reconstructed	0
(42) Type of Service	15
On	1-Highway
Under	5-Waterway
(28) Lane	
On	2
Under	0
(29) Average Daily Traffic	200
(30) Year of ADT	2018
(109) Truck ADT	1 %
(19) Bypass, Detour Length	6 mi
GEOMETRIC DATA	
(48) Length of Maximum Span	31 ft
(49) Structure Length	69 ft
(50) Curb or Sidewalk Width	
Left	1 ft
Right	1 ft
(51) Bridge Roadway Width Curb to Curb	24.3 ft
(52) Deck Width Out to Out	26.2 ft
(32) Approach Roadway Width (W/Shoulders)	18 ft
(33) Bridge Median	0-No median
(34) Skew	0 Deg
(35) Structure Flared	No flare
(10) Inventory Route Min Vert Clear	99.99 ft
(47) Inventory Route Total Horiz Clear	25.6 ft
(53) Min Vert Clear Over Bridge Rdwy	99.99 ft
(54) Min Vert Underclear	0 ft
Ref:	
(55) Min Lat Underclear RT	99.9 ft
Ref:	
(56) Min Lat Underclear LT	0 ft
NAVIGATION DATA	
(38) Navigation Control	0-No navigation control on water
(111) Pier Protection	1-Navigation protection not requ
(39) Navigation Vertical Clearance	0 ft
(116) Vert-Lift Bridge Nav Min Vert Clear	0 ft
(40) Navigation Horizontal Clearance	0 ft

CLASSIFICATION	
(112) NBIS Bridge Length	Y
(104) Highway System	0
(26) Functional Class	8-Rural Minor Collector
(100) Defense Highway	0-The inventory route is not a S
(101) Parallel Structure	N-No parallel structure exists.
(102) Direction of Traffic	2 - way traffic
(103) Temporary Structure	
(105) Federal Lands Highways	0-N/A
(110) Designated National Network	0-The inventory route is not part of
(20) Toll	3-On free road. The structure is toll-
(21) Maintain	2-County Highway Agency
(22) Owner	2-County Highway Agency
(37) Historical Significance	4-Historical significance is not dete
CONDITION	
(58) Deck	7
(59) Superstructure	7
(60) Substructure	7
(61) Channel & Channel Protection	6
(62) Culverts	N
LOAD RATING AND POSTING	
(31) Design Load	2-M 13.5 / H 15
(63) Operating Rating Method	1
(64) Operating Rating	
Type	1-Load Factor(LF)
Rating	60
(65) Inventory Rating Method	1-Load Factor(LF)
(66) Inventory Rating	
Type	3
Rating	36
(70) Bridge Posting	5-Equal to or above legal loads
(41) Structure Open/Posted/Closed	A-Open, no restriction
APPRAISAL	
(67) Structural Evaluation	7
(68) Deck Geometry	6
(69) Clearances, Vertical/Horizontal	N
(71) Waterway Adequacy	6
(72) Approach Roadway Alignment	7
(36A) Bridge Railings	1-Inspected feature meets currently a
(36B) Transitions	0-Inspected feature does not meet cur
(36C) Approach Guardrail	0-Inspected feature does not meet cur
(36D) Approach Guardrail Ends	0-Inspected feature does not meet cur
(113) Scour Critical Bridges	5-Bridge foundations determined to be
PROPOSED IMPROVEMENTS	
(75) Type of Work	
(76) Length of Structure Improvement	0 ft
(94) Bridge Improvement Cost	\$ 0
(95) Roadway Improvement Cost	\$ 0
(96) Total Project Cost	\$ 0
(97) Year of Improvement Cost Estimate	
(114) Future ADT	93
(115) Year of Future ADT	2007

INSPECTIONS *			
(90) Inspection Date	02/2022		
(91) Frequency	24 Months		
(92) Critical Feature Inspection	Done	Freq. (Mon)	Date
A: Fracture Critical Detail	No		
B: Underwater Inspection	No		
C: Other Special Inspection	No		
* The inspection date and frequency information in this box contains the current NBI date and frequency information. Please refer to the report header for the date this inspection was conducted.			



02/2022 typ. bottom of units



Alignment



Alignment



Elevation



Typical deck photo asphalt overlay



2/2022 typical bents photo



2/2022 span 3 bottom of precast unit number 3 concrete has spalled on the bottom of unit at bent 3 about 3ft long

Maintenance Needs

Date Reported: 02/07/2022
Priority: D- Routine
Type of Work: Repair
Status: Open
Component: Miscellaneous

Deficiency Description

Erosion at Bent 1 About 5 ft from cap. needs rip added ...

Remarks



02/22 Erosion at Bent 1 east. About 5 ft from cap.



Bridge #04289(Routine, Underwater type 2)

C.R. 51 - F - 0.31 over ONION CREEK

Location: 2 M S PRESCOTT

Team Lead: John King **Inspection Date:** February 07, 2022

Inspection Comments

2/14/2018 AL,SS,DEF. PHOTOS TAKEN PER THIS INSPECTION...2/18/2020...AL, Elevation photos taken. Little or no change in condition...

02/07/2022 alignment elevation photos taken soundings taken per inspection...

Deck Notes

Railing: METAL RAIL .Wearing Surface: 0.5....

2/2022 deck photo taken

Superstructure Notes

Girders/Beams: PRECAST UNITS

Typical bottom of deck taken

Substructure Notes

Piles: STEEL PILE W/CONCRETE ENCASEMENTS.Called county Road Foreman Kenneth Ward 10:30 am 02/14/2018. And talk to him about erosion. John King...fixed per 02/19/2018 Johnny King.....2/18/2020...Spall on concrete encasement around steel pile, bent 2, pile 4...

02/2022 soundings taken per this inspection.. 2/2022 span 3 bottom of precast unit number 3 concrete has spalled on the bottom of unit at bent 3 about 3ft long