

## General Info

---

to **disable** Q & A notifications for this solicitation.

Digital ID required

---

### Deadline

05/07/2024 11:00 AM CDT

### Advertised

04/18/2024 10:39 AM CDT

### Business Name

Arkansas Department of Transportation - Equipment and Procurement

### Location(s)

Scott, Arkansas

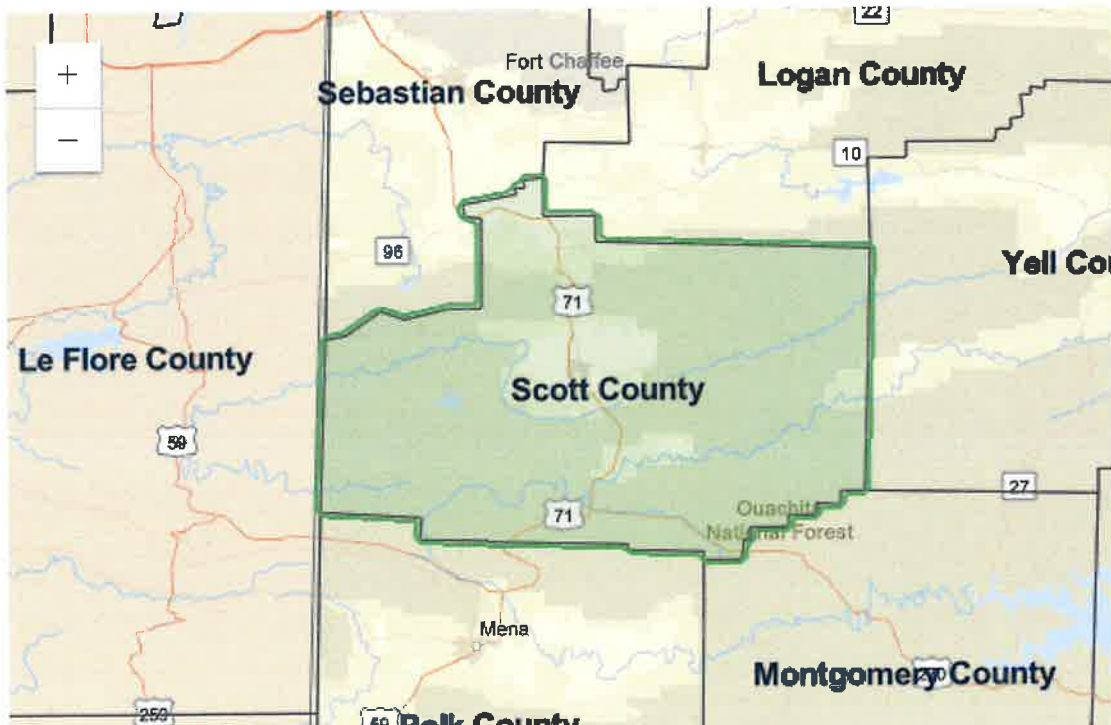

Arkansas GIS Office, Texas Parks & Wildlife, Esri, TomTom, Garmin, SafeGraph, FAO, METI/NASA, ... Powered by Esri

### Number

M-24-032H

### Description

Replace existing wastewater treatment plant and sewer lines with a new Aerobic Treatment Unit

Job# 42-24

FOB: Waldron

### Allows zero unit prices and labor

Yes

**Allows negative unit prices and labor**

Yes

**Allows multiple bids per solicitation**

No

**Q & A**

---

**Deadline**

05/02/2024 03:00 PM CDT

**Remarks**

---

**Notes**

---

**Notes**

**ATTACHMENT LIST**

---

CONTRACT AND GRANT DISCLOSURE AND CERTIFICATION FORM.pdf (157 KB)

Download, complete, and upload in the Required Document List at the bottom of t...

---

Standard Bid Conditions Revised 2023.pdf (156 KB)

---

Certificate For Boycott and Illegal Immigrant Restrictions.pdf (174 KB)

Download, complete, and upload in the Required Document List at the bottom of t...

---

Job 42-24 Project Manual.pdf (3.18 MB)

---

Job 42-24 Drawings.pdf (195 KB)

---

**BID INVITATION**

---

Electronic Sealed bids for furnishing the commodities and/or services described below subject to the Standard Bid Conditions of this Bid Invitation will be publicly opened at the above-noted bid opening date and time at the ARDOT Equipment and Procurement Division located at 11302 West Baseline Road, Little Rock, AR 72209. Bids must be submitted on this form, with attachments when appropriate, or bids will be rejected.

In compliance with this Bid Invitation and subject to all the Conditions thereof, the undersigned offers and agrees to furnish any and all items upon which prices are quoted, at the price set opposite each item.

**Company Name:\***

**Name:\***

**Address:\***

**Title:\***

**Federal Tax ID or Social Security No:\***

**Phone:\***

**Fax:**

**E-mail:\***

**Signature:\***

**Sewer Replacement**

Replace existing wastewater treatment plant and sewer lines with a new Aerobic Treatment Unit at the Waldron Rest Area, Waldron, AR.  
Job #42-24

To meet the requirements of the Arkansas Department of Transportation Specifications attached to and made part of this bi

For questions about Bidding requirements contact Danny Keene (501-569-2674).

For questions about job specifications contact Cameron Parsons (501-574-8705).

A mandatory pre-bid meeting is scheduled for all potential bidders at the job site located at the Waldron Rest Area on US 71 N., Waldron, AR 72958 at 10:00 A.M. on April 25, 2024.

Bid price shall include all labor, materials, and equipment necessary to perform the work as specified, and shall further include all licenses, fees, permits, royalties, and all taxes.

Bid price shall represent full compensation for completion of work. This provision supercedes Condition 5 on page 1 of Standard Bid Conditions. Payment will be made in accordance with Arkansas Department of Transportation Specification and Applicable Special Provisions.

All bidders should complete and return the Eligible Bidder Certification (Attachment A) and Disclosure Form (see Page 2 of Standard Bid Conditions – Item 18) and Restriction of Boycott of Israel Certification issued with this bid. A current copy of the DFA Illegal Immigrant Contractor Disclosure Certification (see Page 1 of Standard Bid Conditions – Item 17) should also be submitted with bid. These forms are kept on file and remain current for one year from date of submission. Forms do not need to be submitted again, during that time, unless there is a status change.

**The successful bidder for this project will be required to obtain Builder's Risk Insurance coverage in a minimum amount equal to the total amount bid for all building facilities included in the contract, and to provide coverage for all existing structures on the job site.**

**Current Arkansas Contractor's License Number must be listed or bid will be rejected.  
(A.C.A. 17-25-101 et. seq.)**

**The successful bidder will be required to begin work within 30 days after notice.**

Bid Bond in the amount of 5% of total bid price is required of all bidders at time of bid opening or bid will be rejected. **Personal and company checks are not acceptable as Bid Bonds. See Condition 4 on page 1 of Standard Bid Conditions.** Bid bonds that are not submitted electronically must be physically received by Equipment & Procurement located at 11302 West Baseline Road, Little Rock, AR 72209 prior to the designated time of the bid opening. Bid Invitation number should be clearly displayed on the sealed envelope or package. **Performance Bond only (no checks of any kind allowed) in the amount of 100% will be required of successful bidder prior to providing goods/services. See Condition 4 on page 1 of Standard Bid Conditions.**

Surety Bonds may be submitted electronically through the online bidding process. If submitting a Surety Bond that is not compatible with Surety 2000 and Tinubu, your company still may do so. Other Surety Companies will still be accepted but must be received in Equipment and Procurement before the time of bid opening at 11302 West Baseline Road, Little Rock, AR 72209 prior to the designated time of the bid opening. This includes Cashier's checks, Certified checks, or Money orders submitted as bid bonds must be physically received by Equipment & Procurement.

Bids and Specifications are available on-line by going to the ARDOT Web Site – [www.ardot.gov](http://www.ardot.gov) and clicking on "Commodities and Services Bids/Contracts Information". Tabulations will also be available at this site after award of bid/contract. If you have any questions, call this office at 501-569-2667.

## BID SHEET

---

1. 1 – Replace existing wastewater treatment plant and sewer lines with new Aerobic Treatment Unit.

FOB: Waldron, AR

### Lump Sum\*

\$

### Arkansas Contractor's License Number\*

## ATTACHMENT A - ELIGIBLE BIDDER CERTIFICATION

---

The Bidder represents and warrants for itself, its employees and its subcontractors and certifies they:

1. Are not presently debarred, suspended, proposed for debarment, declared ineligible, or voluntarily excluded from covered transactions by any Federal department or agency;
2. Have not within a three-year period preceding this Bid been convicted of or had a civil judgment rendered against them for commission of fraud or a criminal offense in connection with obtaining, attempting to obtain, or performing a public (Federal, State, or local) transaction or contract under a public transaction; violation of Federal or State antitrust statutes or commission of embezzlement, theft, forgery, bribery, falsification or destruction of records, making false statements, or receiving stolen property;
3. Are not presently indicted for or otherwise criminally or civilly charged by a governmental entity (Federal, State, or local) with commission of any of the offenses enumerated in paragraph two (2) of this Certification;
4. Have not within a one-year period preceding this application/Bid had one or more public transactions (Federal, State, or local) terminated for cause or default; and

The Bidder represents, warrants and acknowledges the understanding that restrictions placed on the employment of labor or on the scale of pay for the work on a contract will be the requirements of the Fair Labor Standards Act (Federal Wage-Hour Law) of 1938, 28 USC §201 et seq., and other applicable labor laws.

The person executing this Certification further represents, warrants and affirms the truthfulness and accuracy of the contents of the statements submitted on or with this Certification and understands that the provisions of 31 USC §3801 et seq. are applicable thereto.

### BIDDER NAME (Company Name):\*

**BY (Signature):\***

**TITLE:\***

## BID BOND

---

In the amount of 5% of total bid price

**Guarantee Method\***

Choices...

**Paper Bid Bond, Cashier's Check, Certified Check, Money Order, or an Annual Bond on File**

**Confirmation\***

Choices...

**Electronic Bid Bond**

**Bond ID\***

**Surety Agency\***

Choices...

**Surety State\***

**Principal\***

## ENVELOPE REQUIRED DOCUMENT LIST

---

**Name**

**Omission Terms**

The information supplied in this component will be available to the owner-agency immediately after the bid deadline, but before the bid is

1 Required Document

**Name**

**Omission Terms**

opened.

Paper Bid Bond, Cashier's Check, Certified Check, Money Order, or an Annual Bond on File  
Original, wet-ink documents are required at time of bid opening or bid will be rejected.

I have opted to electronically verify my bid bond.

1 Required Document

**REQUIRED DOCUMENT LIST**

**Name**

**Omission Terms**

Contract and Grant Disclosure and Certification Form  
Failure to complete all of the following information may result in a delay in obtaining a contract...

Certification for Boycott and Illegal Immigrant Restrictions  
Failure to complete all of the following information may result in rejection of bid submission.

2 Required Documents

## ARDOT - STANDARD BID CONDITIONS

1. **GENERAL:** Any special terms and conditions included in the invitation for bid override these standard terms and conditions. The standard terms and conditions and any special terms and conditions become part of any contract entered into if any or all parts of the bid are accepted by the Arkansas Department of Transportation (ARDOT).
2. **ACCEPTANCE AND REJECTION:** ARDOT reserves the right to reject any or all bids, to accept bids in whole or in part (unless otherwise indicated by bidder), to waive any informalities in bids received, to accept bids on materials or equipment with variations from specifications where efficiency of operation will not be impaired, and to award bids to best serve the interest of the State.
3. **PRICES:** Unless otherwise stated in the Bid Invitation, the following will apply: (1) unit prices shall be bid, (2) prices should be stated in units of quantity specified (feet, each, lbs., etc.), (3) prices must be F.O.B. destination specified in bid, (4) prices must be firm and not subject to escalation, (5) bid must be firm for acceptance for 30 days from bid opening date. In case of errors in extension, unit prices shall govern. Discounts from bid price will not be considered in making awards.
4. **BID BONDS AND PERFORMANCE BONDS:** If required, a **Bid Bond** in the form of a cashier's check, certified check, or surety bond issued by a surety company, in an amount stated in the Bid Invitation, must accompany bid. **Personal and company checks are not acceptable as Bid Bonds.** Surety Bonds may be submitted electronically through the online bidding process. Cashier's checks, Certified checks, or Money orders submitted as bid bonds must be physically received by Equipment & Procurement located at 11302 West Baseline Road, Little Rock, AR 72209 prior to the designated time of the bid opening. Failure to submit a Bid Bond as required will cause a bid to be rejected. The Bid Bond will be forfeited as liquidated damages if the successful bidder fails to provide a required Performance Bond within the period stipulated by ARDOT or fails to honor their bid. When a bidder claims and can show clear and convincing evidence that a material mistake was made in the bid and was not the bid intended, the bidder may be permitted to withdraw their bid prior to award without forfeiture of bid bond. Cashier's checks and certified checks submitted as Bid Bonds will be returned to unsuccessful bidders; surety bonds will be retained. The successful bidder will be required to furnish a **Performance Bond** in an amount stated in the Bid Invitation and in the form of a cashier's check, certified check, or surety bond issued by a surety company, unless otherwise stated in the Bid Invitation, as a guarantee of delivery of goods/services in accordance with the specifications and within the time established in the bid. **Personal and company checks are not acceptable as Performance Bonds.** In some cases, a cashier's check or certified check submitted as a Bid Bond will be held as the Performance Bond of the successful bidder. Cashier's checks or certified checks submitted as Performance Bonds will be refunded shortly after payment has been made to the successful bidder for completion of all terms of the bid; surety bonds will be retained. Surety bonds must be issued by a surety company that is authorized to do business in the State of Arkansas and that is listed on the current United States Department of the Treasury Listing of Approved Sureties. Surety bonds must be executed by a resident or non-resident agent who is licensed by the Arkansas State Insurance Commissioner to represent the surety company executing the bond, and the resident or non-resident agent shall file with the bond the power of attorney of the agent to act on behalf of the bonding company. Certain bids involving labor will require Performance Bonds in the form of surety bonds only (no checks of any kind allowed). These bonds shall not only serve to guarantee the completion of the work, but also to guarantee the excellence of both workmanship and material until the work is finally accepted and the provisions of the Plans, Specifications, and Special Provisions fulfilled. In such cases, the company issuing the surety bond must comply with all stipulations herein and must be named in the U. S. Treasury listing of companies holding Certificates of Authority as acceptable sureties on Federal Bonds and as acceptable reinsuring companies. Any excess between the face amount of the bond and the underwriting limitation of the bonding company shall be protected by reinsurance provided by an acceptable reinsuring company. Annual Bid and Performance Bonds on file with E & P Division must have sufficient unencumbered funds to meet current bonding requirements, or the bid will be rejected, unless the balance is submitted as set forth above, prior to bid opening.
5. **TAXES:** The ARDOT is not exempt from Arkansas State Sales and Use Taxes, or local option city/county sales taxes, when applicable, and bidders are responsible to the State Revenue Department for such taxes. These taxes should not be included in bid prices, but where required by law, will be paid by the ARDOT as an addition thereto, and should be added to the billing to the ARDOT. The ARDOT is exempt from Federal Excise Taxes on all commodities except motor fuels; and excise taxes should not be included in bid prices except for motor fuels. Where applicable, tax exemption certificates will be furnished by the ARDOT.
6. **"ALL OR NONE" BIDS:** Bidders who wish to bid "All or None" on two or more items shall so stipulate on the face of bid sheet; otherwise, bid may be awarded on an individual item basis.
7. **SPECIFICATIONS:** Complete specifications should be attached for any substitution or alternate offered, or where amplification is necessary. Bidder's name must be placed on all attachments to the bid.
8. **EXCEPTIONS TO SPECIFICATIONS:** Any exceptions to the bid specifications must be stated in the bid. Any exceptions to manufacturer's published literature must be stated in the bid, or it will be assumed that bidder is bidding exactly as stated in the literature.
9. **BRAND NAME REFERENCES:** All brand name references in bid specifications refer to that commodity or its equivalent, unless otherwise stated in Bid Invitation. Bidder should state brand or trade name of item being bid, if such name exists.
10. **FREIGHT:** All freight charges should be included in bid price. Any change in common carrier rates authorized by the Interstate Commerce Commission will be adjusted if such change occurs after the bid opening date. Receipted common carrier bills that reflect ICC authorized rate changes must be furnished.



11. **SAMPLES, LITERATURE, DEMONSTRATIONS:** Samples and technical literature must be provided free of any charge within 14 days of ARDOT request, and free demonstrations within 30 days, unless ARDOT extends time. Failure to provide as requested within this period may cause bid to be rejected. Samples, literature and demonstrations must be substantially the same as the item(s) being bid, unless otherwise agreed to by ARDOT. Samples that are not destroyed will be returned upon request at bidders expense. Samples from successful bidders may be retained for comparison with items actually furnished.
12. **GUARANTY:** Unless otherwise indicated in Bid Invitation, it is understood and agreed that any item offered or shipped on this bid shall be newly manufactured, latest model and design, and in first class condition; and that all containers shall be new, suitable for storage or shipment and in compliance with all applicable laws relating to construction, packaging, labeling and registration.
13. **BACKORDERS OR DELAY IN DELIVERY:** Backorders or failure to deliver within the time required may constitute default. Vendor must give written notice to the ARDOT, as soon as possible, of the reason for any delay and the expected delivery date. The ARDOT has the right to extend delivery if reasons appear valid. If reason or delivery date is not acceptable, vendor is in default.
14. **DEFAULT:** All commodities furnished will be subject to inspection and acceptance by ARDOT after delivery. Default in promised delivery or failure to meet specifications authorizes the ARDOT to cancel award or any portion of same, to reasonably purchase commodities or services elsewhere and to charge full increase, if any, in cost and handling to defaulting vendor. Applicable bonds may be forfeited.
15. **ETHICS:** *"It shall be a breach of ethical standards for a person to be retained, or to retain a person, to solicit or secure a State contract upon an agreement of understanding for a commission, percentage, brokerage, or contingent fee, except for retention of bona fide employees or bona fide established commercial selling agencies maintained by the contractor for the purpose of securing business."* (Arkansas Code, Annotated, Section 19-11-708).
16. **NOTICE OF NONDISCRIMINATION:** The Arkansas State Highway Commission, through ARDOT, complies with all civil rights provisions of federal statutes and related authorities that prohibit discrimination in programs and activities receiving federal financial assistance. Therefore, ARDOT does not discriminate on the basis of race, sex, color, age, national origin, religion (not applicable as a protected group under the Federal Motor Carrier Safety Administration Title VI Program), disability, Limited English Proficiency (LEP), or low-income status in the admission, access to and treatment in the ARDOT's programs and activities, as well as the ARDOT's hiring or employment practices. Complaints of alleged discrimination and inquiries regarding the ARDOT's nondiscrimination policies may be directed to Civil Rights Officer Joanna P. McFadden (ADA/504/Title VI Coordinator), P. O. Box 2261, Little Rock, AR 72203, (501)569-2298, (Voice/TTY 711), or the following email address: [joanna.mcfadden@ardot.gov](mailto:joanna.mcfadden@ardot.gov). Free language assistance for Limited English Proficient individuals is available upon request. This notice is available from the ADA/504/Title VI Coordinator in large print, on audiotape and in Braille.
17. **PROHIBITION OF EMPLOYMENT OF ILLEGAL IMMIGRANTS:** Pursuant to Arkansas Code Annotated 19-11-105, all bidders must certify prior to award of a contract that they **do not** employ or contract with any illegal immigrant(s) in its contract with the state. Bidders shall certify online at <https://www.ark.org/dfa/immigrant/index.php>.
18. **DISCLOSURE:** Failure to make any disclosure required by Governor's Executive Order 98-04, or any violation of any rule, regulation, or policy adopted pursuant to that order, **shall** be a material breach of the terms of this contract. Any contractor, whether an individual or entity, who fails to make the required disclosure or who violates any rule, regulation, or policy **shall** be subject to all legal remedies available to the agency.

## CONTRACT AND GRANT DISCLOSURE AND CERTIFICATION FORM

Failure to complete all of the following information may result in a delay in obtaining a contract, lease, purchase agreement, or grant award with any Arkansas State Agency.

SUBCONTRACTOR: \_\_\_\_\_

Yes  No

IS THIS FOR:

Goods?  Services?  Both?

TAXPAYER ID NAME: \_\_\_\_\_

FIRST NAME: \_\_\_\_\_

M.I.: \_\_\_\_\_

ADDRESS: \_\_\_\_\_

STATE: \_\_\_\_\_

ZIP CODE: \_\_\_\_\_

COUNTY: \_\_\_\_\_

### AS A CONDITION OF OBTAINING, EXTENDING, AMENDING, OR RENEWING A CONTRACT, LEASE, PURCHASE AGREEMENT, OR GRANT AWARD WITH ANY ARKANSAS STATE AGENCY, THE FOLLOWING INFORMATION MUST BE DISCLOSED:

#### FOR INDIVIDUALS\*

Indicate below if: you, your spouse or the brother, sister, parent, or child of you or your spouse is a current or former: member of the General Assembly, Constitutional Officer, State Board or Commission Member, or State Employee:

Position Held	Mark (✓)		Name of Position of Job Held <small>(senator, representative, name of board/ commission, data entry, etc.)</small>	For How Long?		What is the person(s) name and how are they related to you? <small>(i.e., Jane Q. Public, spouse, John Q. Public, Jr., child, etc.)</small>
	Current	Former		From MM/YY	To MM/YY	
General Assembly						
Constitutional Officer						
State Board or						
Commission Member						
State Employee						

None of the above applies

#### FOR AN ENTITY (BUSINESS)\*

Indicate below if any of the following persons, current or former, hold any position of control or hold any ownership interest of 10% or greater in the entity: member of the General Assembly, Constitutional Officer, State Board or Commission Member, State Employee, or the spouse, brother, sister, parent, or child of a member of the General Assembly, Constitutional Officer, State Board or Commission Member, or State Employee. Position of control means the power to direct the purchasing policies or influence the management of the entity.

Position Held	Mark (✓)		Name of Position of Job Held <small>(senator, representative, name of board/ commission, data entry, etc.)</small>	For How Long?		What is the person(s) name and what is his/her % of ownership interest and/or what is his/her position of control?		
	Current	Former		From MM/YY	To MM/YY	Person's Name(s)	Ownership Interest (%)	Position of Control
General Assembly								
Constitutional Officer								
State Board or								
Commission Member								
State Employee								

None of the above applies

## Contract and Grant Disclosure and Certification Form

*Failure to make any disclosure required by Governor's Executive Order 98-04, or any violation of any rule, regulation, or policy adopted pursuant to that Order, shall be a material breach of the terms of this contract. Any contractor, whether an individual or entity, who fails to make the required disclosure or who violates any rule, regulation, or policy shall be subject to all legal remedies available to the agency.*

As an additional condition of obtaining, extending, amending, or renewing a contract with a state agency I agree as follows:

1. Prior to entering into any agreement with any subcontractor, prior or subsequent to the contract date, I will require the subcontractor to complete a **CONTRACT AND GRANT DISCLOSURE AND CERTIFICATION FORM**. Subcontractor shall mean any person or entity with whom I enter an agreement whereby I assign or otherwise delegate to the person or entity, for consideration, all, or any part, of the performance required of me under the terms of my contract with the state agency.
2. I will include the following language as a part of any agreement with a subcontractor:  

Failure to make any disclosure required by Governor's Executive Order 98-04, or any violation of any rule, regulation, or policy adopted pursuant to that Order, shall be a material breach of the terms of this subcontract. The party who fails to make the required disclosure or who violates any rule, regulation, or policy shall be subject to all legal remedies available to the contractor.
3. No later than ten (10) days after entering into any agreement with a subcontractor, whether prior or subsequent to the contract date, I will mail a copy of the CONTRACT AND GRANT DISCLOSURE AND CERTIFICATION FORM completed by the subcontractor and a statement containing the dollar amount of the subcontract to the state agency.

Signature _____	Title _____	Date _____
Vendor Contact Person _____	Title _____	Phone No. _____

<small>Agency Use Only</small>			
Agency Number _____	Agency Name _____	Agency Contact Person _____	Contact Phone No. _____
			Contract or Grant No. _____



### CERTIFICATION FOR BOYCOTT AND ILLEGAL IMMIGRANT RESTRICTIONS

Pursuant to Arkansas law, a vendor must submit the below certifications prior to entering into a contract with a public entity for an amount as designated by the applicable laws.

**1. Israel Boycott Restriction:** For contracts valued at \$1,000 or greater.

A public entity shall not enter into a contract with a company unless the contract includes a written certification that the person or company is not currently engaged in a boycott of Israel. If at any time after signing this certification the contractor decides to engage in a boycott of Israel, the contractor must notify the contracting public entity in writing. See Arkansas Code Annotated § 25-1-503.

**2. Illegal Immigrant Restriction:** For contracts exceeding \$25,000.

No state agency may enter into or renew a public contract for services with a contractor who employs or contracts with an illegal immigrant. A contractor shall certify that it does not employ, or contract with, illegal immigrants. See Arkansas Code Annotated § 19-11-105.

**3. Energy, Fossil Fuel, Firearms, and Ammunition Industries Boycott Restriction:** For contracts valued at, or exceeding, \$75,000.

A public entity shall not enter into a contract with a company unless the contract includes a written certification that the person or company is not currently engaged in, and agrees for the duration of the contract not to engage in, a boycott of an Energy, Fossil Fuel, Firearms, or Ammunition Industry. If a company does boycott any of these industries, see Arkansas Code Annotated § 25-1-1102.

By signing this form, the contractor agrees and certifies that it does not, and shall not for the remaining aggregate term of the contract, participate in the activities checked below:

- Do not boycott Israel.
- Do not employ illegal immigrants.
- Do not boycott Energy, Fossil Fuel, Firearms, or Ammunition Industries.

Contract Number & Description	
Name of Public Entity	Arkansas Department of Transportation
Name of Vendor/Contractor	
AASIS Vendor Number	N/A

\_\_\_\_\_  
Contractor Signature

\_\_\_\_\_  
Date

**PROJECT  
MANUAL**

**ARDOT  
Waldron Rest Area Sewer  
Replacement  
Waldron, Arkansas**

Prepared by  
**Arkansas Department of Transportation**

**Project Number 42-24**

ARKANSAS DEPARTMENT OF TRANSPORTATION  
JOB NO. 42-24  
WALDRON REST AREA SEWER REPLACEMENT  
PROJECT MANUAL

**TABLE OF CONTENTS**

**DIVISION01 - GENERAL REQUIREMENTS**

01 10 00	SUMMARY
01 25 00	SUBSTITUTION PROCEDURES
01 26 00	CONTRACT MODIFICATION PROCEDURES
01 29 00	PAYMENT PROCEDURES
01 31 00	PROJECT MANAGEMENT AND COORDINATION
01 32 00	CONSTRUCTION PROGRESS DOCUMENTATION
01 33 00	SUBMITTAL PROCEDURES
01 40 00	QUALITY REQUIREMENTS
01 60 00	PRODUCT REQUIREMENTS
01 73 00	EXECUTION
01 77 00	CLOSEOUT PROCEDURES
01 78 23	OPERATION AND MAINTENANCE DATA
01 78 39	PROJECT RECORD DOCUMENTS
01 79 00	DEMONSTRATION AND TRAINING

**DIVISION32 - EXTERIOR IMPROVEMENTS**

32 92 00	TURF AND GRASSES
----------	------------------

**END OF TABLE OF CONTENTS**

ARKANSAS DEPARTMENT OF TRANSPORTATION  
JOB NO. 42-24  
WALDRON REST AREA SEWER REPLACEMENT  
PROJECT MANUAL

**SECTION 01 10 00 - SUMMARY**

**PART 1 - GENERAL**

**1.1 SUMMARY**

A. Section Includes:

1. Project information.
2. Work covered by Contract Documents.
3. Phased construction.
4. Contractor's use of site and premises.
5. Coordination with occupants.
6. Work restrictions.
7. Specification and Drawing conventions.
8. Miscellaneous provisions.

**1.2 PROJECT INFORMATION**

- A. Project Identification: Waldron Rest Area Sewer Replacement.
- B. Owner: Arkansas Department of Transportation.
1. Owner's Representative: Cameron Parsons, Project Coordinator ARDOT (501) 569-4951.

**1.3 WORK COVERED BY CONTRACT DOCUMENTS**

- A. The Work of Project is defined by the Contract Documents and includes, but is not limited to, the following:
1. Installation of a new aerobic sewer treatment system and the demolition and removal of existing sewer treatment system and other Work indicated in the Contract Documents.
- B. Type of Contract:
1. Project will be constructed under a single prime contract.

**1.4 PHASED CONSTRUCTION**

- A. Construct the Work in phases, with each phase substantially complete as indicated below.

ARKANSAS DEPARTMENT OF TRANSPORTATION  
JOB NO. 42-24  
WALDRON REST AREA SEWER REPLACEMENT  
PROJECT MANUAL

1. Phase one: Installation of new Aerobic system complete and operational.
  2. Phase two: Perform the remaining Work. The remaining Work shall be substantially complete at time of Substantial Completion of the Work.
- B. Before commencing Work of each phase, submit an updated copy of Contractor's construction schedule, showing the sequence, commencement and completion dates for all phases of the Work.

**1.5 CONTRACTOR'S USE OF SITE AND PREMISES**

- A. Restricted Use of Site: Contractor shall have limited use of Project site for construction operations as indicated on Drawings by the Contract limits and as indicated by requirements of this Section.
- B. Limits on Use of Site: Limit use of Project site to Work in areas indicated. Do not disturb portions of Project site beyond areas in which the Work is indicated.
1. Driveways, Walkways and Entrances: Keep driveways and entrances serving premises clear and available to Owner, Owner's employees, and emergency vehicles at all times. Do not use these areas for parking or for storage of materials.
    - a. Schedule deliveries to minimize use of driveways and entrances by construction operations.
    - b. Schedule deliveries to minimize space and time requirements for storage of materials and equipment on-site.
- C. Condition of Existing Building: Maintain portions of existing building affected by construction operations in a weathertight condition throughout construction period. Repair damage caused by construction operations.
- D. Condition of Existing Grounds: Maintain portions of existing grounds, landscaping, and hardscaping affected by construction operations throughout construction period. Repair damage caused by construction operations.

**1.6 COORDINATION WITH OCCUPANTS**

- A. Full Owner Occupancy: Owner will occupy Project site and existing building(s) during entire construction period. Cooperate with Owner during construction operations to minimize conflicts and facilitate Owner usage. Perform the Work so as not to interfere with Owner's day-to-day operations. Maintain existing exits unless otherwise indicated.
1. Maintain access to existing walkways, corridors, and other adjacent occupied or used facilities. Do not close or obstruct walkways, corridors, or other occupied or used facilities without written permission from Owner and approval of authorities having jurisdiction.



ARKANSAS DEPARTMENT OF TRANSPORTATION  
JOB NO. 42-24  
WALDRON REST AREA SEWER REPLACEMENT  
PROJECT MANUAL

2. Notify Owner not less than 72 hours in advance of activities that will affect Owner's operations.

**1.7 WORK RESTRICTIONS**

- A. Comply with restrictions on construction operations.
  1. Comply with limitations on use of public streets, work on public streets, rights of way, and other requirements of authorities having jurisdiction.
- B. On-Site Work Hours: Limit work to between 7 a.m. to 5 p.m., Monday through Friday, unless otherwise indicated. Work hours may be modified to meet Project requirements if approved by Owner and authorities having jurisdiction.
  1. Weekend Hours: Weekend work shall be permitted with Owner approval.
- C. Existing Utility Interruptions: Do not interrupt utilities serving facilities occupied by Owner or others unless permitted under the following conditions and then only after arranging for temporary utility services according to requirements indicated:
  1. Notify Owner not less than two days in advance of proposed utility interruptions.
  2. Obtain Owner's written permission before proceeding with utility interruptions.
- D. Smoking and Controlled Substance Restrictions: Use of tobacco products , alcoholic beverages, and other controlled substances within the existing building is not permitted.
- E. Employee Screening: Comply with Owner's requirements for drug screening of Contractor personnel working on Project site.
  1. Maintain list of approved screened personnel with Owner's representative.

**PART 2 - PRODUCTS (Not Used)**

**PART 3 - EXECUTION (Not Used)**

**END OF SECTION 01 10 00**

ARKANSAS DEPARTMENT OF TRANSPORTATION  
JOB NO. 42-24  
WALDRON REST AREA SEWER REPLACEMENT  
PROJECT MANUAL

**SECTION 01 25 00 - SUBSTITUTION PROCEDURES**

**PART 1 - GENERAL**

**1.1 SUMMARY**

- A. Section includes administrative and procedural requirements for substitutions.

**1.2 ACTION SUBMITTALS**

- A. Substitution Requests: Submit documentation identifying product or fabrication or installation method to be replaced. Include Specification Section number and title and Drawing numbers and titles.
1. Substitution Request Form: Use form acceptable to Owner.
  2. Documentation: Show compliance with requirements for substitutions and the following, as applicable:
    - a. Statement indicating why specified product or fabrication or installation method cannot be provided, if applicable.
    - b. Coordination of information, including a list of changes or revisions needed to other parts of the Work and to construction performed by Owner and separate contractors that will be necessary to accommodate proposed substitution.
    - c. Detailed comparison of significant qualities of proposed substitutions with those of the Work specified. Include annotated copy of applicable Specification Section. Significant qualities may include attributes, such as performance, weight, size, durability, visual effect, sustainable design characteristics, warranties, and specific features and requirements indicated. Indicate deviations, if any, from the Work specified.
    - d. Product Data, including drawings and descriptions of products and fabrication and installation procedures.
    - e. Samples, where applicable or requested.
    - f. Certificates and qualification data, where applicable or requested.
    - g. List of similar installations for completed projects, with project names and addresses as well as names and addresses of architects and owners.
    - h. Material test reports from a qualified testing agency, indicating and interpreting test results for compliance with requirements indicated.
    - i. Detailed comparison of Contractor's construction schedule using proposed substitutions with products specified for the Work, including effect on the overall Contract Time. If specified product or method of construction cannot be provided within the Contract Time, include letter from manufacturer, on manufacturer's letterhead, stating date of

ARKANSAS DEPARTMENT OF TRANSPORTATION  
JOB NO. 42-24  
WALDRON REST AREA SEWER REPLACEMENT  
PROJECT MANUAL

- receipt of purchase order, lack of availability, or delays in delivery.
  - j. Cost information, including a proposal of change, if any, in the Contract Sum.
  - k. Contractor's certification that proposed substitution complies with requirements in the Contract Documents, except as indicated in substitution request, is compatible with related materials and is appropriate for applications indicated.
  - l. Contractor's waiver of rights to additional payment or time that may subsequently become necessary because of failure of proposed substitution to produce indicated results.
3. Owner's Action: If necessary, Owner will request additional information or documentation for evaluation within seven days of receipt of a request for substitution. Owner will notify Contractor of acceptance or rejection of proposed substitution within 15 days of receipt of request, or seven days of receipt of additional information or documentation, whichever is later.
- a. Forms of Acceptance: Change Order, Construction Change Directive, or Owner's Supplemental Instructions for minor changes in the Work.
  - b. Use product specified if Owner does not issue a decision on use of a proposed substitution within time allocated.

### 1.3 QUALITY ASSURANCE

- A. Compatibility of Substitutions: Investigate and document compatibility of proposed substitution with related products and materials. Engage a qualified testing agency to perform compatibility tests recommended by manufacturers.

### 1.4 PROCEDURES

- A. Coordination: Revise or adjust affected work as necessary to integrate work of the approved substitutions.

### 1.5 SUBSTITUTIONS

- A. Substitutions for Cause: Submit requests for substitution immediately on discovery of need for change, but not later than 15 days prior to time required for preparation and review of related submittals.
  - 1. Conditions: Owner will consider Contractor's request for substitution when the following conditions are satisfied. If the following conditions are not satisfied, Owner will return requests without action, except to record noncompliance with these requirements:
    - a. Requested substitution is consistent with the Contract Documents and will produce indicated results.

ARKANSAS DEPARTMENT OF TRANSPORTATION  
JOB NO. 42-24  
WALDRON REST AREA SEWER REPLACEMENT  
PROJECT MANUAL

- b. Substitution request is fully documented and properly submitted.
- c. Requested substitution will not adversely affect Contractor's construction schedule.
- d. Requested substitution has received necessary approvals of authorities having jurisdiction.
- e. Requested substitution is compatible with other portions of the Work.
- f. Requested substitution has been coordinated with other portions of the Work.
- g. Requested substitution provides specified warranty.
- h. If requested substitution involves more than one contractor, requested substitution has been coordinated with other portions of the Work, is uniform and consistent, is compatible with other products, and is acceptable to all contractors involved.

B. Substitutions for Convenience:

- 1. Not allowed unless otherwise indicated.

**PART 2 - PRODUCTS (Not Used)**  
**PART 3 - EXECUTION (Not Used)**

**END OF SECTION 01 25 00**

ARKANSAS DEPARTMENT OF TRANSPORTATION  
JOB NO. 42-24  
WALDRON REST AREA SEWER REPLACEMENT  
PROJECT MANUAL

**SECTION 01 26 00 - CONTRACT MODIFICATION PROCEDURES**

**PART 1 - GENERAL**

**1.1 SUMMARY**

- A. Section includes administrative and procedural requirements for handling and processing Contract modifications.
- B. Related Requirements:
  - 1. Section 012500 "Substitution Procedures" for administrative procedures for handling requests for substitutions made after the Contract award.
  - 2. Section 013100 "Project Management and Coordination" for requirements for forms for contract modifications provided as part of web-based Project management software.

**1.2 PROPOSAL REQUESTS**

- A. Owner-Initiated Proposal Requests: Owner will issue a detailed description of proposed changes in the Work that may require adjustment to the Contract Sum or the Contract Time. If necessary, the description will include supplemental or revised Drawings and Specifications.
  - 1. Work Change Proposal Requests issued by are not instructions either to stop work in progress or to execute the proposed change.
  - 2. Within time specified in Proposal Request, or, 20 days, when not otherwise specified, after receipt of Proposal Request, submit a quotation estimating cost adjustments to the Contract Sum and the Contract Time necessary to execute the change.
    - a. Include a list of quantities of products required or eliminated and unit costs, with total amount of purchases and credits to be made. If requested, furnish survey data to substantiate quantities.
    - b. Indicate applicable taxes, delivery charges, equipment rental, and amounts of trade discounts.
    - c. Include costs of labor and supervision directly attributable to the change.
    - d. Include an updated Contractor's construction schedule that indicates the effect of the change, including, but not limited to, changes in activity duration, start and finish times, and activity relationship. Use available total float before requesting an extension of the Contract Time.
    - e. Quotation Form: Use forms acceptable to Owner.

ARKANSAS DEPARTMENT OF TRANSPORTATION  
JOB NO. 42-24  
WALDRON REST AREA SEWER REPLACEMENT  
PROJECT MANUAL

- B. Contractor-Initiated Proposals: If latent or changed conditions require modifications to the Contract, Contractor may initiate a claim by submitting a request for a change to Owner.
1. Include a statement outlining reasons for the change and the effect of the change on the Work. Provide a complete description of the proposed change. Indicate the effect of the proposed change on the Contract Sum and the Contract Time.
  2. Include a list of quantities of products required or eliminated and unit costs, with total amount of purchases and credits to be made. If requested, furnish survey data to substantiate quantities.
  3. Indicate applicable taxes, delivery charges, equipment rental, and amounts of trade discounts.
  4. Include costs of labor and supervision directly attributable to the change.
  5. Include an updated Contractor's construction schedule that indicates the effect of the change, including, but not limited to, changes in activity duration, start and finish times, and activity relationship. Use available total float before requesting an extension of the Contract Time.
  6. Comply with requirements in Section 012500 "Substitution Procedures" if the proposed change requires substitution of one product or system for product or system specified.
  7. Proposal Request Form: Use form acceptable to Owner.

**1.3 CHANGE ORDER PROCEDURES**

- A. On Owner's approval of a Work Change Proposal Request, Owner will issue a Change Order for signature of Contractor .

**PART 2 - PRODUCTS (Not Used)**  
**PART 3 - EXECUTION (Not Used)**

**END OF SECTION 01 26 00**

ARKANSAS DEPARTMENT OF TRANSPORTATION  
JOB NO. 42-24  
WALDRON REST AREA SEWER REPLACEMENT  
PROJECT MANUAL

**SECTION 01 29 00 - PAYMENT PROCEDURES**

**PART 1 - GENERAL**

**1.1 SUMMARY**

- A. Section includes administrative and procedural requirements necessary to prepare and process Applications for Payment.
- B. Related Requirements:
  - 1. Section 012600 "Contract Modification Procedures" for administrative procedures for handling changes to the Contract.
  - 2. Section 013200 "Construction Progress Documentation" for administrative requirements governing the preparation and submittal of the Contractor's construction schedule.

**1.2 APPLICATIONS FOR PAYMENT**

- A. Each Application for Payment following the initial Application for Payment shall be consistent with previous applications and payments, as certified by Owner and paid for by Owner.
- B. Payment Application Times: Submit Application for Payment to Owner by the 15th of the month. The period covered by each Application for Payment is one month, ending on the last day of the month.
- C. Application for Payment Forms: Use forms acceptable to Owner.
- D. Application Preparation: Complete every entry on form. Notarize and execute by a person authorized to sign legal documents on behalf of Contractor. will return incomplete applications without action.
  - 1. Entries shall match data on the schedule of values and Contractor's construction schedule. Use updated schedules if revisions were made.
  - 2. Include amounts for work completed following previous Application for Payment, whether or not payment has been received. Include only amounts for work completed at time of Application for Payment.
  - 3. Include amounts of Change Orders and Construction Change Directives issued before last day of construction period covered by application.
  - 4. Indicate separate amounts for work being carried out under Owner-requested project acceleration.
- E. Stored Materials: Include in Application for Payment amounts applied for materials or equipment purchased or fabricated and stored, but not yet installed.

ARKANSAS DEPARTMENT OF TRANSPORTATION  
JOB NO. 42-24  
WALDRON REST AREA SEWER REPLACEMENT  
PROJECT MANUAL

Differentiate between items stored on-site and items stored off-site.

1. Provide certificate of insurance, evidence of transfer of title to Owner, and consent of surety to payment for stored materials.
  2. Provide supporting documentation that verifies amount requested, such as paid invoices. Match amount requested with amounts indicated on documentation; do not include overhead and profit on stored materials.
  3. Provide summary documentation for stored materials indicating the following:
    - a. Value of materials previously stored and remaining stored as of date of previous Applications for Payment.
    - b. Value of previously stored materials put in place after date of previous Application for Payment and on or before date of current Application for Payment.
    - c. Value of materials stored since date of previous Application for Payment and remaining stored as of date of current Application for Payment.
- F. Transmittal: Submit three signed and notarized original copies of each Application for Payment to by a method ensuring receipt within 24 hours. One copy shall include waivers of lien and similar attachments if required.
1. Transmit each copy with a transmittal form listing attachments and recording appropriate information about application.
- G. Waivers of Mechanic's Lien: With each Application for Payment, submit waivers of mechanic's lien from subcontractors, sub-subcontractors, and suppliers for construction period covered by the previous application.
1. Submit partial waivers on each item for amount requested in previous application, after deduction for retainage, on each item.
  2. When an application shows completion of an item, submit conditional final or full waivers.
  3. Owner reserves the right to designate which entities involved in the Work must submit waivers.
  4. Submit final Application for Payment with or preceded by conditional final waivers from every entity involved with performance of the Work covered by the application who is lawfully entitled to a lien.
  5. Waiver Forms: Submit executed waivers of lien on forms acceptable to Owner.
- H. Initial Application for Payment: Administrative actions and submittals that must precede or coincide with submittal of first Application for Payment include the following:
1. List of subcontractors.
  2. Schedule of values.



ARKANSAS DEPARTMENT OF TRANSPORTATION  
JOB NO. 42-24  
WALDRON REST AREA SEWER REPLACEMENT  
PROJECT MANUAL

3. Contractor's construction schedule (preliminary if not final).
  4. Combined Contractor's construction schedule (preliminary if not final) incorporating Work of multiple contracts, with indication of acceptance of schedule by each Contractor.
  5. Products list (preliminary if not final).
  6. Sustainable design action plans, including preliminary project materials cost data.
  7. Schedule of unit prices.
  8. Submittal schedule (preliminary if not final).
  9. List of Contractor's staff assignments.
  10. List of Contractor's principal consultants.
  11. Copies of building permits.
  12. Copies of authorizations and licenses from authorities having jurisdiction for performance of the Work.
  13. Initial progress report.
  14. Report of preconstruction conference.
  15. Certificates of insurance and insurance policies.
  16. Performance and payment bonds.
  17. Data needed to acquire Owner's insurance.
- I. Application for Payment at Substantial Completion: After Owner issues the Certificate of Substantial Completion, submit an Application for Payment showing 100 percent completion for portion of the Work claimed as substantially complete.
1. Include documentation supporting claim that the Work is substantially complete and a statement showing an accounting of changes to the Contract Sum.
    - a. Complete administrative actions, submittals, and Work preceding this application, as described in Section 017700 "Closeout Procedures."
  2. This application shall reflect Certificate(s) of Substantial Completion issued previously for Owner occupancy of designated portions of the Work.
- J. Final Payment Application: After completing Project closeout requirements, submit final Application for Payment with releases and supporting documentation not previously submitted and accepted, including, but not limited, to the following:
1. Evidence of completion of Project closeout requirements.
  2. Certification of completion of final punch list items.
  3. Insurance certificates for products and completed operations where required and proof that taxes, fees, and similar obligations were paid.
  4. Updated final statement, accounting for final changes to the Contract Sum.
  5. Evidence that claims have been settled.
  6. Final meter readings for utilities, a measured record of stored fuel, and similar data as of date of Substantial Completion or when Owner took

ARKANSAS DEPARTMENT OF TRANSPORTATION  
JOB NO. 42-24  
WALDRON REST AREA SEWER REPLACEMENT  
PROJECT MANUAL

possession of and assumed responsibility for corresponding elements of the Work.

7. Final liquidated damages settlement statement.
8. Proof that taxes, fees, and similar obligations are paid.
9. Waivers and releases.

**PART 2 - PRODUCTS (Not Used)**

**PART 3 - EXECUTION (Not Used)**

**END OF SECTION 01 29 00**

ARKANSAS DEPARTMENT OF TRANSPORTATION  
JOB NO. 42-24  
WALDRON REST AREA SEWER REPLACEMENT  
PROJECT MANUAL

**SECTION 01 31 00 - PROJECT MANAGEMENT AND COORDINATION**

**PART 1 - GENERAL**

**1.1 SUMMARY**

- A. Section includes administrative provisions for coordinating construction operations on Project, including, but not limited to, the following:
  - 1. General coordination procedures.
  - 2. RFIs.
  - 3. Digital project management procedures.
  - 4. Project meetings.
- B. Each contractor shall participate in coordination requirements. Certain areas of responsibility are assigned to a specific contractor.
- C. Related Requirements:
  - 1. Section 013200 "Construction Progress Documentation" for preparing and submitting Contractor's construction schedule.
  - 2. Section 017300 "Execution" for procedures for coordinating general installation and field-engineering services, including establishment of benchmarks and control points.
  - 3. Section 017700 "Closeout Procedures" for coordinating closeout of the Contract.

**1.2 INFORMATIONAL SUBMITTALS**

- A. Subcontract List: Prepare a written summary identifying individuals or firms proposed for each portion of the Work, including those who are to furnish products or equipment fabricated to a special design. Include the following information in tabular form:
  - 1. Name, address, telephone number, and email address of entity performing subcontract or supplying products.
  - 2. Number and title of related Specification Section(s) covered by subcontract.
  - 3. Drawing number and detail references, as appropriate, covered by subcontract.
- B. Key Personnel Names: Within 15 days of starting construction operations, submit a list of key personnel assignments, including superintendent and other personnel in attendance at Project site. Identify individuals and their duties and responsibilities; list addresses, cellular telephone numbers, and e-mail

ARKANSAS DEPARTMENT OF TRANSPORTATION  
JOB NO. 42-24  
WALDRON REST AREA SEWER REPLACEMENT  
PROJECT MANUAL

addresses. Provide names, addresses, and telephone numbers of individuals assigned as alternates in the absence of individuals assigned to Project.

### **1.3 GENERAL COORDINATION PROCEDURES**

- A. Coordination: Coordinate construction operations included in different Sections of the Specifications to ensure efficient and orderly installation of each part of the Work. Coordinate construction operations included in different Sections that depend on each other for proper installation, connection, and operation.
  - 1. Schedule construction operations in sequence required to obtain the best results, where installation of one part of the Work depends on installation of other components, before or after its own installation.
  - 2. Coordinate installation of different components to ensure maximum performance and accessibility for required maintenance, service, and repair.
  - 3. Make adequate provisions to accommodate items scheduled for later installation.
  
- B. Prepare memoranda for distribution to each party involved, outlining special procedures required for coordination. Include such items as required notices, reports, and list of attendees at meetings.
  - 1. Prepare similar memoranda for Owner and separate contractors if coordination of their Work is required.
  
- C. Administrative Procedures: Coordinate scheduling and timing of required administrative procedures with other construction activities to avoid conflicts and to ensure orderly progress of the Work. Such administrative activities include, but are not limited to, the following:
  - 1. Preparation of Contractor's construction schedule.
  - 2. Delivery and processing of submittals.
  - 3. Progress meetings.
  - 4. Preinstallation conferences.
  - 5. Project closeout activities.
  - 6. Startup and adjustment of systems.

### **1.4 REQUEST FOR INFORMATION (RFI)**

- A. General: Immediately on discovery of the need for additional information, clarification, or interpretation of the Contract Documents, Contractor shall prepare and submit an RFI in the form specified.
  - 1. Owner will return without response those RFIs submitted to Owner by other entities controlled by Contractor.
  - 2. Coordinate and submit RFIs in a prompt manner to avoid delays in

ARKANSAS DEPARTMENT OF TRANSPORTATION  
JOB NO. 42-24  
WALDRON REST AREA SEWER REPLACEMENT  
PROJECT MANUAL

Contractor's work or work of subcontractors.

- B. Content of the RFI: Include a detailed, legible description of item needing information or interpretation and the following:
1. Project name.
  2. Owner name.
  3. Owner's Project number.
  4. Date.
  5. Name of Contractor.
  6. RFI number, numbered sequentially.
  7. RFI subject.
  8. Specification Section number and title and related paragraphs, as appropriate.
  9. Drawing number and detail references, as appropriate.
  10. Field dimensions and conditions, as appropriate.
  11. Contractor's suggested resolution. If Contractor's suggested resolution impacts the Contract Time or the Contract Sum, Contractor shall state impact in the RFI.
  12. Contractor's signature.
  13. Attachments: Include sketches, descriptions, measurements, photos, Product Data, Shop Drawings, coordination drawings, and other information necessary to fully describe items needing interpretation.
    - a. Include dimensions, thicknesses, structural grid references, and details of affected materials, assemblies, and attachments on attached sketches.
- C. RFI Forms: Software-generated form with substantially the same content as indicated above, acceptable to Owner.
1. Attachments shall be electronic files in PDF format.
- D. Owner's Action: Owner will review each RFI, determine action required, and respond. Allow three days for Owner's response for each RFI. RFIs received by Owner after 1:00 p.m. will be considered as received the following working day.
1. The following Contractor-generated RFIs will be returned without action:
    - a. Requests for approval of submittals.
    - b. Requests for approval of substitutions.
    - c. Requests for approval of Contractor's means and methods.
    - d. Requests for coordination information already indicated in the Contract Documents.
    - e. Requests for adjustments in the Contract Time or the Contract Sum.
    - f. Requests for interpretation of Owner's actions on submittals.
    - g. Incomplete RFIs or inaccurately prepared RFIs.

ARKANSAS DEPARTMENT OF TRANSPORTATION  
JOB NO. 42-24  
WALDRON REST AREA SEWER REPLACEMENT  
PROJECT MANUAL

2. Owner's action may include a request for additional information, in which case Owner's time for response will date from time of receipt by Owner of additional information.
  3. Owner's action on RFIs that may result in a change to the Contract Time or the Contract Sum may be eligible for Contractor to submit Change Proposal according to Section 012600 "Contract Modification Procedures."
    - a. If Contractor believes the RFI response warrants change in the Contract Time or the Contract Sum, notify Owner and Construction Manager in writing within 5 days of receipt of the RFI response.
- E. RFI Log: Prepare, maintain, and submit a tabular log of RFIs organized by the RFI number. Submit log weekly. Software log with not less than the following:
1. Project name.
  2. Name and address of Contractor.
  3. RFI number, including RFIs that were returned without action or withdrawn.
  4. RFI description.
  5. Date the RFI was submitted.
  6. Date Owner's response was received.
  7. Identification of related Minor Change in the Work, Construction Change Directive, and Proposal Request, as appropriate.
- F. On receipt of Owner's action, update the RFI log and immediately distribute the RFI response to affected parties. Review response and notify Owner within three days if Contractor disagrees with response.

## 1.5 DIGITAL PROJECT MANAGEMENT PROCEDURES

- A. Use of Owner's Digital Data Files: Digital data files of Owner's CAD drawings will be provided by Owner for Contractor's use during construction.
1. Digital data files may be used by Contractor in preparing coordination drawings, Shop Drawings, and Project Record Drawings.
  2. Owner makes no representations as to the accuracy or completeness of digital data files as they relate to Contract Drawings.
  3. Digital Drawing Software Program: Contract Drawings are available in AutoCAD.
  4. Contractor shall execute a data licensing agreement in the form of Agreement form acceptable to Owner and Owner.
    - a. Subcontractors and other parties granted access by Contractor to Owner's digital data files shall execute a data licensing agreement in the form of Agreement acceptable to Owner and Owner.
  5. The following digital data files will be furnished for each appropriate discipline:

ARKANSAS DEPARTMENT OF TRANSPORTATION  
JOB NO. 42-24  
WALDRON REST AREA SEWER REPLACEMENT  
PROJECT MANUAL

- a. Site Plan.
- B. PDF Document Preparation: Where PDFs are required to be submitted to Owner, prepare as follows:
  - 1. Assemble complete submittal package into a single indexed file, incorporating submittal requirements of a single Specification Section and transmittal form with links enabling navigation to each item.
  - 2. Name file with submittal number or other unique identifier, including revision identifier.
  - 3. Certifications: Where digitally submitted certificates and certifications are required, provide a digital signature with digital certificate on where indicated.

## 1.6 PROJECT MEETINGS

- A. General: Schedule and conduct meetings and conferences at Project site unless otherwise indicated.
  - 1. Attendees: Inform participants and others involved, and individuals whose presence is required, of date and time of each meeting. Notify Owner and Owner of scheduled meeting dates and times a minimum of seven days prior to meeting.
  - 2. Agenda: Prepare the meeting agenda. Distribute the agenda to all invited attendees.
  - 3. Minutes: Entity responsible for conducting meeting will record significant discussions and agreements achieved. Distribute the meeting minutes to everyone concerned, including Owner and Owner, within three days of the meeting.
- B. Preconstruction Conference: Owner will schedule and conduct a preconstruction conference before starting construction, at a time convenient to Owner and Owner, but no later than 15 days after execution of the Agreement.
  - 1. Attendees: Authorized representatives of Owner; Contractor and its superintendent; major subcontractors; suppliers; and other concerned parties shall attend the conference. Participants at the conference shall be familiar with Project and authorized to conclude matters relating to the Work.
  - 2. Agenda: Discuss items of significance that could affect progress, including the following:
    - a. Responsibilities and personnel assignments.
    - b. Tentative construction schedule.
    - c. Phasing.
    - d. Critical work sequencing and long lead items.
    - e. Designation of key personnel and their duties.

ARKANSAS DEPARTMENT OF TRANSPORTATION  
JOB NO. 42-24  
WALDRON REST AREA SEWER REPLACEMENT  
PROJECT MANUAL

- f. Lines of communications.
  - g. Procedures for processing field decisions and Change Orders.
  - h. Procedures for RFIs.
  - i. Procedures for processing Applications for Payment.
  - j. Distribution of the Contract Documents.
  - k. Submittal procedures.
  - l. Preparation of Record Documents.
  - m. Use of the premises.
  - n. Work restrictions.
  - o. Working hours.
  - p. Owner's occupancy requirements.
  - q. Procedures for disruptions and shutdowns.
  - r. Parking availability.
  - s. Office, work, and storage areas.
  - t. Equipment deliveries and priorities.
3. Minutes: Entity responsible for conducting meeting will record and distribute meeting minutes.
- C. Progress Meetings: Conduct progress meetings at weekly intervals.
- 1. Coordinate dates of meetings with preparation of payment requests.
  - 2. Attendees: In addition to representatives of Owner, each contractor, subcontractor, supplier, and other entity concerned with current progress or involved in planning, coordination, or performance of future activities shall be represented at these meetings. All participants at the meeting shall be familiar with Project and authorized to conclude matters relating to the Work.
  - 3. Agenda: Review and correct or approve minutes of previous progress meeting. Review other items of significance that could affect progress. Include topics for discussion as appropriate to status of Project.
    - a. Contractor's Construction Schedule: Review progress since the last meeting. Determine whether each activity is on time, ahead of schedule, or behind schedule, in relation to Contractor's construction schedule. Determine how construction behind schedule will be expedited; secure commitments from parties involved to do so. Discuss whether schedule revisions are required to ensure that current and subsequent activities will be completed within the Contract Time.
      - 1) Review schedule for next period.
    - b. Review present and future needs of each entity present, including the following:
      - 1) Interface requirements.
      - 2) Sequence of operations.



ARKANSAS DEPARTMENT OF TRANSPORTATION  
JOB NO. 42-24  
WALDRON REST AREA SEWER REPLACEMENT  
PROJECT MANUAL

- 3) Status of submittals.
  - 4) Deliveries.
  - 5) Off-site fabrication.
  - 6) Access.
  - 7) Site use.
  - 8) Progress cleaning.
  - 9) Quality and work standards.
  - 10) Status of correction of deficient items.
  - 11) Field observations.
  - 12) Status of RFIs.
  - 13) Status of Proposal Requests.
  - 14) Pending changes.
  - 15) Status of Change Orders.
  - 16) Pending claims and disputes.
  - 17) Documentation of information for payment requests.
4. Minutes: Entity responsible for conducting the meeting will record and distribute the meeting minutes to each party present and to parties requiring information.
- a. Schedule Updating: Revise Contractor's construction schedule after each progress meeting, where revisions to the schedule have been made or recognized. Issue revised schedule concurrently with the report of each meeting.

**PART 2 - PRODUCTS (Not Used)**  
**PART 3 - EXECUTION (Not Used)**

**END OF SECTION 01 31 00**

ARKANSAS DEPARTMENT OF TRANSPORTATION  
JOB NO. 42-24  
WALDRON REST AREA SEWER REPLACEMENT  
PROJECT MANUAL

**SECTION 01 32 00 - CONSTRUCTION PROGRESS DOCUMENTATION**

**PART 1 - GENERAL**

**1.1 SUMMARY**

- A. Section includes administrative and procedural requirements for documenting the progress of construction during performance of the Work, including the following:
  - 1. Contractor's Construction Schedule.
  - 2. Construction schedule updating reports.
  - 3. Daily construction reports.
  - 4. Material location reports.
  - 5. Site condition reports.
  - 6. Unusual event reports.
  
- B. Related Requirements:
  - 1. Section 012900 "Payment Procedures" for schedule of values and requirements for use of cost-loaded schedule for Applications for Payment.
  - 2. Section 014000 "Quality Requirements" for schedule of tests and inspections.

**1.2 INFORMATIONAL SUBMITTALS**

- A. Format for Submittals: Submit required submittals in the following format:
  - 1. Working electronic copy of schedule file.
  - 2. PDF file.
  
- B. Contractor's Construction Schedule: Initial schedule, of size required to display entire schedule for entire construction period.
  
- C. Construction Schedule Updating Reports: Submit with Applications for Payment.
  
- D. Daily Construction Reports: Submit at weekly intervals.
  
- E. Material Location Reports: Submit at weekly intervals.
  
- F. Site Condition Reports: Submit at time of discovery of differing conditions.
  
- G. Unusual Event Reports: Submit at time of unusual event.
  
- H. Qualification Data: For scheduling consultant.

ARKANSAS DEPARTMENT OF TRANSPORTATION  
JOB NO. 42-24  
WALDRON REST AREA SEWER REPLACEMENT  
PROJECT MANUAL

**1.3 COORDINATION**

- A. Coordinate Contractor's Construction Schedule with the schedule of values, list of subcontracts, submittal schedule, progress reports, payment requests, and other required schedules and reports.
  - 1. Secure time commitments for performing critical elements of the Work from entities involved.
  - 2. Coordinate each construction activity in the network with other activities, and schedule them in proper sequence.

**1.4 CONTRACTOR'S CONSTRUCTION SCHEDULE**

- A. Computer Scheduling Software: Prepare schedules using current version of a program that is capable of managing construction schedules.
- B. Time Frame: Extend schedule from date established for the Notice to Proceed to date of Final Completion.
  - 1. Contract completion date to not be changed by submission of a schedule that shows an early completion date, unless specifically authorized by Change Order.
- C. Constraints: Include constraints and work restrictions indicated in the Contract Documents and as follows in schedule, and show how the sequence of the Work is affected.
  - 1. Phasing: Arrange list of activities on schedule by phase.
  - 2. Products Ordered in Advance: Include a separate activity for each product. Include delivery date indicated in Section 011000 "Summary." Delivery dates indicated stipulate the earliest possible delivery date.
  - 3. Work Restrictions: Show the effect of the following items on the schedule:
    - a. Limitations of continued occupancies.
    - b. Uninterruptible services.
    - c. Use-of-premises restrictions.
    - d. Seasonal variations.
    - e. Environmental control.
- D. Milestones: Include milestones indicated in the Contract Documents in schedule, including, but not limited to, the Notice to Proceed, Substantial Completion, and Final Completion.
- E. Contractor's Construction Schedule Updating: At monthly intervals, update schedule to reflect actual construction progress and activities. Issue schedule one week before each regularly scheduled progress meeting.
  - 1. Revise schedule immediately after each meeting or other activity where

ARKANSAS DEPARTMENT OF TRANSPORTATION  
JOB NO. 42-24  
WALDRON REST AREA SEWER REPLACEMENT  
PROJECT MANUAL

- revisions have been recognized or made. Issue updated schedule concurrently with the report of each such meeting.
2. Include a report with updated schedule that indicates every change, including, but not limited to, changes in logic, durations, actual starts and finishes, and activity durations.
  3. As the Work progresses, indicate Final Completion percentage for each activity.
- F. Recovery Schedule: When periodic update indicates the Work is 14 or more calendar days behind the current approved schedule, submit a separate recovery schedule indicating means by which Contractor intends to regain compliance with the schedule. Indicate changes to working hours, working days, crew sizes, equipment required to achieve compliance, and date by which recovery will be accomplished.
- G. Distribution: Distribute copies of approved schedule to Owner, separate contractors, testing and inspecting agencies, and other parties identified by Contractor with a need-to-know schedule responsibility.
1. Post copies in Project meeting rooms and temporary field offices.
  2. When revisions are made, distribute updated schedules to the same parties and post in the same locations. Delete parties from distribution when they have completed their assigned portion of the Work and are no longer involved in performance of construction activities.

## 1.5 GANTT-CHART SCHEDULE REQUIREMENTS

- A. Gantt-Chart Schedule: Submit a comprehensive, fully developed, horizontal, Gantt-chart-type, Contractor's Construction Schedule within 30 days of date established for the Notice to Proceed.
1. Base schedule on the startup construction schedule and additional information received since the start of Project.
- B. Preparation: Indicate each significant construction activity separately. Identify first workday of each week with a continuous vertical line.
1. For construction activities that require three months or longer to complete, indicate an estimated completion percentage in 10 percent increments within time bar.

## 1.6 REPORTS

- A. Daily Construction Reports: Prepare a daily construction report recording the following information concerning events at Project site:
1. List of subcontractors at Project site.

ARKANSAS DEPARTMENT OF TRANSPORTATION  
JOB NO. 42-24  
WALDRON REST AREA SEWER REPLACEMENT  
PROJECT MANUAL

2. List of separate contractors at Project site.
  3. Approximate count of personnel at Project site.
  4. Equipment at Project site.
  5. Material deliveries.
  6. High and low temperatures and general weather conditions, including presence of rain or snow.
  7. Testing and inspection.
  8. Accidents.
  9. Meetings and significant decisions.
  10. Unusual events.
  11. Stoppages, delays, shortages, and losses.
  12. Meter readings and similar recordings.
  13. Emergency procedures.
  14. Orders and requests of authorities having jurisdiction.
  15. Change Orders received and implemented.
  16. Construction Change Directives received and implemented.
  17. Services connected and disconnected.
  18. Equipment or system tests and startups.
  19. Partial completions and occupancies.
  20. Substantial Completions authorized.
- B. Material Location Reports: At weekly intervals, prepare and submit a comprehensive list of materials delivered to and stored at Project site. List to be cumulative, showing materials previously reported plus items recently delivered. Include with list a statement of progress on and delivery dates for materials or items of equipment fabricated or stored away from Project site. Indicate the following categories for stored materials:
1. Material stored prior to previous report and remaining in storage.
  2. Material stored prior to previous report and since removed from storage and installed.
  3. Material stored following previous report and remaining in storage.
- C. Site Condition Reports: Immediately on discovery of a difference between site conditions and the Contract Documents, prepare and submit a detailed report. Submit with a Request for Information. Include a detailed description of the differing conditions, together with recommendations for changing the Contract Documents.
- D. Unusual Event Reports: When an event of an unusual and significant nature occurs at Project site, whether or not related directly to the Work, prepare and submit a special report. List chain of events, persons participating, responses by Contractor's personnel, evaluation of results or effects, and similar pertinent information. Advise Owner in advance when these events are known or predictable.
1. Submit unusual event reports directly to Owner within one day(s) of an occurrence. Distribute copies of report to parties affected by the

ARKANSAS DEPARTMENT OF TRANSPORTATION  
JOB NO. 42-24  
WALDRON REST AREA SEWER REPLACEMENT  
PROJECT MANUAL

occurrence.

**PART 2 - PRODUCTS (Not Used)**  
**PART 3 - EXECUTION (Not Used)**

**END OF SECTION 01 32 00**

ARKANSAS DEPARTMENT OF TRANSPORTATION  
JOB NO. 42-24  
WALDRON REST AREA SEWER REPLACEMENT  
PROJECT MANUAL

**SECTION 01 33 00 - SUBMITTAL PROCEDURES**

**PART 1 - GENERAL**

**1.1 SUMMARY**

A. Section Includes:

1. Submittal schedule requirements.
2. Administrative and procedural requirements for submittals.

B. Related Requirements:

1. Section 012900 "Payment Procedures" for submitting Applications for Payment and the schedule of values.
2. Section 013100 "Project Management and Coordination" for submitting coordination drawings and subcontract list and for requirements for web-based Project software.
3. Section 013200 "Construction Progress Documentation" for submitting schedules and reports, including Contractor's construction schedule.
4. Section 014000 "Quality Requirements" for submitting test and inspection reports, and schedule of tests and inspections.
5. Section 017700 "Closeout Procedures" for submitting closeout submittals and maintenance material submittals.
6. Section 017823 "Operation and Maintenance Data" for submitting operation and maintenance manuals.
7. Section 017839 "Project Record Documents" for submitting record Drawings, record Specifications, and record Product Data.
8. Section 017900 "Demonstration and Training" for submitting video recordings of demonstration of equipment and training of Owner's personnel.

**1.2 SUBMITTAL SCHEDULE**

A. Submittal Schedule: Submit, as an action submittal, a list of submittals, arranged in chronological order by dates required by construction schedule. Include time required for review, ordering, manufacturing, fabrication, and delivery when establishing dates. Include additional time required for making corrections or revisions to submittals noted by Owner and additional time for handling and reviewing submittals required by those corrections.

1. Coordinate submittal schedule with list of subcontracts, the schedule of values, and Contractor's construction schedule.
2. Final Submittal Schedule: Submit concurrently with the first complete submittal of Contractor's construction schedule.

ARKANSAS DEPARTMENT OF TRANSPORTATION  
JOB NO. 42-24  
WALDRON REST AREA SEWER REPLACEMENT  
PROJECT MANUAL

- a. Submit revised submittal schedule as required to reflect changes in current status and timing for submittals.
3. Format: Arrange the following information in a tabular format:
  - a. Scheduled date for first submittal.
  - b. Specification Section number and title.
  - c. Submittal Category: Action; informational.
  - d. Name of subcontractor.
  - e. Description of the Work covered.
  - f. Scheduled date for Owner's final release or approval.
  - g. Scheduled date of fabrication.
  - h. Scheduled dates for installation.
  - i. Activity or event number.

### 1.3 SUBMITTAL FORMATS

- A. Submittal Information: Include the following information in each submittal:
  1. Project name.
  2. Date.
  3. Name of Contractor.
  4. Name of firm or entity that prepared submittal.
  5. Names of subcontractor, manufacturer, and supplier.
  6. Category and type of submittal.
  7. Submittal purpose and description.
  8. Number and title of Specification Section, with paragraph number and generic name for each of multiple items.
  9. Drawing number and detail references, as appropriate.
  10. Indication of full or partial submittal.
  11. Location(s) where product is to be installed, as appropriate.
  12. Other necessary identification.
  13. Remarks.
  14. Signature of transmitter.
- B. Options: Identify options requiring selection by Owner.
- C. Deviations and Additional Information: On each submittal, clearly indicate deviations from requirements in the Contract Documents, including minor variations and limitations; include relevant additional information and revisions, other than those requested by Owner on previous submittals. Indicate by highlighting on each submittal or noting on attached separate sheet.
- D. Electronic Submittals: Prepare submittals as PDF package, incorporating complete information into each PDF file. Name PDF file with submittal number.



ARKANSAS DEPARTMENT OF TRANSPORTATION  
JOB NO. 42-24  
WALDRON REST AREA SEWER REPLACEMENT  
PROJECT MANUAL

**1.4 SUBMITTAL PROCEDURES**

- A. Prepare and submit submittals required by individual Specification Sections. Types of submittals are indicated in individual Specification Sections.
  - 1. Email: Prepare submittals as PDF package and transmit to Owner by sending via email. Include PDF transmittal form. Include information in email subject line as requested by Owner.
    - a. Owner will return annotated file. Annotate and retain one copy of file as a digital Project Record Document file.
- B. Coordination: Coordinate preparation and processing of submittals with performance of construction activities.
  - 1. Coordinate each submittal with fabrication, purchasing, testing, delivery, other submittals, and related activities that require sequential activity.
  - 2. Submit all submittal items required for each Specification Section concurrently unless partial submittals for portions of the Work are indicated on approved submittal schedule.
  - 3. Submit action submittals and informational submittals required by the same Specification Section as separate packages under separate transmittals.
  - 4. Coordinate transmittal of submittals for related parts of the Work specified in different Sections, so processing will not be delayed because of need to review submittals concurrently for coordination.
    - a. Owner reserves the right to withhold action on a submittal requiring coordination with other submittals until related submittals are received.
- C. Processing Time: Allow time for submittal review, including time for resubmittals, as follows. Time for review shall commence on Owner's receipt of submittal. No extension of the Contract Time will be authorized because of failure to transmit submittals enough in advance of the Work to permit processing, including resubmittals.
  - 1. Initial Review: Allow 15 days for initial review of each submittal. Allow additional time if coordination with subsequent submittals is required. Owner will advise Contractor when a submittal being processed must be delayed for coordination.
  - 2. Intermediate Review: If intermediate submittal is necessary, process it in same manner as initial submittal.
  - 3. Resubmittal Review: Allow 15 days for review of each resubmittal.
- D. Resubmittals: Make resubmittals in same form and number of copies as initial submittal.
  - 1. Note date and content of previous submittal.

ARKANSAS DEPARTMENT OF TRANSPORTATION  
JOB NO. 42-24  
WALDRON REST AREA SEWER REPLACEMENT  
PROJECT MANUAL

2. Note date and content of revision in label or title block, and clearly indicate extent of revision.
  3. Resubmit submittals until they are marked with approval notation from Owner's action stamp.
- E. Distribution: Furnish copies of final submittals to manufacturers, subcontractors, suppliers, fabricators, installers, authorities having jurisdiction, and others as necessary for performance of construction activities. Show distribution on transmittal forms.
- F. Use for Construction: Retain complete copies of submittals on Project site. Use only final action submittals that are marked with approval notation from Owner's action stamp.

## 1.5 SUBMITTAL REQUIREMENTS

- A. Product Data: Collect information into a single submittal for each element of construction and type of product or equipment.
1. If information must be specially prepared for submittal because standard published data are unsuitable for use, submit as Shop Drawings, not as Product Data.
  2. Mark each copy of each submittal to show which products and options are applicable.
  3. Include the following information, as applicable:
    - a. Manufacturer's catalog cuts.
    - b. Manufacturer's product specifications.
    - c. Standard color charts.
    - d. Statement of compliance with specified referenced standards.
    - e. Testing by recognized testing agency.
    - f. Application of testing agency labels and seals.
    - g. Notation of coordination requirements.
    - h. Availability and delivery time information.
  4. For equipment, include the following in addition to the above, as applicable:
    - a. Wiring diagrams that show factory-installed wiring.
    - b. Printed performance curves.
    - c. Operational range diagrams.
    - d. Clearances required to other construction, if not indicated on accompanying Shop Drawings.
  5. Submit Product Data before Shop Drawings, and before or concurrently with Samples.
- B. Shop Drawings: Prepare Project-specific information, drawn accurately to scale. Do not base Shop Drawings on reproductions of the Contract Documents or

ARKANSAS DEPARTMENT OF TRANSPORTATION  
JOB NO. 42-24  
WALDRON REST AREA SEWER REPLACEMENT  
PROJECT MANUAL

standard printed data.

1. Preparation: Fully illustrate requirements in the Contract Documents. Include the following information, as applicable:
  - a. Identification of products.
  - b. Schedules.
  - c. Compliance with specified standards.
  - d. Notation of coordination requirements.
  - e. Notation of dimensions established by field measurement.
  - f. Relationship and attachment to adjoining construction clearly indicated.
  - g. Seal and signature of professional engineer if specified.
  
- C. Product Schedule: As required in individual Specification Sections, prepare a written summary indicating types of products required for the Work and their intended location. Include the following information in tabular form:
  1. Type of product. Include unique identifier for each product indicated in the Contract Documents or assigned by Contractor if none is indicated.
  2. Manufacturer and product name, and model number if applicable.
  3. Number and name of room or space.
  4. Location within room or space.
  
- D. Qualification Data: Prepare written information that demonstrates capabilities and experience of firm or person. Include lists of completed projects with project names and addresses, contact information of architects and owners, and other information specified.
  
- E. Design Data: Prepare and submit written and graphic information indicating compliance with indicated performance and design criteria in individual Specification Sections. Include list of assumptions and summary of loads. Include load diagrams if applicable. Provide name and version of software, if any, used for calculations. Number each page of submittal.
  
- F. Certificates:
  1. Certificates and Certifications Submittals: Submit a statement that includes signature of entity responsible for preparing certification. Certificates and certifications shall be signed by an officer or other individual authorized to sign documents on behalf of that entity. Provide a notarized signature where indicated.
  2. Installer Certificates: Submit written statements on manufacturer's letterhead, certifying that Installer complies with requirements in the Contract Documents and, where required, is authorized by manufacturer for this specific Project.
  3. Manufacturer Certificates: Submit written statements on manufacturer's letterhead, certifying that manufacturer complies with requirements in the

ARKANSAS DEPARTMENT OF TRANSPORTATION  
JOB NO. 42-24  
WALDRON REST AREA SEWER REPLACEMENT  
PROJECT MANUAL

Contract Documents. Include evidence of manufacturing experience where required.

4. Material Certificates: Submit written statements on manufacturer's letterhead, certifying that material complies with requirements in the Contract Documents.
5. Product Certificates: Submit written statements on manufacturer's letterhead, certifying that product complies with requirements in the Contract Documents.
6. Welding Certificates: Prepare written certification that welding procedures and personnel comply with requirements in the Contract Documents. Submit record of AWS B2.1/B2.1M on AWS forms. Include names of firms and personnel certified.

**1.6 OWNER'S REVIEW**

- A. Action Submittals: Owner will review each submittal, indicate corrections or revisions required, and return.
  1. PDF Submittals: Owner will indicate, via markup on each submittal, the appropriate action.
- B. Informational Submittals: Owner will review each submittal and will not return it, or will return it if it does not comply with requirements. Owner will forward each submittal to appropriate party.
- C. Partial submittals prepared for a portion of the Work will be reviewed when use of partial submittals has received prior approval from Owner.
- D. Incomplete submittals are unacceptable, will be considered nonresponsive, and will be returned for resubmittal without review.
- E. Owner will discard submittals received from sources other than Contractor.
- F. Submittals not required by the Contract Documents will be returned by Owner without action.

**PART 2 - PRODUCTS (Not Used)**  
**PART 3 - EXECUTION (Not Used)**

**END OF SECTION 01 33 00**

ARKANSAS DEPARTMENT OF TRANSPORTATION  
JOB NO. 42-24  
WALDRON REST AREA SEWER REPLACEMENT  
PROJECT MANUAL

**SECTION 01 40 00 - QUALITY REQUIREMENTS**

**PART 1 - GENERAL**

**1.1 SUMMARY**

- A. Section includes administrative and procedural requirements for quality assurance and quality control.
- B. Testing and inspection services are required to verify compliance with requirements specified or indicated. These services do not relieve Contractor of responsibility for compliance with the Contract Document requirements.
  - 1. Specific quality-assurance and quality-control requirements for individual work results are specified in their respective Specification Sections. Requirements in individual Sections may also cover production of standard products.
  - 2. Specified tests, inspections, and related actions do not limit Contractor's other quality-assurance and quality-control procedures that facilitate compliance with the Contract Document requirements.

**1.2 DELEGATED DESIGN SERVICES**

- A. Performance and Design Criteria: Where professional design services or certifications by a design professional are specifically required of Contractor by the Contract Documents, provide products and systems complying with specific performance and design criteria indicated.
  - 1. If criteria indicated are not sufficient to perform services or certification required, submit a written request for additional information to Owner.
- B. Delegated Design Services Statement: Submit a statement signed and sealed by the responsible design professional, for each product and system specifically assigned to Contractor to be designed or certified by a design professional, indicating that the products and systems are in compliance with performance and design criteria indicated. Include list of codes, loads, and other factors used in performing these services.

**1.3 CONFLICTING REQUIREMENTS**

- A. Conflicting Standards and Other Requirements: If compliance with two or more standards or requirements is specified and the standards or requirements establish different or conflicting requirements for minimum quantities or quality levels, inform the Owner regarding the conflict and obtain clarification prior to

ARKANSAS DEPARTMENT OF TRANSPORTATION  
JOB NO. 42-24  
WALDRON REST AREA SEWER REPLACEMENT  
PROJECT MANUAL

proceeding with the Work. Refer conflicting requirements that are different, but apparently equal, to Owner for clarification before proceeding.

- B. Minimum Quantity or Quality Levels: The quantity or quality level shown or specified is the minimum provided or performed. The actual installation may comply exactly with the minimum quantity or quality specified, or it may exceed the minimum within reasonable limits. To comply with these requirements, indicated numeric values are minimum or maximum, as appropriate, for the context of requirements. Refer uncertainties to Owner for a decision before proceeding.

#### **1.4 REPORTS AND DOCUMENTS**

- A. Manufacturer's Technical Representative's Field Reports: Prepare written information documenting manufacturer's technical representative's tests and inspections specified in other Sections. Include the following:
  - 1. Name, address, telephone number, and email address of technical representative making report.
  - 2. Statement on condition of substrates and their acceptability for installation of product.
  - 3. Statement that products at Project site comply with requirements.
  - 4. Summary of installation procedures being followed, whether they comply with requirements and, if not, what corrective action was taken.
  - 5. Results of operational and other tests and a statement of whether observed performance complies with requirements.
  - 6. Statement of whether conditions, products, and installation will affect warranty.
  - 7. Other required items indicated in individual Specification Sections.

#### **1.5 QUALITY ASSURANCE**

- A. Qualifications paragraphs in this article establish the minimum qualification levels required; individual Specification Sections specify additional requirements.
- B. Manufacturer Qualifications: A firm experienced in manufacturing products or systems similar to those indicated for this Project and with a record of successful in-service performance, as well as sufficient production capacity to produce required units. As applicable, procure products from manufacturers able to meet qualification requirements, warranty requirements, and technical or factory-authorized service representative requirements.
- C. Fabricator Qualifications: A firm experienced in producing products similar to those indicated for this Project and with a record of successful in-service performance, as well as sufficient production capacity to produce required units.
- D. Installer Qualifications: A firm or individual experienced in installing, erecting,

ARKANSAS DEPARTMENT OF TRANSPORTATION  
JOB NO. 42-24  
WALDRON REST AREA SEWER REPLACEMENT  
PROJECT MANUAL

applying, or assembling work similar in material, design, and extent to that indicated for this Project, whose work has resulted in construction with a record of successful in-service performance.

- E. **Manufacturer's Technical Representative Qualifications:** An authorized representative of manufacturer who is trained and approved by manufacturer to observe and inspect installation of manufacturer's products that are similar in material, design, and extent to those indicated for this Project.

## 1.6 QUALITY CONTROL

- A. **Contractor Responsibilities:** Tests and inspections not explicitly assigned to Owner are Contractor's responsibility. Perform additional quality-control activities, whether specified or not, to verify and document that the Work complies with requirements.
  - 1. Unless otherwise indicated, provide quality-control services specified and those required by authorities having jurisdiction. Perform quality-control services required of Contractor by authorities having jurisdiction, whether specified or not.
  - 2. Notify testing agencies at least 24 hours in advance of time when Work that requires testing or inspection will be performed.
  - 3. Where quality-control services are indicated as Contractor's responsibility, submit a certified written report, in duplicate, of each quality-control service.
  - 4. Testing and inspection requested by Contractor and not required by the Contract Documents are Contractor's responsibility.
  - 5. Submit additional copies of each written report directly to authorities having jurisdiction, when they so direct.
- B. **Retesting/Reinspecting:** Regardless of whether original tests or inspections were Contractor's responsibility, provide quality-control services, including retesting and reinspecting, for construction that replaced Work that failed to comply with the Contract Documents.
- C. **Manufacturer's Field Services:** Where indicated, engage a factory-authorized service representative to inspect field-assembled components and equipment installation, including service connections. Report results in writing as specified in Section 013300 "Submittal Procedures."
- D. **Manufacturer's Technical Services:** Where indicated, engage a manufacturer's technical representative to observe and inspect the Work. Manufacturer's technical representative's services include participation in preinstallation conferences, examination of substrates and conditions, verification of materials, observation of Installer activities, inspection of completed portions of the Work, and submittal of written reports.
- E. **Contractor's Associated Requirements and Services:** Cooperate with agencies

ARKANSAS DEPARTMENT OF TRANSPORTATION  
JOB NO. 42-24  
WALDRON REST AREA SEWER REPLACEMENT  
PROJECT MANUAL

and representatives performing required tests, inspections, and similar quality-control services, and provide reasonable auxiliary services as requested. Notify agency sufficiently in advance of operations to permit assignment of personnel. Provide the following:

1. Access to the Work.
  2. Incidental labor and facilities necessary to facilitate tests and inspections.
  3. Adequate quantities of representative samples of materials that require testing and inspection. Assist agency in obtaining samples.
- F. Coordination: Coordinate sequence of activities to accommodate required quality-assurance and quality-control services with a minimum of delay and to avoid necessity of removing and replacing construction to accommodate testing and inspection.
1. Schedule times for tests, inspections, obtaining samples, and similar activities.

**PART 2 - PRODUCTS (Not Used)**  
**PART 3 - EXECUTION**

**3.1 TEST AND INSPECTION LOG**

- A. Test and Inspection Log: Prepare a record of tests and inspections. Include the following:
1. Date test or inspection was conducted.
  2. Description of the Work tested or inspected.
  3. Date test or inspection results were transmitted to Owner.
  4. Identification of testing agency or special inspector conducting test or inspection.

**3.2 REPAIR AND PROTECTION**

- A. General: On completion of testing, inspection, sample-taking, and similar services, repair damaged construction and restore substrates and finishes.
1. Provide materials and comply with installation requirements specified in other Specification Sections or matching existing substrates and finishes. Restore patched areas and extend restoration into adjoining areas with durable seams that are as invisible as possible. Comply with the Contract Document requirements for cutting and patching in Section 017300 "Execution."
- B. Protect construction exposed by or for quality-control service activities.



ARKANSAS DEPARTMENT OF TRANSPORTATION  
JOB NO. 42-24  
WALDRON REST AREA SEWER REPLACEMENT  
PROJECT MANUAL

- C. Repair and protection are Contractor's responsibility, regardless of the assignment of responsibility for quality-control services.

**END OF SECTION 01 40 00**

ARKANSAS DEPARTMENT OF TRANSPORTATION  
JOB NO. 42-24  
WALDRON REST AREA SEWER REPLACEMENT  
PROJECT MANUAL

**SECTION 01 60 00 - PRODUCT REQUIREMENTS**

**PART 1 - GENERAL**

**1.1 SUMMARY**

- A. The Work of This Section Includes: Administrative and procedural requirements for selection of products for use in Project; product delivery, storage, and handling; manufacturers' standard warranties on products; special warranties; and comparable products.
- B. Related Requirements:
  - 1. Section 011000 "Summary" for Contractor requirements related to Owner-furnished products.
  - 2. Section 012500 "Substitution Procedures" for requests for substitutions.
  - 3. Section 017700 "Closeout Procedures" for submitting warranties.

**1.2 QUALITY ASSURANCE**

- A. Compatibility of Options: If Contractor is given option of selecting between two or more products for use on Project, select product compatible with products previously selected, even if previously selected products were also options.
- B. Identification of Products: Except for required labels and operating data, do not attach or imprint manufacturer or product names or trademarks on exposed surfaces of products or equipment that will be exposed to view in occupied spaces or on the exterior.
  - 1. Labels: Locate required product labels and stamps on a concealed surface, or, where required for observation following installation, on a visually accessible surface that is inconspicuous.
  - 2. Equipment Nameplates: Provide a permanent nameplate on each item of service- or power-operated equipment. Locate on a visually accessible but inconspicuous surface. Include information essential for operation, including the following:
    - a. Name of product and manufacturer.
    - b. Model and serial number.
    - c. Capacity.
    - d. Speed.
    - e. Ratings.

ARKANSAS DEPARTMENT OF TRANSPORTATION  
JOB NO. 42-24  
WALDRON REST AREA SEWER REPLACEMENT  
PROJECT MANUAL

**1.3 COORDINATION**

- A. Modify or adjust affected work as necessary to integrate work of approved comparable products and approved substitutions.

**1.4 PRODUCT DELIVERY, STORAGE, AND HANDLING**

- A. Deliver, store, and handle products, using means and methods that will prevent damage, deterioration, and loss, including theft and vandalism. Comply with manufacturer's written instructions.

- B. Delivery and Handling:

1. Schedule delivery to minimize long-term storage at Project site and to prevent overcrowding of construction spaces.
2. Coordinate delivery with installation time to ensure minimum holding time for items that are flammable, hazardous, easily damaged, or sensitive to deterioration, theft, and other losses.
3. Deliver products to Project site in an undamaged condition in manufacturer's original sealed container or other packaging system, complete with labels and instructions for handling, storing, unpacking, protecting, and installing.
4. Inspect products on delivery to determine compliance with the Contract Documents and that products are undamaged and properly protected.

- C. Storage:

1. Provide a secure location and enclosure at Project site for storage of materials and equipment.
2. Store products to allow for inspection and measurement of quantity or counting of units.
3. Store materials in a manner that will not endanger Project structure.
4. Store products that are subject to damage by the elements under cover in a weathertight enclosure above ground, with ventilation adequate to prevent condensation and with adequate protection from wind.
5. Protect foam plastic from exposure to sunlight, except to extent necessary for period of installation and concealment.
6. Comply with product manufacturer's written instructions for temperature, humidity, ventilation, and weather-protection requirements for storage.
7. Protect stored products from damage and liquids from freezing.

**1.5 PRODUCT WARRANTIES**

- A. Warranties specified in other Sections are to be in addition to, and run concurrent with, other warranties required by the Contract Documents. Manufacturer's disclaimers and limitations on product warranties do not relieve Contractor of obligations under requirements of the Contract Documents.

ARKANSAS DEPARTMENT OF TRANSPORTATION  
JOB NO. 42-24  
WALDRON REST AREA SEWER REPLACEMENT  
PROJECT MANUAL

1. **Manufacturer's Warranty:** Written standard warranty form furnished by individual manufacturer for a particular product and issued in the name of Owner or endorsed by manufacturer to Owner.
  2. **Special Warranty:** Written warranty required by the Contract Documents to provide specific rights for Owner and issued in the name of Owner or endorsed by manufacturer to Owner.
- B. **Special Warranties:** Prepare a written document that contains appropriate terms and identification, ready for execution.
1. **Manufacturer's Standard Form:** Modified to include Project-specific information and properly executed.
  2. **Specified Form:** When specified forms are included in the Project Manual, prepare a written document, using indicated form properly executed.
  3. See other Sections for specific content requirements and particular requirements for submitting special warranties.
- C. **Submittal Time:** Comply with requirements in Section 017700 "Closeout Procedures."

## **PART 2 - PRODUCTS**

### **2.1 PRODUCT SELECTION PROCEDURES**

- A. **General Product Requirements:** Provide products that comply with the Contract Documents, are undamaged and, unless otherwise indicated, are new at time of installation.
1. Provide products complete with accessories, trim, finish, fasteners, and other items needed for a complete installation and indicated use and effect.
  2. **Standard Products:** If available, and unless custom products or nonstandard options are specified, provide standard products of types that have been produced and used successfully in similar situations on other projects.
  3. Owner reserves the right to limit selection to products with warranties meeting requirements of the Contract Documents.
  4. Where products are accompanied by the term "as selected," Owner will make selection.
  5. Descriptive, performance, and reference standard requirements in Specifications establish salient characteristics of products.
- B. **Product Selection Procedures:**
1. **Basis-of-Design Product:** Where Specifications name a product, or refer to a product indicated on Drawings, and include a list of manufacturers, provide the specified or indicated product or a comparable product by one of the other named manufacturers. Drawings and Specifications may

ARKANSAS DEPARTMENT OF TRANSPORTATION  
JOB NO. 42-24  
WALDRON REST AREA SEWER REPLACEMENT  
PROJECT MANUAL

additionally indicate sizes, profiles, dimensions, and other characteristics that are based on the product named. Comply with requirements in "Comparable Products" Article for consideration of an unnamed product by one of the other named manufacturers.

- a. For approval of products by unnamed manufacturers, comply with requirements in Section 012500 "Substitution Procedures" for substitutions for convenience.

## 2.2 COMPARABLE PRODUCTS

- A. Conditions for Consideration of Comparable Products: Owner will consider Contractor's request for comparable product when the following conditions are satisfied. If the following conditions are not satisfied, Owner may return requests without action, except to record noncompliance with the following requirements:
  1. Evidence that proposed product does not require revisions to the Contract Documents, is consistent with the Contract Documents, will produce the indicated results, and is compatible with other portions of the Work.
  2. Detailed comparison of significant qualities of proposed product with those of the named basis-of-design product. Significant product qualities include attributes such as type, function, in-service performance and physical properties, weight, dimension, durability, visual characteristics, and other specific features and requirements.
  3. Evidence that proposed product provides specified warranty.
  4. List of similar installations for completed projects, with project names and addresses and names and addresses of architects and owners, if requested.
  5. Samples, if requested.
- B. Owner's Action on Comparable Products Submittal: If necessary, Owner will request additional information or documentation for evaluation within seven days of receipt of a request for a comparable product. Owner will notify Contractor of approval or rejection of proposed comparable product within 15 days of receipt of request, or seven days of receipt of additional information or documentation, whichever is later.
  1. Owner's Approval of Submittal: Marked with approval notation from Owner's action stamp. See Section 013300 "Submittal Procedures."
  2. Use product specified if Owner does not issue a decision on use of a comparable product request within time allocated.
- C. Submittal Requirements, Single-Step Process: When acceptable to Owner, incorporate specified submittal requirements of individual Specification Section in combined submittal for comparable products. Approval by Owner of Contractor's request for use of comparable product and of individual submittal requirements will also satisfy other submittal requirements.

ARKANSAS DEPARTMENT OF TRANSPORTATION  
JOB NO. 42-24  
WALDRON REST AREA SEWER REPLACEMENT  
PROJECT MANUAL

**PART 3 - EXECUTION (Not Used)**

**END OF SECTION 01 60 00**

ARKANSAS DEPARTMENT OF TRANSPORTATION  
JOB NO. 42-24  
WALDRON REST AREA SEWER REPLACEMENT  
PROJECT MANUAL

**SECTION 01 73 00 - EXECUTION**

**PART 1 - GENERAL**

**1.1 SUMMARY**

- A. Section includes general administrative and procedural requirements governing execution of the Work, including, but not limited to, the following:
  - 1. Construction layout.
  - 2. Field engineering.
  - 3. Installation.
  - 4. Starting and adjusting.
  - 5. Protection of installed construction.
  - 6. Correction of the Work.
  
- B. Related Requirements:
  - 1. Section 013300 "Submittal Procedures" for submitting surveys.
  - 2. Section 017700 "Closeout Procedures" for submitting final property survey with Project Record Documents, recording of Owner-accepted deviations from indicated lines and levels, replacing defective work, and final cleaning.

**1.2 INFORMATIONAL SUBMITTALS**

- A. Qualification Data: For land surveyor.
- B. Certified Surveys: Submit two copies signed by land surveyor.
- C. Certificates: Submit certificate signed by land surveyor, certifying that location and elevation of improvements comply with requirements.

**1.3 QUALITY ASSURANCE**

- A. Land Surveyor Qualifications: A professional land surveyor who is legally qualified to practice in jurisdiction where Project is located and who is experienced in providing land-surveying services of the kind indicated.
- B. Manufacturer's Installation Instructions: Obtain and maintain on-site manufacturer's written recommendations and instructions for installation of specified products and equipment.

ARKANSAS DEPARTMENT OF TRANSPORTATION  
JOB NO. 42-24  
WALDRON REST AREA SEWER REPLACEMENT  
PROJECT MANUAL

**PART 2 - PRODUCTS**

**2.1 MATERIALS**

- A. Comply with requirements specified in other Sections.
- B. In-Place Materials: Use materials for patching identical to in-place materials. For exposed surfaces, use materials that visually match in-place adjacent surfaces to the fullest extent possible.
  - 1. If identical materials are unavailable or cannot be used, use materials that, when installed, will provide a match acceptable to Owner for the visual and functional performance of in-place materials. Use materials that are not considered hazardous.

**PART 3 - EXECUTION**

**3.1 EXAMINATION**

- A. Existing Conditions: The existence and location of underground and other utilities and construction indicated as existing are not guaranteed. Before beginning sitework, investigate and verify the existence and location of underground utilities, mechanical and electrical systems, and other construction affecting the Work.
  - 1. Before construction, verify the location and invert elevation at points of connection of sanitary sewer, storm sewer, gas service piping, and water-service piping; underground electrical services; and other utilities.
  - 2. Furnish location data for work related to Project that must be performed by public utilities serving Project site.
- B. Examination and Acceptance of Conditions: Before proceeding with each component of the Work, examine substrates, areas, and conditions, with Installer or Applicator present where indicated, for compliance with requirements for installation tolerances and other conditions affecting performance. Record observations.
  - 1. Examine roughing-in for mechanical and electrical systems to verify actual locations of connections before equipment and fixture installation.
  - 2. Examine walls, floors, and roofs for suitable conditions where products and systems are to be installed.
  - 3. Verify compatibility with and suitability of substrates, including compatibility with existing finishes or primers.
- C. Proceed with installation only after unsatisfactory conditions have been corrected. Proceeding with the Work indicates acceptance of surfaces and



ARKANSAS DEPARTMENT OF TRANSPORTATION  
JOB NO. 42-24  
WALDRON REST AREA SEWER REPLACEMENT  
PROJECT MANUAL

conditions.

### 3.2 PREPARATION

- A. Existing Utility Information: Furnish information to Owner that is necessary to adjust, move, or relocate existing utility structures, utility poles, lines, services, or other utility appurtenances located in or affected by construction. Coordinate with authorities having jurisdiction.
- B. Field Measurements: Take field measurements as required to fit the Work properly. Recheck measurements before installing each product. Where portions of the Work are indicated to fit to other construction, verify dimensions of other construction by field measurements before fabrication. Coordinate fabrication schedule with construction progress to avoid delaying the Work.
- C. Space Requirements: Verify space requirements and dimensions of items shown diagrammatically on Drawings.
- D. Review of Contract Documents and Field Conditions: Immediately on discovery of the need for clarification of the Contract Documents, submit a request for information to Owner in accordance with requirements in Section 013100 "Project Management and Coordination."

### 3.3 CONSTRUCTION LAYOUT

- A. Verification: Before proceeding to lay out the Work, verify layout information shown on Drawings, in relation to the property survey and existing benchmarks and existing conditions. If discrepancies are discovered, notify Owner promptly.
- B. Engage a land surveyor experienced in laying out the Work, using the following accepted surveying practices:
  - 1. Establish benchmarks and control points to set lines and levels at each story of construction and elsewhere as needed to locate each element of Project.
  - 2. Establish limits on use of Project site.
  - 3. Establish dimensions within tolerances indicated. Do not scale Drawings to obtain required dimensions.
  - 4. Inform installers of lines and levels to which they must comply.
  - 5. Check the location, level and plumb, of every major element as the Work progresses.
  - 6. Notify Owner when deviations from required lines and levels exceed allowable tolerances.
  - 7. Close site surveys with an error of closure equal to or less than the standard established by authorities having jurisdiction.
- C. Site Improvements: Locate and lay out site improvements, including pavements,

ARKANSAS DEPARTMENT OF TRANSPORTATION  
JOB NO. 42-24  
WALDRON REST AREA SEWER REPLACEMENT  
PROJECT MANUAL

grading, fill and topsoil placement, utility slopes, and rim and invert elevations.

### 3.4 FIELD ENGINEERING

- A. Identification: Owner will identify existing benchmarks, control points, and property corners.
- B. Reference Points: Locate existing permanent benchmarks, control points, and similar reference points before beginning the Work. Preserve and protect permanent benchmarks and control points during construction operations.
  - 1. Do not change or relocate existing benchmarks or control points without prior written approval of Owner. Report lost or destroyed permanent benchmarks or control points promptly. Report the need to relocate permanent benchmarks or control points to Owner before proceeding.
  - 2. Replace lost or destroyed permanent benchmarks and control points promptly. Base replacements on the original survey control points.
- C. Benchmarks: Establish and maintain a minimum of two permanent benchmarks on Project site, referenced to data established by survey control points. Comply with authorities having jurisdiction for type and size of benchmark.
  - 1. Record benchmark locations, with horizontal and vertical data, on Project Record Documents.
  - 2. Where the actual location or elevation of layout points cannot be marked, provide temporary reference points sufficient to locate the Work.
  - 3. Remove temporary reference points when no longer needed. Restore marked construction to its original condition.

### 3.5 INSTALLATION

- A. Locate the Work and components of the Work accurately, in correct alignment and elevation, as indicated.
  - 1. Make vertical work plumb, and make horizontal work level.
  - 2. Where space is limited, install components to maximize space available for maintenance and ease of removal for replacement.
  - 3. Conceal pipes, ducts, and wiring in finished areas unless otherwise indicated.
  - 4. Maintain minimum headroom clearance of 96 inches in occupied spaces and 90 inches in unoccupied spaces, unless otherwise indicated on Drawings.
- B. Comply with manufacturer's written instructions and recommendations for installing products in applications indicated.
- C. Install products at the time and under conditions that will ensure satisfactory

ARKANSAS DEPARTMENT OF TRANSPORTATION  
JOB NO. 42-24  
WALDRON REST AREA SEWER REPLACEMENT  
PROJECT MANUAL

results as judged by Owner. Maintain conditions required for product performance until Substantial Completion.

- D. Conduct construction operations, so no part of the Work is subjected to damaging operations or loading in excess of that expected during normal conditions of occupancy of type expected for Project.
- E. Sequence the Work and allow adequate clearances to accommodate movement of construction items on-site and placement in permanent locations.
- F. Tools and Equipment: Select tools or equipment that minimize production of excessive noise levels.
- G. Templates: Obtain and distribute to the parties involved templates for Work specified to be factory prepared and field installed. Check Shop Drawings of other portions of the Work to confirm that adequate provisions are made for locating and installing products to comply with indicated requirements.
- H. Attachment: Provide blocking and attachment plates and anchors and fasteners of adequate size and number to securely anchor each component in place, accurately located and aligned with other portions of the Work. Where size and type of attachments are not indicated, verify size and type required for load conditions with manufacturer.
  - 1. Mounting Heights: Where mounting heights are not indicated, mount components at heights directed by Owner.
  - 2. Allow for building movement, including thermal expansion and contraction.
  - 3. Coordinate installation of anchorages. Furnish setting drawings, templates, and directions for installing anchorages, including sleeves, concrete inserts, anchor bolts, and items with integral anchors, that are to be embedded in concrete or masonry. Deliver such items to Project site in time for installation.
- I. Joints: Make joints of uniform width. Where joint locations in exposed Work are not indicated, arrange joints for the best visual effect, as judged by Owner. Fit exposed connections together to form hairline joints.

### **3.6 CUTTING AND PATCHING**

- A. General: Employ skilled workers to perform cutting and patching. Proceed with cutting and patching at the earliest feasible time, and complete without delay.
  - 1. Cut in-place construction to provide for installation of other components or performance of other construction, and subsequently patch as required to restore surfaces to their original condition.
- B. Existing Warranties: Remove, replace, patch, and repair materials and surfaces cut or damaged during installation or cutting and patching operations, by

ARKANSAS DEPARTMENT OF TRANSPORTATION  
JOB NO. 42-24  
WALDRON REST AREA SEWER REPLACEMENT  
PROJECT MANUAL

methods and with materials so as not to void existing warranties.

- C. Temporary Support: Provide temporary support of Work to be cut.
- D. Protection: Protect in-place construction during cutting and patching to prevent damage. Provide protection from adverse weather conditions for portions of Project that might be exposed during cutting and patching operations.
- E. Existing Utility Services and Mechanical/Electrical Systems: Where existing services/systems are required to be removed, relocated, or abandoned, bypass such services/systems before cutting to minimize interruption to occupied areas.
- F. Cutting: Cut in-place construction by sawing, drilling, breaking, chipping, grinding, and similar operations, including excavation, using methods least likely to damage elements retained or adjoining construction. If possible, review proposed procedures with original Installer; comply with original Installer's written recommendations.
  - 1. In general, use hand or small power tools designed for sawing and grinding, not hammering and chopping. Cut holes and slots neatly to minimum size required, and with minimum disturbance of adjacent surfaces. Temporarily cover openings when not in use.
  - 2. Finished Surfaces: Cut or drill from the exposed or finished side into concealed surfaces.
  - 3. Concrete: Cut using a cutting machine, such as an abrasive saw or a diamond-core drill.
  - 4. Excavating and Backfilling: Comply with requirements in applicable Sections where required by cutting and patching operations.
  - 5. Proceed with patching after construction operations requiring cutting are complete.
- G. Patching: Patch construction by filling, repairing, refinishing, closing up, and similar operations following performance of other Work. Patch with durable seams that are as invisible as practicable, as judged by Owner. Provide materials and comply with installation requirements specified in other Sections, where applicable.
  - 1. Inspection: Where feasible, test and inspect patched areas after completion to demonstrate physical integrity of installation.
  - 2. Exposed Finishes: Restore exposed finishes of patched areas and extend finish restoration into retained adjoining construction in a manner that will eliminate evidence of patching and refinishing.
    - a. Clean piping, conduit, and similar features before applying paint or other finishing materials.
    - b. Restore damaged pipe covering to its original condition.

ARKANSAS DEPARTMENT OF TRANSPORTATION  
JOB NO. 42-24  
WALDRON REST AREA SEWER REPLACEMENT  
PROJECT MANUAL

**3.7      PROGRESS CLEANING**

- A.    Clean Project site and work areas daily, including common areas. Enforce requirements strictly. Dispose of materials lawfully.
  - 1.    Comply with requirements in NFPA 241 for removal of combustible waste materials and debris.
  - 2.    Do not hold waste materials more than seven days during normal weather or three days if the temperature is expected to rise above **80 deg F**.
  - 3.    Containerize hazardous and unsanitary waste materials separately from other waste. Mark containers appropriately and dispose of legally, in accordance with regulations.
    - a.    Use containers intended for holding waste materials of type to be stored.
  - 4.    Coordinate progress cleaning for joint-use areas where Contractor and other contractors are working concurrently.
- B.    Site: Maintain Project site free of waste materials and debris.
- C.    Work Areas: Clean areas where Work is in progress to the level of cleanliness necessary for proper execution of the Work.
  - 1.    Remove liquid spills promptly.
  - 2.    Where dust would impair proper execution of the Work, broom-clean or vacuum the entire work area, as appropriate.
- D.    Installed Work: Keep installed work clean. Clean installed surfaces in accordance with written instructions of manufacturer or fabricator of product installed, using only cleaning materials specifically recommended. If specific cleaning materials are not recommended, use cleaning materials that are not hazardous to health or property and that will not damage exposed surfaces.
- E.    Concealed Spaces: Remove debris from concealed spaces before enclosing the space.
- F.    Exposed Surfaces: Clean exposed surfaces and protect as necessary to ensure freedom from damage and deterioration at time of Substantial Completion.
- G.    Waste Disposal: Do not bury or burn waste materials on-site. Do not wash waste materials down sewers or into waterways.
- H.    During handling and installation, clean and protect construction in progress and adjoining materials already in place. Apply protective covering where required to ensure protection from damage or deterioration at Substantial Completion.
- I.    Clean and provide maintenance on completed construction as frequently as necessary through the remainder of the construction period. Adjust and lubricate

ARKANSAS DEPARTMENT OF TRANSPORTATION  
JOB NO. 42-24  
WALDRON REST AREA SEWER REPLACEMENT  
PROJECT MANUAL

operable components to ensure operability without damaging effects.

- J. Limiting Exposures: Supervise construction operations to ensure that no part of the construction, completed or in progress, is subject to harmful, dangerous, damaging, or otherwise deleterious exposure during the construction period.

### **3.8 STARTING AND ADJUSTING**

- A. Start equipment and operating components to confirm proper operation. Remove malfunctioning units, replace with new units, and retest.
- B. Adjust equipment for proper operation. Adjust operating components for proper operation without binding.
- C. Test each piece of equipment to verify proper operation. Test and adjust controls and safeties. Replace damaged and malfunctioning controls and equipment.
- D. Manufacturer's Field Service: Comply with qualification requirements in Section 014000 "Quality Requirements."

### **3.9 PROTECTION OF INSTALLED CONSTRUCTION**

- A. Provide final protection and maintain conditions that ensure installed Work is without damage or deterioration at time of Substantial Completion.
- B. Protection of Existing Items: Provide protection and ensure that existing items to remain undisturbed by construction are maintained in condition that existed at commencement of the Work.
- C. Comply with manufacturer's written instructions for temperature and relative humidity.

### **3.10 CORRECTION OF THE WORK**

- A. Repair or remove and replace damaged, defective, or nonconforming Work. Restore damaged substrates and finishes.
  - 1. Repairing includes replacing defective parts, refinishing damaged surfaces, touching up with matching materials, and properly adjusting operating equipment.
- B. Repair Work previously completed and subsequently damaged during construction period. Repair to like-new condition.
- C. Restore permanent facilities used during construction to their specified condition.

ARKANSAS DEPARTMENT OF TRANSPORTATION  
JOB NO. 42-24  
WALDRON REST AREA SEWER REPLACEMENT  
PROJECT MANUAL

- D. Remove and replace damaged surfaces that are exposed to view if surfaces cannot be repaired without visible evidence of repair.
- E. Repair components that do not operate properly. Remove and replace operating components that cannot be repaired.
- F. Remove and replace chipped, scratched, and broken glass or reflective surfaces.

**END OF SECTION 01 73 00**

ARKANSAS DEPARTMENT OF TRANSPORTATION  
JOB NO. 42-24  
WALDRON REST AREA SEWER REPLACEMENT  
PROJECT MANUAL

**SECTION 01 77 00 - CLOSEOUT PROCEDURES**

**PART 1 - GENERAL**

**1.1 SUMMARY**

- A. Section includes administrative and procedural requirements for Contract closeout, including, but not limited to, the following:
  - 1. Substantial Completion procedures.
  - 2. Final Completion procedures.
  - 3. List of incomplete items.
  - 4. Submittal of Project warranties.
  - 5. Final cleaning.
  
- B. Related Requirements:
  - 1. Section 012900 "Payment Procedures" for requirements for Applications for Payment for Substantial Completion and Final Completion.
  - 2. Section 017823 "Operation and Maintenance Data" for additional operation and maintenance manual requirements.
  - 3. Section 017839 "Project Record Documents" for submitting Record Drawings, Record Specifications, and Record Product Data.
  - 4. Section 017900 "Demonstration and Training" for requirements to train Owner's maintenance personnel to adjust, operate, and maintain products, equipment, and systems.

**1.2 ACTION SUBMITTALS**

- A. Contractor's List of Incomplete Items: Initial submittal at Substantial Completion.
- B. Certified List of Incomplete Items: Final submittal at Final Completion.

**1.3 CLOSEOUT SUBMITTALS**

- A. Certificates of Release: From authorities having jurisdiction.

**1.4 SUBSTANTIAL COMPLETION PROCEDURES**

- A. Contractor's List of Incomplete Items: Prepare and submit a list of items to be completed and corrected (Contractor's "punch list"), indicating the value of each item on the list and reasons why the Work is incomplete.



ARKANSAS DEPARTMENT OF TRANSPORTATION  
JOB NO. 42-24  
WALDRON REST AREA SEWER REPLACEMENT  
PROJECT MANUAL

- B. Submittals Prior to Substantial Completion: Complete the following a minimum of 10 days prior to requesting inspection for determining date of Substantial Completion. List items below that are incomplete at time of request.
1. Certificates of Release: Obtain and submit releases from authorities having jurisdiction, permitting Owner unrestricted use of the Work and access to services and utilities. Include occupancy permits, operating certificates, and similar releases.
  2. Submit closeout submittals specified in other Division 01 Sections, including Project Record Documents, operation and maintenance manuals, damage or settlement surveys, property surveys, and similar final record information.
  3. Submit closeout submittals specified in individual Sections, including specific warranties, workmanship bonds, maintenance service agreements, final certifications, and similar documents.
  4. Submit maintenance material submittals specified in individual Sections, including tools, spare parts, extra materials, and similar items, and deliver to location designated by . Label with manufacturer's name and model number.
- C. Procedures Prior to Substantial Completion: Complete the following a minimum of 10 days prior to requesting inspection for determining date of Substantial Completion. List items below that are incomplete at time of request.
1. Advise Owner of pending insurance changeover requirements.
  2. Make final changeover of permanent locks and deliver keys to Owner. Advise Owner's personnel of changeover in security provisions.
  3. Complete startup and testing of systems and equipment.
  4. Perform preventive maintenance on equipment used prior to Substantial Completion.
  5. Instruct Owner's personnel in operation, adjustment, and maintenance of products, equipment, and systems. Submit demonstration and training video recordings specified in Section 017900 "Demonstration and Training."
  6. Advise Owner of changeover in utility services.
  7. Participate with Owner in conducting inspection and walkthrough with local emergency responders.
  8. Terminate and remove temporary facilities from Project site, along with mockups, construction tools, and similar elements.
  9. Complete final cleaning requirements.
  10. Touch up paint and otherwise repair and restore marred exposed finishes to eliminate visual defects.
- D. Inspection: Submit a written request for inspection to determine Substantial Completion a minimum of 10 days prior to date the Work will be completed and ready for final inspection and tests. On receipt of request, Owner will either proceed with inspection or notify Contractor of unfulfilled requirements. Owner will prepare the Certificate of Substantial Completion after inspection or will notify

ARKANSAS DEPARTMENT OF TRANSPORTATION  
JOB NO. 42-24  
WALDRON REST AREA SEWER REPLACEMENT  
PROJECT MANUAL

Contractor of items, either on Contractor's list or additional items identified by Owner, that must be completed or corrected before certificate will be issued.

1. Request reinspection when the Work identified in previous inspections as incomplete is completed or corrected.
2. Results of completed inspection will form the basis of requirements for Final Completion.

## **1.5 FINAL COMPLETION PROCEDURES**

- A. Submittals Prior to Final Completion: Before requesting final inspection for determining Final Completion, complete the following:
  1. Submit a final Application for Payment in accordance with Section 012900 "Payment Procedures."
  2. Certified List of Incomplete Items: Submit certified copy of Owner's Substantial Completion inspection list of items to be completed or corrected (punch list), endorsed and dated by Owner. Certified copy of the list will state that each item has been completed or otherwise resolved for acceptance.
- B. Inspection: Submit a written request for final inspection to determine acceptance a minimum of 10 days prior to date the Work will be completed and ready for final inspection and tests. On receipt of request, Owner will either proceed with inspection or notify Contractor of unfulfilled requirements. Owner will prepare a final Certificate for Payment after inspection or will notify Contractor of construction that must be completed or corrected before certificate will be issued.
  1. Request reinspection when the Work identified in previous inspections as incomplete is completed or corrected.

## **1.6 LIST OF INCOMPLETE ITEMS**

- A. Organization of List: Include name and identification of each space and area affected by construction operations for incomplete items and items needing correction including, if necessary, areas disturbed by Contractor that are outside the limits of construction.
  1. Include the following information at the top of each page:
    - a. Project name.
    - b. Date.
    - c. Name of Contractor.
    - d. Page number.

ARKANSAS DEPARTMENT OF TRANSPORTATION  
JOB NO. 42-24  
WALDRON REST AREA SEWER REPLACEMENT  
PROJECT MANUAL

**1.7 SUBMITTAL OF PROJECT WARRANTIES**

- A. Time of Submittal: Submit written warranties on request of Owner for designated portions of the Work where warranties are indicated to commence on dates other than date of Substantial Completion, or when delay in submittal of warranties might limit Owner's rights under warranty.
- B. Organize warranty documents into an orderly sequence based on the table of contents of Project Manual.
- C. Warranty Electronic File: Provide warranties and bonds in PDF format. Assemble complete warranty and bond submittal package into a single electronic PDF file with bookmarks enabling navigation to each item. Provide bookmarked table of contents at beginning of document.
  - 1. Submit on digital media acceptable to Owner.
- D. Provide additional copies of each warranty to include in operation and maintenance manuals.

**PART 2 - PRODUCTS  
PART 3 - EXECUTION**

**3.1 FINAL CLEANING**

- A. General: Perform final cleaning. Conduct cleaning and waste-removal operations to comply with local laws and ordinances and Federal and local environmental and antipollution regulations.

**3.2 CORRECTION OF THE WORK**

- A. Complete repair and restoration operations required by "Correction of the Work" Article in Section 017300 "Execution" before requesting inspection for determination of Substantial Completion.

**END OF SECTION 01 77 00**

ARKANSAS DEPARTMENT OF TRANSPORTATION  
JOB NO. 42-24  
WALDRON REST AREA SEWER REPLACEMENT  
PROJECT MANUAL

**SECTION 01 78 23 - OPERATION AND MAINTENANCE DATA**

**PART 1 - GENERAL**

**1.1 SUMMARY**

- A. Section Includes: Administrative and procedural requirements for preparing operation and maintenance manuals, including the following:
  - 1. Operation and maintenance documentation directory manuals.
  - 2. Systems and equipment operation manuals.
  - 3. Systems and equipment maintenance manuals.
  - 4. Product maintenance manuals.
- B. Related Requirements:
  - 1. Section 013300 "Submittal Procedures" for submitting copies of submittals for operation and maintenance manuals.

**1.2 CLOSEOUT SUBMITTALS**

- A. Submit operation and maintenance manuals indicated. Provide content for each manual as specified in individual Specification Sections, and as reviewed and approved at the time of Section submittals. Submit reviewed manual content formatted and organized as required by this Section.
  - 1. Owner will comment on whether content of operation and maintenance submittals is acceptable.
  - 2. Where applicable, clarify and update reviewed manual content to correspond to revisions and field conditions.
- B. Format: Submit operation and maintenance manuals in the following format:
  - 1. Submit on digital media acceptable to Owner. Enable reviewer comments on draft submittals.
- C. Final Manual Submittal: Submit each manual in final form prior to requesting inspection for Substantial Completion and at least 15 days before commencing demonstration and training. Owner will return copy with comments.
  - 1. Correct or revise each manual to comply with Owner's comments. Submit copies of each corrected manual within 15 days of receipt of Owner's comments and prior to commencing demonstration and training.
- D. Comply with Section 017700 "Closeout Procedures" for schedule for submitting

ARKANSAS DEPARTMENT OF TRANSPORTATION  
JOB NO. 42-24  
WALDRON REST AREA SEWER REPLACEMENT  
PROJECT MANUAL

operation and maintenance documentation.

### **1.3 FORMAT OF OPERATION AND MAINTENANCE MANUALS**

- A. Manuals, Electronic Files: Submit manuals in the form of a multiple file composite electronic PDF file for each manual type required.
  - 1. Electronic Files: Use electronic files prepared by manufacturer where available. Where scanning of paper documents is required, configure scanned file for minimum readable file size.
  - 2. File Names and Bookmarks: Bookmark individual documents based on file names. Name document files to correspond to system, subsystem, and equipment names used in manual directory and table of contents. Group documents for each system and subsystem into individual composite bookmarked files, then create composite manual, so that resulting bookmarks reflect the system, subsystem, and equipment names in a readily navigated file tree. Configure electronic manual to display bookmark panel on opening file.

### **1.4 REQUIREMENTS FOR EMERGENCY, OPERATION, AND MAINTENANCE MANUALS**

- A. Organization of Manuals: Unless otherwise indicated, organize each manual into a separate section for each system and subsystem, and a separate section for each piece of equipment not part of a system. Each manual to contain the following materials, in the order listed:
  - 1. Title page.
  - 2. Table of contents.
  - 3. Manual contents.
- B. Title Page: Include the following information:
  - 1. Subject matter included in manual.
  - 2. Name and address of Project.
  - 3. Name and address of Owner.
  - 4. Date of submittal.
  - 5. Name and contact information for Contractor.
  - 6. Name and contact information for Construction Manager.
  - 7. Name and contact information for Owner.
  - 8. Name and contact information for Commissioning Authority.
  - 9. Names and contact information for major consultants to the Owner that designed the systems contained in the manuals.
  - 10. Cross-reference to related systems in other operation and maintenance manuals.
- C. Table of Contents: List each product included in manual, identified by product

ARKANSAS DEPARTMENT OF TRANSPORTATION  
JOB NO. 42-24  
WALDRON REST AREA SEWER REPLACEMENT  
PROJECT MANUAL

name, indexed to the content of the volume, and cross-referenced to Specification Section number in Project Manual.

- D. Identification: In the documentation directory and in each operation and maintenance manual, identify each system, subsystem, and piece of equipment with same designation used in the Contract Documents. If no designation exists, assign a designation in accordance with ASHRAE Guideline 4, "Preparation of Operating and Maintenance Documentation for Building Systems."

## **1.5 SYSTEMS AND EQUIPMENT OPERATION MANUALS**

- A. Systems and Equipment Operation Manual: Assemble a complete set of data indicating operation of each system, subsystem, and piece of equipment not part of a system. Include information required for daily operation and management, operating standards, and routine and special operating procedures.
1. Engage a factory-authorized service representative to assemble and prepare information for each system, subsystem, and piece of equipment not part of a system.
  2. Prepare a separate manual for each system and subsystem, in the form of an instructional manual for use by Owner's operating personnel.
- B. Content: In addition to requirements in this Section, include operation data required in individual Specification Sections and the following information:
1. System, subsystem, and equipment descriptions. Use designations for systems and equipment indicated on Contract Documents.
  2. Performance and design criteria if Contractor has delegated design responsibility.
  3. Operating standards.
  4. Operating procedures.
  5. Operating logs.
  6. Wiring diagrams.
  7. Control diagrams.
  8. Piped system diagrams.
  9. Precautions against improper use.
  10. License requirements including inspection and renewal dates.
- C. Descriptions: Include the following:
1. Product name and model number. Use designations for products indicated on Contract Documents.
  2. Manufacturer's name.
  3. Equipment identification with serial number of each component.
  4. Equipment function.
  5. Operating characteristics.
  6. Limiting conditions.

ARKANSAS DEPARTMENT OF TRANSPORTATION  
JOB NO. 42-24  
WALDRON REST AREA SEWER REPLACEMENT  
PROJECT MANUAL

7. Performance curves.
  8. Engineering data and tests.
  9. Complete nomenclature and number of replacement parts.
- D. Operating Procedures: Include the following, as applicable:
1. Startup procedures.
  2. Equipment or system break-in procedures.
  3. Routine and normal operating instructions.
  4. Regulation and control procedures.
  5. Instructions on stopping.
  6. Normal shutdown instructions.
  7. Seasonal and weekend operating instructions.
  8. Required sequences for electric or electronic systems.
  9. Special operating instructions and procedures.
- E. Systems and Equipment Controls: Describe the sequence of operation, and diagram controls as installed.
- F. Piped Systems: Diagram piping as installed, and identify color coding where required for identification.

## 1.6 SYSTEMS AND EQUIPMENT MAINTENANCE MANUALS

- A. Systems and Equipment Maintenance Manuals: Assemble a complete set of data indicating maintenance of each system, subsystem, and piece of equipment not part of a system. Include manufacturers' maintenance documentation, preventive maintenance procedures and frequency, repair procedures, wiring and systems diagrams, lists of spare parts, and warranty information.
1. Engage a factory-authorized service representative to assemble and prepare information for each system, subsystem, and piece of equipment not part of a system.
  2. Prepare a separate manual for each system and subsystem, in the form of an instructional manual for use by Owner's operating personnel.
- B. Content: For each system, subsystem, and piece of equipment not part of a system, include source information, manufacturers' maintenance documentation, maintenance procedures, maintenance and service schedules, spare parts list and source information, maintenance service contracts, and warranties and bonds as described below.
- C. Source Information: List each system, subsystem, and piece of equipment included in manual, identified by product name and arranged to match manual's table of contents. For each product, list name, address, and telephone number of Installer or supplier and maintenance service agent, and cross-reference Specification Section number and title in Project Manual and drawing or

ARKANSAS DEPARTMENT OF TRANSPORTATION  
JOB NO. 42-24  
WALDRON REST AREA SEWER REPLACEMENT  
PROJECT MANUAL

schedule designation or identifier where applicable.

- D. **Manufacturers' Maintenance Documentation:** Include the following information for each component part or piece of equipment:
  - 1. Standard maintenance instructions and bulletins; include only sheets pertinent to product or component installed. Mark each sheet to identify each product or component incorporated into the Work. If data include more than one item in a tabular format, identify each item using appropriate references from the Contract Documents. Identify data applicable to the Work and delete references to information not applicable.
    - a. Prepare supplementary text if manufacturers' standard printed data are not available and where the information is necessary for proper operation and maintenance of equipment or systems.
  - 2. Drawings, diagrams, and instructions required for maintenance, including disassembly and component removal, replacement, and assembly.
  - 3. Identification and nomenclature of parts and components.
  - 4. List of items recommended to be stocked as spare parts.
- E. **Maintenance Procedures:** Include the following information and items that detail essential maintenance procedures:
  - 1. Test and inspection instructions.
  - 2. Troubleshooting guide.
  - 3. Precautions against improper maintenance.
  - 4. Disassembly; component removal, repair, and replacement; and reassembly instructions.
  - 5. Aligning, adjusting, and checking instructions.
  - 6. Demonstration and training video recording, if available.
- F. **Maintenance and Service Schedules:** Include service and lubrication requirements, list of required lubricants for equipment, and separate schedules for preventive and routine maintenance and service with standard time allotment.
  - 1. **Scheduled Maintenance and Service:** Tabulate actions for daily, weekly, monthly, quarterly, semiannual, and annual frequencies.
  - 2. **Maintenance and Service Record:** Include manufacturers' forms for recording maintenance.
- G. **Spare Parts List and Source Information:** Include lists of replacement and repair parts, with parts identified and cross-referenced to manufacturers' maintenance documentation and local sources of maintenance materials and related services.
- H. **Warranties and Bonds:** Include copies of warranties and bonds and lists of circumstances and conditions that would affect validity of warranties or bonds.
  - 1. Include procedures to follow and required notifications for warranty claims.



ARKANSAS DEPARTMENT OF TRANSPORTATION  
JOB NO. 42-24  
WALDRON REST AREA SEWER REPLACEMENT  
PROJECT MANUAL

- I. Drawings: Prepare drawings supplementing manufacturers' printed data to illustrate the relationship of component parts of equipment and systems and to illustrate control sequence and flow diagrams. Coordinate these drawings with information contained in record Drawings to ensure correct illustration of completed installation.
  - 1. Do not use original project record documents as part of maintenance manuals.

**1.7 PRODUCT MAINTENANCE MANUALS**

- A. Product Maintenance Manual: Assemble a complete set of maintenance data indicating care and maintenance of each product, material, and finish incorporated into the Work.
- B. Content: Organize manual into a separate section for each product, material, and finish. Include source information, product information, maintenance procedures, repair materials and sources, and warranties and bonds, as described below.
- C. Source Information: List each product included in manual, identified by product name and arranged to match manual's table of contents. For each product, list name, address, and telephone number of Installer or supplier and maintenance service agent, and cross-reference Specification Section number and title in Project Manual and drawing or schedule designation or identifier where applicable.
- D. Product Information: Include the following, as applicable:
  - 1. Product name and model number.
  - 2. Manufacturer's name.
  - 3. Color, pattern, and texture.
  - 4. Material and chemical composition.
  - 5. Reordering information for specially manufactured products.
- E. Maintenance Procedures: Include manufacturer's written recommendations and the following:
  - 1. Inspection procedures.
  - 2. Types of cleaning agents to be used and methods of cleaning.
  - 3. List of cleaning agents and methods of cleaning detrimental to product.
  - 4. Schedule for routine cleaning and maintenance.
  - 5. Repair instructions.
- F. Repair Materials and Sources: Include lists of materials and local sources of materials and related services.
- G. Warranties and Bonds: Include copies of warranties and bonds and lists of

ARKANSAS DEPARTMENT OF TRANSPORTATION  
JOB NO. 42-24  
WALDRON REST AREA SEWER REPLACEMENT  
PROJECT MANUAL

circumstances and conditions that would affect validity of warranties or bonds.

1. Include procedures to follow and required notifications for warranty claims.

**PART 2 - PRODUCTS (Not Used)**  
**PART 3 - EXECUTION (Not Used)**

**END OF SECTION 01 78 23**

ARKANSAS DEPARTMENT OF TRANSPORTATION  
JOB NO. 42-24  
WALDRON REST AREA SEWER REPLACEMENT  
PROJECT MANUAL

**SECTION 01 78 39 - PROJECT RECORD DOCUMENTS**

**PART 1 - GENERAL**

**1.1 SUMMARY**

- A. Section includes administrative and procedural requirements for Project Record Documents, including the following:
  - 1. Record Drawings.
  - 2. Record specifications.
  - 3. Record Product Data.
  - 4. Miscellaneous record submittals.
  
- B. Related Requirements:
  - 1. Section 017300 "Execution" for final property survey.
  - 2. Section 017700 "Closeout Procedures" for general closeout procedures.
  - 3. Section 017823 "Operation and Maintenance Data" for operation and maintenance manual requirements.

**1.2 CLOSEOUT SUBMITTALS**

- A. Record Drawings: Comply with the following:
  - 1. Number of Copies: Submit copies of Record Drawings as follows:
    - a. Final Submittal:
      - 1) Submit PDF electronic files of scanned Record Prints and three set(s) of file prints.
      - 2) Print each drawing, whether or not changes and additional information were recorded.
  
- B. Record Specifications: Submit annotated PDF electronic files of Project's Specifications, including addenda and Contract modifications.
  
- C. Record Product Data: Submit annotated PDF electronic files and directories of each submittal.
  - 1. Where record Product Data are required as part of operation and maintenance manuals, submit duplicate marked-up Product Data as a component of manual.

ARKANSAS DEPARTMENT OF TRANSPORTATION  
JOB NO. 42-24  
WALDRON REST AREA SEWER REPLACEMENT  
PROJECT MANUAL

**1.3 RECORD DRAWINGS**

- A. Record Prints: Maintain one set of marked-up paper copies of the Contract Drawings and Shop Drawings, incorporating new and revised drawings as modifications are issued.
1. Preparation: Mark record prints to show the actual installation, where installation varies from that shown originally. Require individual or entity who obtained record data, whether individual or entity is Installer, subcontractor, or similar entity, to provide information for preparation of corresponding marked-up record prints.
    - a. Give particular attention to information on concealed elements that would be difficult to identify or measure and record later.
    - b. Accurately record information in an acceptable drawing technique.
    - c. Record data as soon as possible after obtaining it.
    - d. Record and check the markup before enclosing concealed installations.
    - e. Cross-reference record prints to corresponding photographic documentation.
  2. Content: Types of items requiring marking include, but are not limited to, the following:
    - a. Dimensional changes to Drawings.
    - b. Revisions to details shown on Drawings.
    - c. Depths of foundations.
    - d. Locations and depths of underground utilities.
    - e. Revisions to routing of piping and conduits.
    - f. Revisions to electrical circuitry.
    - g. Actual equipment locations.
    - h. Duct size and routing.
    - i. Locations of concealed internal utilities.
    - j. Changes made by Change Order or Construction Change Directive.
    - k. Changes made following Owner's written orders.
    - l. Details not on the original Contract Drawings.
    - m. Field records for variable and concealed conditions.
    - n. Record information on the Work that is shown only schematically.
  3. Mark the Contract Drawings and Shop Drawings completely and accurately. Use personnel proficient at recording graphic information in production of marked-up record prints.
  4. Mark record prints with erasable, red-colored pencil. Use other colors to distinguish between changes for different categories of the Work at same location.
  5. Mark important additional information that was either shown schematically or omitted from original Drawings.
  6. Note Construction Change Directive numbers, alternate numbers, Change

ARKANSAS DEPARTMENT OF TRANSPORTATION  
JOB NO. 42-24  
WALDRON REST AREA SEWER REPLACEMENT  
PROJECT MANUAL

Order numbers, and similar identification, where applicable.

- B. Record Digital Data Files: Immediately before inspection for Certificate of Substantial Completion, review marked-up record prints with Owner. When authorized, prepare a full set of corrected digital data files of the Contract Drawings, as follows:
  - 1. Format: Annotated PDF electronic file with comment function enabled.
  - 2. Incorporate changes and additional information previously marked on record prints. Delete, redraw, and add details and notations where applicable.
  - 3. Refer instances of uncertainty to Owner for resolution.
  
- C. Format: Identify and date each Record Drawing; include the designation "PROJECT RECORD DRAWING" in a prominent location.
  - 1. Record Prints: Organize record prints into manageable sets. Bind each set with durable paper cover sheets. Include identification on cover sheets.
  - 2. Format: Annotated PDF electronic file with comment function enabled.
  - 3. Record Digital Data Files: Organize digital data information into separate electronic files that correspond to each sheet of the Contract Drawings. Name each file with the sheet identification. Include identification in each digital data file.
  - 4. Identification: As follows:
    - a. Project name.
    - b. Date.
    - c. Designation "PROJECT RECORD DRAWINGS."
    - d. Name of Contractor.

#### 1.4 RECORD SPECIFICATIONS

- A. Preparation: Mark Specifications to indicate the actual product installation, where installation varies from that indicated in Specifications, addenda, and Contract modifications.
  - 1. Give particular attention to information on concealed products and installations that cannot be readily identified and recorded later.
  - 2. Mark copy with the proprietary name and model number of products, materials, and equipment furnished, including substitutions and product options selected.
  - 3. Record the name of manufacturer, supplier, Installer, and other information necessary to provide a record of selections made.
  - 4. For each principal product, indicate whether Record Product Data has been submitted in operation and maintenance manuals instead of submitted as Record Product Data.
  - 5. Note related Change Orders, Record Product Data, and Record Drawings

ARKANSAS DEPARTMENT OF TRANSPORTATION  
JOB NO. 42-24  
WALDRON REST AREA SEWER REPLACEMENT  
PROJECT MANUAL

where applicable.

- B. Format: Submit record specifications as annotated PDF electronic file.

### **1.5 RECORD PRODUCT DATA**

- A. Recording: Maintain one copy of each submittal during the construction period for Project Record Document purposes. Post changes and revisions to Project Record Documents as they occur; do not wait until end of Project.
- B. Preparation: Mark Product Data to indicate the actual product installation where installation varies substantially from that indicated in Product Data submittal.
  - 1. Give particular attention to information on concealed products and installations that cannot be readily identified and recorded later.
  - 2. Include significant changes in the product delivered to Project site and changes in manufacturer's written instructions for installation.
  - 3. Note related Change Orders, Record Specifications, and Record Drawings where applicable.
- C. Format: Submit Record Product Data as annotated PDF electronic file.
  - 1. Include Record Product Data directory organized by Specification Section number and title, electronically linked to each item of Record Product Data.

### **1.6 MISCELLANEOUS RECORD SUBMITTALS**

- A. Assemble miscellaneous records required by other Specification Sections for miscellaneous record keeping and submittal in connection with actual performance of the Work. Bind or file miscellaneous records and identify each, ready for continued use and reference.
- B. Format: Submit miscellaneous record submittals as PDF electronic file.
  - 1. Include miscellaneous record submittals directory organized by Specification Section number and title, electronically linked to each item of miscellaneous record submittals.

### **1.7 MAINTENANCE OF RECORD DOCUMENTS**

- A. Maintenance of Record Documents: Store Record Documents in the field office apart from the Contract Documents used for construction. Do not use Project Record Documents for construction purposes. Maintain Record Documents in good order and in a clean, dry, legible condition, protected from deterioration and loss. Provide access to Project Record Documents for Owner's reference during normal working hours.

ARKANSAS DEPARTMENT OF TRANSPORTATION  
JOB NO. 42-24  
WALDRON REST AREA SEWER REPLACEMENT  
PROJECT MANUAL

**PART 2 - PRODUCTS (Not Used)**  
**PART 3 - EXECUTION (Not Used)**

**END OF SECTION 01 78 39**

ARKANSAS DEPARTMENT OF TRANSPORTATION  
JOB NO. 42-24  
WALDRON REST AREA SEWER REPLACEMENT  
PROJECT MANUAL

**SECTION 01 79 00 - DEMONSTRATION AND TRAINING**

**PART 1 - GENERAL**

**1.1 SUMMARY**

- A. Section includes administrative and procedural requirements for instructing Owner's personnel, including the following:
  - 1. Instruction in operation and maintenance of systems, subsystems, and equipment.

**1.2 INFORMATIONAL SUBMITTALS**

- A. Instruction Program: Submit outline of instructional program for demonstration and training, including a list of training modules and a schedule of proposed dates, times, length of instruction time, and instructors' names for each training module. Include learning objective and outline for each training module.
  - 1. Indicate proposed training modules using manufacturer-produced demonstration and training video recordings for systems, equipment, and products in lieu of video recording of live instructional module.
- B. Attendance Record: For each training module, submit list of participants and length of instruction time.
- C. Evaluations: For each participant and for each training module, submit results and documentation of performance-based test.

**1.3 QUALITY ASSURANCE**

- A. Facilitator Qualifications: A firm or individual experienced in training or educating maintenance personnel in a training program similar in content and extent to that indicated for this Project, and whose work has resulted in training or education with a record of successful learning performance.
- B. Instructor Qualifications: A factory-authorized service representative, complying with requirements in Section 014000 "Quality Requirements," experienced in operation and maintenance procedures and training.

**1.4 COORDINATION**

- A. Coordinate instruction schedule with Owner's operations. Adjust schedule as



ARKANSAS DEPARTMENT OF TRANSPORTATION  
JOB NO. 42-24  
WALDRON REST AREA SEWER REPLACEMENT  
PROJECT MANUAL

required to minimize disrupting Owner's operations and to ensure availability of Owner's personnel.

- B. Coordinate instructors, including providing notification of dates, times, length of instruction time, and course content.
- C. Coordinate content of training modules with content of approved emergency, operation, and maintenance manuals. Do not submit instruction program until operation and maintenance data have been reviewed and approved by Owner.

## 1.5 INSTRUCTION PROGRAM

- A. Program Structure: Develop an instruction program that includes individual training modules for each system and for equipment not part of a system, as required by individual Specification Sections.
- B. Training Modules: Develop a learning objective and teaching outline for each module. Include a description of specific skills and knowledge that participant is expected to master. For each module, include instruction for the following as applicable to the system, equipment, or component:
  - 1. Basis of System Design, Operational Requirements, and Criteria: Include the following:
    - a. System, subsystem, and equipment descriptions.
    - b. Performance and design criteria if Contractor is delegated design responsibility.
    - c. Operating standards.
    - d. Regulatory requirements.
    - e. Equipment function.
    - f. Operating characteristics.
    - g. Limiting conditions.
    - h. Performance curves.
  - 2. Documentation: Review the following items in detail:
    - a. Emergency manuals.
    - b. Systems and equipment operation manuals.
    - c. Systems and equipment maintenance manuals.
    - d. Product maintenance manuals.
    - e. Project Record Documents.
    - f. Identification systems.
    - g. Warranties and bonds.
    - h. Maintenance service agreements and similar continuing commitments.
  - 3. Emergencies: Include the following, as applicable:

ARKANSAS DEPARTMENT OF TRANSPORTATION  
JOB NO. 42-24  
WALDRON REST AREA SEWER REPLACEMENT  
PROJECT MANUAL

- a. Instructions on meaning of warnings, trouble indications, and error messages.
  - b. Instructions on stopping.
  - c. Shutdown instructions for each type of emergency.
  - d. Operating instructions for conditions outside of normal operating limits.
  - e. Sequences for electric or electronic systems.
  - f. Special operating instructions and procedures.
4. Operations: Include the following, as applicable:
- a. Startup procedures.
  - b. Equipment or system break-in procedures.
  - c. Routine and normal operating instructions.
  - d. Regulation and control procedures.
  - e. Control sequences.
  - f. Safety procedures.
  - g. Instructions on stopping.
  - h. Normal shutdown instructions.
  - i. Operating procedures for emergencies.
  - j. Operating procedures for system, subsystem, or equipment failure.
  - k. Seasonal and weekend operating instructions.
  - l. Required sequences for electric or electronic systems.
  - m. Special operating instructions and procedures.
5. Adjustments: Include the following:
- a. Alignments.
  - b. Checking adjustments.
  - c. Noise and vibration adjustments.
  - d. Economy and efficiency adjustments.
6. Troubleshooting: Include the following:
- a. Diagnostic instructions.
  - b. Test and inspection procedures.
7. Maintenance: Include the following:
- a. Inspection procedures.
  - b. Types of cleaning agents to be used and methods of cleaning.
  - c. List of cleaning agents and methods of cleaning detrimental to product.
  - d. Procedures for routine cleaning.
  - e. Procedures for preventive maintenance.
  - f. Procedures for routine maintenance.
  - g. Instruction on use of special tools.

ARKANSAS DEPARTMENT OF TRANSPORTATION  
JOB NO. 42-24  
WALDRON REST AREA SEWER REPLACEMENT  
PROJECT MANUAL

8. Repairs: Include the following:
  - a. Diagnosis instructions.
  - b. Repair instructions.
  - c. Disassembly; component removal, repair, and replacement; and reassembly instructions.
  - d. Instructions for identifying parts and components.
  - e. Review of spare parts needed for operation and maintenance.

**1.6 PREPARATION**

- A. Assemble educational materials necessary for instruction, including documentation and training module. Assemble training modules into a training manual organized in coordination with requirements in Section 017823 "Operation and Maintenance Data."
- B. Set up instructional equipment at instruction location.

**1.7 INSTRUCTION**

- A. Facilitator: Engage a qualified facilitator to prepare instruction program and training modules, to coordinate instructors, and to coordinate between Contractor and Owner for number of participants, instruction times, and location.
- B. Engage qualified instructors to instruct Owner's personnel to adjust, operate, and maintain systems, subsystems, and equipment not part of a system.
  1. Owner will furnish Contractor with names and positions of participants.
- C. Scheduling: Provide instruction at mutually agreed-on times. For equipment that requires seasonal operation, provide similar instruction at start of each season.
  1. Schedule training with Owner with at least seven days' advance notice.
- D. Training Location and Reference Material: Conduct training on-site in the completed and fully operational facility using the actual equipment in-place. Conduct training using final operation and maintenance data submittals.
- E. Evaluation: At conclusion of each training module, assess and document each participant's mastery of module by use of a demonstration performance-based test.
- F. Cleanup: Collect used and leftover educational materials and give to Owner. Remove instructional equipment. Restore systems and equipment to condition existing before initial training use.

ARKANSAS DEPARTMENT OF TRANSPORTATION  
JOB NO. 42-24  
WALDRON REST AREA SEWER REPLACEMENT  
PROJECT MANUAL

**PART 2 - PRODUCTS (Not Used)**  
**PART 3 - EXECUTION (Not Used)**

**END OF SECTION 01 79 00**

ARKANSAS DEPARTMENT OF TRANSPORTATION  
JOB NO. 42-24  
WALDRON REST AREA SEWER REPLACEMENT  
PROJECT MANUAL

**SECTION 32 92 00 - TURF AND GRASSES**

**PART 1 - GENERAL**

**1.1 SUMMARY**

A. Section Includes:

1. Sodding.

**1.2 INFORMATIONAL SUBMITTALS**

A. Qualification Data: For landscape Installer.

B. Certification of Grass Seed: From seed vendor for each grass-seed monostand or mixture, stating the botanical and common name, percentage by weight of each species and variety, and percentage of purity, germination, and weed seed. Include the year of production and date of packaging.

1. Certification of each seed mixture for turfgrass sod. Include identification of source and name and telephone number of supplier.

C. Product Certificates: For fertilizers, from manufacturer.

**1.3 CLOSEOUT SUBMITTALS**

A. Maintenance Data: Recommended procedures to be established by Owner for maintenance of turf during a calendar year. Submit before expiration of required maintenance periods.

**1.4 QUALITY ASSURANCE**

A. Installer Qualifications: A qualified landscape installer whose work has resulted in successful turf establishment.

1. Installer's Field Supervision: Require Installer to maintain an experienced full-time supervisor on Project site when work is in progress.
2. Personnel Certifications: Installer's field supervisor shall have certification in one of the following categories from the National Association of Landscape Professionals:
  - a. Landscape Industry Certified Technician - Exterior.
  - b. Landscape Industry Certified Lawn Care Manager.

ARKANSAS DEPARTMENT OF TRANSPORTATION  
JOB NO. 42-24  
WALDRON REST AREA SEWER REPLACEMENT  
PROJECT MANUAL

- c. Landscape Industry Certified Lawn Care Technician.
- 3. Pesticide Applicator: State licensed, commercial.

## **1.5 DELIVERY, STORAGE, AND HANDLING**

- A. Sod: Harvest, deliver, store, and handle sod according to requirements in "Specifications for Turfgrass Sod Materials" and "Specifications for Turfgrass Sod Transplanting and Installation" sections in TPI's "Guideline Specifications to Turfgrass Sodding." Deliver sod within 24 hours of harvesting and in time for planting promptly. Protect sod from breakage and drying.
- B. Bulk Materials:
  - 1. Do not dump or store bulk materials near structures, utilities, walkways and pavements, or on existing turf areas or plants.
  - 2. Provide erosion-control measures to prevent erosion or displacement of bulk materials; discharge of soil-bearing water runoff; and airborne dust reaching adjacent properties, water conveyance systems, or walkways.
  - 3. Accompany each delivery of bulk materials with appropriate certificates.

## **1.6 FIELD CONDITIONS**

- A. Planting Restrictions: Plant during one of the following periods. Coordinate planting periods with initial maintenance periods to provide required maintenance from date of Substantial Completion.
- B. Weather Limitations: Proceed with planting only when existing and forecasted weather conditions permit planting to be performed when beneficial and optimum results may be obtained. Apply products during favorable weather conditions according to manufacturer's written instructions.

## **PART 2 - PRODUCTS**

### **2.1 TURFGRASS SOD**

- A. Turfgrass Sod: Certified, complying with "Specifications for Turfgrass Sod Materials" in TPI's "Guideline Specifications to Turfgrass Sodding." Furnish viable sod of uniform density, color, and texture that is strongly rooted and capable of vigorous growth and development when planted.
- B. Turfgrass Species, Warm-Season Grass: Bermudagrass (*Cynodon dactylon*).

ARKANSAS DEPARTMENT OF TRANSPORTATION  
JOB NO. 42-24  
WALDRON REST AREA SEWER REPLACEMENT  
PROJECT MANUAL

**2.2 FERTILIZERS**

- A. Slow-Release Fertilizer: Granular or pelleted fertilizer consisting of 50 percent water-insoluble nitrogen, phosphorus, and potassium in the following composition:
  - 1. Composition:
    - a. 20 percent nitrogen, 10 percent phosphorous, and 10 percent potassium, by weight.

**2.3 PESTICIDES**

- A. General: Pesticide, registered and approved by the EPA, acceptable to authorities having jurisdiction, and of type recommended by manufacturer for each specific problem and as required for Project conditions and application. Do not use restricted pesticides unless authorized in writing by authorities having jurisdiction.
- B. Pre-Emergent Herbicide (Selective and Nonselective): Effective for controlling the germination or growth of weeds within planted areas at the soil level directly below the mulch layer.
- C. Post-Emergent Herbicide (Selective and Nonselective): Effective for controlling weed growth that has already germinated.

**PART 3 - EXECUTION**

**3.1 EXAMINATION**

- A. Examine areas to be planted for compliance with requirements and other conditions affecting installation and performance of the Work.
  - 1. Verify that no foreign or deleterious material or liquid such as paint, paint washout, concrete slurry, concrete layers or chunks, cement, plaster, oils, gasoline, diesel fuel, paint thinner, turpentine, tar, roofing compound, or acid has been deposited in soil within a planting area.
  - 2. Suspend planting operations during periods of excessive soil moisture until the moisture content reaches acceptable levels to attain the required results.
  - 3. Uniformly moisten excessively dry soil that is not workable or which is dusty.
- B. Proceed with installation only after unsatisfactory conditions have been corrected.

ARKANSAS DEPARTMENT OF TRANSPORTATION  
JOB NO. 42-24  
WALDRON REST AREA SEWER REPLACEMENT  
PROJECT MANUAL

- C. If contamination by foreign or deleterious material or liquid is present in soil within a planting area, remove the soil and contamination as directed by Architect and replace with new planting soil.

### **3.2 PREPARATION**

- A. Protect structures; utilities; sidewalks; pavements; and other facilities, trees, shrubs, and plantings from damage caused by planting operations.
  - 1. Protect grade stakes set by others until directed to remove them.
- B. Install erosion-control measures to prevent erosion or displacement of soils and discharge of soil-bearing water runoff or airborne dust to adjacent properties and walkways.

### **3.3 TURF AREA PREPARATION**

- A. Placing Planting Soil: Place manufactured planting soil over exposed subgrade.
  - 1. Reduce elevation of planting soil to allow for soil thickness of sod.
- B. Moisten prepared area before planting if soil is dry. Water thoroughly and allow surface to dry before planting. Do not create muddy soil.
- C. Before planting, obtain Architect's acceptance of finish grading; restore planting areas if eroded or otherwise disturbed after finish grading.

### **3.4 SODDING**

- A. Lay sod within 24 hours of harvesting. Do not lay sod if dormant or if ground is frozen or muddy.
- B. Lay sod to form a solid mass with tightly fitted joints. Butt ends and sides of sod; do not stretch or overlap. Stagger sod strips or pads to offset joints in adjacent courses. Avoid damage to soil or sod during installation. Tamp and roll lightly to ensure contact with soil, eliminate air pockets, and form a smooth surface. Work sifted soil or fine sand into minor cracks between pieces of sod; remove excess to avoid smothering sod and adjacent grass.
  - 1. Lay sod across slopes exceeding 1:3.
  - 2. Anchor sod on slopes exceeding 1:6 with wood pegs or steel staples spaced as recommended by sod manufacturer but not less than two anchors per sod strip to prevent slippage.
- C. Saturate sod with fine water spray within two hours of planting. During first week after planting, water daily or more frequently as necessary to maintain moist soil



ARKANSAS DEPARTMENT OF TRANSPORTATION  
JOB NO. 42-24  
WALDRON REST AREA SEWER REPLACEMENT  
PROJECT MANUAL

to a minimum depth of **1-1/2 inches** below sod.

### 3.5 TURF MAINTENANCE

- A. General: Maintain and establish turf by watering, fertilizing, weeding, mowing, trimming, replanting, and performing other operations as required to establish healthy, viable turf. Roll, regrade, and replant bare or eroded areas and remulch to produce a uniformly smooth turf. Provide materials and installation the same as those used in the original installation.
  - 1. Fill in as necessary soil subsidence that may occur because of settling or other processes. Replace materials and turf damaged or lost in areas of subsidence.
  - 2. Apply treatments as required to keep turf and soil free of pests and pathogens or disease. Use integrated pest management practices whenever possible to minimize the use of pesticides and reduce hazards.
  
- B. Watering: Install and maintain temporary piping, hoses, and turf-watering equipment to convey water from sources and to keep turf uniformly moist to a depth of **4 inches**.
  - 1. Schedule watering to prevent wilting, puddling, erosion, and displacement of seed or mulch. Lay out temporary watering system to avoid walking over muddy or newly planted areas.
  - 2. Water turf with fine spray at a minimum rate of **1 inch** per week unless rainfall precipitation is adequate.
  
- C. Mow turf as soon as top growth is tall enough to cut. Repeat mowing to maintain specified height without cutting more than one-third of grass height. Remove no more than one-third of grass-leaf growth in initial or subsequent mowings. Do not delay mowing until grass blades bend over and become matted. Do not mow when grass is wet. Schedule initial and subsequent mowings to maintain the following grass height:
  - 1. Mow bermudagrass to a height of **1/2 to 1 inch**.
  
- D. Turf Postfertilization: Apply slow-release fertilizer after initial mowing and when grass is dry.
  - 1. Use fertilizer that provides actual nitrogen of at least 1 lb/1000 sq. ft. to turf area.

### 3.6 SATISFACTORY TURF

- A. Turf installations shall meet the following criteria as determined by Architect:
  - 1. Satisfactory Seeded Turf: At end of maintenance period, a healthy,

ARKANSAS DEPARTMENT OF TRANSPORTATION  
JOB NO. 42-24  
WALDRON REST AREA SEWER REPLACEMENT  
PROJECT MANUAL

uniform, close stand of grass has been established, free of weeds and surface irregularities, with coverage exceeding 90 percent over any 10 sq. ft. and bare spots not exceeding 5 by 5 inches.

2. Satisfactory Sodded Turf: At end of maintenance period, a healthy, well-rooted, even-colored, viable turf has been established, free of weeds, open joints, bare areas, and surface irregularities.
- B. Use specified materials to reestablish turf that does not comply with requirements, and continue maintenance until turf is satisfactory.

### 3.7 PESTICIDE APPLICATION

- A. Apply pesticides and other chemical products and biological control agents according to requirements of authorities having jurisdiction and manufacturer's written recommendations. Coordinate applications with Owner's operations and others in proximity to the Work. Notify Owner before each application is performed.
- B. Post-Emergent Herbicides (Selective and Nonselective): Apply only as necessary to treat already-germinated weeds and according to manufacturer's written recommendations.

### 3.8 CLEANUP AND PROTECTION

- A. Promptly remove soil and debris created by turf work from paved areas. Clean wheels of vehicles before leaving site to avoid tracking soil onto roads, walks, or other paved areas.
- B. Remove surplus soil and waste material, including excess subsoil, unsuitable soil, trash, and debris, and legally dispose of them off Owner's property.
- C. Erect temporary fencing or barricades and warning signs as required to protect newly planted areas from traffic. Maintain fencing and barricades throughout initial maintenance period and remove after plantings are established.
- D. Remove nondegradable erosion-control measures after grass establishment period.

**END OF SECTION 32 92 00**

**ARKANSAS DEPARTMENT OF TRANSPORTATION CONSTRUCTION PLANS:  
 WALDRON REST AREA  
 SEWER SYSTEM REPLACEMENT  
 WALDRON, ARKANSAS  
 SCOTT COUNTY  
 JOB 42-24**

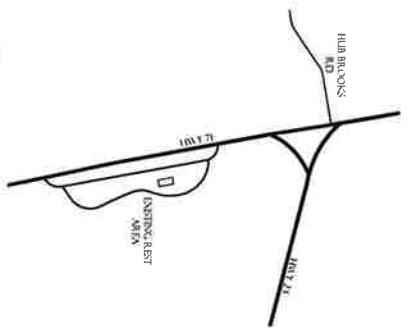

NORTH  
 VICINITY MAP  
 SCALE AND SCALE

INDEX OF SHEETS	
SHEET NO.	TITLE SHEET
C1.1	1
C1.1	2

UNLESS OTHERWISE  
 INDICATED, ALL  
 DIMENSIONS ARE IN FEET



**WALDRON REST AREA  
 SEWER SYSTEM REPLACEMENT**  
 Waldron, Arkansas  
 Scott County



DATE: APRIL 3, 2024  
 JOB NO: 42-24  
 DRAWING NO: 10  
 REVISIONS:

**C1.1**  
 1 OF 2

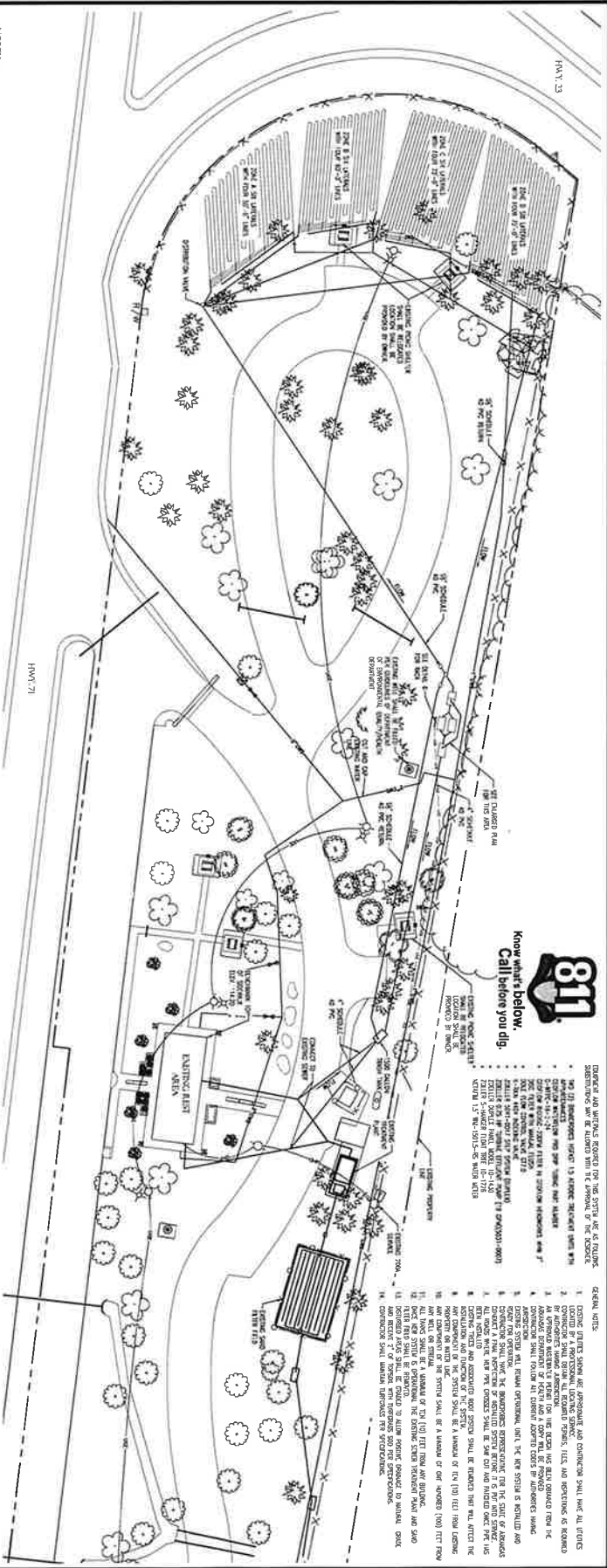

OPERATOR AND WITHOUT RECORD FOR THE SERVICE OF AS FOLLOWS:  
 OPERATIONS ARE TO BE MAINTAINED IN THE PRESENCE OF THE CONTRACTOR.  
 1. THE CONTRACTOR SHALL BE RESPONSIBLE FOR THE PROTECTION AND MAINTENANCE OF ALL UTILITIES AND STRUCTURES EXISTING ON THE PROJECT.  
 2. THE CONTRACTOR SHALL BE RESPONSIBLE FOR THE PROTECTION AND MAINTENANCE OF ALL UTILITIES AND STRUCTURES EXISTING ON THE PROJECT.  
 3. THE CONTRACTOR SHALL BE RESPONSIBLE FOR THE PROTECTION AND MAINTENANCE OF ALL UTILITIES AND STRUCTURES EXISTING ON THE PROJECT.  
 4. THE CONTRACTOR SHALL BE RESPONSIBLE FOR THE PROTECTION AND MAINTENANCE OF ALL UTILITIES AND STRUCTURES EXISTING ON THE PROJECT.  
 5. THE CONTRACTOR SHALL BE RESPONSIBLE FOR THE PROTECTION AND MAINTENANCE OF ALL UTILITIES AND STRUCTURES EXISTING ON THE PROJECT.  
 6. THE CONTRACTOR SHALL BE RESPONSIBLE FOR THE PROTECTION AND MAINTENANCE OF ALL UTILITIES AND STRUCTURES EXISTING ON THE PROJECT.  
 7. THE CONTRACTOR SHALL BE RESPONSIBLE FOR THE PROTECTION AND MAINTENANCE OF ALL UTILITIES AND STRUCTURES EXISTING ON THE PROJECT.  
 8. THE CONTRACTOR SHALL BE RESPONSIBLE FOR THE PROTECTION AND MAINTENANCE OF ALL UTILITIES AND STRUCTURES EXISTING ON THE PROJECT.  
 9. THE CONTRACTOR SHALL BE RESPONSIBLE FOR THE PROTECTION AND MAINTENANCE OF ALL UTILITIES AND STRUCTURES EXISTING ON THE PROJECT.  
 10. THE CONTRACTOR SHALL BE RESPONSIBLE FOR THE PROTECTION AND MAINTENANCE OF ALL UTILITIES AND STRUCTURES EXISTING ON THE PROJECT.  
 11. THE CONTRACTOR SHALL BE RESPONSIBLE FOR THE PROTECTION AND MAINTENANCE OF ALL UTILITIES AND STRUCTURES EXISTING ON THE PROJECT.  
 12. THE CONTRACTOR SHALL BE RESPONSIBLE FOR THE PROTECTION AND MAINTENANCE OF ALL UTILITIES AND STRUCTURES EXISTING ON THE PROJECT.  
 13. THE CONTRACTOR SHALL BE RESPONSIBLE FOR THE PROTECTION AND MAINTENANCE OF ALL UTILITIES AND STRUCTURES EXISTING ON THE PROJECT.  
 14. THE CONTRACTOR SHALL BE RESPONSIBLE FOR THE PROTECTION AND MAINTENANCE OF ALL UTILITIES AND STRUCTURES EXISTING ON THE PROJECT.

1 SITE PLAN  
 SCALE: 1"=300'

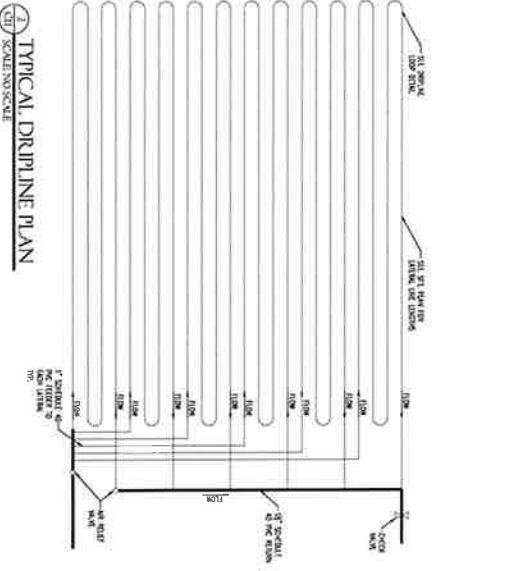

2 TYPICAL DRILINE PLAN  
 SCALE: 1"=30'

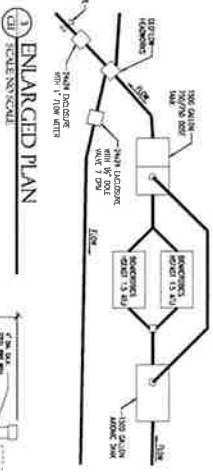

3 ENLARGED PLAN  
 SCALE: 1"=30'

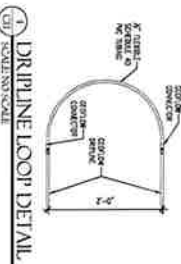

4 DRILINE LOOP DETAIL  
 SCALE: 1"=30'

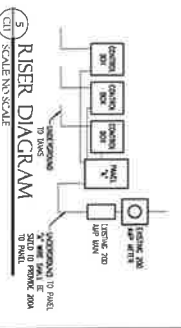

5 RISER DIAGRAM  
 SCALE: 1"=30'

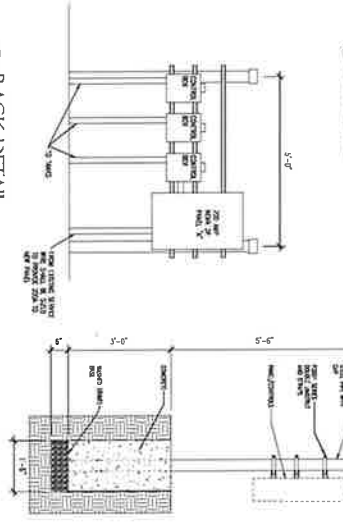

6 RACK DETAIL  
 SCALE: 1"=30'

SECTION	DESCRIPTION	DATE	BY	CHECKED
A	VERTICAL			
B	HORIZONTAL			
C	PLAN			
D	SECTION			
E	SECTION			
F	SECTION			
G	SECTION			
H	SECTION			
I	SECTION			
J	SECTION			
K	SECTION			
L	SECTION			
M	SECTION			
N	SECTION			
O	SECTION			
P	SECTION			
Q	SECTION			
R	SECTION			
S	SECTION			
T	SECTION			
U	SECTION			
V	SECTION			
W	SECTION			
X	SECTION			
Y	SECTION			
Z	SECTION			

7 PANEL SCHEDULE  
 SCALE: 1"=30'



WALDRON REST AREA  
 SEWER SYSTEM REPLACEMENT  
 Waldron, Arkansas  
 Scott County

