

**ADDENDUM NO. 1 – JOB SA5741**

**ARKANSAS DEPARTMENT OF TRANSPORTATION**

**PROGRAM MANAGEMENT DIVISION**

**LITTLE ROCK, ARKANSAS**

March 18, 2024

**TO:** Eligible Bidders – Job SA5741

**SUBJECT:** Proposal Documents Changes

The project length has been reduced by 0.41 mile. The associated pay items have been revised as shown in the table below. Lettersize Plan Sheets 1, 6, 8, and 10, Proposal Document Page 2, the Proposal Schedule of Items (1 page), and the EBS file have been revised to reflect these changes. You should substitute the revised sheets into your proposal documents and consider these revisions when submitting your bid.

Line No.	Item Description	Previous Quantity	Revised Quantity	Unit
0001	Aggregate Base Course (Class 7)	502	437	Ton
0002	Tack Coat	5,405	4,720	Gal.
0003	Mineral Aggregate in ACHM Surface Course (1/2")	5,757	5,031	Ton
0004	Asphalt Binder (PG 64-22) in ACHM Surface Course (1/2")	387	338	Ton

**ACKNOWLEDGEMENT OF THIS ADDENDUM SHALL BE MADE BY SIGNING BELOW AND SUBMITTING THIS SIGNED FORM TO THE PROGRAM MANAGEMENT DIVISION BY EMAIL AT [pmd@ardot.gov](mailto:pmd@ardot.gov) OR BY FAX AT (501)569-2623.**

Sincerely,

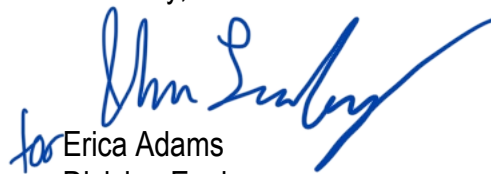

for Erica Adams  
Division Engineer  
Program Management

\_\_\_\_\_  
Name

\_\_\_\_\_  
Company

EMAILED ADDENDUM

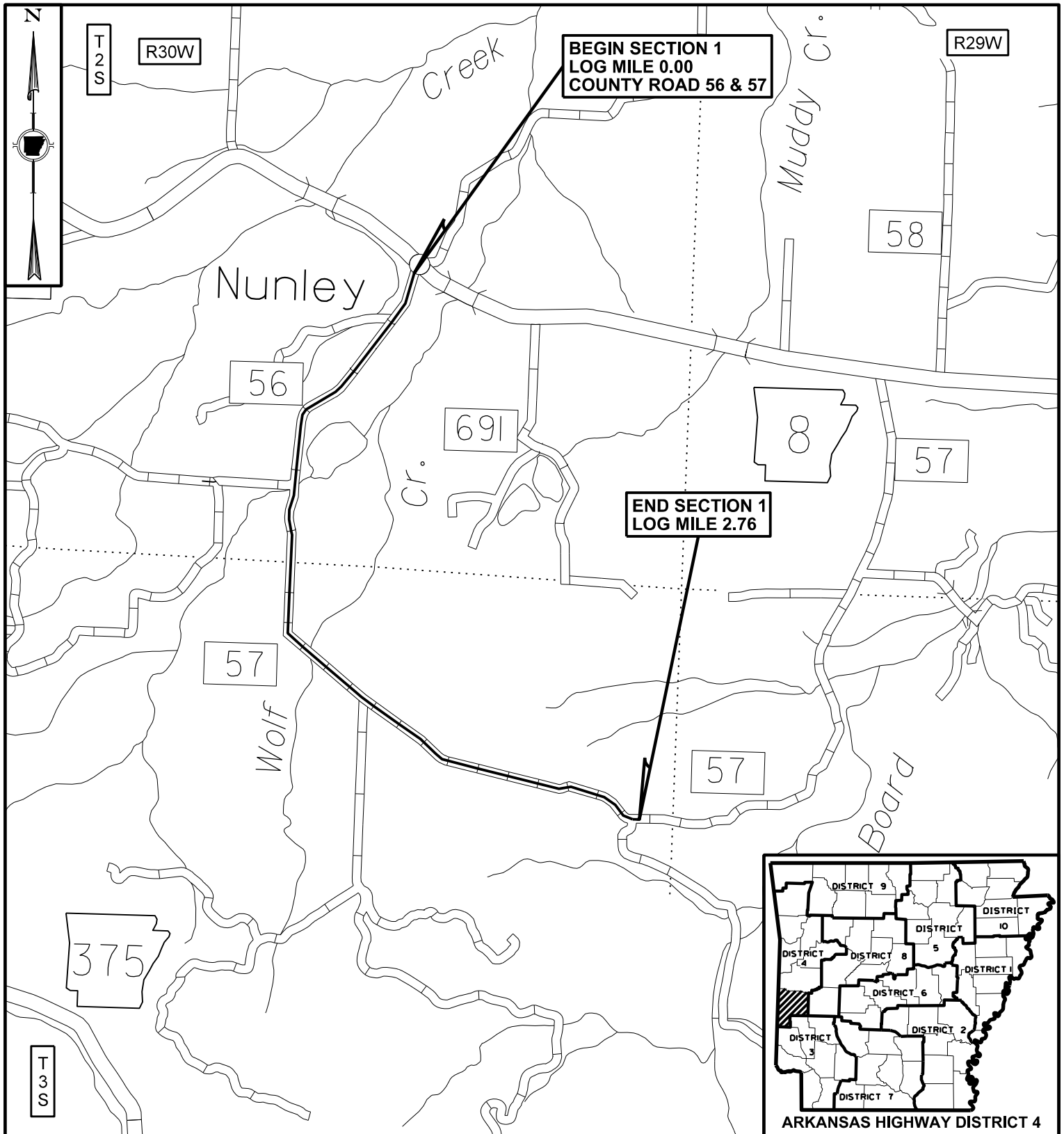

# JOB SA5741

**HWY. 8 - SOUTH (OVERLAY) (S)  
CO. RDS. 56 & 57  
POLK COUNTY**

**APPROXIMATE CENTER OF SECTION 1**

**LATITUDE: N 34° 31' 12"**

**LONGITUDE: W 94° 09' 46"**

Digitally signed by  
Freeling, Bryan E.  
Date: 2024.03.15  
10:57:59-05'00'



REVISED 03-14-24

**SHEET 1 OF 10**

NOTE: DETAILS MAY BE MODIFIED TO MEET LOCAL  
CONDITIONS AS DIRECTED BY THE ENGINEER.

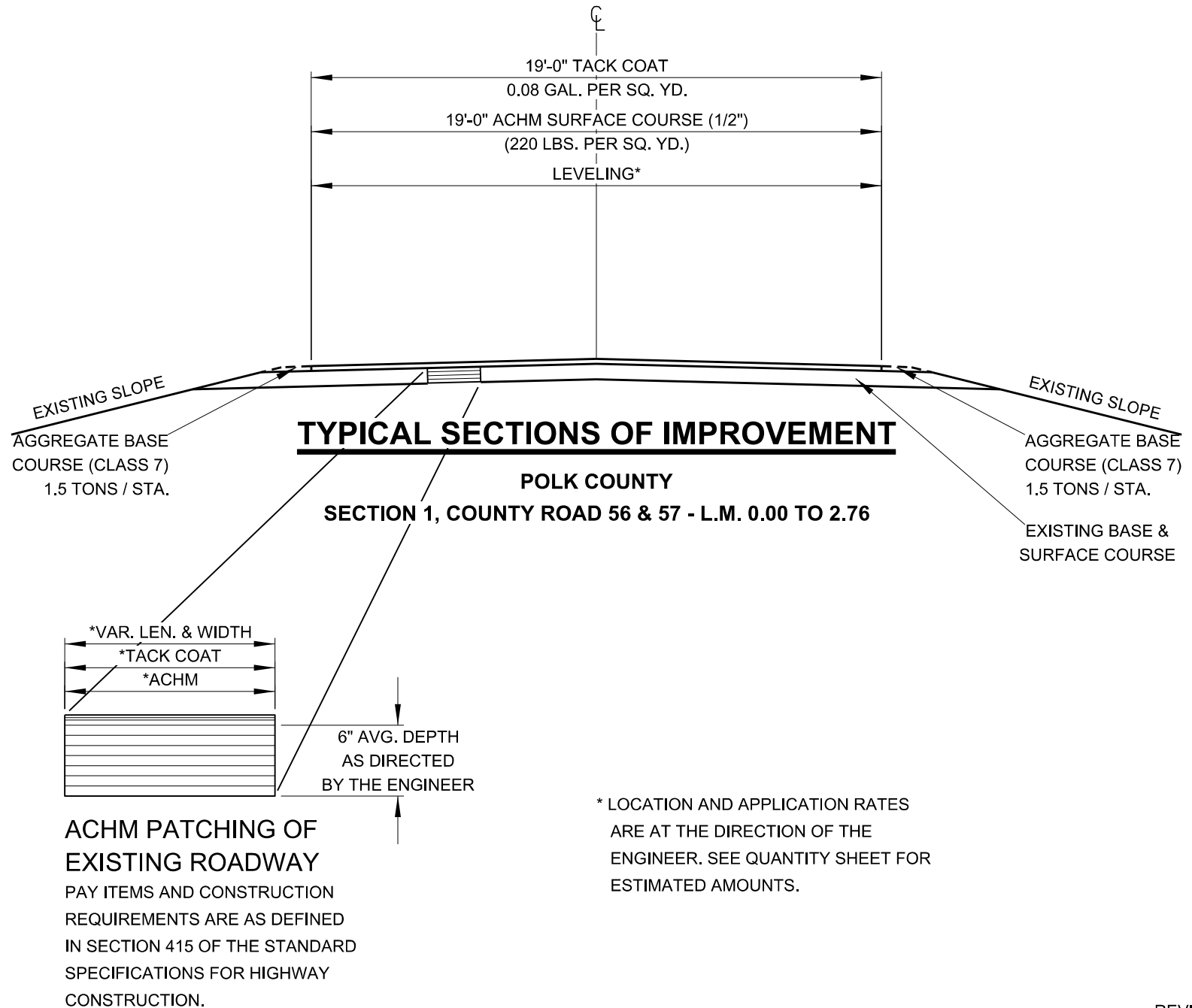

## PATCHING AND SURFACING

DESCRIPTION	LOG MILE		LENGTH	AGGREGATE BASE COURSE (CLASS 7)	ACHM PATCHING OF EXISTING ROADWAY**	TACK COAT			ACHM SURFACE COURSE (1/2")		
	FROM	TO	LIN. FT.	TON	TON	WIDTH	SQ. YD.	GAL.	WIDTH	SQ. YD.	TON
SECTION 1 - COUNTY ROAD 56 & 57											
MAIN LANES	0.00	2.76	14573		100.0	19.00	30765.2	2461.2	19.00	30765.2	3384.2
SHOULDERS	0.00	2.76	14573	437.2							
46 PRIVATE ENTRANCES (ADD'L 415')							317.6	25.4		317.6	34.9
1 COUNTY ROAD TURNOUT							230.3	18.4		230.3	25.3
LEVELING**								2215.1			1925.0
								</			

**BASIS OF ESTIMATE:**  
TACK COAT \_\_\_\_\_ 0.08 GAL. PER SQ. YD.  
ACHM SURFACE COURSE (1/2") \_\_\_\_\_ 220 POUND PER SQ. YD.  
AGGREGATE BASE COURSE (CLASS 7) FOR SHOULDERS \_\_\_\_\_ 3 TON PER STATION

**VOLUME CONTROL:**  
ASPHALT BINDER (PG 64-22) IN ACHM SURFACE COURSE (1/2") \_\_\_\_\_ 6.3%  
MINERAL AGGREGATE IN ACHM SURFACE COURSE (1/2") \_\_\_\_\_ 93.7%

\*\*QUANTITY ESTIMATED. TO BE USED IF AND WHERE DIRECTED BY THE ENGINEER. SEE SECTION 104.03 OF THE STANDARD SPECIFICATIONS FOR HIGHWAY CONSTRUCTION.

## SUMMARY OF QUANTITIES

[illegible]

## REVISIONS

DATE	REVISION	SHEET NO.
3/14/2024	REVISED LENGTH OF SECTION 1 TO 2.76 MILES.	1, 6, 8, & 10

# ARKANSAS STATE HIGHWAY COMMISSION

## PROPOSAL DOCUMENTS

### PROPOSAL FOR CONSTRUCTING:

THE PURPOSE OF THIS PROJECT IS TO SURFACE APPROXIMATELY 2.76 MILES OF COUNTY ROADS 56 & 57 IN POLK COUNTY. THIS PROJECT CONSISTS OF AGGREGATE BASE COURSE, ACHM SURFACE COURSE, MAINTENANCE OF TRAFFIC, AND MISC. ITEMS.

County Road No. CRS 56 & 57 in **POLK** County, Arkansas, in accordance with Standard Specifications for Highway Construction, Edition of 2014; the Supplemental Specifications and Special Provisions attached hereto; and the Construction Plans on file in the Office of the State Highway Commission, designated as

Job **SA5741**                      **STATE AID COUNTY JOB (CODE 9970)**

Job Name: **HWY. 8 – SOUTH (OVERLAY) (S)**

said project being approximately **2.76 miles in length.**

Proposal received until 10:00 a.m. on April 10, 2024

### TO THE ARKANSAS STATE HIGHWAY COMMISSION:

Gentlemen: By submission of your bid, you agree to the following:

It is hereby certified that a careful examination has been made of the Plans, Specifications, Supplemental Specifications, Special Provisions, and Form of Contract and the site of the work throughout its whole extent. On the basis of the Plans, Specifications, Supplemental Specifications, Special Provisions, and Form of Contract, the bidder proposes to furnish all necessary machinery, equipment, tools, labor and other means of construction, and to furnish all materials as specified, in the manner and at the time prescribed, and to finish the entire project within the time hereinafter proposed. The bidder understands that the quantities of work mentioned herein are approximate only, and are subject to increase or decrease, and hereby proposes to perform all quantities of work, whether increased or decreased, in accordance with the provisions of the Specifications, and at the unit prices bid in the attached Schedule of Items.

Receipt is hereby specifically acknowledged, and complete examination expressly guaranteed of the following:

1. Standard Specifications for Highway Construction, Edition of 2014.
2. Supplemental Specifications.
3. Special Provisions.
4. Proposal Documents.
5. Schedule of Items.
6. Construction Plans.

The bidder further proposes to perform all Extra Work that may be required, on the basis provided in the Specifications, and to give such work personal attention, and to secure economical performance.

The bidder further proposes to execute the contract agreement, and to furnish satisfactory bonds within ten days after he has received notice that he has been awarded the contract. The bidder further agrees to begin work when ordered by the Engineer, or within ten days thereafter, and to complete the work **on or before November 22, 2024.**

Arkansas Department of Transportation  
Schedule of Items

State Job No.: SA5741

Job Name: HWY. 8 – SOUTH (OVERLAY) (S)

Federal Aid Project: 9970SA5741

Date Estimated: 1/25/2024

Date Revised: 3/14/2024

Line Number	Item Code and Description	Estimated Quantity	Unit Bid Price	Price Extension
Section 01 - ROADWAY ITEMS				
0001	SPSS303 - AGGREGATE BASE COURSE (CLASS 7)	437.000 TON		
0002	SS&401 - TACK COAT	4,720.000 GAL		
0003	SPSS407 - MINERAL AGGREGATE IN ACHM SURFACE COURSE (1/2")	5,031.000 TON		
0004	SPSS407 - ASPHALT BINDER (PG 64-22) IN ACHM SURFACE COURSE (1/2") (MINIMUM BID \$120.00)	338.000 TON		
0005	SPSS415 - ACHM PATCHING OF EXISTING ROADWAY	100.000 TON		
0006	SS&603 - MAINTENANCE OF TRAFFIC	1.000 L.S.		
0007	SS&604 - SIGNS	176.000 SQFT		
			Section 01 Total:	
			Subtotal:	
0008	601 - MOBILIZATION (UNIT BID AMOUNT MAY NOT EXCEED 5% OF SUBTOTAL)	1.000 L.S.		
			Bid Total:	